

F.A.P. RTE.	SECTION	COUNTY	TOTAL SHEETS	SHEET NO.
310	60-15HB-3	MADISON	93	85
STA.		TO STA.		
FED. ROAD DIST. NO.	ILLINOIS FED. AID PROJECT			
CONTRACT NO. 76706				

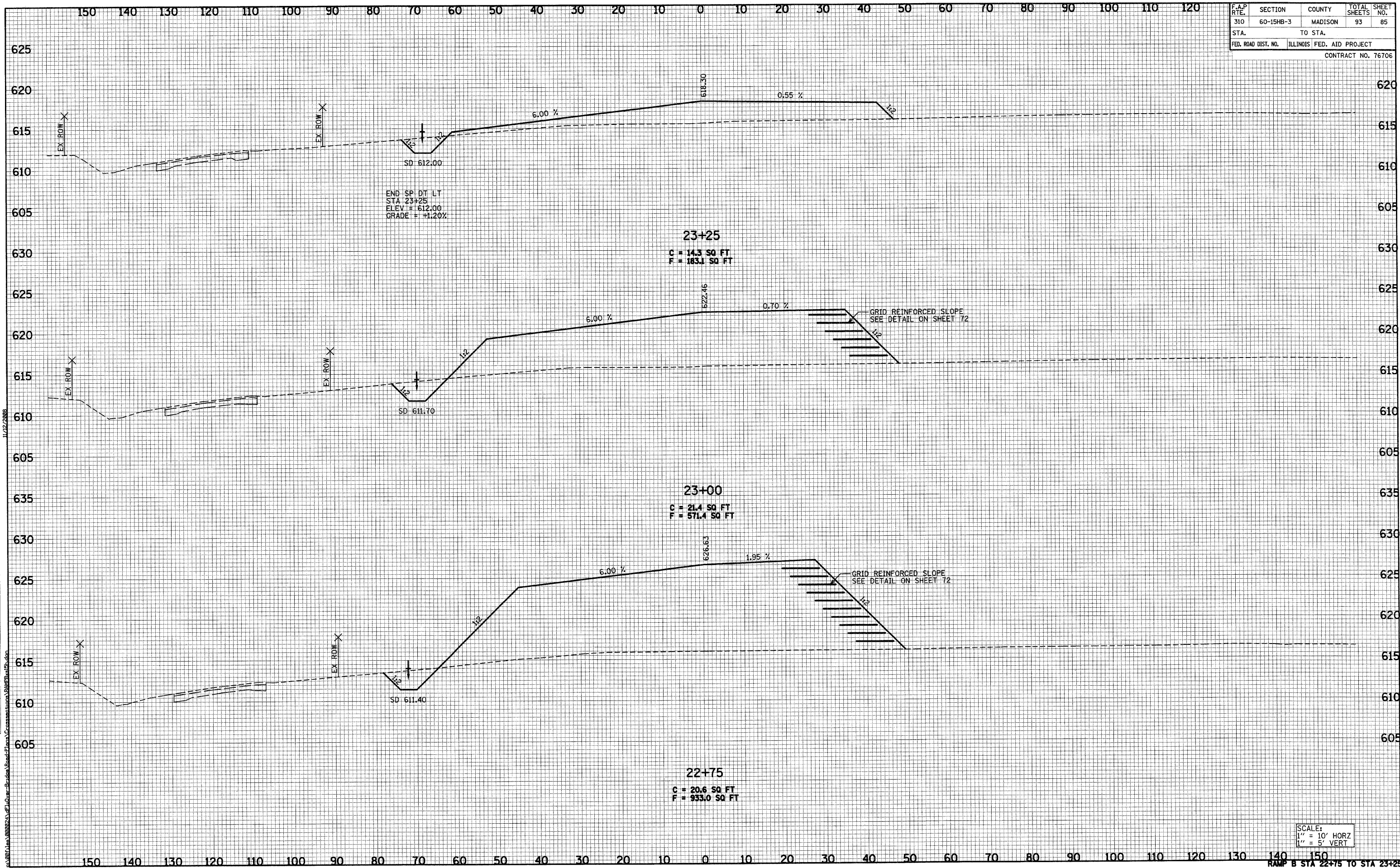

END SP DT LT  
 STA 23+25  
 ELEV = 612.00  
 GRADE = +1.20%

23+25  
 C = 14.3 SQ FT  
 F = 183.1 SQ FT

23+00  
 C = 21.4 SQ FT  
 F = 571.4 SQ FT

22+75  
 C = 20.6 SQ FT  
 F = 933.0 SQ FT

SCALE:  
 1" = 10' HORZ  
 1" = 5' VERT

RAMP B STA 22+75 TO STA 23+25

DATE \_\_\_\_\_  
 BY \_\_\_\_\_  
 SURVEYED \_\_\_\_\_  
 PLOTTED \_\_\_\_\_  
 NOTE BOOK \_\_\_\_\_  
 AREAS CHECKED \_\_\_\_\_

DATE \_\_\_\_\_  
 BY \_\_\_\_\_  
 SURVEYED \_\_\_\_\_  
 PLOTTED \_\_\_\_\_  
 NOTE BOOK \_\_\_\_\_  
 AREAS CHECKED \_\_\_\_\_