

F.A.P. RTE.	SECTION	COUNTY	TOTAL SHEETS	SHEET NO.
310	60-15HB-3	MADISON	93	89
STA.		TO STA.		
FED. ROAD DIST. NO.		ILLINOIS FED. AID PROJECT		
CONTRACT NO. 76706				

FINAL SURVEY NO.	DATE
SURVEYED BY	
PLOTTED BY	
TEMPLATE NO.	
AREAS CHECKED	

ORIGINAL SURVEY NO.	DATE
SURVEYED BY	
PLOTTED BY	
TEMPLATE NO.	
AREAS CHECKED	

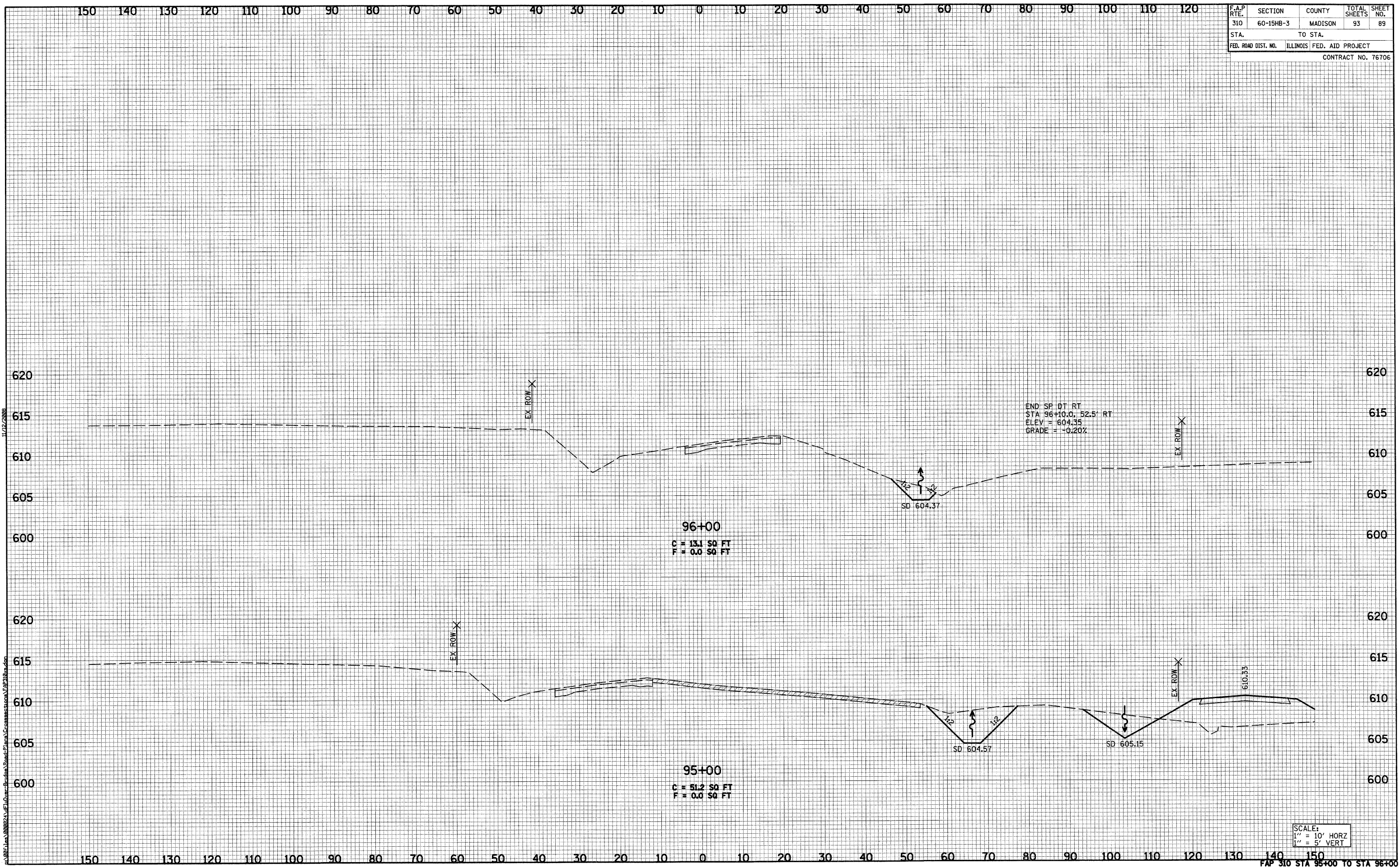

END SP DT RT
 STA 96+10.0, 52.5' RT
 ELEV = 604.35
 GRADE = -0.20%

96+00
 C = 13.1 SO FT
 F = 0.0 SO FT

95+00
 C = 51.2 SO FT
 F = 0.0 SO FT

SCALE:
 1" = 10' HORZ
 1" = 5' VERT

FAP 310 STA 95+00 TO STA 96+00