

DATE	
BY	
PLANNED	
CHECKED	
REVISED	
NO.	
CADD FILE NAME	

DATE	
BY	
PLANNED	
CHECKED	
REVISED	
NO.	
STRUCTURE NOTATION CIRCUIT	

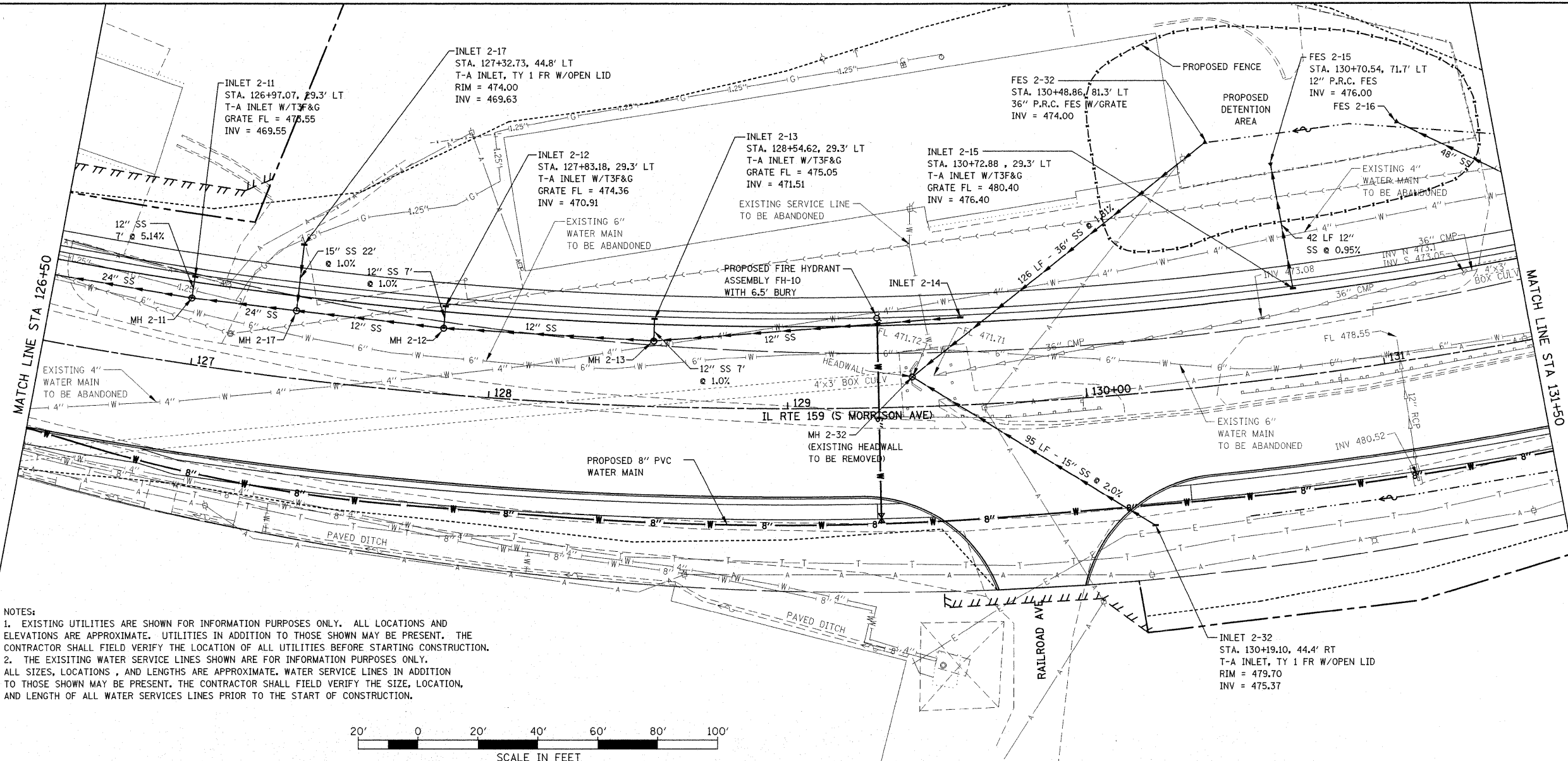

NOTES:  
 1. EXISTING UTILITIES ARE SHOWN FOR INFORMATION PURPOSES ONLY. ALL LOCATIONS AND ELEVATIONS ARE APPROXIMATE. UTILITIES IN ADDITION TO THOSE SHOWN MAY BE PRESENT. THE CONTRACTOR SHALL FIELD VERIFY THE LOCATION OF ALL UTILITIES BEFORE STARTING CONSTRUCTION.  
 2. THE EXISTING WATER SERVICE LINES SHOWN ARE FOR INFORMATION PURPOSES ONLY. ALL SIZES, LOCATIONS, AND LENGTHS ARE APPROXIMATE. WATER SERVICE LINES IN ADDITION TO THOSE SHOWN MAY BE PRESENT. THE CONTRACTOR SHALL FIELD VERIFY THE SIZE, LOCATION, AND LENGTH OF ALL WATER SERVICES LINES PRIOR TO THE START OF CONSTRUCTION.

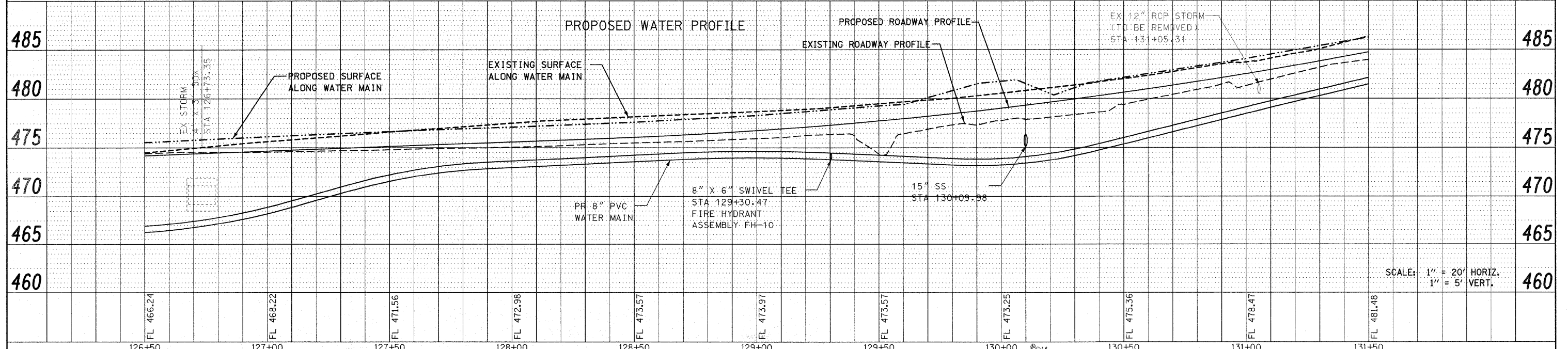
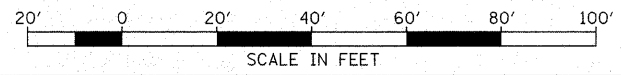

FILE NAME =	USER NAME = default	DESIGNED -	REVISED -	<b>STATE OF ILLINOIS DEPARTMENT OF TRANSPORTATION</b>	<b>DRAINAGE AND UTILITY PLAN/PROFILE IL ROUTE 159</b>	F.A.P. RTE.	SECTION	COUNTY	TOTAL SHEETS	SHEET NO.
P:\Projects\513501\CADD\DWG\0876830-shd-d	am.dgn	DRAWN -	REVISED -			600	60-(30,31,128)-1	MADISON/ST. CLAIR	399	104
PLOT SCALE = 20.0000' / IN.		CHECKED -	REVISED -			CONTRACT NO. 76830				
PLOT DATE = 12/17/2009		DATE -	REVISED -			FED. ROAD DIST. NO. ILLINOIS FED. AID PROJECT				