

DATE	
BY	
SURVEYED	
PLOTTED	
TEMPLATE	
NOTE BOOK	
NO.	
AREAS CHECKED	

DATE	
BY	
SURVEYED	
PLOTTED	
TEMPLATE	
NOTE BOOK	
NO.	
AREAS CHECKED	

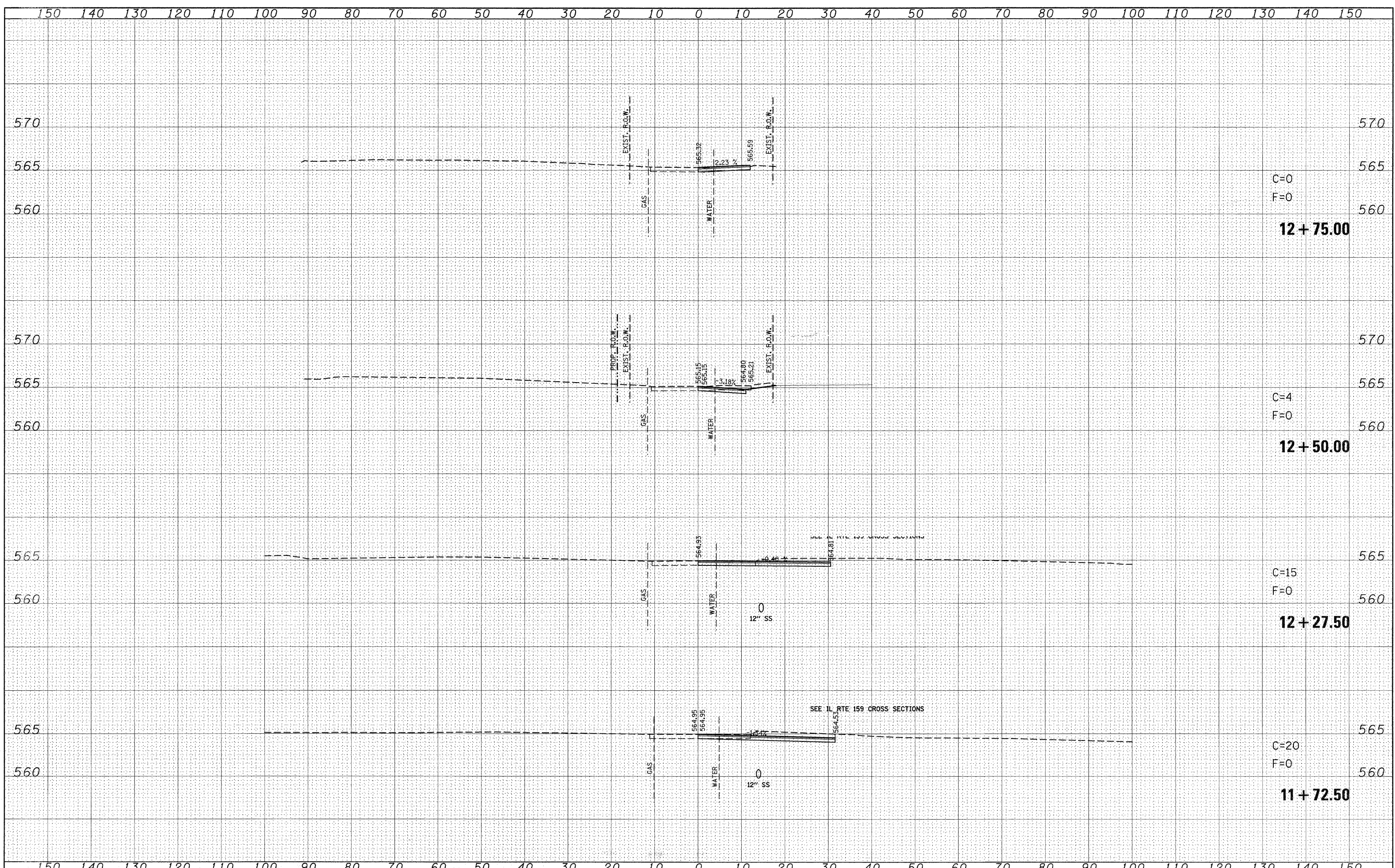

C=0  
F=0  
**12+75.00**

C=4  
F=0  
**12+50.00**

C=15  
F=0  
**12+27.50**

C=20  
F=0  
**11+72.50**

FILE NAME = P:\Projects\513501\CADD\DCN\076830-sht-xssht-11\eg15602.dgn	USER NAME = default	DESIGNED -	REVISED -	<b>STATE OF ILLINOIS DEPARTMENT OF TRANSPORTATION</b>	<i>Rev</i> <b>ALLEY @ IL 159 STA 156+02 SIDE ROAD CROSS SECTIONS</b>	F.A.P. RTE. 600	SECTION 60-(30,31,128)-1	COUNTY ST. CLAIR/MADISON	TOTAL SHEETS 399	SHEET NO. 399	
PLOT SCALE = 10,0000' / IN.	DESIGNED -	REVISED -	SCALE:			SHEET NO. 120 OF 120 SHEETS	STA. 12+27.50	TO STA. 12+75.00	CONTRACT NO. 76830		
PLOT DATE = 12/17/2009	CHECKED -	REVISED -	ILLINOIS FED. AID PROJECT								
	DATE -	REVISED -									