

PRESTAGE CONSTRUCTION -

1. PRESTAGE CONSTRUCTION SHALL CONSIST OF REMOVAL OF THE EXISTING HMA SHOULDERS AND EXISTING GUARDRAIL ON THE WEST SIDE OF THE PAVEMENT; CONSTRUCTION OF THE PROPOSED WIDENING FOR STAGE I TRAFFIC AS SHOWN IN THE PLANS; AND REMOVAL OF THE EXISTING CONCRETE MEDIAN ON EACH SIDE OF THE STRUCTURE AND REPLACING WITH PCC BASE COURSE - 8 1/2".
2. TRAFFIC CONTROL FOR THIS WORK SHALL BE IN ACCORDANCE WITH THE APPLICABLE PORTIONS OF TRAFFIC CONTROL AND PROTECTION STANDARD 701326 AND AS SHOWN IN THE TRAFFIC CONTROL PLANS.

STAGE I CONSTRUCTION -

1. STAGE I CONSTRUCTION SHALL CONSIST OF CLOSING THE NORTH BOUND LANE OF IL 160 AND SWITCHING BOTH LANES OF TRAFFIC TO THE SOUTHBOUND LANE; STAGE I BRIDGE REPAIRS; REMOVAL OF THE EXISTING HMA SHOULDERS AND EXISTING GUARDRAIL ON THE EAST SIDE OF THE PAVEMENT; AND CONSTRUCTION OF THE PROPOSED WIDENING ON THE EAST SIDE OF THE PAVEMENT FOR STAGE II TRAFFIC. THIS WORK WILL BE DONE TO THE LIMITS SHOWN IN THE STAGE I CONSTRUCTION PLANS.
2. TRAFFIC CONTROL FOR THIS WORK SHALL BE IN ACCORDANCE WITH THE APPLICABLE PORTIONS OF TRAFFIC CONTROL AND PROTECTION, STANDARD 701316 AND AS SHOWN IN THE TRAFFIC CONTROL PLANS.

STAGE II CONSTRUCTION -

1. STAGE II CONSTRUCTION SHALL CONSIST OF CLOSING THE SOUTH BOUND LANE OF IL 160 AND SWITCHING BOTH LANES OF TRAFFIC TO THE NORTHBOUND LANE AND COMPLETING STAGE II BRIDGE REPAIRS. THIS WORK WILL BE DONE TO THE LIMITS SHOWN IN THE STAGE II CONSTRUCTION PLANS.
2. THE STAGE II BRIDGE REPAIRS WILL BE DONE IN ACCORDANCE WITH THE APPLICABLE PORTIONS OF TRAFFIC CONTROL AND PROTECTION 701316 AND AS SHOWN IN THE TRAFFIC CONTROL PLANS.

STAGE III CONSTRUCTION -

1. STAGE III CONSTRUCTION SHALL CONSIST OF REPLACING THE MEDIAN REMOVED IN THE PRESTAGE CONSTRUCTION WITH EITHER SOLID CONCRETE MEDIAN (DOWELLED) OR CONCRETE MEDIAN SURFACE WITH MOUNTABLE CONCRETE CURB (DOWELLED) AND PLACING THE HMA SURFACE COURSE TO THE LIMITS AS SHOWN IN THE STAGE III CONSTRUCTION PLANS.
2. TRAFFIC CONTROL FOR THIS WORK SHALL BE ACCORDING TO THE PLANS AS SHOWN IN STAGE III.

NOTES -

1. THE PROPOSED WIDENING SHALL CONSIST OF HMA BASE COURSE - 10 1/2" AND SHALL INCLUDE PLACING EARTH EXCAVATION AGAINST WIDENING TO DRAIN. THE HMA SURFACE COURSE SHALL CONSIST OF HMA SURFACE COURSE, MIX "D", N70 - 2".
2. ALL CONFLICTING PAVEMENT MARKING SHALL BE REMOVED PRIOR TO PLACING PAVEMENT MARKING NECESSARY FOR STAGE CONSTRUCTION. THE COST FOR THIS SHALL BE INCLUDED IN THE APPLICABLE TRAFFIC CONTROL AND PROTECTION STANDARD.
3. THIS PROJECT WILL REQUIRE TEMPORARY RUMBLE STRIP.
4. THE TEMPORARY SAND FILL FOR INLETS SHALL BE ACCORDING TO SECTION 1003.01 OF THE STANDARD SPECIFICATIONS AND SHALL BE CONSIDERED AS INCLUDED IN THE COST OF THE APPLICABLE TRAFFIC CONTROL AND PROTECTION.

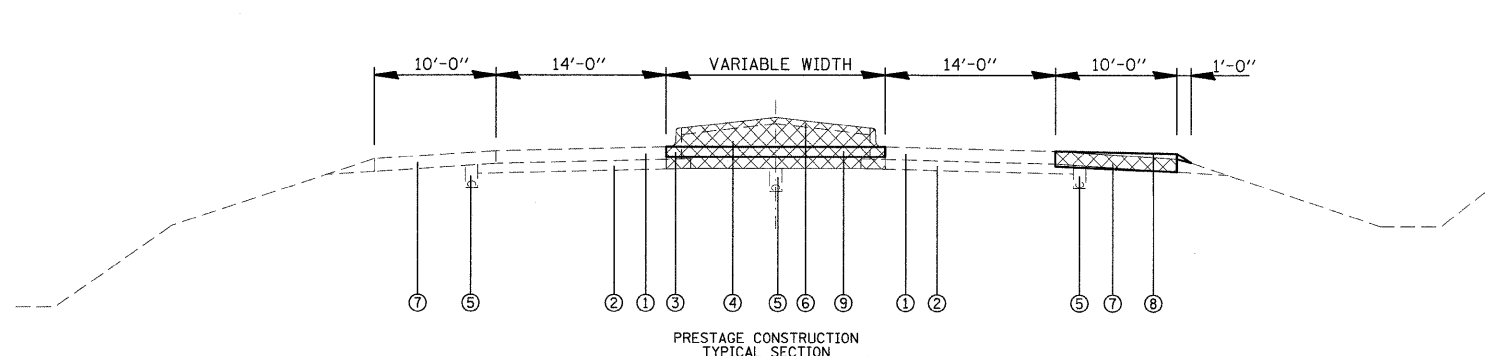

LEGEND

- ① EXISTING PCC PAVEMENT - 10"
 - ② EXISTING SUB BASE GRANULAR MATERIAL, TYPE A - 6"
 - ③ EXISTING COMBINATION CONCRETE CURB AND GUTTER, TYPE M 6.06
 - ④ EXISTING SAND FILL
 - ⑤ EXISTING PIPE UNDERDRAIN 4"
 - ⑥ EXISTING CONCRETE MEDIAN SURFACE 4"/SOLID MEDIAN*
 - ⑦ EXISTING BITUMINOUS SHOULDERS - 8"
 - ⑧ PROPOSED HMA BASE COURSE - 10 1/2"
 - ⑨ PROPOSED PCC BASE COURSE - 8 1/2"
 - ⑩ PROPOSED CONCRETE MEDIAN, TYPE SM (DOWELLED)
 - ⑪ PROPOSED HMA SURFACE COURSE - 2"
 - ⑫ BASE COURSE PLACED IN PREVIOUS STAGE
 - ⑬ PROPOSED DOWELL BARS
 - ⑭ DRUM WITH FLASHING LIGHT
 - ⑮ VERTICAL BARRICADE
- ☒ REMOVAL

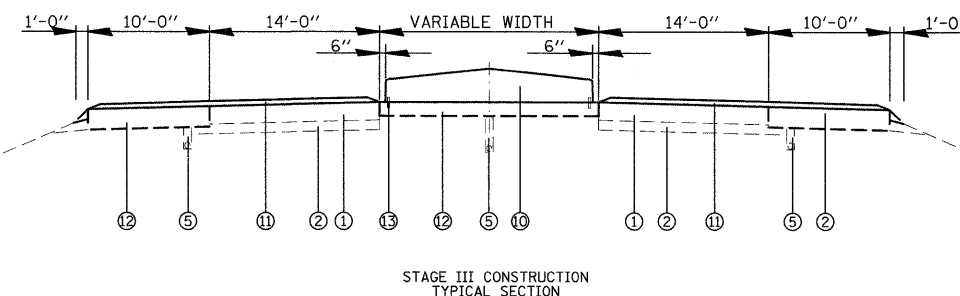
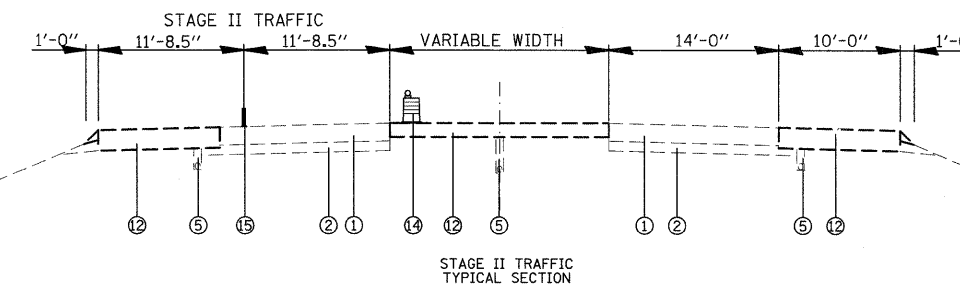
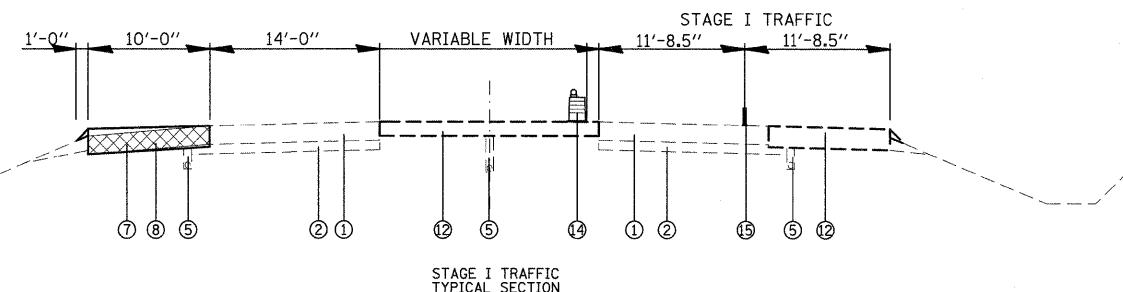

Rev.

FILE NAME =	USER NAME = manntm	DESIGNED -	REVISED -	STATE OF ILLINOIS DEPARTMENT OF TRANSPORTATION	SUGGESTED STAGES OF CONSTRUCTION & TRAFFIC CONTROL - LOCATION 1	FAPP. RTE.	SECTION	COUNTY	TOTAL SHEETS	SHEET NO.
ca\pwork\pwork\manntm\dms2470\p110207e.dgn		DRAWN -	REVISED -			327	14-12BR-1	CLINTON	72	11
PLOT SCALE = 20.0000' / IN.		CHECKED -	REVISED -			CONTRACT NO. 76B27				
PLOT DATE = 12/8/2009		DATE -	REVISED -			ILLINOIS FED. AID PROJECT				
				SCALE: 1" = 20'	SHEET NO. 1 OF 7 SHEETS	STA. TO STA.				