

SIGN SPACING	
POSTED SPEED	SIGN SPACING
55	500' (150 m)
50-45	350' (100 m)
<45	200' (60 m)

DRUMS SHALL BE PLACED AT 25' CENTERS.

TRAFFIC CONTROL NOT SHOWN WILL BE IN ACCORDANCE WITH TRAFFIC CONTROL AND PROTECTION STANDARD 701316.

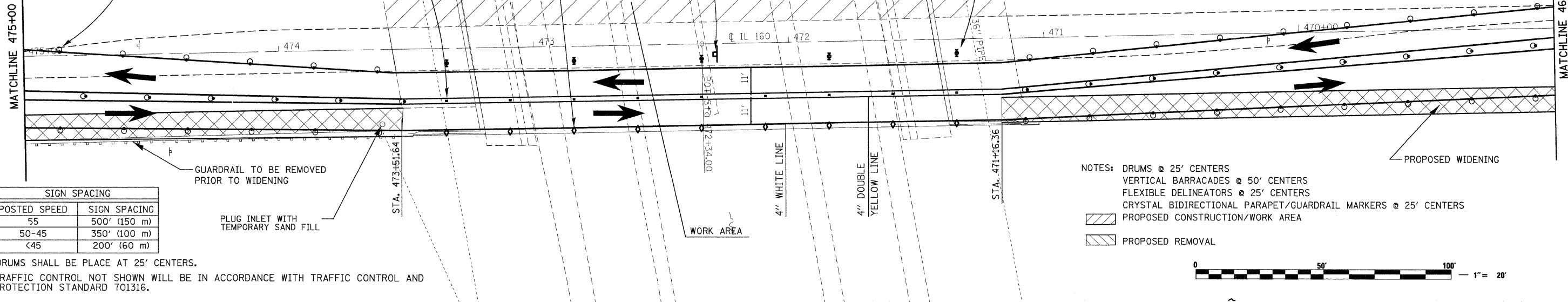
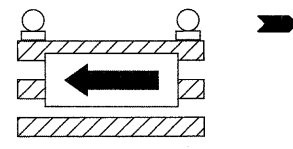
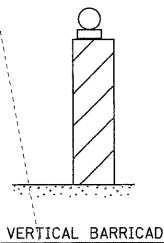
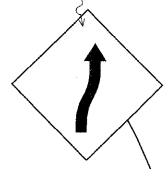
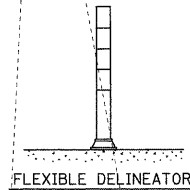
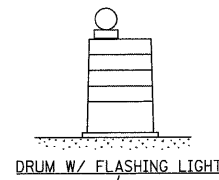
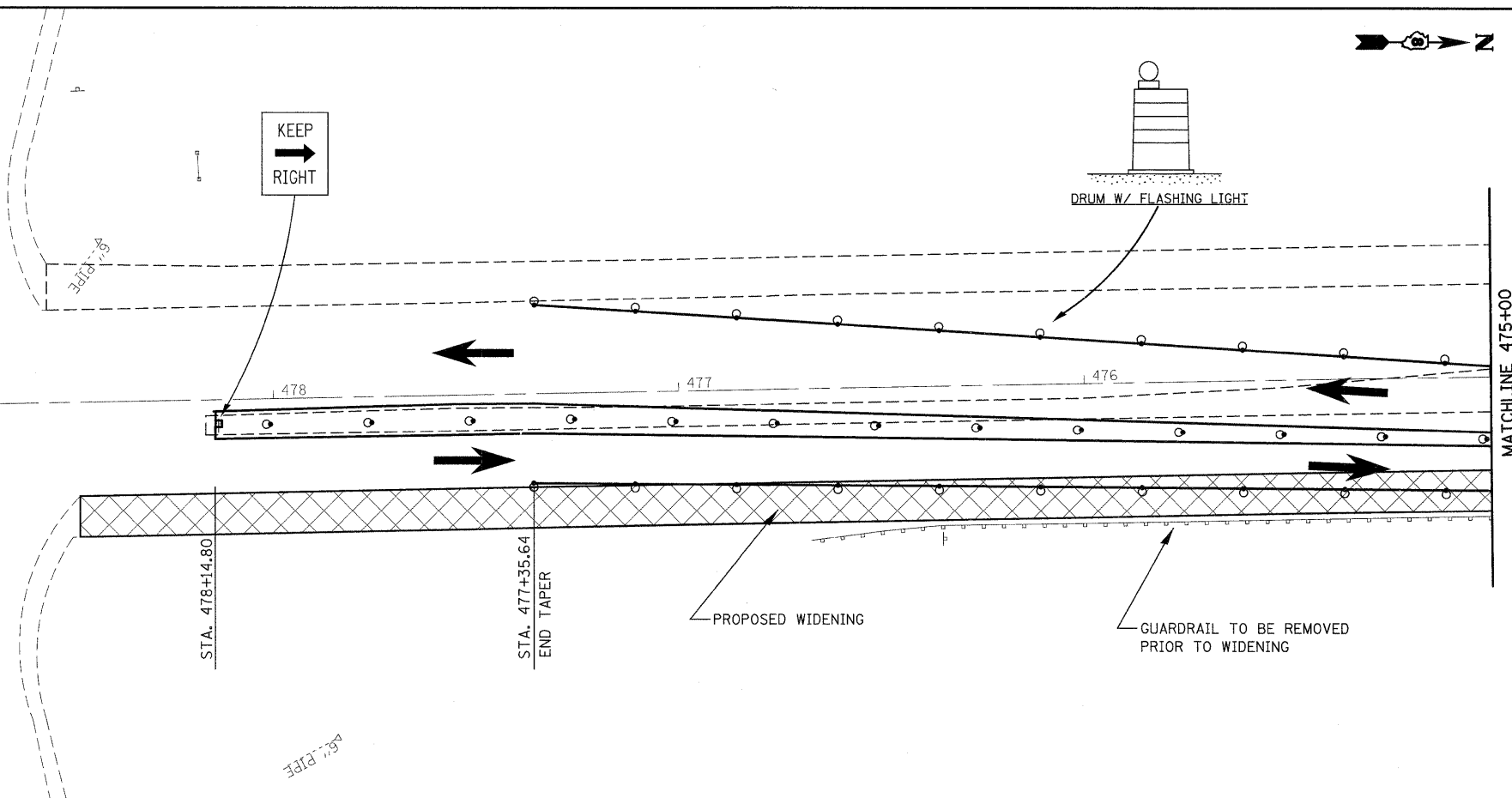

SIGN SPACING	
POSTED SPEED	SIGN SPACING
55	500' (150 m)
50-45	350' (100 m)
<45	200' (60 m)

PLUG INLET WITH TEMPORARY SAND FILL

- NOTES:
- DRUMS @ 25' CENTERS
  - VERTICAL BARRICADES @ 50' CENTERS
  - FLEXIBLE DELINEATORS @ 25' CENTERS
  - CRYSTAL BIDIRECTIONAL PARAPET/GUARDRAIL MARKERS @ 25' CENTERS
  - PROPOSED CONSTRUCTION/WORK AREA
  - PROPOSED REMOVAL

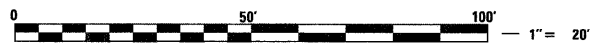

FILE NAME =	USER NAME = mannta	DESIGNED -	REVISED -	<b>STATE OF ILLINOIS DEPARTMENT OF TRANSPORTATION</b>	<b>SUGGESTED STAGES OF CONSTRUCTION &amp; TRAFFIC CONTROL STAGE II - LOCATION 1</b>	F.A.P. RTE.	SECTION	COUNTY	TOTAL SHEETS	SHEET NO.	
ct:\p\work\p\dot\mannta\dms32470\p1n1207.dgn	PLOT SCALE = 20.0000' / IN.	CHECKED -	REVISED -			327	14-12BR-1	CLINTON	72	14	
PLOT DATE = 12/8/2009	DATE -	REVISED -	REVISED -			CONTRACT NO. 76B27					
						ILLINOIS FED. AID PROJECT					