

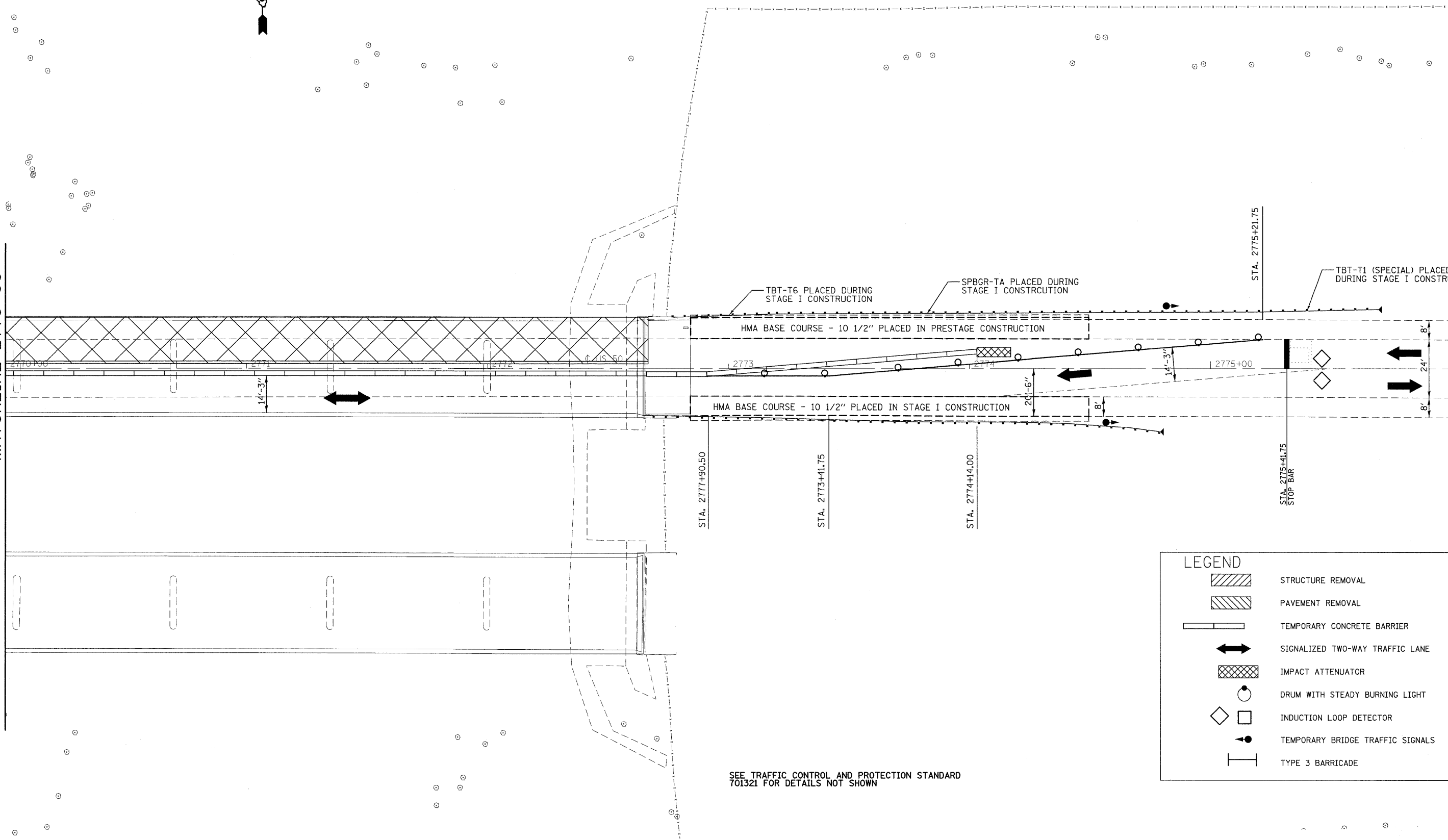

MATCHLINE 2770+00

MATCHLINE 2776+00



SEE TRAFFIC CONTROL AND PROTECTION STANDARD 701321 FOR DETAILS NOT SHOWN

LEGEND

- STRUCTURE REMOVAL
- PAVEMENT REMOVAL
- TEMPORARY CONCRETE BARRIER
- SIGNALIZED TWO-WAY TRAFFIC LANE
- IMPACT ATTENUATOR
- DRUM WITH STEADY BURNING LIGHT
- INDUCTION LOOP DETECTOR
- TEMPORARY BRIDGE TRAFFIC SIGNALS
- TYPE 3 BARRICADE

FILE NAME =	USER NAME = manntm	DESIGNED -	REVISED -
cr:\pwork\pwwdot\manntm\dms52470\p1118207b.dgn		DRAWN -	REVISED -
PLOT SCALE = 20.0000' / IN.		CHECKED -	REVISED -
PLOT DATE = 12/8/2009		DATE -	REVISED -

**STATE OF ILLINOIS
DEPARTMENT OF TRANSPORTATION**

STAGE II CONSTRUCTION - LOCATION 2

SCALE: 1" = 20' SHEET NO. 7 OF 7 SHEETS STA. 2770+00 TO STA. 2776+00

F.A.P. RTE.	SECTION	COUNTY	TOTAL SHEETS	SHEET NO.
327	14-12BR-1	CLINTON	72	44
CONTRACT NO. 76B27				
FED. ROAD DIST. NO. 8 ILLINOIS FED. AID PROJECT				