

F.A. RTE.	SECTION	COUNTY	TOTAL SHEETS	SHEET NO.
358	86-00075-01-AS	WOODFORD	66	17
STA. _____ TO STA. _____		FED. ROAD DIST. NO. _____ ILLINOIS FED. AID PROJECT		

County Highway #1  
 POT STA 22+00.00  
 N 1505060.2005  
 E 2543827.9481

EDITH M  
 HARTZLER

STA. 21+50.00, 32.0' LT  
 PIPE CULVERT, CLASS D, TYPE 1,  
 EQUIVALENT ROUND-SIZE 24"  
 44' @ 1.60%  
 U/S H = 751.52 (+71.00)  
 D/S H = 750.81 (+27.00)

PLAN	DATE	BY
REVISIONS		
NO.	DESCRIPTION	DATE

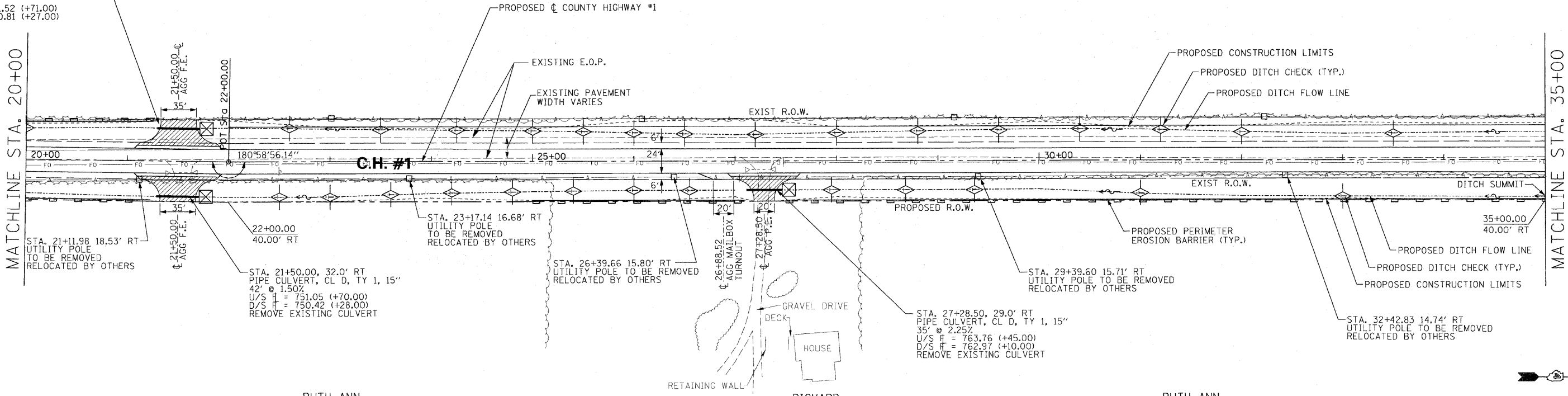

RUTH ANN  
 SCHERTZ

RICHARD  
 LIVINGSTON  
 ET UX

RUTH ANN  
 SCHERTZ

H. SCALE: 1" = 50'  
 V. SCALE: 1" = 5'

PROFILE	DATE	BY
REVISIONS		
NO.	DESCRIPTION	DATE

