

**FRAMING PLAN**

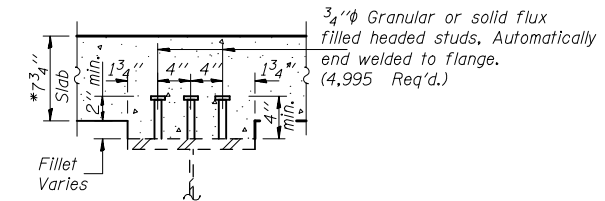

**SECTION A-A**

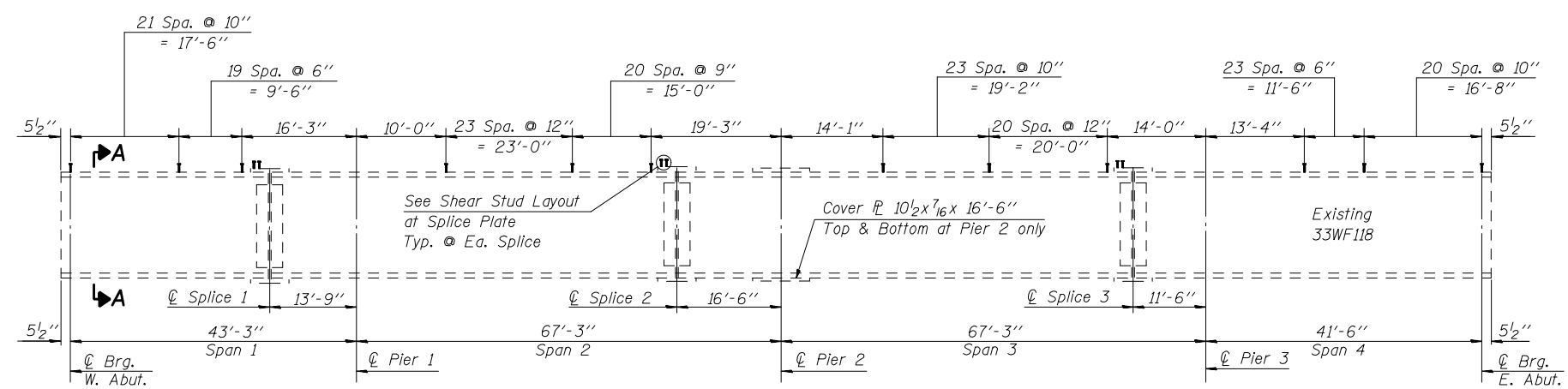

**BEAM ELEVATION**

(Looking North - Showing Shear Connectors to be Added)

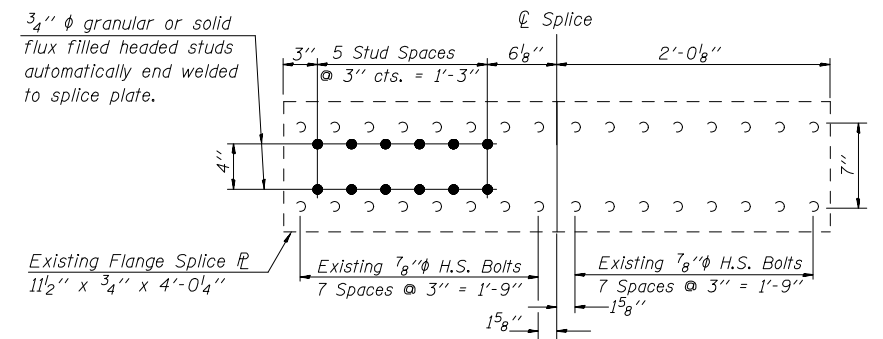

**SHEAR STUD LAYOUT AT SPLICE PLATE**

Showing location of new 3/4" granular or solid flux filled headed studs automatically end welded to splice plate. Locate studs as shown at splices 1, 2 & 3.

**TOP OF EXISTING BEAM ELEVATIONS**

(For Information Only)

Location	Beam 1	Beam 2	Beam 3	Beam 4	Beam 5	Beam 6	Beam 7	Beam 8	Beam 9
⊕ Brg. W. Abut.	695.35	695.42	695.49	695.56	695.62	695.56	695.49	695.42	695.35
⊕ Pier 1	695.33	695.40	695.47	695.54	695.60	695.54	695.47	695.40	695.33
⊕ Pier 2	695.15	695.22	695.28	695.36	695.42	695.36	695.28	695.22	695.15
⊕ Pier 3	694.79	694.86	694.93	695.00	695.06	695.00	694.93	694.86	694.79
⊕ Brg. E. Abut.	694.48	694.55	694.62	694.69	694.75	694.69	694.62	694.55	694.48

Note: Elevations have been taken from the existing plans and reduced by 0.47' to match the new bench mark datum. Elevations at Pier 2 are to top of beam (not to top of cover plate).

DESIGNED Ruben V. Boehler  
 CHECKED Tim S. Howard  
 DRAWN Nicole L. Darling  
 CHECKED Michael D. Cummins

Work this sheet with sheet 14 of 22.

**STRUCTURAL STEEL**

IL ROUTE 133 OVER I-57  
 F.A.I. ROUTE 57 SECTION (15,21-25HB-2)BR  
 DOUGLAS COUNTY  
 STA. 1492+76.53  
 S.N. 021-0024

CUMMINS ENGINEERING CORPORATION

JOB #: 2114
FILE: 2114SS
DATE: 10/24/06