

ROUTE NO.	SECTION	COUNTY	TOTAL SHEETS	SHEET NO.
F.A.I. 57	(15,21-25HB-2)BR	DOUGLAS	65	54
FED. ROAD DIST. NO. 5	ILLINOIS PROJECT			

Sheet 18 of 22 CONTRACT #90952

MIN. BAR LAP
#5 bar = 2'-2"

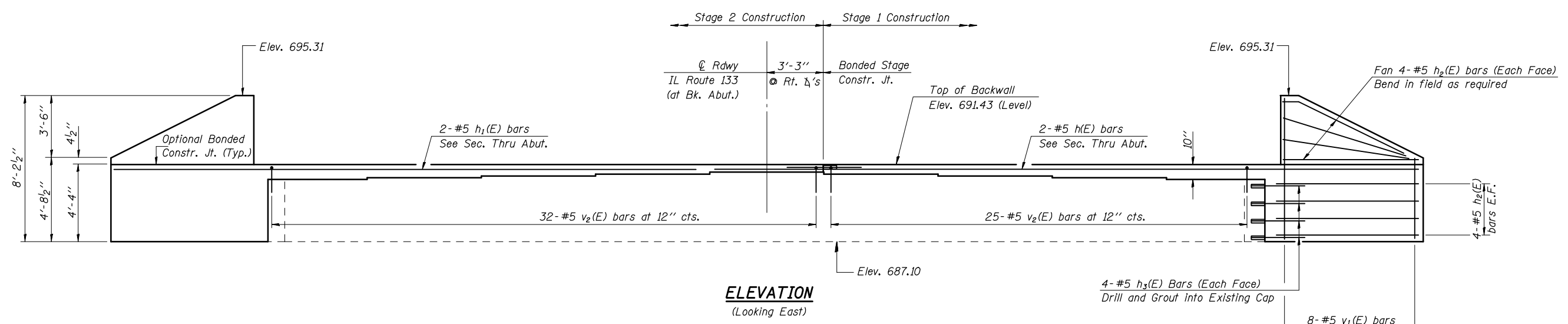

ELEVATION
(Looking East)

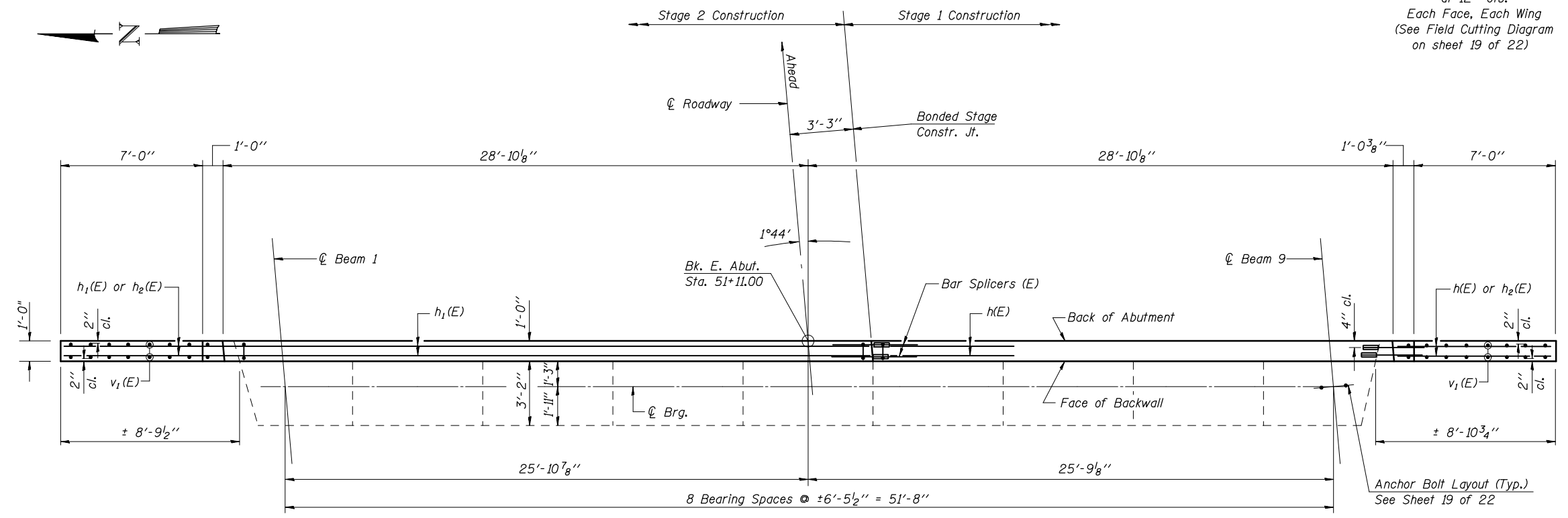

TOP VIEW

NOTE
Plan elevations relative to the existing structure have been taken from existing plans and reduced by 0.47 feet to match benchmark datum.

DESIGNED	Ruben V. Boehler
CHECKED	Tim S. Howard
DRAWN	Nicole L. Darling
CHECKED	Michael D. Cummins

Notes: Space drilled holes in existing cap to miss existing reinforcement. Epoxy grout h₃(E) and v₂(E) bars in accordance with Section 584 of the Standard Specifications. Minimum embedment = 9". See sheet 20 of 22 for bar splicer details. See sheet 19 of 22 for abutment details and Bill of Material.

EAST ABUTMENT

IL ROUTE 133 OVER I-57
F.A.I. ROUTE 57 SECTION (15,21-25HB-2)BR
DOUGLAS COUNTY
STA. 1492+76.53
S.N. 021-0024

CUMMINS ENGINEERING CORPORATION	JOB #: 2114
	FILE: 2114ABUTS
	DATE: 10/24/06