

LAYOUT LEGEND

EXISTING	PROPOSED	DESCRIPTION
▶	▶	SIGNAL HEAD
▶	▶	SIGNAL HEAD WITH BACKPLATE
◻	◻	PEDESTRIAN SIGNAL HEAD
⊙	⊙	PEDESTRIAN PUSHBUTTON
○	●	SIGNAL POST
⊞	⊞	QUADRAPOLE LOOP
○	●	STEEL MAST ARM ASSEMBLY AND POLE
⊞	⊞	CONTROLLER
◻	◻	HANDHOLE
○	●	SERVICE POLE
⊞	⊞	DOUBLE HANDHOLE
⊞	⊞	GULFBOX JUNCTION
⊞	⊞	CONDUIT 45 LF (T=TRENCH, A=AUGERED, E=EXISTING) 3 (S=STEEL, P=PVC, F=FIBER)
⌒	⌒	LUMINAIRE
■	■	8mm CAMERA

NOTES

- EXACT LOCATION OF CONTROLLER, HAND HOLES, AND CAMERAS TO BE DETERMINED BY STATE OF ILLINOIS HIGHWAY ENGINEER.

GRAPHIC SCALE: 1" = 20'

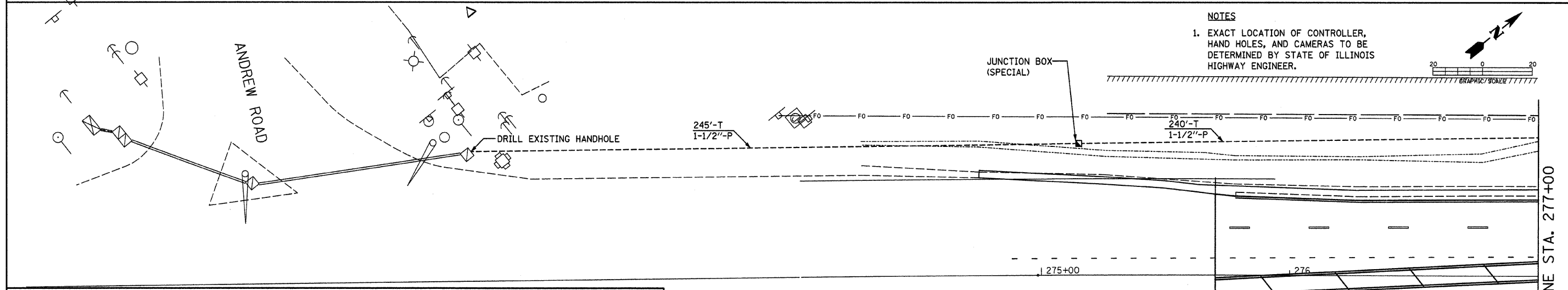

SIGN PANEL DETAILS

SIGN PANEL, TYPE 2 DIMENSIONS/SCHEDULE

QUANTITY EACH	FORMAT	LETTER SIZE		LOCATION	SIGN SIZE			SIGN PANEL	
		UC	LC		WIDTH	HEIGHT	SQ. FT.	STYLE (d)	STYLE (f)
2	Village Center Dr.	8D	6D	NE & SW QUAD	78"	40"	21.7		43.4
1	Business 55	8D	6D	SE QUAD	94"	24"	15.7		15.7
								TOTAL	59.1 SQ. FT.

*STYLE (d) & (f) SIGN PANELS PER T20016-02

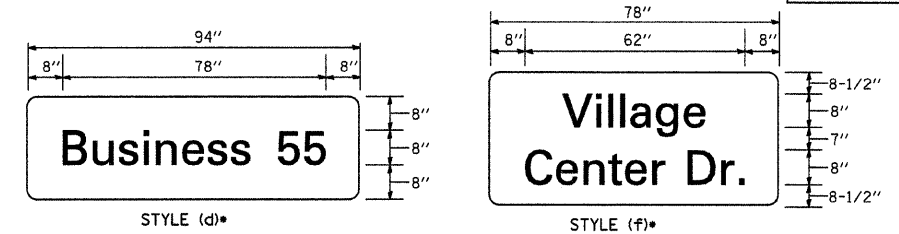

FILE NAME =	USER NAME = #USER#	DESIGNED - M.T.V.	REVISED -	STATE OF ILLINOIS DEPARTMENT OF TRANSPORTATION	SIGNAL PLAN			F.A.P. RTE. =	SECTION	COUNTY	TOTAL SHEETS	SHEET NO.
#FILEL#		DRAWN - K.M.S.	REVISED -		INTERSECTION CONSTRUCTION (BL-55 & VILLAGE CTR DR), SHERMAN, IL			666	09-00015-00 PV	SANGAMON	25	13
		CHECKED - T.T.P.	REVISED -		SCALE: 1"=20'			SHEET NO. 13 OF 25 SHEETS		CONTRACT NO. 090513		
		DATE - 11/20/09	REVISED -		STA. TO STA.			ILLINOIS FED. AID PROJECT				