

**STAGE 1**

1. INSTALL TRAFFIC PROTECTION DEVICES.
2. PERFORM ALL EARTHWORK OPERATIONS FOR VILLAGE CENTER DRIVE AND RIGHT TURN LANE ON S.B. B.L. 55.
3. INSTALL STORM SEWER ON VILLAGE CENTER DRIVE.
4. REMOVE HEADWALLS LOCATED ALONG B.L. 55.
5. MILL OUTSIDE LANES OF B.L. 55.
6. REMOVE EXISTING PAVED SHOULDER ALONG OUTSIDE EDGES OF S.B. AND N.B. LANES OF B.L. 55 AND EXCAVATE FOR HOT-MIX ASPHALT SHOULDER PLACEMENT ALONG OUTSIDE EDGES OF S.B. AND N.B. LANES OF B.L. 55.
7. PLACE ALL SUB-BASE GRANULAR MATERIALS FOR VILLAGE CENTER DRIVE AND RIGHT TURN LANE ON S.B. B.L. 55.
8. CONSTRUCT CURB AND GUTTER AND MEDIAN PAVEMENT FOR VILLAGE CENTER DRIVE.
9. PLACE HOT-MIX ASPHALT BASE COURSES FOR VILLAGE CENTER DRIVE AND RIGHT TURN LANE ON S.B. B.L. 55.
10. PLACE HOT-MIX ASPHALT SHOULDERS TO WITHIN 2" OF FINISHED GRADE ELEVATION OF S.B. AND N.B. B.L. 55.
11. BACKFILL AND GRADE EARTH BEHIND NEW CURB AND GUTTER AND NEW HOT-MIX ASPHALT SHOULDER.
12. INSTALL SIGNAL FOUNDATIONS AND CONDUITS.

**LEGEND**

- ↑ ARROW BOARD
- ↓ SIGN
- ↑ DIRECTION INDICATOR BARRICADE WITH STEADY BURN MONODIRECTIONAL LIGHT
- I TYPE II BARRICADE, DRUM, OR VERTICAL BARRICADE
- ↓ TYPE II BARRICADE, DRUM OR VERTICAL BARRICADE WITH STEADY BURN MONODIRECTIONAL LIGHT
- ⊥ TYPE III BARRICADE WITH ROAD CLOSED SIGN
- ▨ CONSTRUCTION AREA

G20-1103(O)-3660

END WORK ZONE SPEED LIMIT

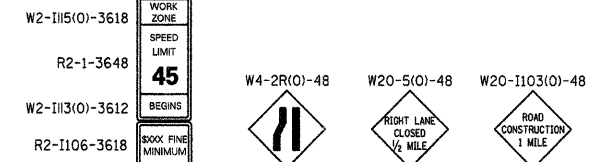
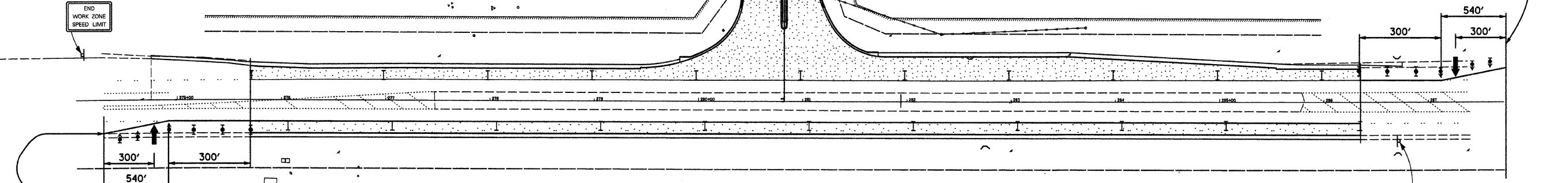

**STAGE 2**

1. RELOCATE TRAFFIC CONTROL DEVICES.
2. EXCAVATE EXISTING EARTH MEDIAN ON B.L. 55.
3. MILL INSIDE LANES OF B.L. 55.
4. REMOVE EXISTING MEDIAN CURB AND GUTTER ON B.L. 55.
5. PLACE ALL SUB-BASE GRANULAR MATERIALS WITHIN EXISTING PAVEMENT LIMITS FOR LEFT TURN LANE ON N.B. B.L. 55.
6. CONSTRUCT CURB AND GUTTER AND MEDIAN PAVEMENT FOR RAISED MEDIAN FOR B.L. 55.
7. PLACE HOT-MIX ASPHALT BASE COURSES FOR LEFT TURN LANE ON N.B. B.L. 55.
8. PLACE EARTH BACKFILL WITHIN LIMITS OF RAISED MEDIAN ON B.L. 55.

VILLAGE CENTER DRIVE WILL REMAIN CLOSED THROUGH STAGE 4 CONSTRUCTION

UTILIZE STANDARD BLR-21 TO CLOSE VILLAGE CENTER DRIVE

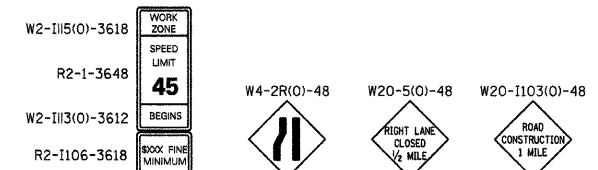
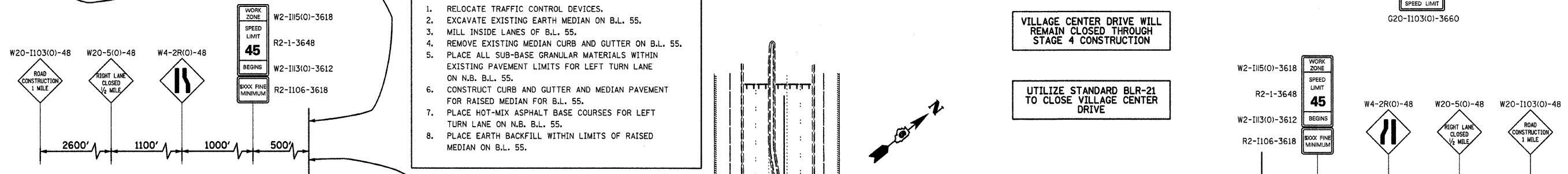

G20-1103(O)-3660

END WORK ZONE SPEED LIMIT

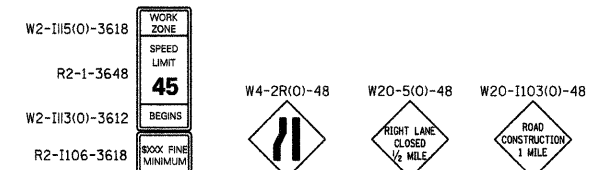
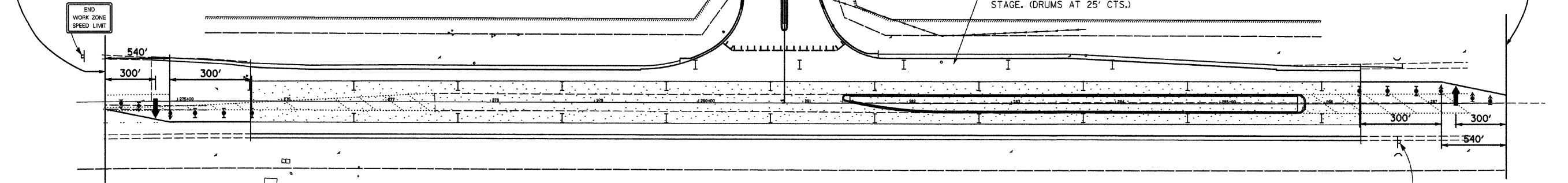

G20-1103(O)-3660

END WORK ZONE SPEED LIMIT

|             |                      |                   |           |   |  |                           |                 |                        |                 |                    |              |  |
|-------------|----------------------|-------------------|-----------|---|--|---------------------------|-----------------|------------------------|-----------------|--------------------|--------------|--|
| FILE NAME = | USER NAME = #USER#   | DESIGNED - T.T.P. | REVISED - | <b>STATE OF ILLINOIS<br/>DEPARTMENT OF TRANSPORTATION</b> | <b>MAINTENANCE OF TRAFFIC PLAN SHEET 1<br/>INTERSECTION CONSTRUCTION (BL-55 &amp; VILLAGE CTR DR), SHERMAN, IL</b> |                           | F.A.P. RTE. 666 | SECTION 09-00015-00-PV | COUNTY SANGAMON | TOTAL SHEETS 25    | SHEET NO. 15 |  |
| #FILE#      | PLOT SCALE = #SCALE# | DRAWN - J.T.F.    | REVISED - |   | SCALE: 1"=50'  | SHEET NO. 15 OF 25 SHEETS | STA.            | TO STA.                |                 | CONTRACT NO. 93519 |              |  |
|             | PLOT DATE = #DATE#   | CHECKED - T.T.P.  | REVISED - |   | ILLINOIS FED. AID PROJECT  |                           |                 |                        |                 |                    |              |  |
|             |                      | DATE - 11/20/09   | REVISED - |   |  |                           |                 |                        |                 |                    |              |  |