

BENCH MARK

RR Spike in Power Pole Sta. 132+75, 37' Lt. Elev. 452.31
 RR Spike in Power Pole Sta. 133+69, 33' Rt. Elev. 452.60

EXISTING STRUCTURE

Single span precast prestressed concrete deck beam structure on closed concrete abutments with metal shell piles. 54'-0" Bk. to Bk. and 33'-0" Out to Out., 0° Skew.

The existing superstructure is to be replaced with PPC Deck Beams and a HMA wearing surface.

Road to be closed during construction.

No Salvage

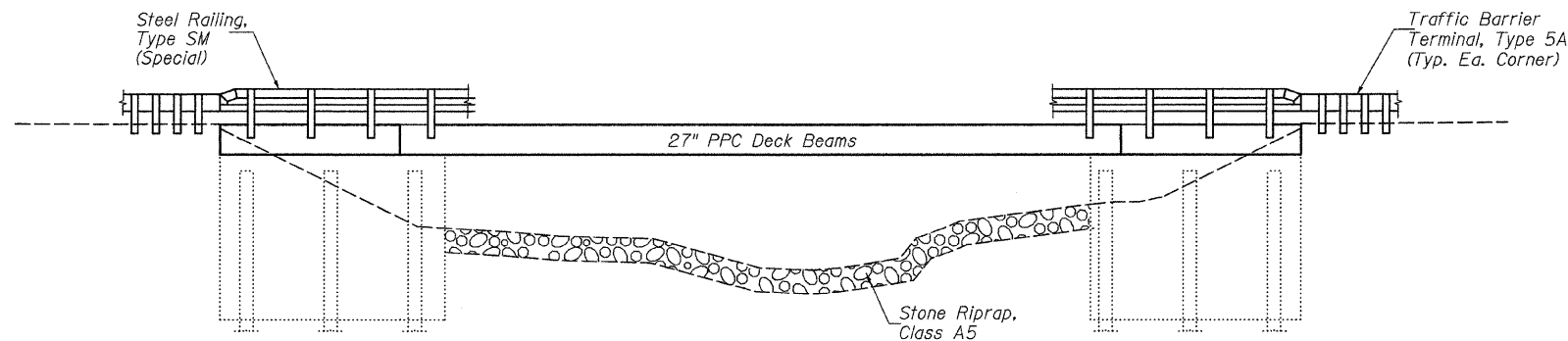

ELEVATION

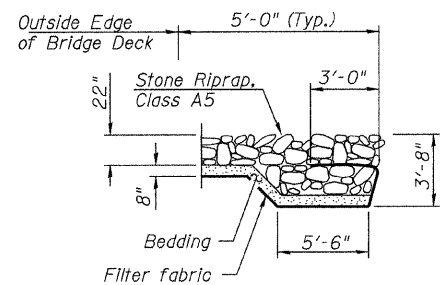

SECTION A-A

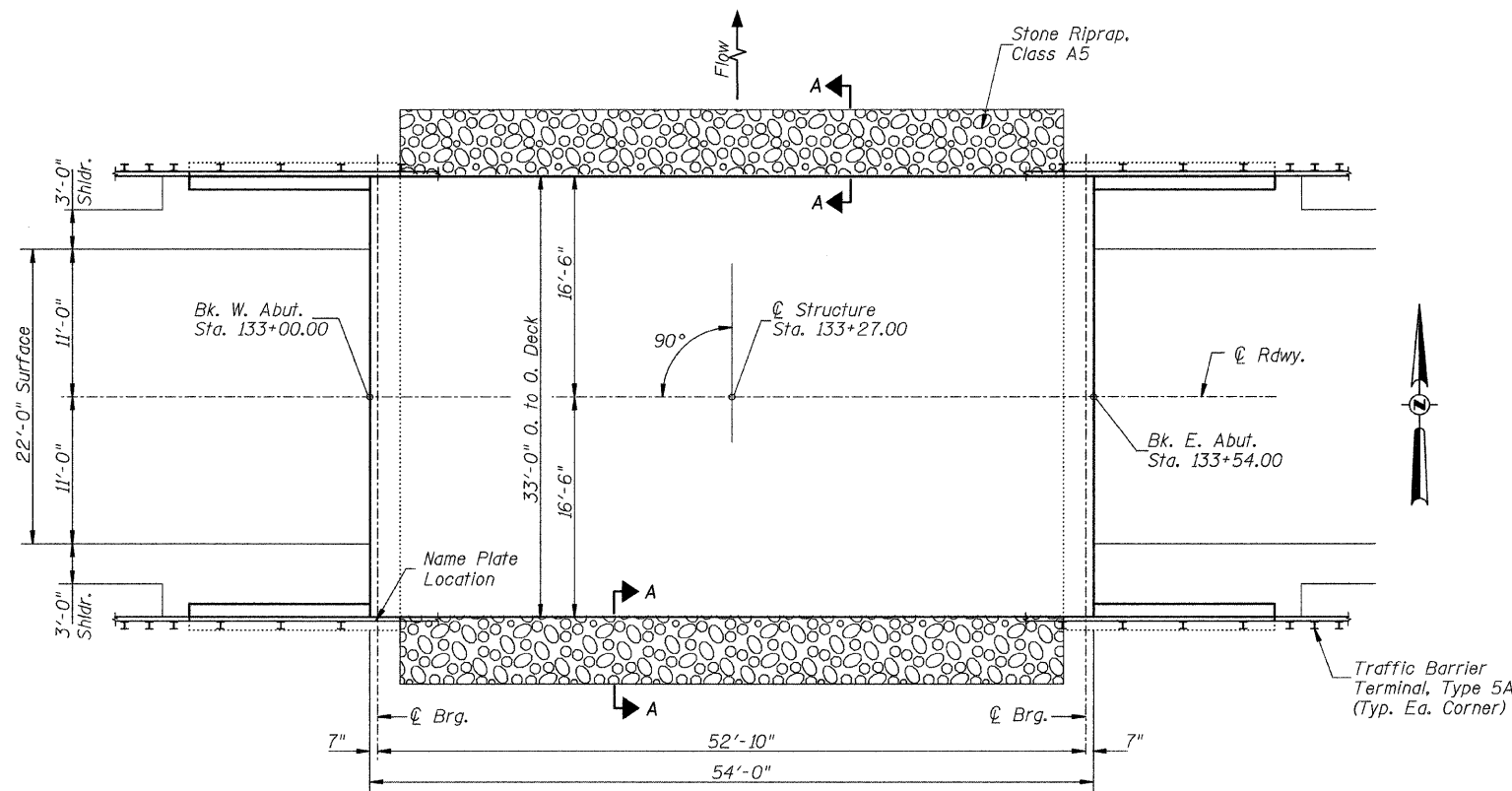

PLAN

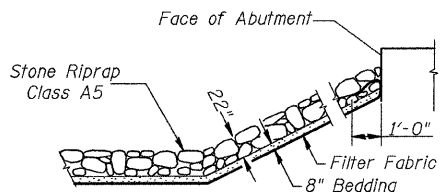

STONE RIPRAP DETAIL

Top of Riprap Shall Match Existing Groundline

**WOLF RUN CREEK
 REBUILT 20__ BY
 SCOTT COUNTY
 SEC. 09-00006-02-BR
 C.H. 3 STATION 133+27.00
 F.A. PROJ. ARA-0605(107)
 STR. NO. 086-3000 LOADING HL-93**

NAME PLATE

Attach new name plate to back side of 8" rail element at West end of South rail. Clean and re-locate existing name plate adjacent to new name plate. Cost included in the cost of Name Plates. See Std. 515001

DESIGN SPECIFICATIONS

2007 AASHTO (LRFD) & Interims

DESIGN STRESSES

(FIELD UNITS) (PRECAST PRESTRESSED UNITS)
 $f'_c = 3,500$ p.s.i. $f'_c = 6,000$ p.s.i.
 $f'_{ci} = 5,000$ p.s.i. $f'_{ci} = 5,000$ p.s.i.
 $f_y = 60,000$ p.s.i. (Rein.) $f'_s = 270,000$ p.s.i. ($\frac{1}{2}$ " Strands)
 $f'_{si} = 201,960$ p.s.i. ($\frac{1}{2}$ " Strands)

LOADING HL-93

Allow 50#/sq. ft. for future wearing surface.

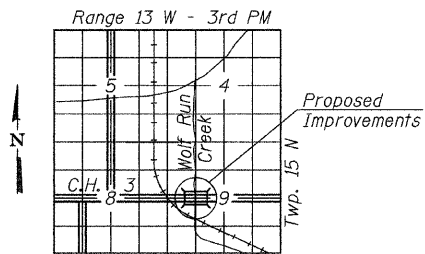

LOCATION SKETCH

GENERAL NOTES

Reinforcement bars shall conform to the requirements of ASTM A706 Grade 60. Reinforcement bars designated (E) shall be epoxy coated.
 The top surface of the beams shall be finished according to the IDOT Manual for Precast Prestressed Concrete Products.
 A Corrosion Inhibitor shall be used in the concrete for Precast Prestressed Concrete Deck Beams according to Article 1020.05(b)(12) of the Standard Specifications.
 Layout of the slope protection system may be varied in the field to suit ground conditions as directed by the Engineer.
 Backfill shall not be placed behind the new abutments until the superstructure has been set and doweled.
 Excavation behind existing abutment walls shall be performed to balance front and back soil pressure before removing the existing superstructure.
 Plan dimensions and details relative to existing plans are subject to nominal construction variations. The Contractor shall field verify existing dimensions and details affecting new construction and make necessary approved adjustments prior to construction or ordering of materials. Such variations shall not be cause for additional compensation for a change in scope of the work, however, the Contractor will be paid for the quantity actually furnished at the unit price bid for the work.

TOTAL BILL OF MATERIAL

ITEM	UNIT	SUPER	SUB	TOTAL
① Removal of Existing Superstructures	EACH	1	—	1
Stone Riprap, Class A5	TON	—	295	295
① Filter Fabric	SQ YD	—	245	245
Concrete Removal	CU YD	—	4.5	4.5
Concrete Structures	CU YD	—	4.5	4.5
① Precast Prestressed Concrete Deck Beams (27" Depth)	SQ FT	1,782	—	1,782
① Reinforcement Bars	POUND	—	370	370
① Steel Bridge Rail, Type SM (Special)	FOOT	162	—	162
Hot-Mix Asphalt Surface Course, Mix "C", N50	TON	20	—	20
Waterproofing Membrane System	SQ YD	198	—	198
Portland Cement Mortar Fairing Course	FOOT	135	—	135
Name Plates	EACH	1	—	1

① See Special Provisions

I certify that to the best of my knowledge, information and belief, this bridge design is structurally adequate for the design loading shown on the plans. The design is an economical one for the style of structure and complies with requirements of the current AASHTO LRFD Bridge Design Specifications.

[Signature] 11/25/2009
 Illinois Structural No. 6440
 Expires 11/30/2010

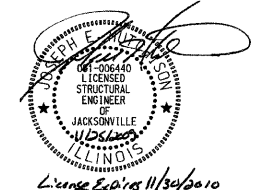

GENERAL PLAN AND ELEVATION

SCOTT COUNTY

SECTION 09-00006-02-BR

C.H. 3 OVER WOLF RUN CREEK

STA. 133+27.00

STRUCTURE NO. 086-3000

DESIGNED	B.A.N.
CHECKED	J.E.H.
DRAWN	T.A.C.
CHECKED	B.A.N./J.E.H.

SHEET NO. 1 6 SHEETS	RTE.	SECTION	COUNTY	TOTAL SHEETS	SHEET NO.
	C.H. 3	09-00006-02-BR	SCOTT	10	5
	SN 086-3000		CONTRACT NO. 93519		
FED. ROAD DIST. NO. 7 ILLINOIS			FED. AID PROJECT ARA-0605(107)		