

| PAVEMENT POINTS |           |           |        |           |            |
|-----------------|-----------|-----------|--------|-----------|------------|
| POINT           | NORTHING  | EASTING   | ELEV.  | STATION   | OFFSET     |
| 1               | 24,976.71 | 38,430.68 | 595.02 | 498+23.44 | 12.00' LT  |
| 2               | 24,959.62 | 38,486.29 | 594.47 | 498+80.41 | 16.98' LT  |
| 3               | 24,946.98 | 38,563.46 | 594.45 | 499+56.19 | 36.25' LT  |
| 4               | 24,954.63 | 38,604.90 | 595.05 | 499+91.13 | 59.83' LT  |
| 5               | 24,980.82 | 38,635.71 | 595.85 | 500+08.89 | 96.15' LT  |
| 6               | 24,901.73 | 38,576.53 | 595.30 | 499+86.27 | 0.00       |
| 7               | 24,916.24 | 38,543.28 | 594.68 | 499+50.00 | 0.00       |
| 8               | 24,949.49 | 38,467.07 | 594.76 | 498+66.85 | 0.00       |
| 9               | 24,965.39 | 38,426.69 | 594.78 | 498+23.44 | 0.00       |
| 10              | 24,954.08 | 38,422.70 | 594.54 | 498+23.44 | 12.00' RT  |
| 11              | 24,935.55 | 38,469.01 | 594.51 | 498+74.20 | 12.00' RT  |
| 12              | 24,833.81 | 38,507.20 | 594.39 | 499+49.88 | 89.98' RT  |
| 13              | 24,785.50 | 38,477.71 | 594.29 | 499+42.17 | 146.05' RT |
| 14              | 24,950.26 | 38,534.63 | 594.24 | 499+28.46 | 27.72' LT  |
| 15              | 24,894.25 | 38,511.04 | 593.64 | 499+29.24 | 33.05' RT  |
| 16              | 24,896.24 | 38,589.11 | 595.90 | 500+00.00 | 0.00       |

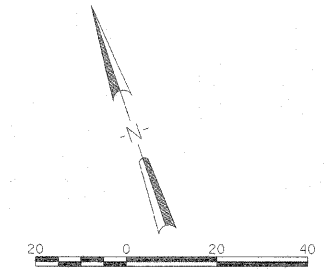

AGGREGATE SHOULDERS, BY CUMBERLAND COUNTY  
 C F.A.S. 662  
 AGGREGATE SHOULDERS, BY CUMBERLAND COUNTY

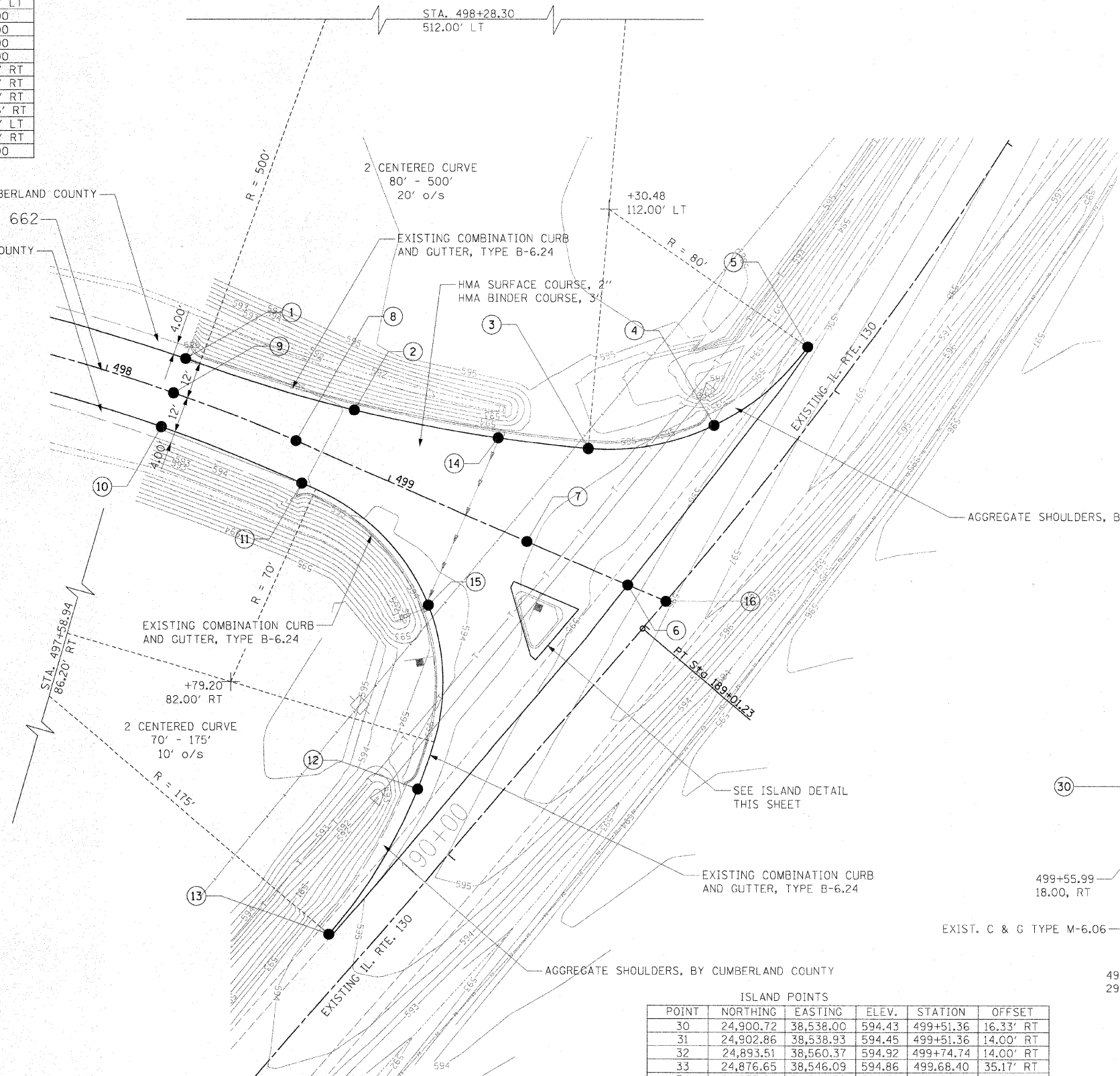

PI STA. = 497+43.15  
 $\Delta = 23^\circ 58' 50''$  (RT)  
 $D = 9^\circ 32' 57''$   
 $R = 600.00'$   
 $T = 127.43'$   
 $L = 251.12'$   
 $E = 13.38'$   
 P.C. STA = 496+15.72  
 P.T. STA = 498+66.85

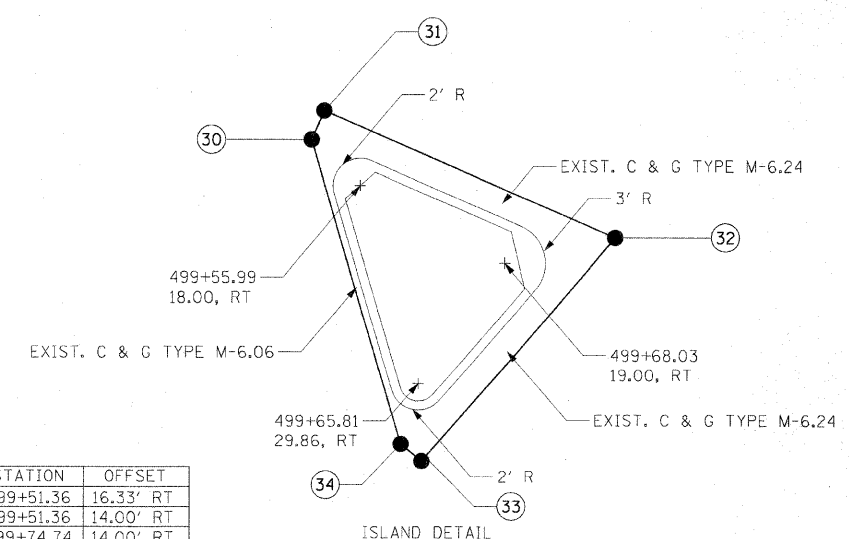

| ISLAND POINTS |           |           |        |           |           |
|---------------|-----------|-----------|--------|-----------|-----------|
| POINT         | NORTHING  | EASTING   | ELEV.  | STATION   | OFFSET    |
| 30            | 24,900.72 | 38,538.00 | 594.43 | 499+51.36 | 16.33' RT |
| 31            | 24,902.86 | 38,538.93 | 594.45 | 499+51.36 | 14.00' RT |
| 32            | 24,893.51 | 38,560.37 | 594.92 | 499+74.74 | 14.00' RT |
| 33            | 24,876.65 | 38,546.09 | 594.86 | 499+68.40 | 35.17' RT |
| 34            | 24,877.94 | 38,544.56 | 594.76 | 499+66.48 | 34.59' RT |

© Copyright Hanson Professional Services Inc. 2009  
**HANSON**  
 Hanson Professional Services Inc.

|          |         |          |
|----------|---------|----------|
| LAYOUT   | MNM/DJP | 10/10/07 |
| DRAWN    | DJP     | 10/10/07 |
| REVIEWED | MNM     | 02/04/08 |

|   |                      |                    |           |
|---|----------------------|--------------------|-----------|
| FILE NAME =                                   | USER NAME = Pop00836 | DESIGNED - MNM/DJP | REVISED - |
| I:\01jobs\01s20218\CADD\Road\Sheet\VC-502.dwg |                      | DRAWN - DJP        | REVISED - |
| PLOT SCALE = 28.0000' / 1"                    |                      | CHECKED - MNM      | REVISED - |
| PLOT DATE = 12/23/2009                        |                      | DATE - 10/22/09    | REVISED - |

**STATE OF ILLINOIS  
 DEPARTMENT OF TRANSPORTATION**

**INTERSECTION DETAIL**  
 SCALE: SHEET NO. 1 OF 1 SHEETS STA. TO STA.

|   |                |            |              |           |
|---|----------------|------------|--------------|-----------|
| F.A.S. RTE.                                   | SECTION        | COUNTY     | TOTAL SHEETS | SHEET NO. |
| 662   | 09-00061-01-RS | CUMBERLAND | 14           | 10        |
| CONTRACT NO. 95614                            |                |            |              |           |
| FED. ROAD DIST. NO. ILLINOIS FED. AID PROJECT |                |            |              |           |