

DRAWING FILE: 00092-02-PV XSEC 0-3450.dwg

PLOT DATE:

SECTION NO.	COUNTY HIGHWAY	COUNTY	SHEET OF SHEETS
06-00092-02-PV	22	ST. CLAIR	51 OF 63
FHWA REG. NO. 7	ILLINOIS		ARA-5011 (297)
FEDERAL AID PROJECT	CONTRACT # 97415		

CROSS SECTIONS

E.T.C.E.

SPECIAL DITCH STA. 13+39 - STA. 14+00
APPROX GRADE +0.98%

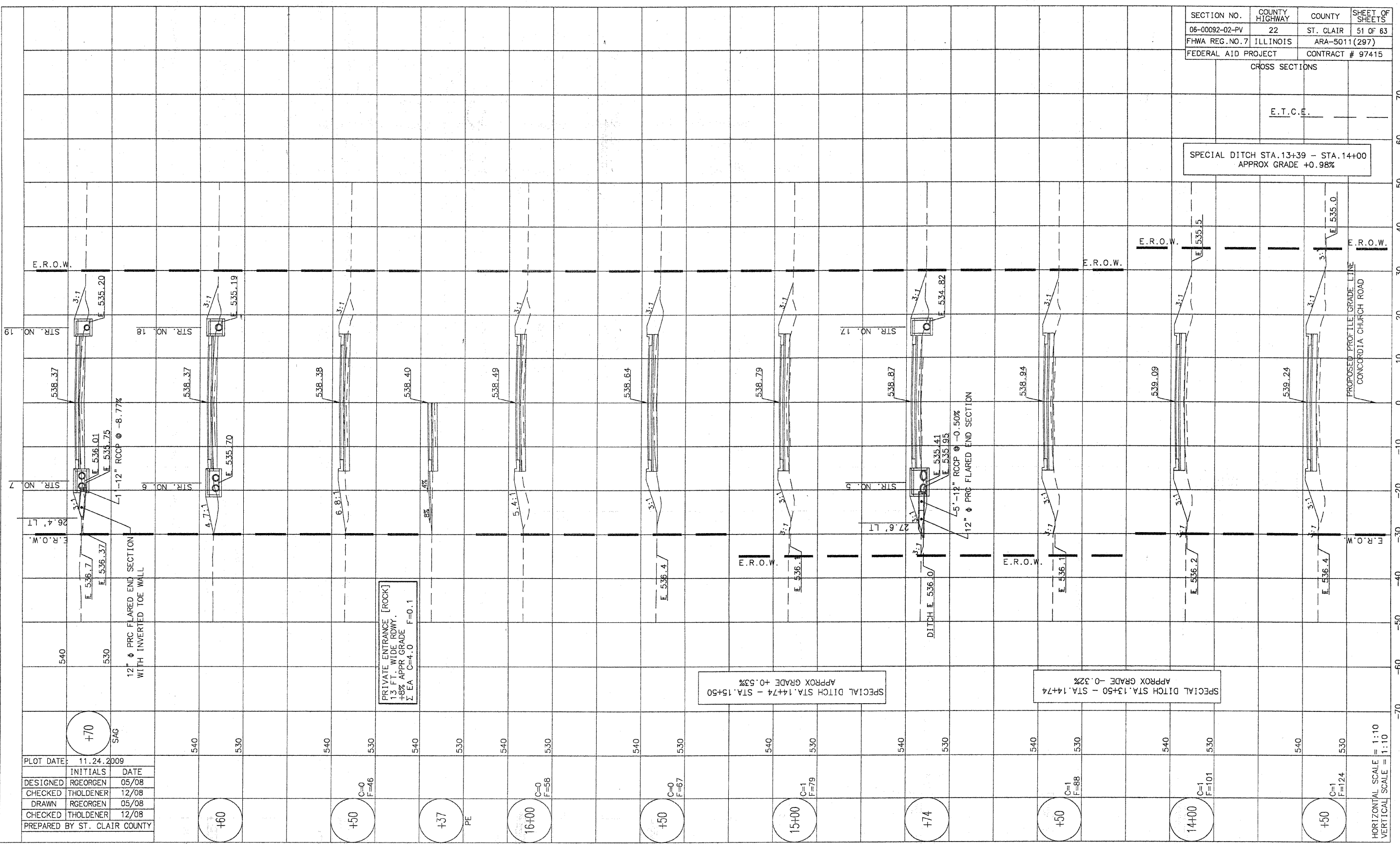

PLOT DATE:	11.24.2009
INITIALS	DATE
DESIGNED RGEORGEN	05/08
CHECKED THOLDENER	12/08
DRAWN RGEORGEN	05/08
CHECKED THOLDENER	12/08
PREPARED BY	ST. CLAIR COUNTY

+70
SAG

+60

+50
C=0
F=46

+37
PE

16+00
C=0
F=58

+50
C=0
F=67

15+00
C=1
F=79

+74

+50
C=1
F=88

14+00
C=1
F=101

+50
C=1
F=124

HORIZONTAL SCALE = 1:10
VERTICAL SCALE = 1:10

12" PRC FLARED END SECTION
WITH INVERTED TOE WALL

PRIVATE ENTRANCE [ROCK]
13 FT. WIDE ROWY.
+8% APPR GRADE
Σ EA C=4.0 F=0.1

SPECIAL DITCH STA. 14+74 - STA. 15+50
APPROX GRADE +0.53%

SPECIAL DITCH STA. 13+50 - STA. 14+74
APPROX GRADE -0.32%

DITCH E. 536.0
E. 535.41
E. 535.95
5'-12" RCCP @ -0.50%
12" PRC FLARED END SECTION

PROPOSED PROFILE GRADE LINE
CONCORDIA CHURCH ROAD