

ROUTE	SECTION	COUNTY	TOTAL SHEETS	SHEET NO.
	05-00002-00-BT	SALINE	47	1
SVCD - EQUALITY TO GLEN O. JONES BIKE PATH				
PROJ. NO. ARA-TE-D009(84)			CONTRACT NO. 99292	

SALINE VALLEY CONSERVANCY DISTRICT
PLANS FOR
AMERICAN RECOVERY AND REINVESTMENT ACT OF 2009
EQUALITY TO GLEN O. JONES LAKE TRAIL
PROJECT NO. ARA-TE-0009(084)
SECTION 05-00002-00-BT
JOB NO. C-99-505-05

Board Members
 ROBERT C. WILSON
PRESIDENT
 BOB S. PRINCE
TREASURER
 BEN BALLARD
SECRETARY
 BRANDON MORSE
TRUSTEE
 JAMES W. WATSON
TRUSTEE
 LARRY PHELPS
MANAGER
 C. MART WATSON
ATTORNEY

INDEX OF SHEETS

- 1 COVER SHEET
- 2 LOCATION MAP
- 3 SUMMARY OF QUANTITIES
- 4 TYPICAL SECTIONS
- 5 MATERIAL SCHEDULES
- 6 TYPICAL DETAILS
- 7 PEDESTRIAN BRIDGE
GENERAL PLAN AND ELEVATION
- 8 PEDESTRIAN BRIDGE
ABUTMENT DETAILS
- 9-30 PLAN & PROFILE
- 31-41 CROSS SECTIONS
- 42-45 CULVERT CROSS SECTIONS
- 46-47 STORM WATER POLLUTION
PREVENTION PLAN

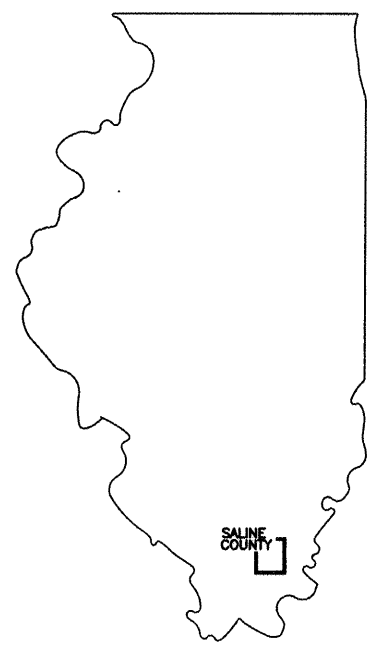

CONTRACT NO. 99292

PROPOSED IMPROVEMENTS

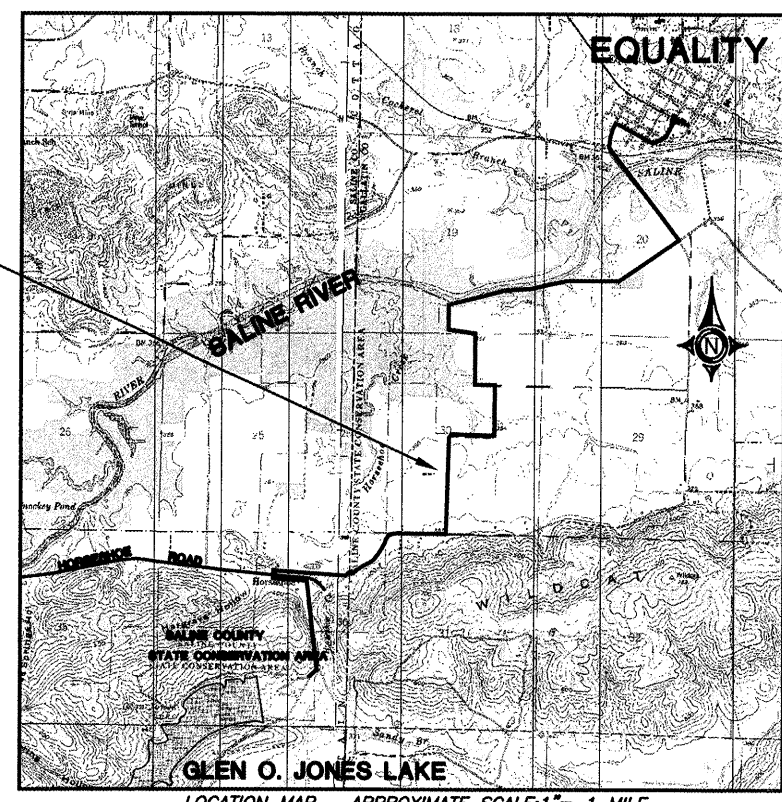

LOCATION MAP APPROXIMATE SCALE: 1" = 1 MILE
LENGTH OF IMPROVEMENT = 29,760 FEET (5.63 MILES)

- HIGHWAY STANDARDS
- 000001-05 STANDARD SYMBOLS, ABBREVIATIONS & PATTERNS
 - 280001-05 TEMPORARY EROSION CONTROL SYSTEMS
 - 701301-03 LANE CLOS., 2L, 2W, SHORT TIME OPERATIONS
 - 701901-01 TRAFFIC CONTROL DEVICES
 - BLR 21-8 TYPICAL APP. OF TRAFFIC CONTROL DEVICES FOR CONSTRUCTION ON RURAL LOCAL HIGHWAYS
 - BLR 22-6 TYPICAL APP. OF TRAFFIC CONTROL DEVICES FOR RURAL LOC. HWYS. (2-LANE 2-WAY RURAL TRAFF.) (RD. CLOSED TO THRU TRAFF.)
 - 728001-01 TELESCOPING STEEL SIGN SUPPORT UTILITIES

SHAWNEE TELEPHONE COMPANY
 SOUTHEASTERN ILLINOIS ELECTRIC CO-OP.

NOTE: ALL EXISTING UTILITIES AND LOCATIONS TO BE CONFIRMED BY J.U.L.I.E. 800-892-0123

B.R.I. JOB NO. 04-096

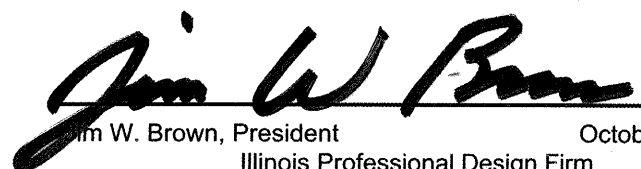
 Jim W. Brown, President
 Illinois Professional Design Firm
 Land Survey & Prof. Eng. Corp
 Number 184-002518
 Expires April 30, 2011

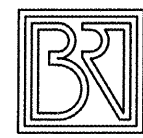
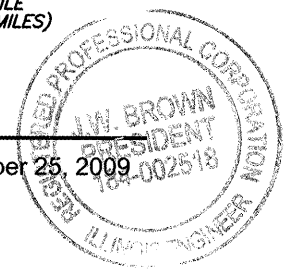

BROWN AND ROBERTS, INC.
CONSULTING ENGINEERS AND LAND SURVEYORS
 1 WESTRIDGE ROAD HARRISBURG, IL. 62946 (618) 252-8111

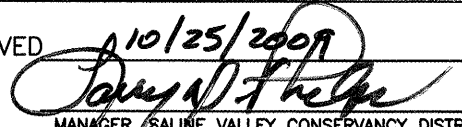
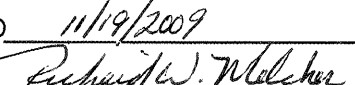
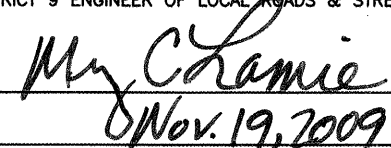
SALINE VALLEY CONSERVANCY DISTRICT	
APPROVED	 10/25/2009 MANAGER, SALINE VALLEY CONSERVANCY DISTRICT
PASSED	 11/19/2009 DISTRICT 9 ENGINEER OF LOCAL ROADS & STREETS
RELEASING FOR BID BASED ON LIMITED REVIEW	 11/19/2009 MARY C. LAMIE, P.E. DEPUTY DIRECTOR OF HIGHWAYS REGION FIVE ENGINEER

28 Oct 2009 - 8:30am X:\2004\04096\04\PLANS\1 cover.dwg