

15 Oct 2009 - 6:30am X:\2004\04096\ac\PLANS\9-30 plan & profile revised Hopson Alignment.dwg

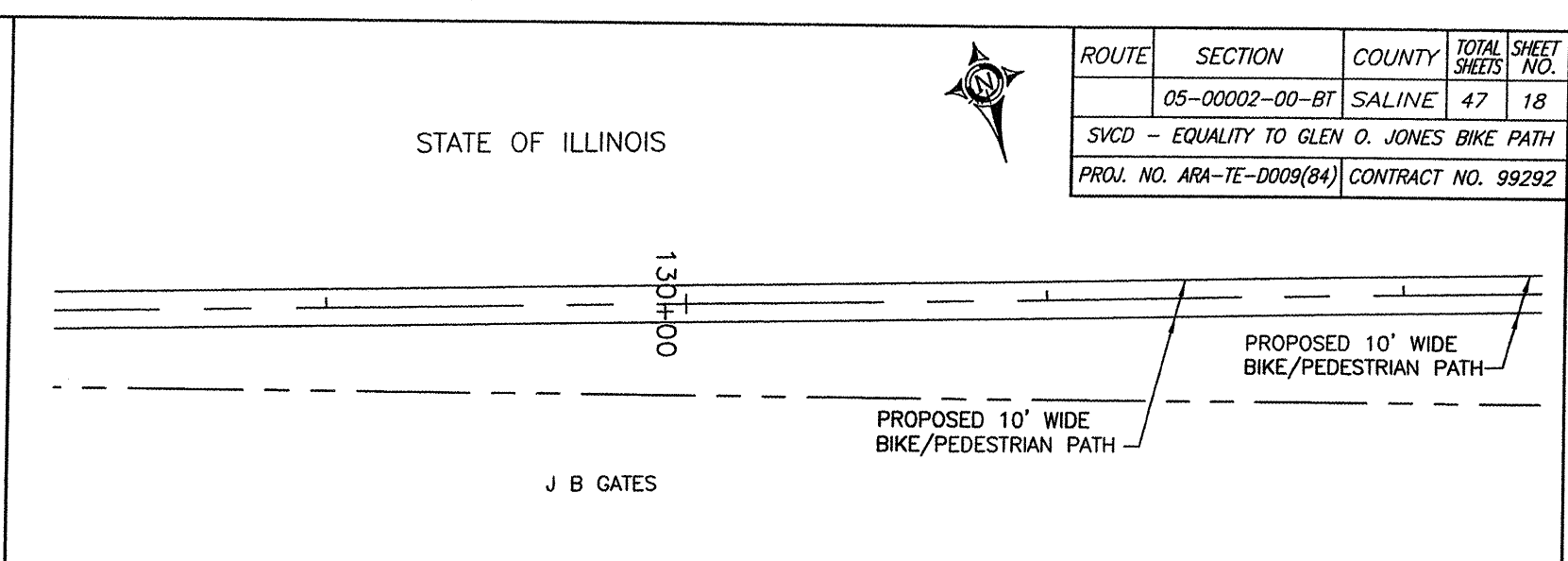

ROUTE	SECTION	COUNTY	TOTAL SHEETS	SHEET NO.
	05-00002-00-BT	SALINE	47	18
SVCD - EQUALITY TO GLEN O. JONES BIKE PATH				
PROJ. NO. ARA-TE-D009(84) CONTRACT NO. 99292				

STATION	ELEVATION	PROPOSED	EXISTING	GRADE	REMARKS
125+00	354.7	354.7	354.7		Proposed Grade Controlled by Existing Roadway
126+00	354.8	354.8	354.8		
127+00	356.4	356.4	356.4	-1.52%	VERTICAL CURVE #27 L = 100' VPC STA. 128+00 ELEV. 354.66 VPI STA. 128+50 ELEV. 353.90 VPT STA. 129+00 ELEV. 353.72 g27 = -1.52% g28 = -0.37%
128+00	354.3	354.65	354.65		
129+00	353.8	353.4	353.71		
130+00	353.1	353.3	353.3	-0.37%	VERTICAL CURVE #28 L = 200' VPC STA. 131+00 ELEV. 352.97 VPI STA. 132+00 ELEV. 352.60 VPT STA. 133+00 ELEV. 352.05 g28 = -0.37% g29 = -0.55%
131+00	352.8	352.97	352.97		
132+00	352.5	352.55	352.55		

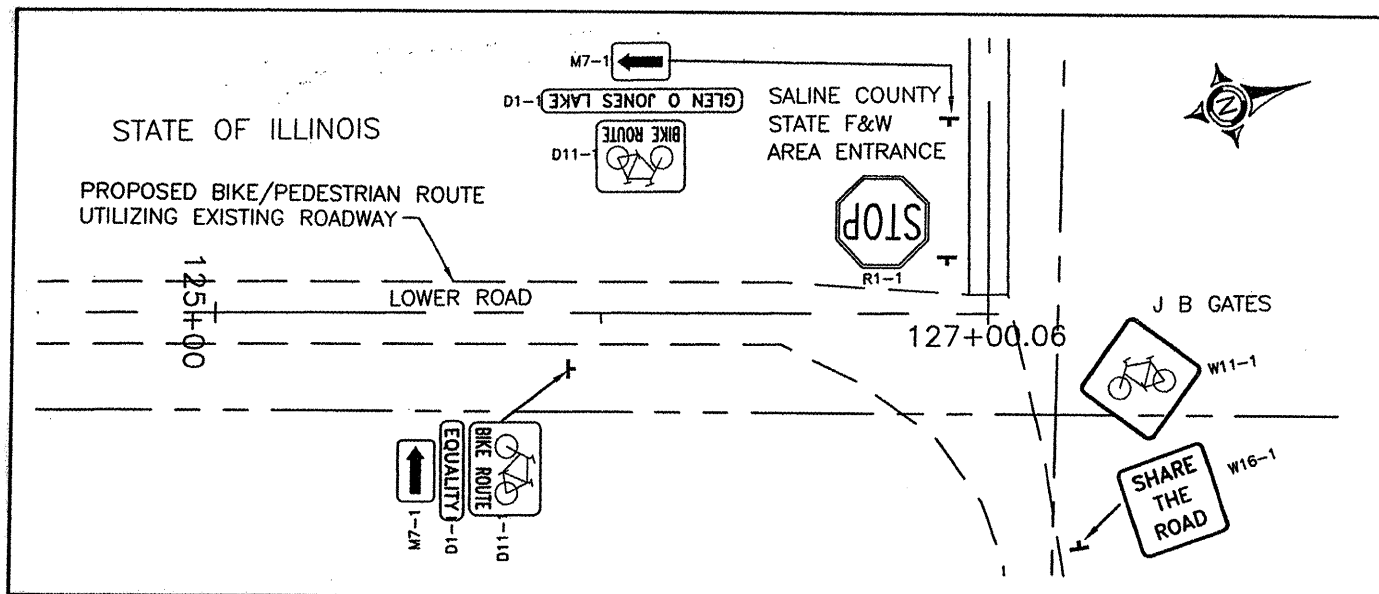
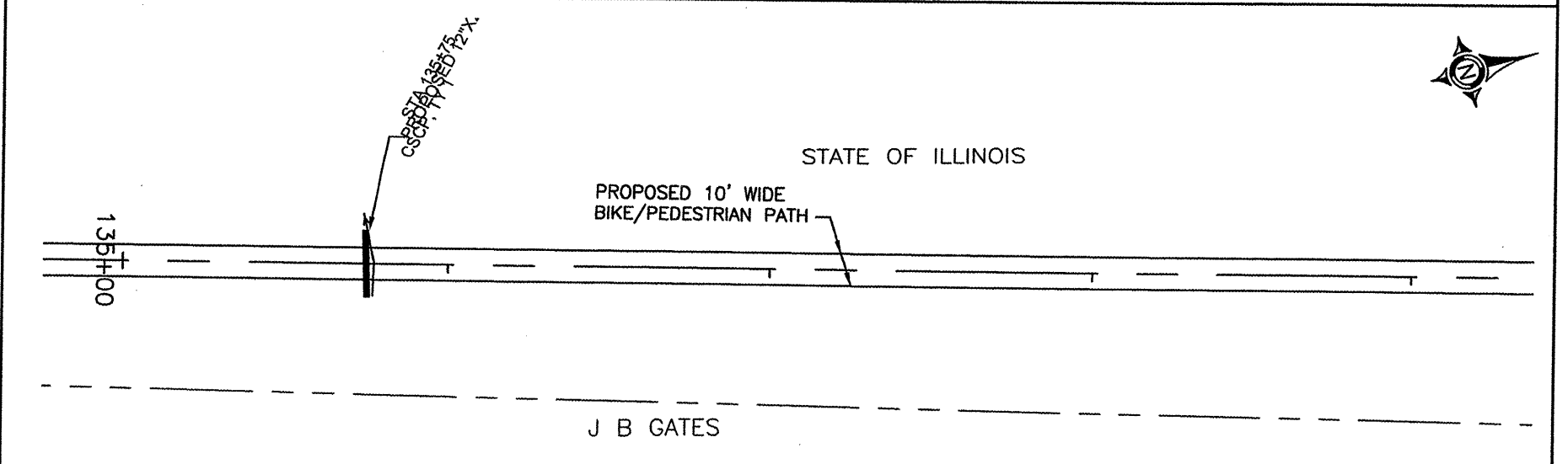
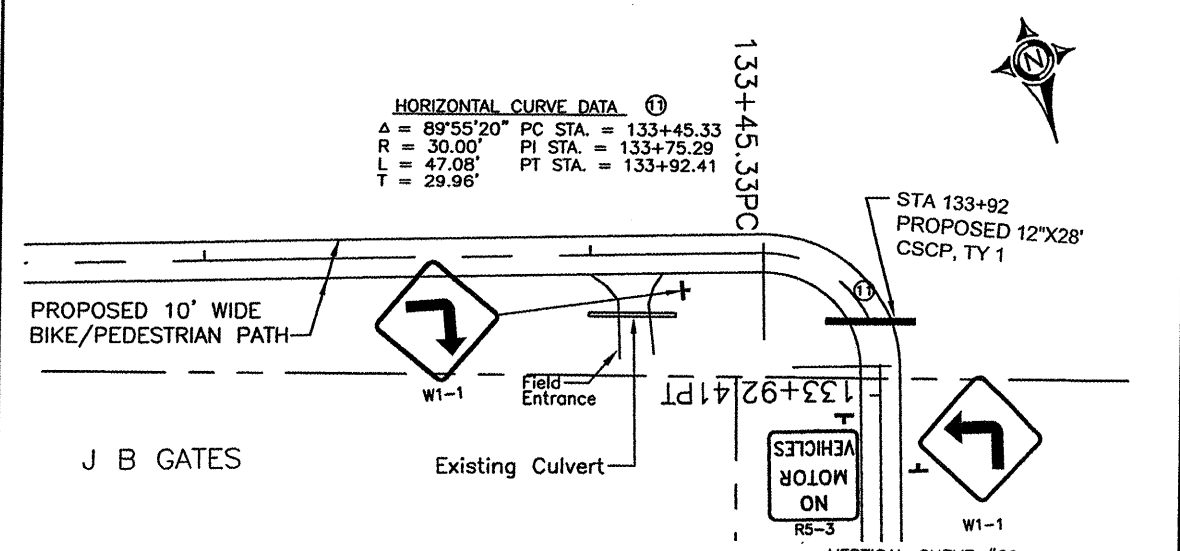

STATION	ELEVATION	PROPOSED	EXISTING	GRADE	REMARKS
132+00	352.5	352.55	352.55		
133+00	351.5	352.05	352.05	-0.55%	VERTICAL CURVE #29 L = 100' VPC STA. 133+50 ELEV. 351.78 VPI STA. 134+00 ELEV. 351.50 VPT STA. 134+50 ELEV. 350.96 g29 = -0.55% g30 = -1.08%
134+00	351.1	351.4	351.4		
135+00	349.7	350.4	350.4	-1.08%	VERTICAL CURVE #30 L = 100' VPC STA. 135+00 ELEV. 350.42 VPI STA. 135+50 ELEV. 349.88 VPT STA. 136+00 ELEV. 350.23 g30 = -1.08% g31 = 0.70%
136+00	348.9	350.25	350.25		
137+00	350.8	350.95	350.95	0.70%	
138+00	351.4	351.65	351.65		
139+00	352.0	352.33	352.33		

HORIZONTAL	VERTICAL
0 25 50	0 5 10