

ROUTE	SECTION	COUNTY	TOTAL SHEETS	SHEET NO.
FAS 1930	06-00038-00-RS	POPE	9	1
PROJECT NO. ARA-RS-1930 (119)			CONTRACT NO. 99418	

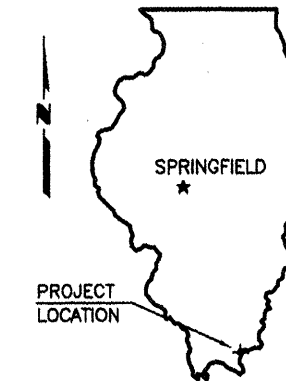

STATE OF ILLINOIS
DEPARTMENT OF TRANSPORTATION
PLANS FOR PROPOSED

AMERICAN RECOVERY AND REINVESTMENT ACT OF 2009



FAS ROUTE 1930 (BAY CITY ROAD)
SECTION 06-00038-00-RS
PROJECT NO. ARA-RS-1930 (119)
JOB NO. C-99-557-06

SUMMARY OF QUANTITIES

CODE NO.	PAY ITEM	UNIT	TOTAL
40200800	AGGREGATE SURFACE COURSE, TYPE B	TON	40
40600100	BITUMINOUS MATERIALS (PRIME COAT)	GALLON	6,400
40600300	AGGREGATE (PRIME COAT)	TON	100
40800635	LEVELING BINDER (MACHINE METHOD), N70	TON	4,460
40600982	HOT-MIX ASPHALT SURFACE REMOVAL - BUTT JOINT	SQ YD	202
40603085	HOT-MIX ASPHALT BINDER COURSE, IL-19.0, N70	TON	1,050
40603315	HOT-MIX ASPHALT SURFACE COURSE, MIX "C", N70	TON	4,600
46101200	AGGREGATE SHOULDERS, TYPE B	TON	3,290
60255500	MANHOLES TO BE ADJUSTED	EACH	5
60266600	VALVE BOXES TO BE ADJUSTED	EACH	2
67100100	MOBILIZATION	L SUM	1
70300100	SHORT-TERM PAVEMENT MARKING	FOOT	4,528
70300220	TEMPORARY PAVEMENT MARKING - LINE 4"	FOOT	80,710
* 78001110	PAINT PAVEMENT MARKING - LINE 4"	FOOT	80,710

* SPECIALTY ITEMS

INDEX OF SHEETS

- COVER SHEET
- TYPICAL SECTIONS
- RESURFACING SCHEDULE
- 7. PLAN & PROFILE
- TYPICAL SIDE ROAD & ENTRANCE DETAILS
- MISCELLANEOUS DETAILS
- STANDARDS
- 701001-02 TRAFFIC CONTROL
- 701006-03 TRAFFIC CONTROL
- 701011-02 TRAFFIC CONTROL
- 701201-03 TRAFFIC CONTROL
- 701301-03 TRAFFIC CONTROL
- 701306-02 TRAFFIC CONTROL
- 701311-03 TRAFFIC CONTROL
- 701901-01 TRAFFIC CONTROL DEVICES
- 780001-02 TYPICAL PAVEMENT MARKINGS
- BLR 24-2 MAILBOX TURNOUTS

POPE COUNTY

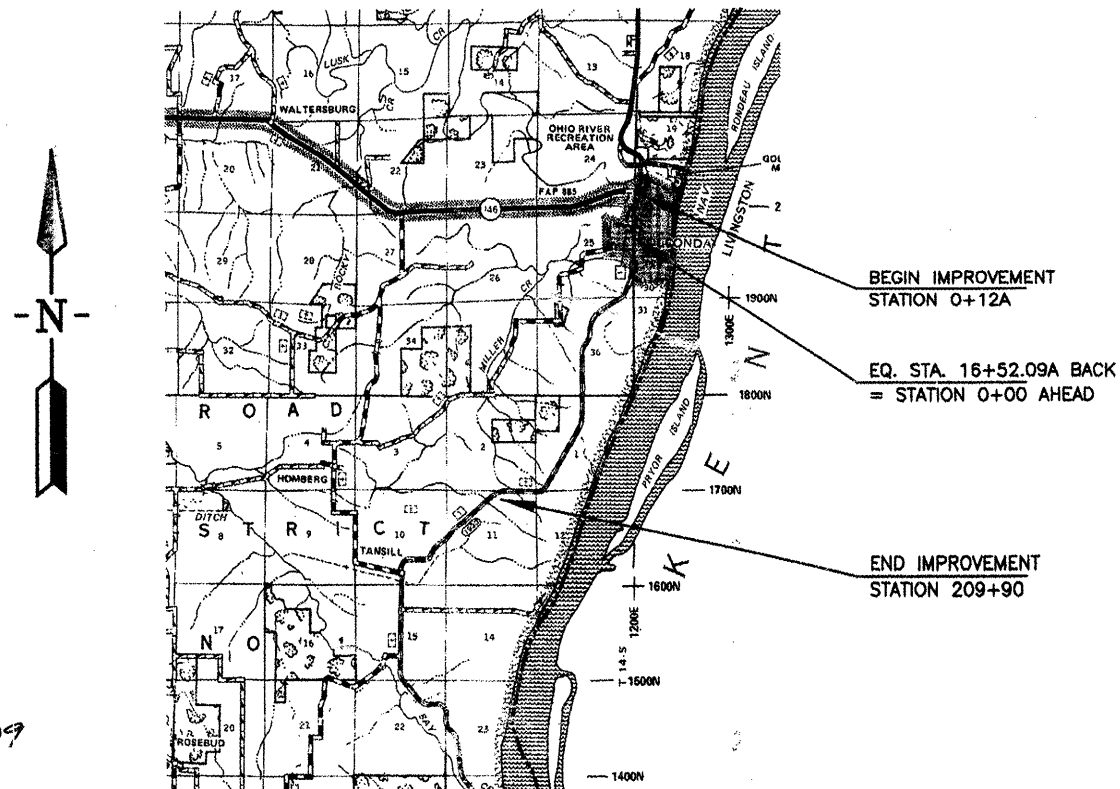

CLASSIFICATION : COLLECTOR
ADT : 370
DESIGN SPEED : 50 MPH

ILLINOIS DEPARTMENT OF TRANSPORTATION	
Approved	12/9/09 W. Brian Ziegler Pope County Engineer
Passed	12/14/09 Richard W. Melcher District 9 Engineer of Local Roads and Streets
Releasing for Bid Based on Limited Review	12/14/09 Mary C. Kamie Deputy Director of Highways, Region 5 Engineer



11-30-09

Edward W. Miller
PROFESSIONAL ENGINEER
#062-025277
EXPIRES NOV. 30, 2011

CONTRACT NO. 99418

E. MILLER ENGINEERING, INC.
CONSULTING ENGINEERS
HARRISBURG, ILLINOIS

LOCATION MAP

SCALE: 1" = 2 MILES

NET LENGTH OF IMPROVEMENT = 22,630.09 FT. = 4.2860 MILES