

LEGEND

	NEW 2" HMA PAVEMENT MILLING (BASE BID)		EXISTING TAXIWAY LIGHT
	NEW 2" FULL DEPTH HMA PAVEMENT REMOVAL (ADDITIVE ALTERNATE #1)		EXISTING AIRFIELD CABLE
	NEW BUTT JOINT CONSTRUCTION		EXISTING ELECTRICAL DUCT (NUMBER OF WAYS NOTED)
	EXISTING STORM SEWER		EXISTING SANITARY MANHOLE
	EXISTING FLARED END SECTION		EXISTING ELECTRICAL MANHOLE
	EXISTING STORM SEWER MANHOLE/INLET		EXISTING ELECTRICAL HANDHOLE
	EXISTING 4' FENCE		DENOTES ADJACENT ITEM TO BE REMOVED
	EXISTING TIE DOWN ANCHOR/MOORING EYE		EXISTING CONTOUR
	DENOTES ADJACENT ITEM TO BE ADJUSTED		

THE INFORMATION SHOWN ON THESE PLANS HAS BEEN OBTAINED FROM AVAILABLE RECORDS. NEITHER THE OWNER NOR THE ENGINEER ASSUMES ANY RESPONSIBILITY WHATEVER IN RESPECT TO THE ACCURACY OR SUFFICIENCY OF THE INFORMATION AND THERE IS NO GUARANTEE EITHER EXPRESSED OR IMPLIED THAT THE CONDITIONS INDICATED ARE REPRESENTATIVE OF THOSE TO BE ENCOUNTERED IN THE FIELD. IT SHALL BE THE CONTRACTOR'S RESPONSIBILITY TO VISIT THE SITE AND ACQUAINT HIMSELF WITH THE EXISTING CONDITIONS.

SURVEY BOOK # BOOK #

REVISIONS		
NUMBER	BY	DATE

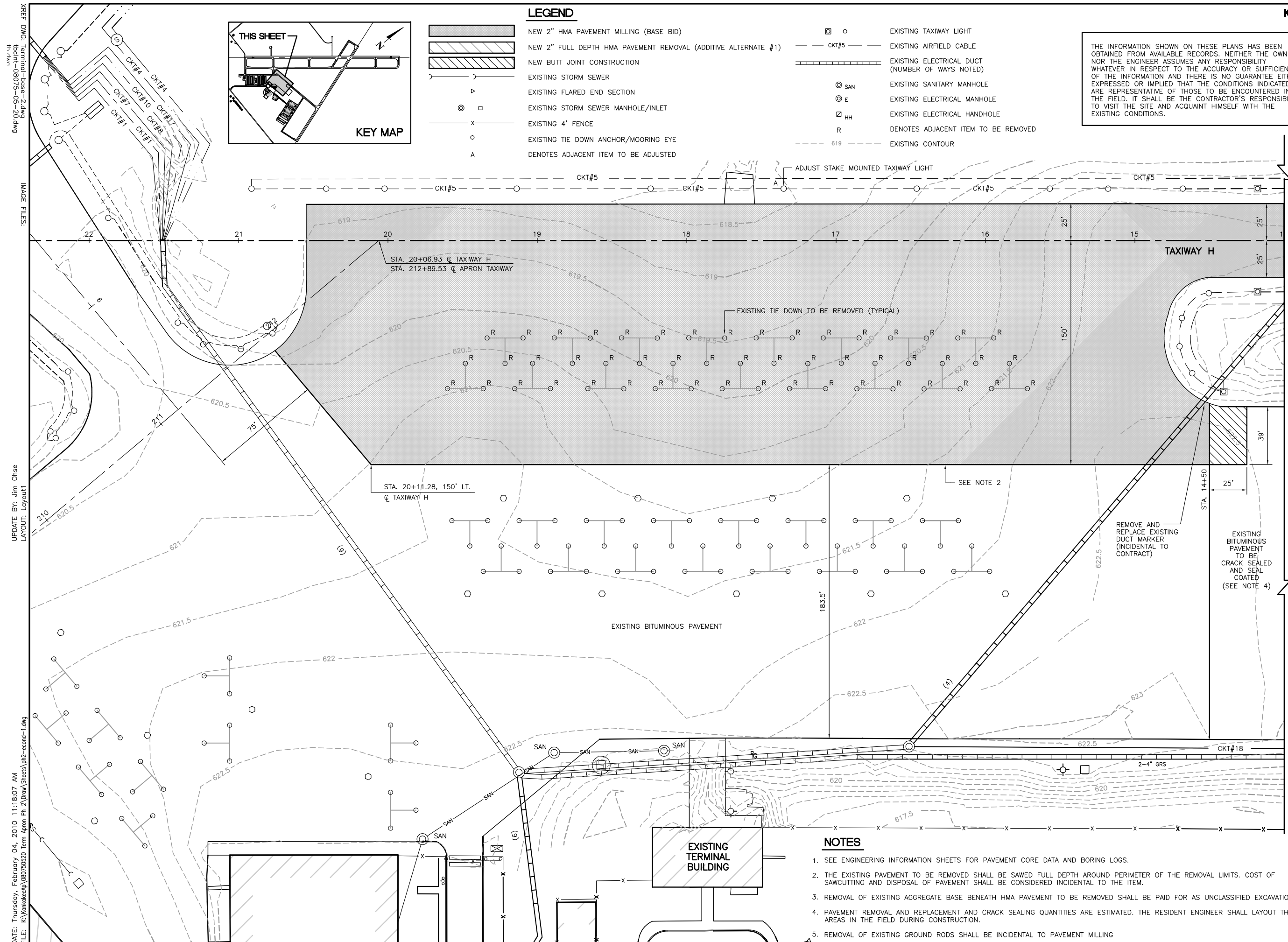
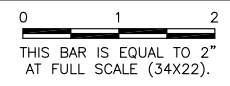

MATCHLINE STA. 14+00 TAXIWAY H

NOTES

- SEE ENGINEERING INFORMATION SHEETS FOR PAVEMENT CORE DATA AND BORING LOGS.
- THE EXISTING PAVEMENT TO BE REMOVED SHALL BE SAWED FULL DEPTH AROUND PERIMETER OF THE REMOVAL LIMITS. COST OF SAWCUTTING AND DISPOSAL OF PAVEMENT SHALL BE CONSIDERED INCIDENTAL TO THE ITEM.
- REMOVAL OF EXISTING AGGREGATE BASE BENEATH HMA PAVEMENT TO BE REMOVED SHALL BE PAID FOR AS UNCLASSIFIED EXCAVATION.
- PAVEMENT REMOVAL AND REPLACEMENT AND CRACK SEALING QUANTITIES ARE ESTIMATED. THE RESIDENT ENGINEER SHALL LAYOUT THESE AREAS IN THE FIELD DURING CONSTRUCTION.
- REMOVAL OF EXISTING GROUND RODS SHALL BE INCIDENTAL TO PAVEMENT MILLING

**GREATER KANKAKEE AIRPORT
KANKAKEE, ILLINOIS
REHABILITATE TERMINAL APRON AND TAXIWAY H - PHASE 2
EXISTING CONDITIONS/PROPOSED REMOVALS
SHEET 1**

© Copyright CMT, Inc.

CMT
CRAWFORD, MURPHY & TILLY, INC.
CONSULTING ENGINEERS
License No. 184-000613

DESIGN BY:	CAL
DRAWN BY:	JRO
CHECKED BY:	CAL
APPROVED BY:	DKP
DATE:	01/15/2010
JOB No:	08075-05-20
ILLINOIS PROJECT:	IKK-3902
A.I.P. PROJECT:	3-17-0057-B17
FINAL	
SHEET	7 OF 20 SHEETS

DATE: Thursday, February 04, 2010 11:18:07 AM
 FILE: K:\kankakee\080750520 Term Apron Ph 2\Draw\Sheets\p2-ecord-1.dwg
 UPDATE BY: Jim Ohse
 LAYOUT: Layout1
 IMAGE FILES:
 KRFT-DWG: Terminal-Base-2.dwg
 Terminal-08075-05-20.dwg
 11.dwg