

RESURFACING SCHEDULE													
LOCATION			LENGTH	HMA SURFACE REMOVAL, 2 1/2"	HMA SURFACE REMOVAL, 2 3/4"	HMA SURFACE COURSE, IL-9.5, MIX "D", N90 1 1/2"	HMA BINDER COURSE, IL-9.5FG, N90 1 1/4"	LONGITUDINAL JOINT SEALANT	HMA SHOULDERS	AGGREGATE WEDGE SHOULDER, TYPE B	BITUMINOUS MATERIALS (TACK COAT)	CURB REFLECTORS	NOTES
STATION	TO	STATION	FOOT	SQ YD	SQ YD	TON	TON	FOOT	TON	TON	POUND	EACH	
IL 157													
139+00	TO	140+80	180.00	1680		121	101	1104	37	5	1080	48	
140+80	TO	144+70	390.00	5509		463	386	1660			3719	23	
144+70	TO	147+13	243.00	1841		155	129	901			1243	16	
147+13	TO	149+30	217.00	1656		140	116	1085			1118	20	
149+30	TO	152+61	331.00	4847		408	340	1602			3272	78	
152+61	TO	155+18	257.00	2285		173	144	956	36	4	1491	16	
155+18	TO	157+00	182.00	1639		125	104	910	25	3	1070	18	
157+00	TO	160+67	367.00	4834		379	316	1964	51	5	3189	52	
160+67	TO	161+60	93.00	838		64	53	495	13	2	547	8	
161+60	TO	167+25	565.00	5776		412	343	2402	136	15	3701	37	
167+25	TO	168+58	133.00	1711		124	104	399	37	4	1101	5	
168+58	TO	170+98	240.00	2054		137	114	720	66	7	1290	15	
170+98	TO	173+03	205.00	1618		106	88	615	57	6	1010	15	
173+03	TO	183+84	1081.00	7808		495	412	2162	296	29	4838	8	
183+84	TO	192+37	853.00	6614		429	357	1706	234	23	4122	46	
192+37	TO	203+00	1063.00	9568		645	538	2727	292	28	6033	57	
203+00	TO	216+50	1350.00										RESURFACING OMISSION
216+50	TO	219+26	276.00	1120	890	169	141	952			1356	21	
219+26	TO	222+12	286.00	2625		221	184	976			1772	18	
222+12	TO	224+44	232.00	1753		148	123	696			1184	15	
224+44	TO	226+83	239.00	1780		139	116	600	21		1172	18	
226+83	TO	239+88	1305.00	12760		585	488	2610	894		7308		
239+88	TO	243+27	339.00	2939		184	153	980	117		1814	21	
243+27	TO	244+00	73.00	536		45	38	219			362	6	
244+00	TO	247+75	375.00	3364		283	236	1162			2271	29	
RAMP 1													
0+38	TO	0+68	30.00	87		6	5		5	1	53	4	
0+68	TO	6+70	602.00	1740		102	85	67	83	8	1054	16	
6+70	TO	9+20	250.00	779		38	32		52	10	450		
RAMP 2													
2+40	TO	3+90	150.00	467		23	19		31	6	270		
3+90	TO	9+41	551.00	1592		93	78	68	76	8	965	14	
9+41	TO	9+71	30.00	87		6	5		5	1	53	1	
RAMP 3													
3+90	TO	7+50	360.00	1120		54	45		74	14	648		
7+50	TO	13+19	569.00	1644		96	80	65	78	8	996	18	
RAMP 4													
0+31	TO	5+60	529.00	1529		89	75	98	73	7	926	14	
5+60	TO	8+10	250.00	779		38	32		52	10	450		
TOTALS				96979	890	6695	5580	29901	2841	204	61928	657	



GUARDRAIL SCHEDULE													
STATION	TO	STATION	LENGTH OF NEED	STEEL PLATE BEAM GUARDRAIL, TYPE A, 6 FOOT POSTS	STEEL PLATE BEAM GUARDRAIL, TYPE B, 9 FOOT POSTS	STEEL PLATE BEAM GUARDRAIL, TYPE D, 6 FOOT POSTS	IMPACT ATTENUATORS (PARTIALLY REDIRECTIVE), TEST LEVEL 3	TRAFFIC BARRIER TERMINAL, TYPE 1 (SPECIAL) TANGENT	TRAFFIC BARRIER TERMINAL, TYPE 2	TERMINAL MARKER-DIRECT APPLIED	GUARDRAIL REFLECTORS, TYPE A	GUARDRAIL REMOVAL	NOTES
			FOOT	FOOT	FOOT	FOOT	EACH	EACH	EACH	EACH	EACH	FOOT	
138+50	TO	139+56	112.5		87.5			1	1	1	2	113	IL 157, MATCH EXISTING
192+00	TO	194+25	637.5		612.5			1	1	1	8	638	IL 157 & CALIFORNIA DR, MATCH EXISTING
223+07	TO	243+29	2012.5		1987.5			1	1	1	26	2013	IL 157, MATCH EXISTING
226+34	TO	237+77	1150.0			1150.0	1				15	1150	IL 157, MATCH EXISTING
237+77	TO	239+52	175.0	350.0							6	350	IL 157, MATCH EXISTING
239+52	TO	239+88	37.5			37.5	1				1	38	IL 157, MATCH EXISTING
TOTALS				350	2688	1188	2	3	3	3	58	4302	

REVISD 2-25-2021

MODEL: Default
FILE NAME: p:\glplanroom.dwt\illinois.gov\p\id\DOT\Documents\DOT Office\District B\Projects\076K45\CAD\Drawings\076K45-shl-schedule.dgn

USER NAME = HUMPHREYSB	DESIGNED -	REVISED -
	DRAWN -	REVISED -
PLOT SCALE = 100.0000' / in.	CHECKED -	REVISED -
PLOT DATE = 2/24/2021	DATE -	REVISED -

STATE OF ILLINOIS
DEPARTMENT OF TRANSPORTATION

SCHEDULE OF QUANTITIES

SCALE: NTS SHEET 1 OF 3 SHEETS STA. TO STA.

F.A.P. RTE.	SECTION	COUNTY	TOTAL SHEETS	SHEET NO.
592	(32-1.119-1)RS-3	ST. CLAIR	92	31
CONTRACT NO. 76K45				
ILLINOIS FED. AID PROJECT				

MODEL: Default
 FILE NAME: p:\work\room.dwg
 PROJECT: 076K45-CADD\DATA\CAD\PROJECTS\076K45-PLAN.dgn



MATCHLINE STA 226+00

MATCHLINE STA 231+50

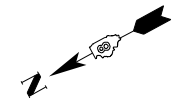
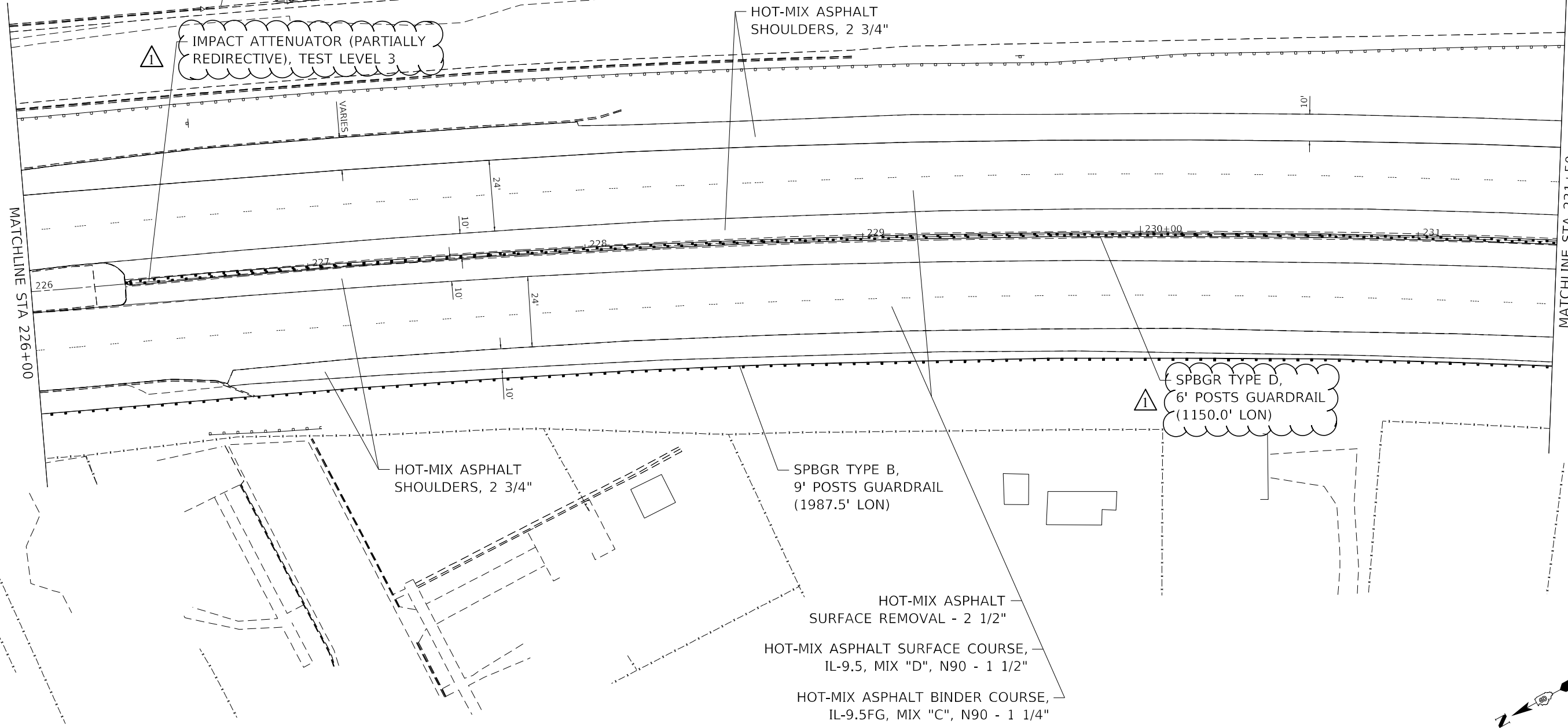

△ REVISED 2-25-2021

USER NAME = humphreysb	DESIGNED -	REVISED -
	DRAWN -	REVISED -
PLOT SCALE = 40,0000 * / in.	CHECKED -	REVISED -
PLOT DATE = 2/25/2021	DATE -	REVISED -

**STATE OF ILLINOIS
 DEPARTMENT OF TRANSPORTATION**

PLANS SHEET

SCALE: 1"=20' SHEET 20 OF 24 SHEETS STA. 226+00 TO STA. 231+50

F.A.P. RTE.	SECTION	COUNTY	TOTAL SHEETS	SHEET NO.
592	(32-1.119-1)RS-3	ST. CLAIR	92	55
CONTRACT NO. 76K45				
ILLINOIS FED. AID PROJECT				

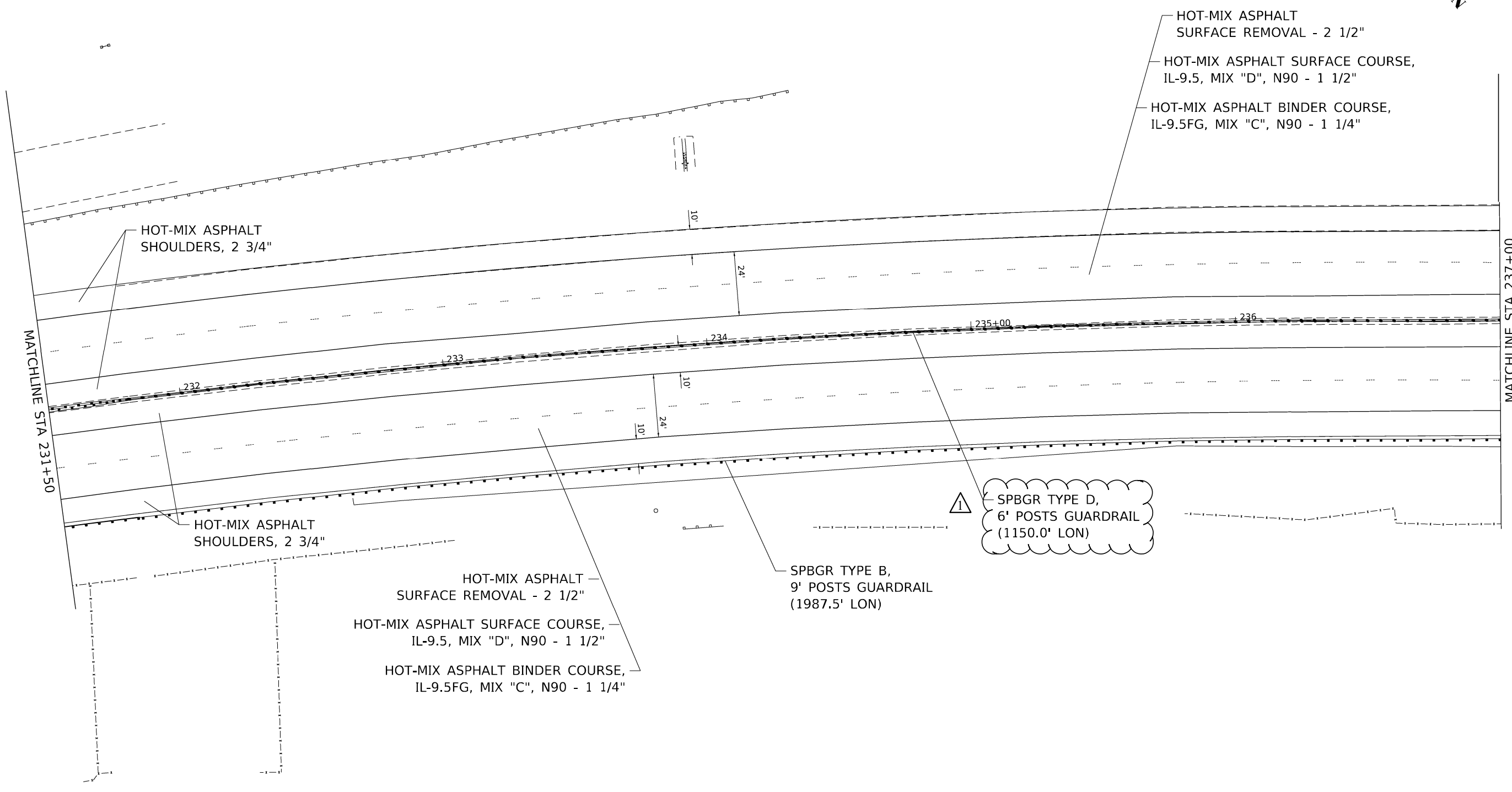
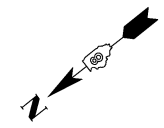

MODEL: Default
 FILE: N:\a\c:\p\uplanroom.dct\illinois.gov\PHWDOT\Documents\DOT_Offices\District_8\Projects\ID76K45\CADD\Drawings\CAD\Drawings\ID76K45-Plan.dgn

△ REVISED 2-25-2021

USER NAME = humphreysb	DESIGNED -	REVISED -
	DRAWN -	REVISED -
PLOT SCALE = 40.0000' / in.	CHECKED -	REVISED -
PLOT DATE = 2/25/2021	DATE -	REVISED -

**STATE OF ILLINOIS
DEPARTMENT OF TRANSPORTATION**

PLANS SHEET

SCALE: 1"=20' SHEET 21 OF 24 SHEETS STA. 231+50 TO STA. 237+00

F.A.P. RTE.	SECTION	COUNTY	TOTAL SHEETS	SHEET NO.
592	(32-1,119-1)RS-3	ST. CLAIR	92	56
CONTRACT NO. 76K45				
ILLINOIS FED. AID PROJECT				

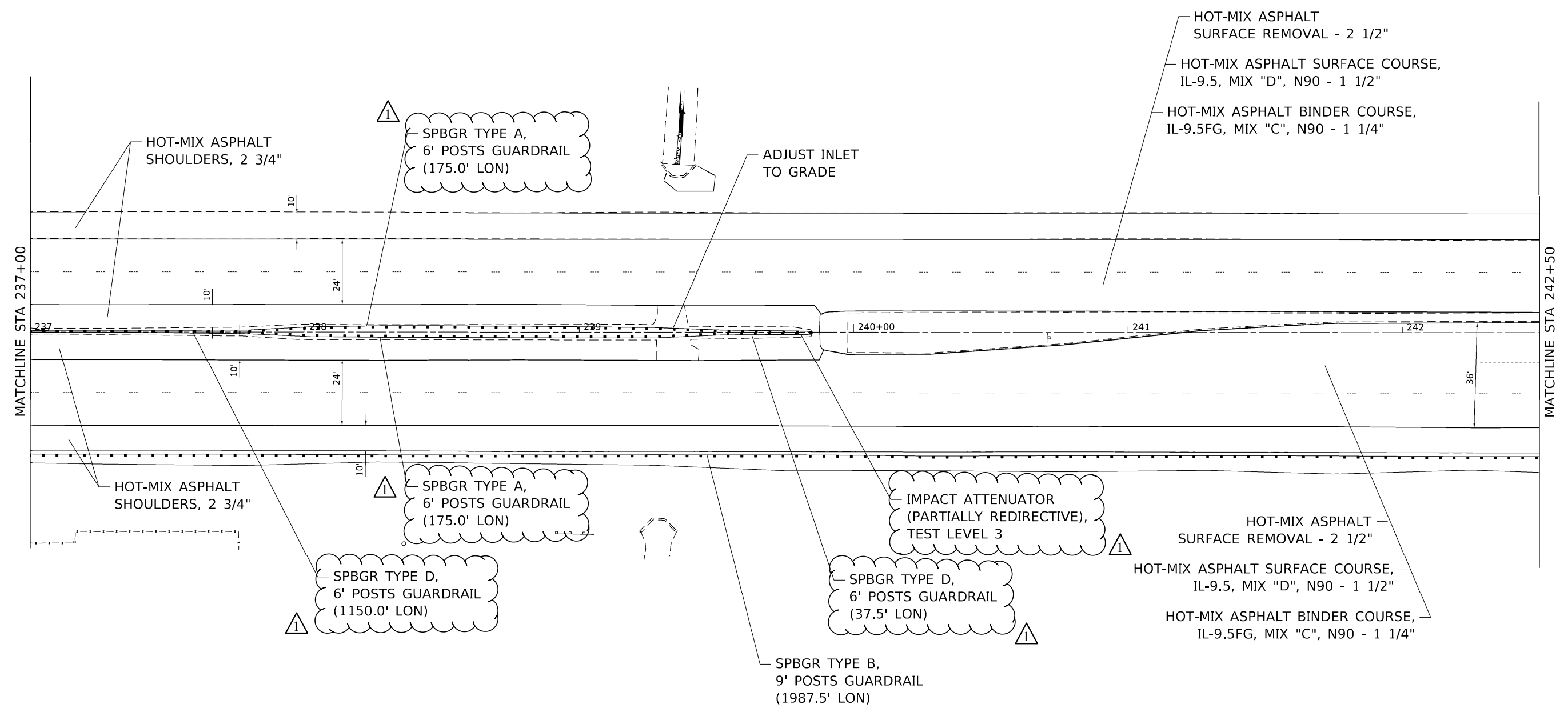
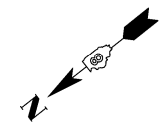

△ REVISED 2-25-2021

MODEL: D:\p1\work\11111111.dwg
 FILE: 11111111.dwg
 PROJECT: 11111111
 USER: humphreysb
 DATE: 2/25/2021

USER NAME = humphreysb	DESIGNED -	REVISED -
	DRAWN -	REVISED -
PLOT SCALE = 40.0000' / in.	CHECKED -	REVISED -
PLOT DATE = 2/25/2021	DATE -	REVISED -

**STATE OF ILLINOIS
DEPARTMENT OF TRANSPORTATION**

PLANS SHEET

SCALE: 1"=20' SHEET 22 OF 24 SHEETS STA. 237+00 TO STA. 242+50

F.A.P. RTE.	SECTION	COUNTY	TOTAL SHEETS	SHEET NO.
592	(32-1,119-1)RS-3	ST. CLAIR	92	57
CONTRACT NO. 76K45				
ILLINOIS FED. AID PROJECT				