

STATE OF ILLINOIS
DEPARTMENT OF TRANSPORTATION

FAS	SECTION	COUNTY	TOTAL SHEETS	SHEET NO.
435	19-00111-00-RS	MCDONOUGH	20	1
		ILLINOIS CONTRACT# 89788		

INDEX OF SHEETS

- 1 COVER SHEET
- 2 GENERAL NOTES
- 3 SUMMARY OF QUANTITIES
- 4 SCHEDULE OF QUANTITIES
- 5 TYPICAL SECTIONS
- 6-19 PLAN AND PROFILE SHEETS
- 20 DETAILS

PLANS FOR PROPOSED LOCAL AGENCY FUNCTIONAL OVERLAY

F.A.S. 435 - CH24 /COLMAR BLACKTOP
SECTION: 19-00111-00-RS
MCDONOUGH COUNTY
PROJECT #HW96(936)
C-94-077-20

ILLINOIS HIGHWAY STANDARDS

- 000001-08 STANDARD SYMBOLS, ABBREVIATIONS AND PATTERNS
- 701306-04 LANE CLOSURE, 2L, 2W, SLOW MOVING OPERATIONS, DAY ONLY > 45MPH
- 701901-08 TRAFFIC CONTROL DEVICES
- 720006-04 SIGN PANEL ERECTION DETAILS
- 780001-05 TYPICAL PAVEMENT MARKINGS

DESIGN DESIGNATION

FAS 435 (CH 24)
LOCAL - MAJOR COLLECTOR
ADT = 500 (2019) 500 (2032)
DESIGN SPEED = 55 MPH

PROJECT DESCRIPTION

Project consists of placing an HMA overlay between CH 19 and CH 8, for approximately 3.82 miles. Additional work includes aggregate shoulder, and other miscellaneous items.



LOCATION OF SECTION INDICATED THUS: - [Symbol] -

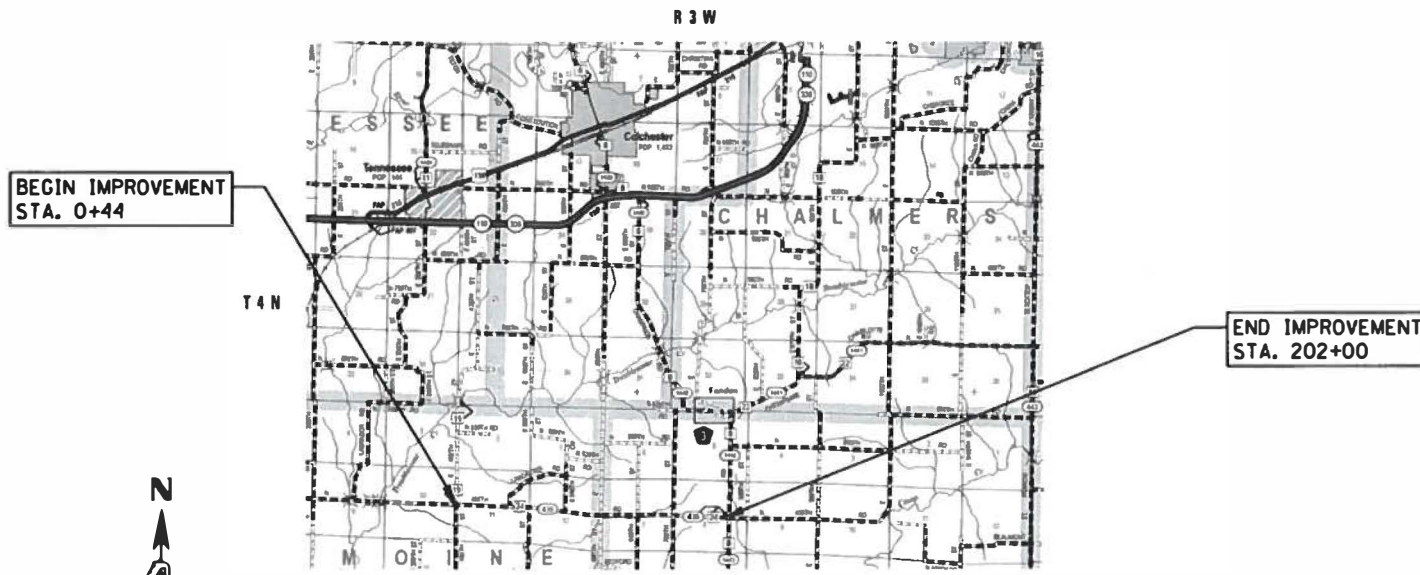

LOCATION MAP

NOT TO SCALE
GROSS /NET LENGTH OF SECTION = 20,156 FT. = 3.817 MILE

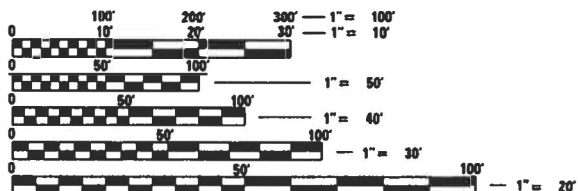

FULL SIZE PLANS HAVE BEEN PREPARED USING STANDARD ENGINEERING SCALES. REDUCED SIZED PLANS WILL NOT CONFORM TO STANDARD SCALES. IN MAKING MEASUREMENTS ON REDUCED PLANS, THE ABOVE SCALES MAY BE USED.

J.U.L.I.E.
JOINT UTILITY LOCATION INFORMATION FOR EXCAVATION
1-800-892-0123
OR 811

CONTRACT NO. 89788
CATALOG NO. 036055-000



STATE OF ILLINOIS
DEPARTMENT OF TRANSPORTATION
DIVISION OF HIGHWAYS

APPROVED 9/17/2020
[Signature]
MCDONOUGH COUNTY ENGINEER

Passed 12-17/2020
[Signature]
DISTRICT 4 BLRS BUREAU CHIEF

Releasing For
Bid Based on
Limited Review December 17 2020
[Signature]
REGION THREE ENGINEER

PRINTED BY THE AUTHORITY OF THE STATE OF ILLINOIS

Plans prepared by:
KLINGNER & ASSOCIATES, P.C.
Engineers • Architects • Surveyors

Galesburg, Illinois
49 N. Prairie Street
309.343.1268
www.klingner.com
Quincy, IL Burlington, IA
Pella, IA Harvel, MO Columbia, MO
IL DESIGN FIRM NO.: 1842738

GENERAL NOTES

- WHERE SECTION OR SUBSECTION MONUMENTS ARE ENCOUNTERED, THE ENGINEER SHALL BE NOTIFIED BEFORE SUCH MONUMENTS ARE REMOVED. THE CONTRACTOR SHALL PROTECT AND CAREFULLY PRESERVE ALL PROPERTY MARKERS AND MONUMENTS UNTIL THE OWNER AND AN AUTHORIZED SURVEYOR OR AGENT, HAS WITNESSED OR OTHERWISE REFERENCED THEIR LOCATION.
- IT WILL BE THE CONTRACTOR'S RESPONSIBILITY TO DETERMINE THE EXACT LOCATION OF ALL UTILITIES AND CARRY OUT HIS OR HER OPERATIONS ACCORDINGLY.
- ADJUSTMENTS OF UTILITY LOCATIONS SHALL BE MADE BY THE OWNER, UNLESS OTHERWISE NOTED.
- AERIAL LINES ARE PRESENT AND THE CONTRACTOR'S OPERATIONS SHOULD TAKE INTO ACCOUNT THE LINES WILL NOT BE MOVED OR RELOCATED.
- ANY REFERENCE TO A STANDARD IN THESE PLANS SHALL BE INTERPRETED TO MEAN THE EDITION, AS INDICATED BY THE SUB-NUMBER ON THE COVER SHEET.
- ALL DETAILS IN THESE PLANS SHALL GOVERN THE CONSTRUCTION OF THIS PROJECT, AND IN CASE OF CONFLICT WITH ANY STANDARD DRAWINGS INCLUDED, THE SAID DETAILS SHALL GOVERN.
- THE EXISTING ROAD SIGNS THAT INTERFERE WITH CONSTRUCTION SHALL BE REMOVED AND RELOCATED AS DIRECTED BY THE ENGINEER. THIS WORK WILL NOT BE PAID FOR SEPARATELY BUT SHALL BE CONSIDERED AS PART OF THE CONTRACT AND NO COMPENSATION WILL BE ALLOWED.
- IN ACCORDANCE WITH STATE OF ILLINOIS P.A. 86-0674, THE CONTRACTOR IS TO NOTIFY ALL UTILITY COMPANIES NOT MORE THAN 14 DAYS NOR LESS THAN 48 HOURS (EXCLUSIVE OF SATURDAYS, SUNDAYS, AND HOLIDAYS) IN ADVANCE OF THE START OF EXCAVATION OR DEMOLITION.

J.U.L.I.E. TELEPHONE NUMBER
1-800-892-0123

KNOWN UTILITIES LOCATED WITHIN THE LIMITS OF THIS IMPROVEMENT ARE:

ELECTRIC & GAS AMEREN IP 1505 E. UNIVERSITY DR MACOMB, IL 1(800)755-5000	CABLE TV MEDIACOM 301 N. MADISON ST MACOMB, IL 61455 1(309)434-5891
--	---

RATES OF APPLICATION TABLE

AGGREGATE (BASE, SUBBASE, OR BACKFILL)	1.80 TON / CU YD
AGGREGATE SHOULDERS	1.50 TON / CU YD
HOT-MIX ASPHALT:	
BITUMINOUS MATERIALS (TACK COAT)	0.08 LB / SQ FT RESIDUAL (ON HMA & CONCRETE)
BITUMINOUS MATERIALS (TACK COAT)	0.08 LB / SQ FT RESIDUAL (BETWEEN LIFTS & ON BRICK)
BITUMINOUS MATERIALS (PRIME COAT)	0.025 LB / SQ FT RESIDUAL (ON AGGREGATE)
SURFACE / BINDER (112 lbs)	0.056 TON / SQ YD • IN

LOCATION(S):		
MIXTURE USE(S):	LEVEL BINDER MM	HMA SURF CSE
AC/PG:	PG 64-22	PG 64-22
DESIGN AIR VOIDS:	4.0% @ N DESIGN=50	4.0% @ N DESIGN=50
MIXTURE COMPOSITION: (GRADATION MIXTURE)	IL 4.75	IL 9.5
FRICITION AGGREGATE	N/A	MIX "C"

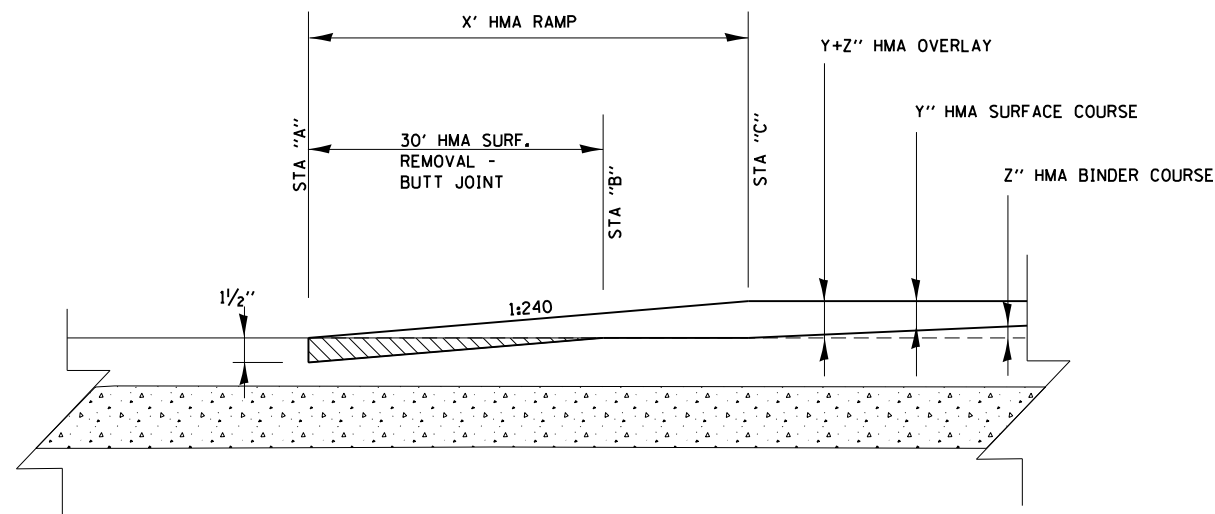

BUTT JOINT DETAIL

DISTRICT 4 GENERAL NOTES

NO PASSING ZONE VERIFICATION

MCDONOUGH COUNTY SHALL VERIFY THE LOCATION OF THE NO PASSING ZONE PRIOR TO CENTERLINE STRIPING.

PAVING SURFACE COURSE

CONTINUOUS PAVING OPERATIONS ON THE MAIN ROADWAY SHALL BE MAINTAINED AT ALL TIMES DURING THE CONSTRUCTION OF HOT MIX ASPHALT SURFACE. NO INTERRUPTIONS FOR SIDE ROADS, ENTRANCES, TURN LANES, ETC., SHALL BE ALLOWED.

STATION "A"	STATION "B"	STATION "C"	X'	Y"	Z"
0+44.0	0+74.0	0+89.0	45'	1 1/2"	3/4"
202+00.0	201+70.0	201+55.0	45'	1 1/2"	3/4"

• BINDER COURSE STARTS AT STATION 0+89.0; ENDS AT 201+55

D:\201\1es\2030003 (7595-002) McDonough County Highway 24\18\Transportation\CADD Sheets\SH_GenNotes.dgn

D:\2021\1es\202009_17595-0021\McDonough County Highway - Highway 24\1B.Transportation\CA00 Sheets\SH_Summary.dgn

CODE NO.	ITEM	UNIT	TOTAL QUANTITY	
			0005	
			STR	FED 80% LOCAL 20%
40200800	AGGREGATE SURFACE COURSE, TYPE B	TON	17	
40600295	POLYMERIZED BITUMINOUS MATERIALS - TACK COAT	POUND	64602	
40600982	HOT-MIX ASPHALT SURFACE REMOVAL - BUTT JOINT	SQ YD	543	
40600990	TEMPORARY RAMP	SQ YD	273	
40600827	POLYMERIZED LEVELING BINDER (MACHINE METHOD), IL 4.75, N50	TON	3122	
40604050	HOT MIX ASPHALT SURFACE COURSE, IL 9.5, MIX "C", N50	TON	3767	
40800050	INCIDENTAL HOT MIX ASPHALT SURFACING	TON	160	
48102100	AGGREGATE WEDGE SHOULDER, TYPE B	TON	2389	
67100100	MOBILIZATION	L SUM	1	
70100460	TRAFFIC CONTROL AND PROTECTION, STANDARD 701306	L SUM	1	
70103815	TRAFFIC CONTROL SURVEILLANCE	CA DAY	10	
△ 72000100	SIGN PANEL, TYPE 1	SQ FT	30	
△ 73000100	WOOD SIGN SUPPORT	FOOT	65	
△ 78001120	PAINT PAVEMENT MARKING, LINE 5"	FOOT	15541	

△ SPECIALTY ITEMS

KLINGNER & ASSOCIATES, P.C.
 Engineers • Architects • Surveyors
 816 N. 24TH ST. QUINCY, ILLINOIS 62451 217.223.3670
 STATE OF ILLINOIS DESIGN FIRM NO. 184-2739

USER NAME = mcl	DESIGNED MCL	REVISED -
	DRAWN MCL	REVISED -
PLOT SCALE = 48.0000' / in.	CHECKED EBB	REVISED -
PLOT DATE = 1/5/2021	DATE 08/10/2020	REVISED -

**MCDONOUGH COUNTY
HIGHWAY DEPARTMENT**

FAS 435 (COUNTY HIGHWAY 24) SUMMARY OF QUANTITIES			
None	SHEET 1	OF 1	SHEETS
	STA.		TO STA.

F.A.S.	SECTION	COUNTY	TOTAL SHEETS	SHEET NO.
435	19-00111-00-RS	MCDONOUGH	20	3
CONTRACT NO. 89788			ILLINOIS FED. AID PROJECT	

ROADWAY PAVING SCHEDULE

LOCATION STATION TO STATION	SIDE	SURFACE WIDTH	40600827	40604050	48102100	40600982
			P LB (MM), IL 4.75 N50 TON	HMA SURF CSE IL 9.5, MIX "C" N50 TON	AGG WEDGE SHOULDER TYPE B TON	HMA SURFACE REMOVAL BUTT-JOINT
FAS 435 (CH 24)						
0+44.0 - 0+89.0	LT & RT	20.0		10.5		100.0
0+89.0 - 201+55.0	LT & RT	20.0	3121.4	3745.7	2389	
201+55.0 - 202+00.0	LT & RT	20.0		10.5		100.0
TOTAL			3121.4	3766.7	2389	200.0
USE			3122	3767	2389	200

PAVEMENT MARKING SCHEDULE

STATION TO STATION	SIDE	78001120
		PAINT PVT MARK LINE 5" LF
FAS 435 (CH 24)		
0+44.0 - 202+00.0	LT & RT	15541.00
TOTALS		15541.00
USE		15541

SIGNAGE SCHEDULE

STATION	SIDE	SIGN	72000100	73000100
			SIGN PANEL TYPE 1 SF	WOOD SIGN SUPPORT LF
FAS 435 (CH 24)				
58+00.0	RT	W14-3*	6.0	13.0
81+00.0	RT	W14-3	6.0	13.0
122+00.0	RT	W14-3	6.0	13.0
125+00.0	LT	W14-3	6.0	13.0
156+00.0	LT	W14-3	6.0	13.0
TOTALS			30.0	65.0
USE			30	65

* - W14-3 SIGN DIMENSIONS - 48" X 48" X 36"

NO PASSING ZONES

STATION	SIDE
FAS 435 (CH 24)	
58+00.0 - 61+00.0	RT
81+00.0 - 101+00.0	RT
122+00.0 - 156+00.0	RT
125+00.0 - 101+00.0	LT
156+00.0 - 150+00.0	LT

ENTRANCE SCHEDULE

STATION	SIDE	TYPE	WIDTH	AREA (SQ YD)	40200800	40800050	40600982
					AGGREGATE SURFACE COURSE TYPE B TON	INCIDENTAL HMA SURFACING TON	HMA SURFACE REMOVAL BUTT-JOINT SQ YD
FAS 435 (CH 24)							
6+25	LT	PE	37	24	2.1	4.7	
8+75	LT	PR	21	19	1.2	3.7	
39+50	LT	475E	44	47		6.2	48.9
46+15	LT	PE	32	23	1.9	4.5	
49+25	LT	PE	31	44.4	1.9	5.3	
54+00	RT	500TH ST	40	44.4		5.6	44.4
81+00	LT	550TH ST	40	57.8		5.6	44.4
108+25	RT	600TH ST	45	55.0		25.9	57.8
108+25	LT	600TH ST	52	21	1.9	25.9	
111+00	LT	PE	38	56.7	2.2	4.1	
112+25	RT	PE	27	24	1.6	4.7	
135+75	RT	650TH ST	36	39		22.4	50.0
135+75	LT	650TH ST	45	50	1.6	22.4	
162+50	RT	700TH ST	39	43.3		5.5	43.3
162+50	LT	700TH ST	48	53.3		6.7	53.3
176+00	LT	PE	23	19	1.3	3.7	
177+00	LT	PE	21	13	1.2	2.5	
TOTALS					16.9	159.4	342.2
USE					17	160	343

* - WIDTH IS 3' OF AGGREGATE WEDGE SHOULDER PER 3P ENTRANCE DETAILS.

G:\201Files\2030003 (7595-002) McDonough County Highway - Highway 24\18.Transportation\CADD Sheets\SH_Schedule.dgn

LEGEND

- ① PROPOSED HOT MIX ASPHALT BINDER, 3/4" & VARIES
- ② PROPOSED HOT MIX ASPHALT SURFACE, 1.5"
- ③ PROPOSED AGGREGATE WEDGE SHOULDER (VARIABLE SLOPE)
- ⓔ1 EXISTING PAVEMENT (±8" AGG BASE W/±4" HMA AND O&C SURFACE)
- ⓔ2 EXISTING AGGREGATE SHOULDER

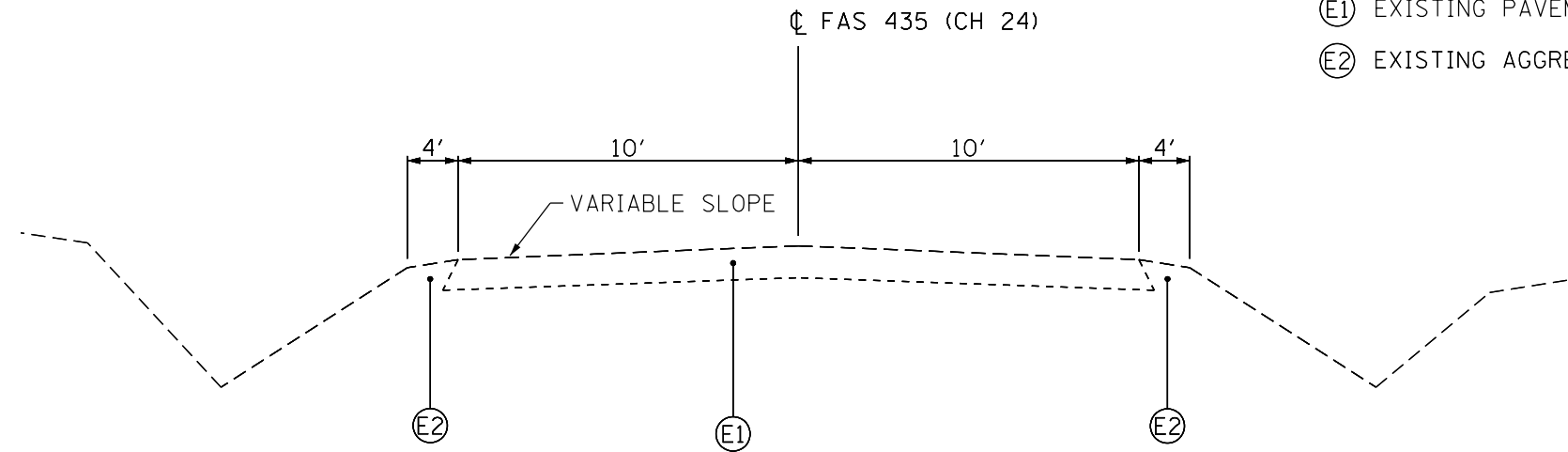

**EXISTING FAS 435 (CH 24)
TYPICAL SECTION**

STA 0+44.00 TO STA 202+00.00

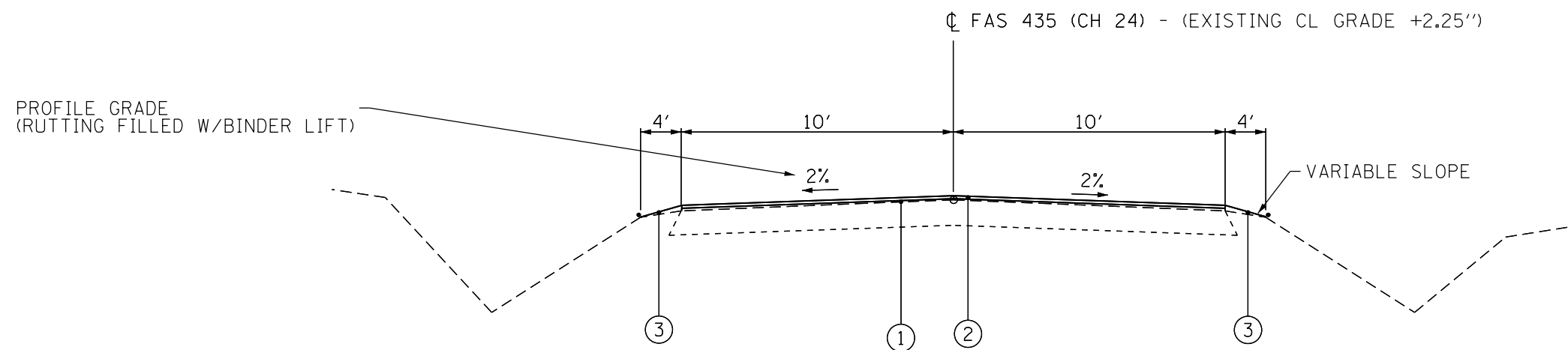

**PROPOSED FAS 435 (CH 24)
TYPICAL SECTION**

STA 0+44.00 TO STA 202+00.00

D:\2019\11\20\2020\17595-002\McDonough County Highway - Highway 24\18.Transportation\CADD Sheets\SH_TypeSection.dgn

USER NAME = mcl	DESIGNED MCL	REVISED -
DRAWN MCL	DRAWN MCL	REVISED -
PLOT SCALE = 2.0000' / in.	CHECKED EBB	REVISED -
PLOT DATE = 9/5/2020	DATE 08/10/2020	REVISED -

REVISIONS	DATE	BY	REASON

F.A.S.	SECTION	COUNTY	TOTAL SHEETS	SHEET NO.
435	19-00111-00-RS	MCDONOUGH	20	5
CONTRACT NO. 89788				
ILLINOIS FED. AID PROJECT				

PLAN	SURVEYED	DATE
	PLOTTED	
	ALIGNED	
	CHECKED	
	FILED	
	NO.	

PROFILE	SURVEYED	DATE
	PLOTTED	
	GRADES CHECKED	
	STRUCTURE NOTATIONS CHECKED	
	NO.	



- PAVEMENT MARKING LEGEND
- ① PR PAINT PAVEMENT MARKING, LINE 5" (SOLID YELLOW)
 - ② PR PAINT PAVEMENT MARKING, LINE 5" (30' SKIP, 10' DASH YELLOW)
 - ③ PR PAINT PAVEMENT MARKING, LINE 5" (SOLID YELLOW/SKIP DASH)

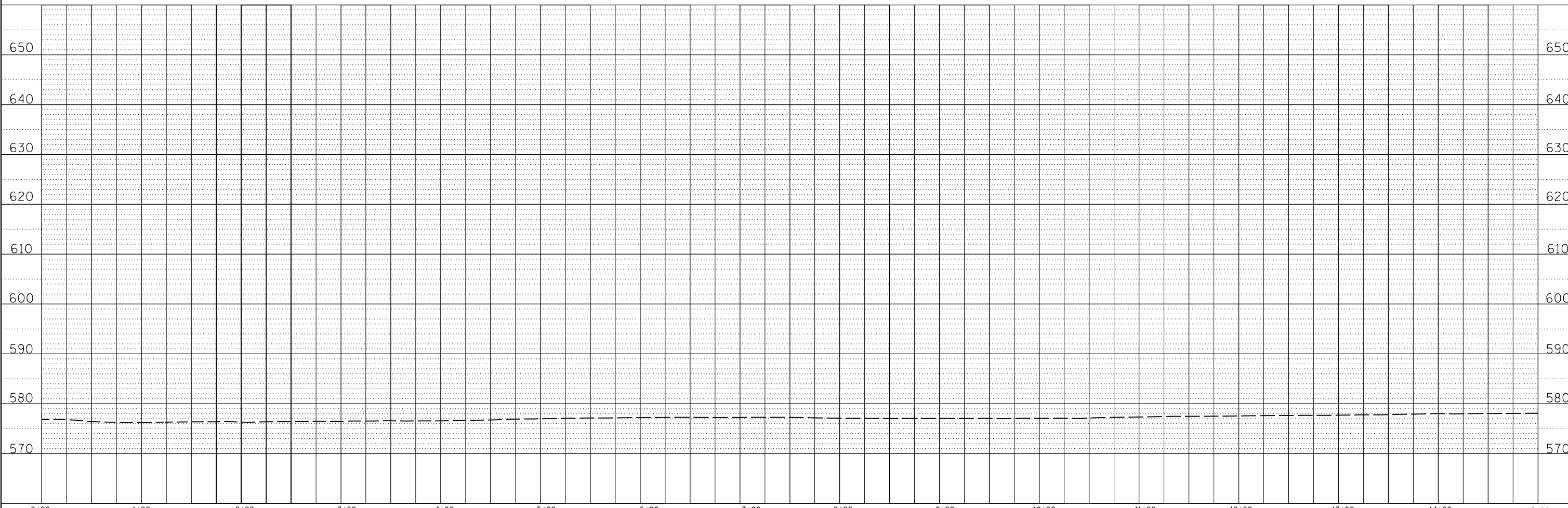
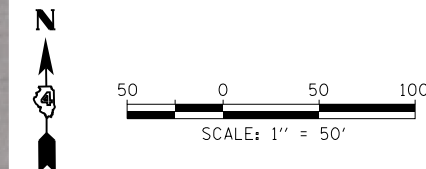

KLINGNER & ASSOCIATES, P.C. Engineers • Architects • Surveyors 616 N. 24TH ST. QUINCY, ILLINOIS 62301 217.223.3670 STATE OF ILLINOIS DESIGN FIRM NO. 184-2738	USER NAME =	DESIGNED MCL	REVISED -	MCDONOUGH COUNTY HIGHWAY DEPARTMENT	FAS 435 (COUNTY HIGHWAY 24) PLAN AND PROFILE	F.A.S.	SECTION	COUNTY	TOTAL SHEETS	SHEET NO.
	DRAWN MCL	REVISED -	435			19-00111-00-RS	MCDONOUGH	20	6	
PLOT SCALE =	CHECKED EBB	REVISED -		SCALE: 1"=50'	SHEET 1 OF 14 SHEETS	STA. 0+00	TO STA. 15+00	CONTRACT NO. 89788		
PLOT DATE	DATE 8/10/20	REVISED -		ILLINOIS FED. AID PROJECT						

PLAN	SURVEYED	DATE
	PLOTTED	BY
	GRADES CHECKED	
	STRUCTURE NOTATIONS CHECKED	
	NOTE BOOK NO.	
	FILE NAME	

PROFILE	SURVEYED	DATE
	PLOTTED	BY
	GRADES CHECKED	
	STRUCTURE NOTATIONS CHECKED	
	NOTE BOOK NO.	
	FILE NAME	

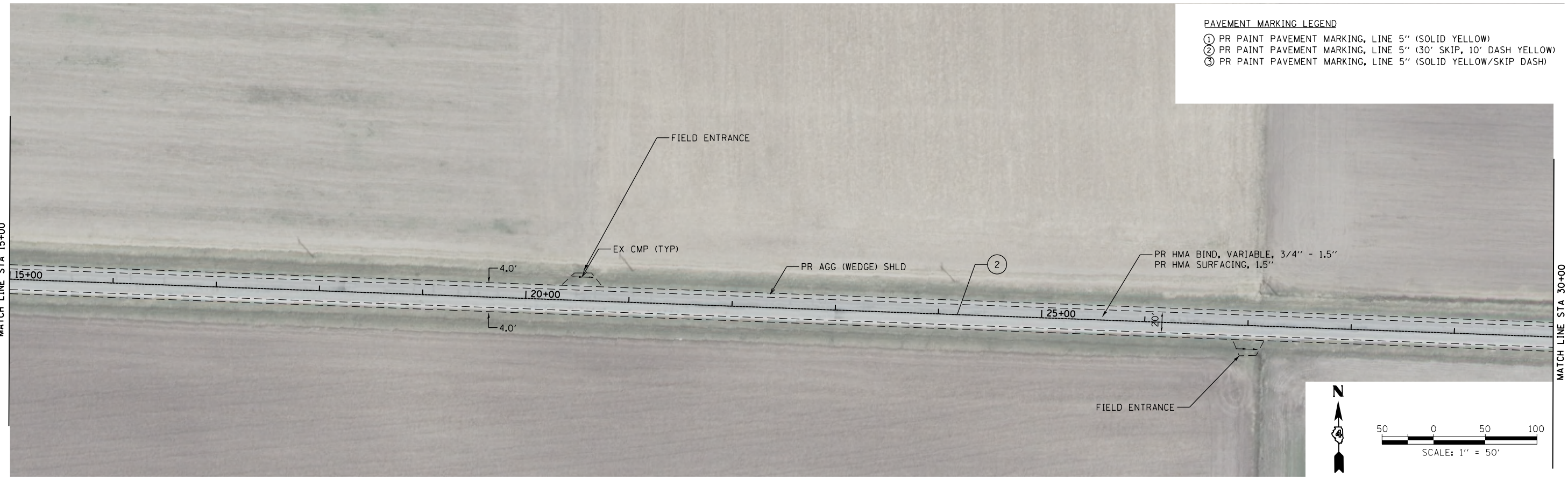

- PAVEMENT MARKING LEGEND**
- ① PR PAINT PAVEMENT MARKING, LINE 5" (SOLID YELLOW)
 - ② PR PAINT PAVEMENT MARKING, LINE 5" (30' SKIP, 10' DASH YELLOW)
 - ③ PR PAINT PAVEMENT MARKING, LINE 5" (SOLID YELLOW/SKIP DASH)

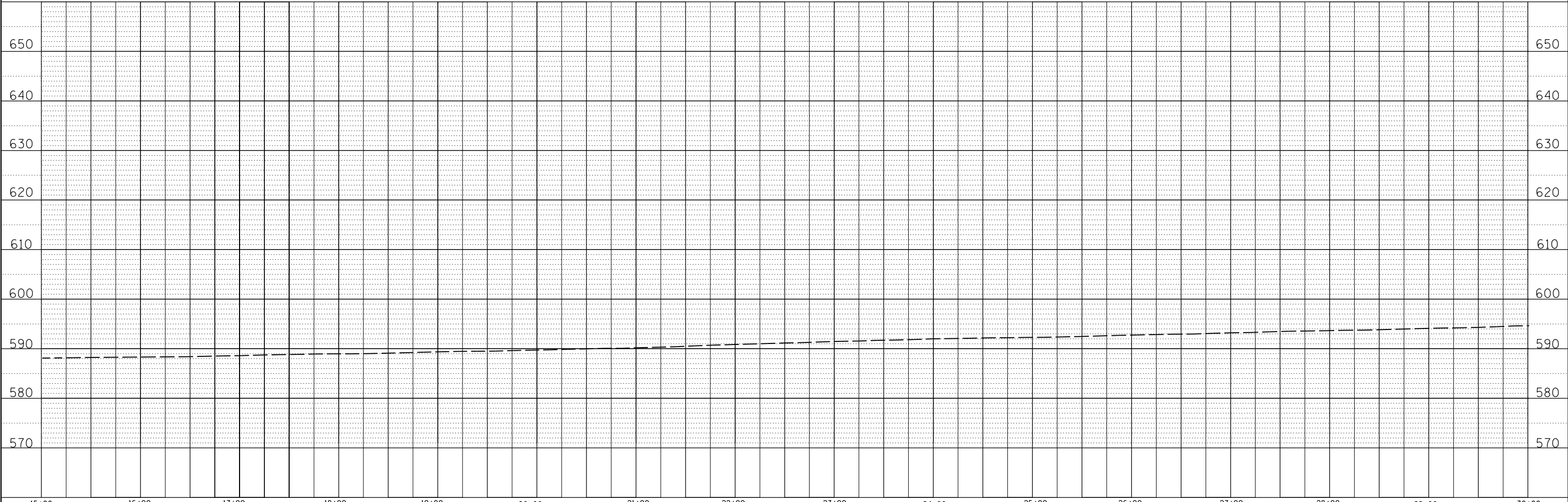
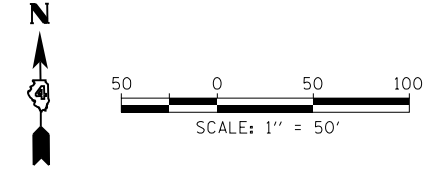

KLINGNER & ASSOCIATES, P.C. Engineers • Architects • Surveyors 616 N. 24TH ST. QUINCY, ILLINOIS 62301 217.223.3670 STATE OF ILLINOIS DESIGN FIRM NO. 184-2738	USER NAME =	DESIGNED MCL	REVISED -	MCDONOUGH COUNTY HIGHWAY DEPARTMENT	FAS 435 (COUNTY HIGHWAY 24) PLAN AND PROFILE			F.A.S.	SECTION	COUNTY	TOTAL SHEETS	SHEET NO.
	DRAWN MCL	REVISED -	435					19-00111-00-RS	MCDONOUGH	20	7	
	PLOT SCALE =	CHECKED EBB	REVISED -					CONTRACT NO. 89788				
	PLOT DATE	DATE 8/10/20	REVISED -					ILLINOIS FED. AID PROJECT				
				SCALE: 1"=50'	SHEET 2 OF 14 SHEETS	STA. 15+00 TO STA. 30+00						

PLAN	SURVEYED	DATE
	PLOTTED	BY
	ALIGNED	
	CHECKED	
	FILED	
	NO.	
	FILE NAME	

PROFILE	SURVEYED	DATE
	PLOTTED	BY
	GRADES CHECKED	
	STRUCTURE	
	NOTATIS	
	CHPND	
	NO.	

- PAVEMENT MARKING LEGEND
- ① PR PAINT PAVEMENT MARKING, LINE 5" (SOLID YELLOW)
 - ② PR PAINT PAVEMENT MARKING, LINE 5" (30' SKIP, 10' DASH YELLOW)
 - ③ PR PAINT PAVEMENT MARKING, LINE 5" (SOLID YELLOW/SKIP DASH)

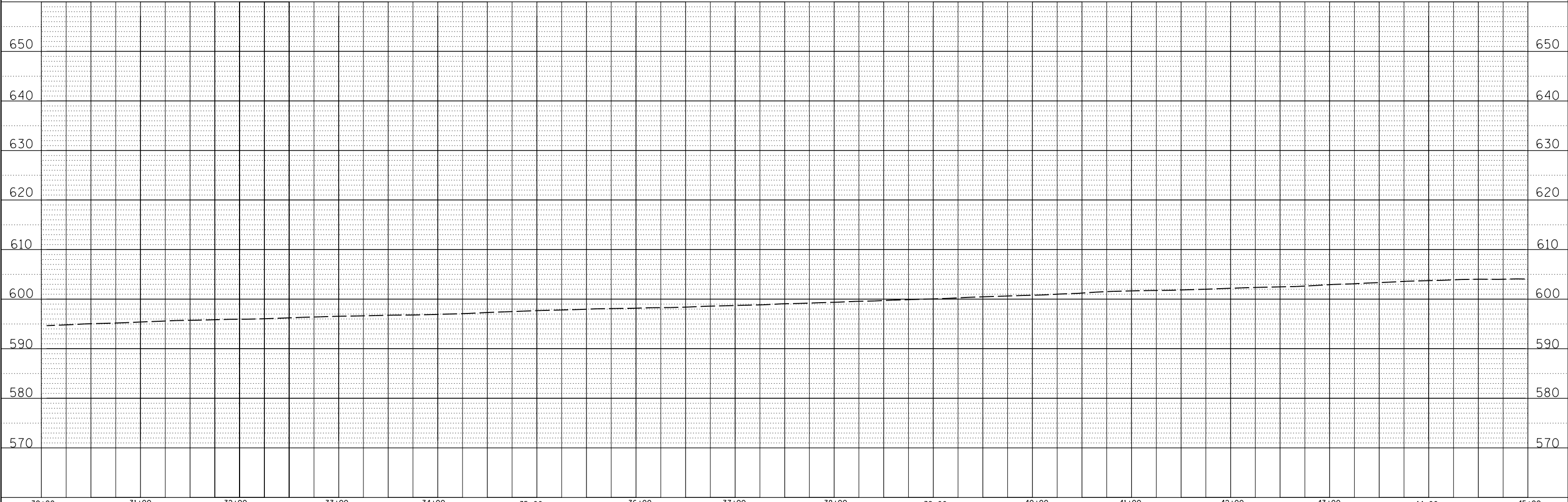
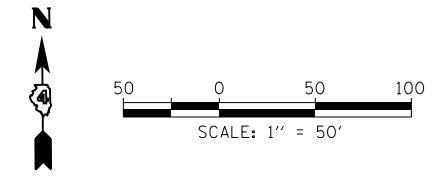

KLINGNER & ASSOCIATES, P.C. Engineers • Architects • Surveyors 616 N. 24TH ST. QUINCY, ILLINOIS 62301 217.223.3670 STATE OF ILLINOIS DESIGN FIRM NO. 184-2738	USER NAME =	DESIGNED MCL	REVISED -	MCDONOUGH COUNTY HIGHWAY DEPARTMENT	FAS 435 (COUNTY HIGHWAY 24)				F.A.S.	SECTION	COUNTY	TOTAL SHEETS	SHEET NO.
		DRAWN MCL	REVISED -		PLAN AND PROFILE				435	19-00111-00-RS	MCDONOUGH	20	8
	PLOT SCALE =	CHECKED EBB	REVISED -		SCALE: 1"=50' SHEET 3 OF 14 SHEETS STA. 30+00 TO STA. 45+00				CONTRACT NO. 89788				
	PLOT DATE	DATE 8/10/20	REVISED -		ILLINOIS FED. AID PROJECT								

PLAN	SURVEYED	DATE
	PLOTTED	
	CHECKED	
	BY	
	NO.	

PROFILE	SURVEYED	DATE
	PLOTTED	
	CHECKED	
	BY	
	NO.	

PAVEMENT MARKING LEGEND

- ① PR PAINT PAVEMENT MARKING, LINE 5" (SOLID YELLOW)
- ② PR PAINT PAVEMENT MARKING, LINE 5" (30' SKIP, 10' DASH YELLOW)
- ③ PR PAINT PAVEMENT MARKING, LINE 5" (SOLID YELLOW/SKIP DASH)

PROP. CURVE CNTYHWY241
 PI STA. = 53+93.32
 $\Delta = 4^\circ 44' 13''$ (RT)
 $D = 1^\circ 54' 35''$
 $R = 3,000.00'$
 $T = 124.08'$
 $L = 248.02'$
 $E = 2.56'$
 $e = \text{---}$
 $T.R. = \text{---}$
 $S.E. \text{ RUN} = \text{---}$
 $P.C. \text{ STA.} = 52+69.24$
 $P.T. \text{ STA.} = 55+17.27$

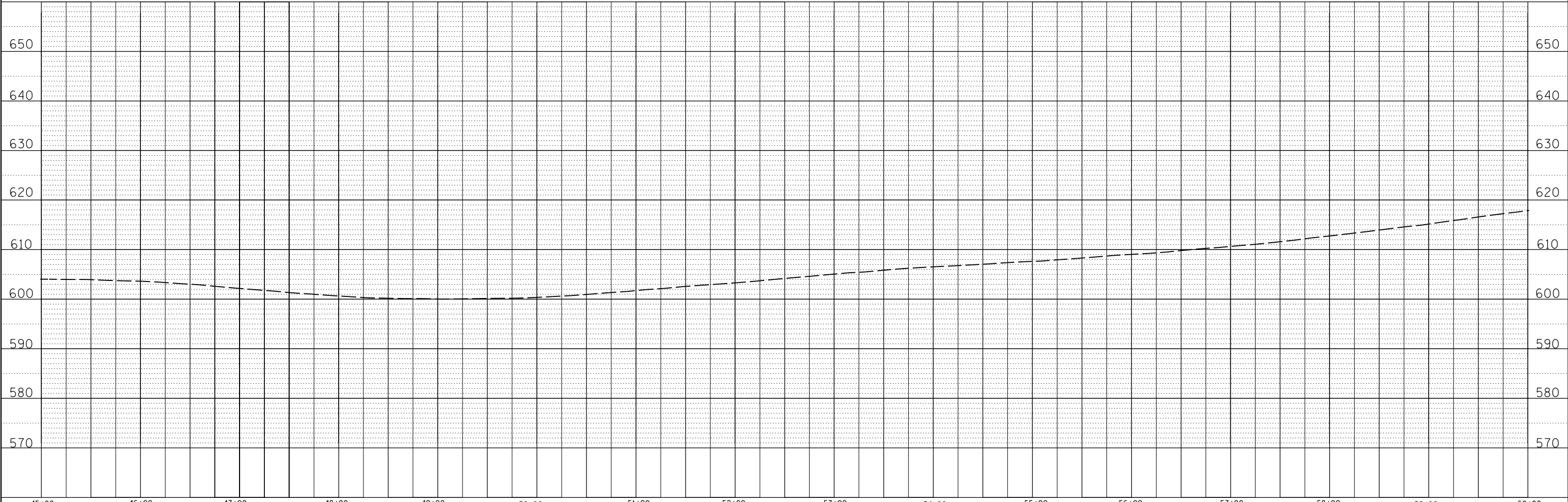
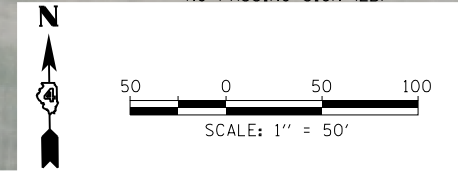

KLINGNER & ASSOCIATES, P.C. Engineers • Architects • Surveyors 616 N. 24TH ST. QUINCY, ILLINOIS 62301 217.223.9670 STATE OF ILLINOIS DESIGN FIRM NO. 184-2738	USER NAME =	DESIGNED MCL	REVISED -	MCDONOUGH COUNTY HIGHWAY DEPARTMENT	FAS 435 (COUNTY HIGHWAY 24) PLAN AND PROFILE			F.A.S.	SECTION	COUNTY	TOTAL SHEETS	SHEET NO.
	DRAWN MCL	REVISED -	435					19-00111-00-RS	MCDONOUGH	20	9	
	PLOT SCALE =	CHECKED EBB	REVISED -					CONTRACT NO. 89788				
	PLOT DATE	DATE 8/10/20	REVISED -					ILLINOIS FED. AID PROJECT				

SCALE: 1"=50' SHEET 4 OF 14 SHEETS STA. 45+00 TO STA. 60+00

PLAN	SURVEYED	DATE
	PLOTTED	BY
	ALIGNED	
	CHECKED	
	FILED	
	CARD FILE NAME	
	NO.	

PROFILE	SURVEYED	DATE
	PLOTTED	BY
	GRADES CHECKED	
	STRUCTURE NOTATIONS CHECKED	
	NO.	

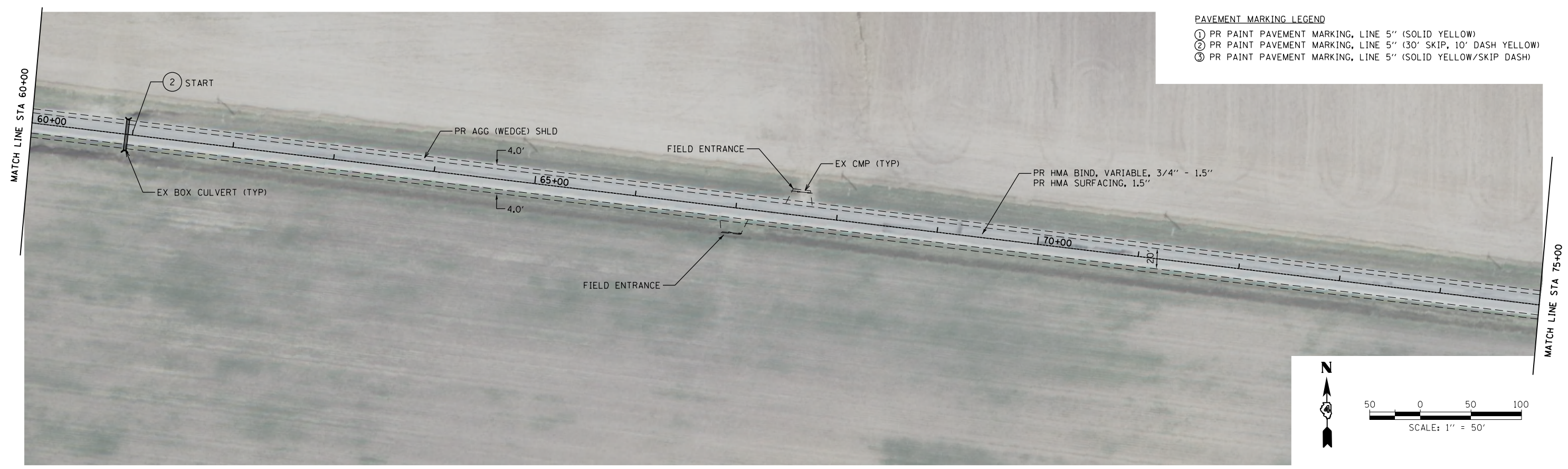

- PAVEMENT MARKING LEGEND**
- ① PR PAINT PAVEMENT MARKING, LINE 5" (SOLID YELLOW)
 - ② PR PAINT PAVEMENT MARKING, LINE 5" (30' SKIP, 10' DASH YELLOW)
 - ③ PR PAINT PAVEMENT MARKING, LINE 5" (SOLID YELLOW/SKIP DASH)

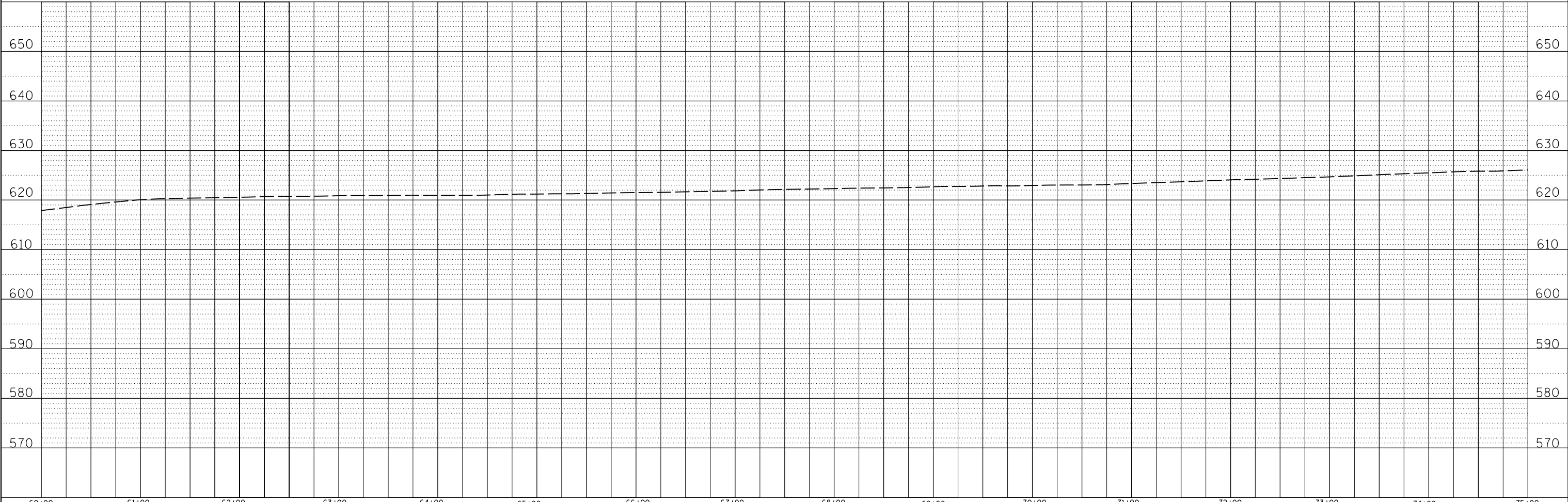
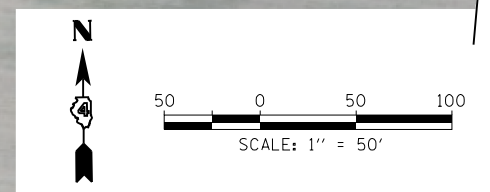

KLINGNER & ASSOCIATES, P.C. Engineers • Architects • Surveyors 616 N. 24TH ST. QUINCY, ILLINOIS 62301 217.223.3670 STATE OF ILLINOIS DESIGN FIRM NO. 184-2738	USER NAME =	DESIGNED MCL	REVISED -	MCDONOUGH COUNTY HIGHWAY DEPARTMENT	FAS 435 (COUNTY HIGHWAY 24) PLAN AND PROFILE				F.A.S.	SECTION	COUNTY	TOTAL SHEETS	SHEET NO.
	DRAWN MCL	REVISIED -	435		19-00111-00-RS	MCDONOUGH	20	10					
	PLOT SCALE =	CHECKED EBB	REVISED -		SCALE: 1"=50' SHEET 5 OF 14 SHEETS STA. 60+00 TO STA. 75+00				CONTRACT NO. 89788				
	PLOT DATE	DATE 8/10/20	REVISED -		ILLINOIS FED. AID PROJECT								

PLAN	SURVEYED	DATE
	PLOTTED	BY
	ALIGNED	
	CHECKED	
	FILED	
	FILE NAME	
	NO.	

PROFILE	SURVEYED	DATE
	PLOTTED	BY
	GRADES CHECKED	
	STRUCTURE	NOT AT THIS OFFICE
	NO.	

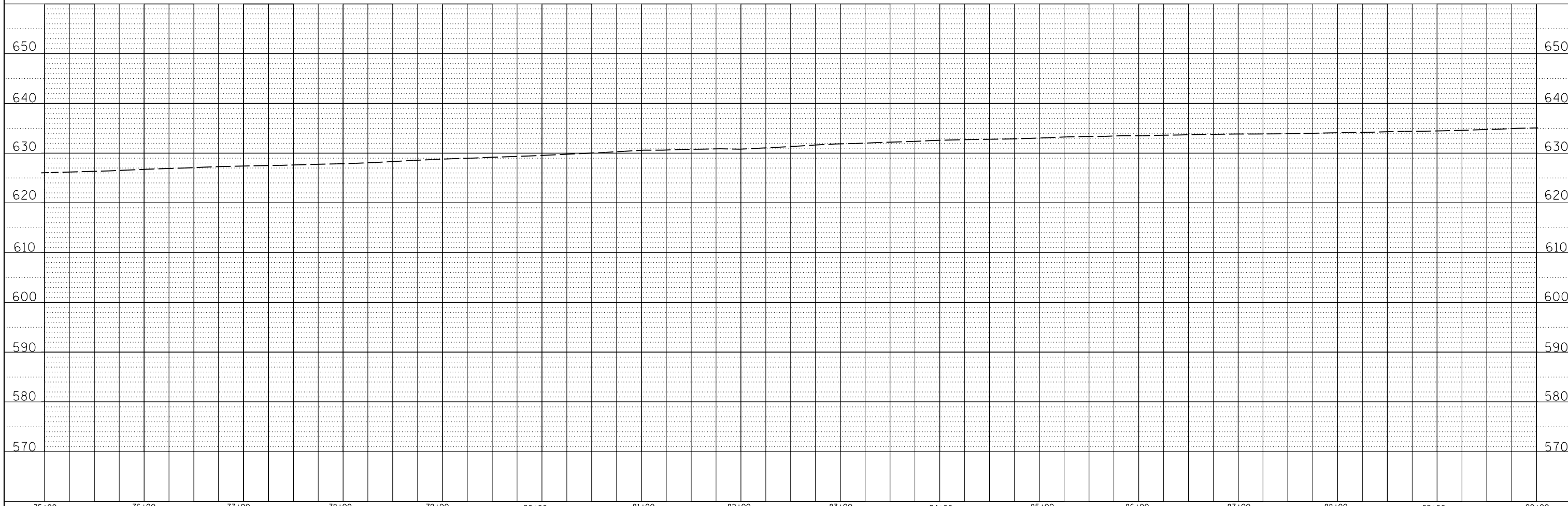
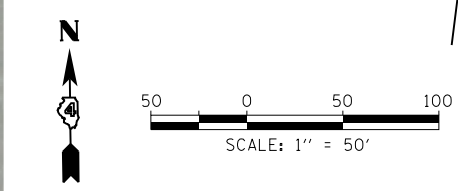
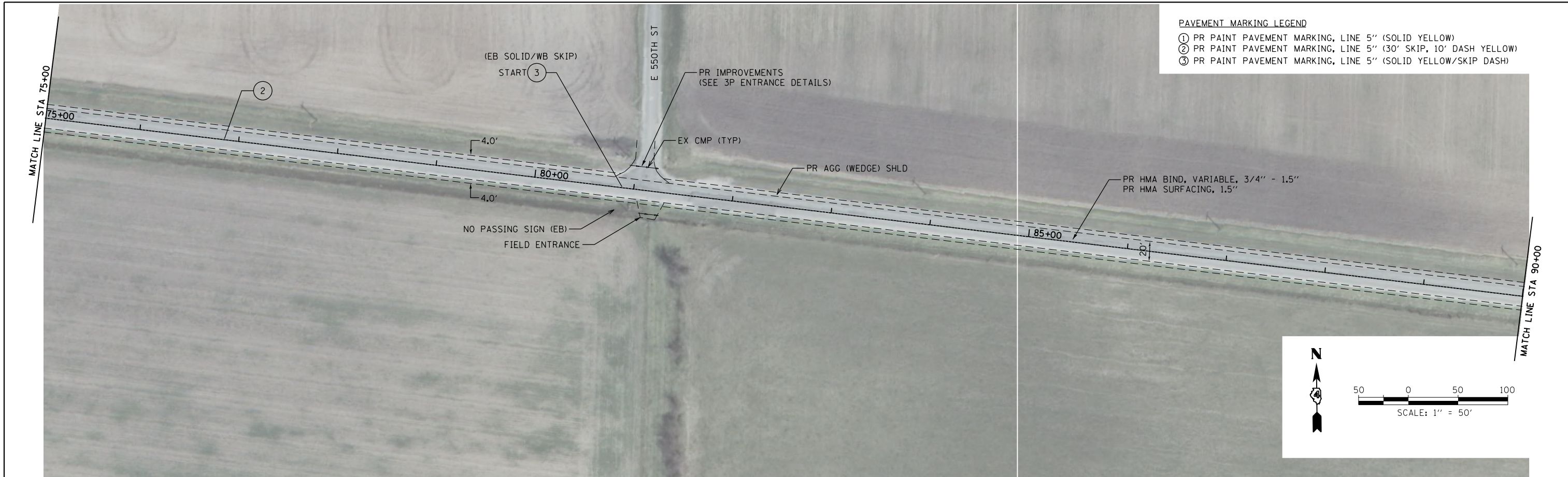

KLINGNER & ASSOCIATES, P.C. Engineers • Architects • Surveyors 615 N. 24TH ST. QUINCY, ILLINOIS 62301 217.223.3670 STATE OF ILLINOIS DESIGN FIRM NO. 184-2738	USER NAME =	DESIGNED MCL	REVISED -	MCDONOUGH COUNTY HIGHWAY DEPARTMENT	FAS 435 (COUNTY HIGHWAY 24) PLAN AND PROFILE			F.A.S.	SECTION	COUNTY	TOTAL SHEETS	SHEET NO.	
		DRAWN MCL	REVISED -		435	19-00111-00-RS	MCDONOUGH	20	11				
	PLOT SCALE =	CHECKED EBB	REVISED -		SCALE: 1"=50'			SHEET 6 OF 14 SHEETS STA. 75+00 TO STA. 90+00			CONTRACT NO. 89788		
	PLOT DATE	DATE 8/10/20	REVISED -		ILLINOIS FED. AID PROJECT								

PLAN	SURVEYED	DATE
	PLOTTED	
	CHECKED	
	FILED	
	NO.	

PROFILE	SURVEYED	DATE
	PLOTTED	
	CHECKED	
	FILED	
	NO.	

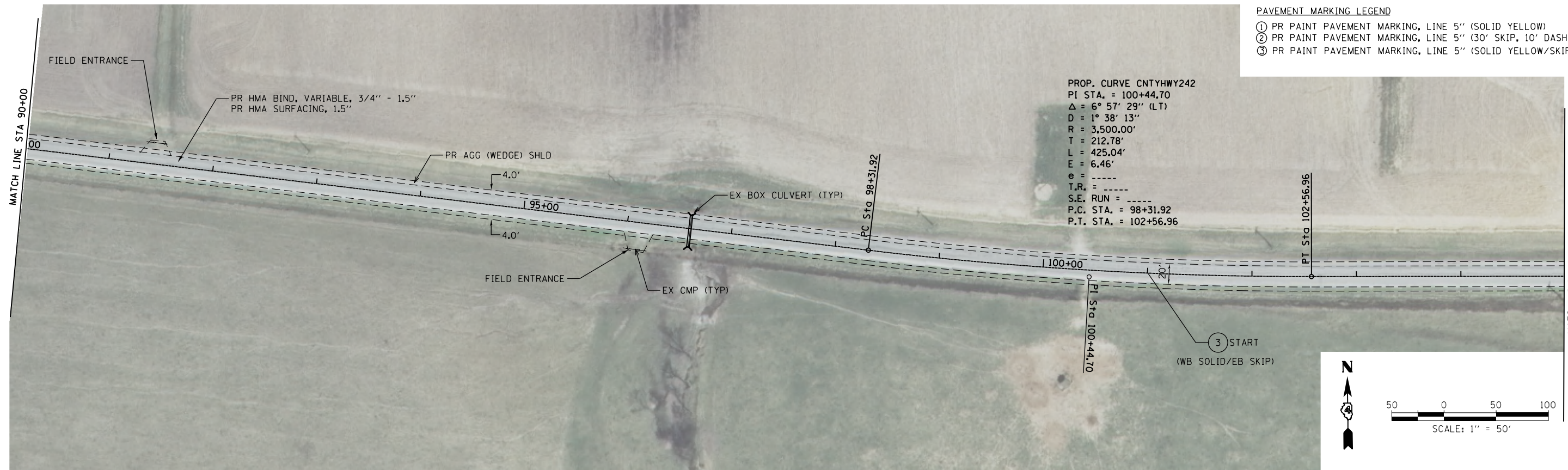

- PAVEMENT MARKING LEGEND**
- ① PR PAINT PAVEMENT MARKING, LINE 5" (SOLID YELLOW)
 - ② PR PAINT PAVEMENT MARKING, LINE 5" (30' SKIP, 10' DASH YELLOW)
 - ③ PR PAINT PAVEMENT MARKING, LINE 5" (SOLID YELLOW/SKIP DASH)

PROP. CURVE CNTYHWY242
 PI STA. = 100+44.70
 $\Delta = 6^\circ 57' 29''$ (LT)
 D = $1^\circ 38' 13''$
 R = 3,500.00'
 T = 212.78'
 L = 425.04'
 E = 6.46'
 e = -----
 T.R. = -----
 S.E. RUN = -----
 P.C. STA. = 98+31.92
 P.T. STA. = 102+56.96

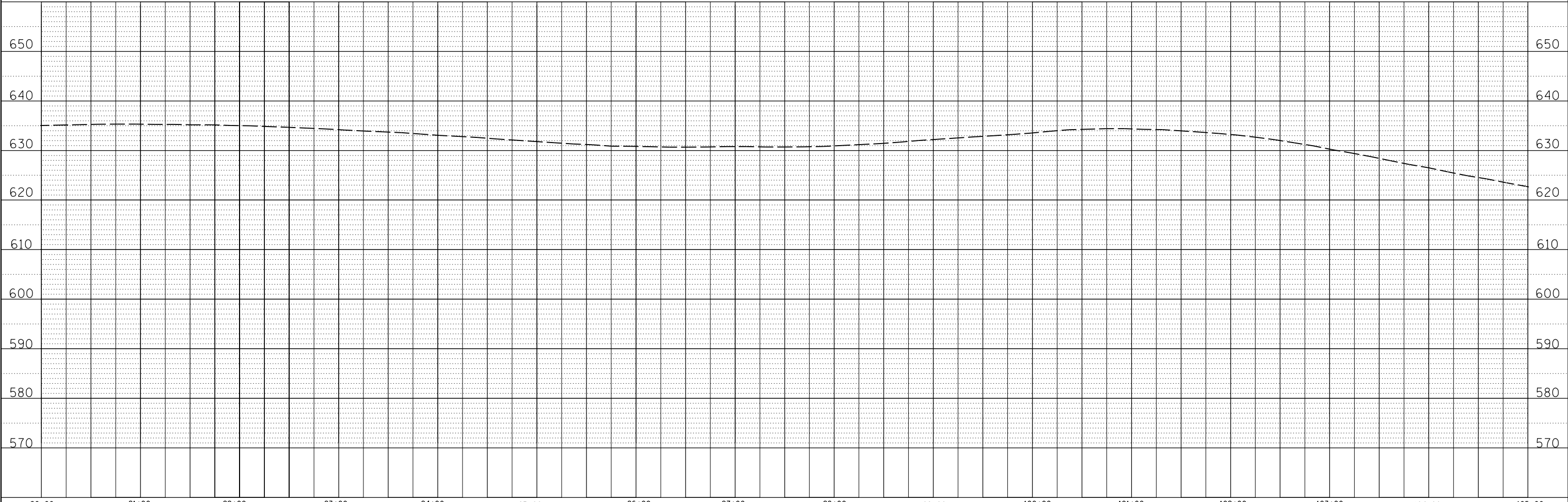
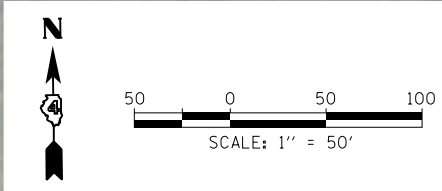

KLINGNER & ASSOCIATES, P.C. Engineers • Architects • Surveyors 616 N. 24TH ST. QUINCY, ILLINOIS 62301 217.223.3670 STATE OF ILLINOIS DESIGN FIRM NO. 184-2738	USER NAME =	DESIGNED MCL	REVISED -	MCDONOUGH COUNTY HIGHWAY DEPARTMENT	FAS 435 (COUNTY HIGHWAY 24)			F.A.S.	SECTION	COUNTY	TOTAL SHEETS	SHEET NO.
	DRAWN MCL	REVISED -	PLAN AND PROFILE			435	19-00111-00-RS	MCDONOUGH	20	12		
	PLOT SCALE =	CHECKED EBB	REVISED -		SCALE: 1"=50' SHEET 7 OF 14 SHEETS STA. 90+00 TO STA. 105+00			CONTRACT NO. 89788				
	PLOT DATE	DATE 8/10/20	REVISED -		ILLINOIS FED. AID PROJECT							

PLAN	SURVEYED	DATE
	PLOTTED	BY
	ALIGNED	
	CHECKED	
	FILED	
	CARD FILE NAME	
	NO.	

PROFILE	SURVEYED	DATE
	PLOTTED	BY
	GRADES CHECKED	
	STRUCTURE	NOT AT THIS OFFICE
	NO.	

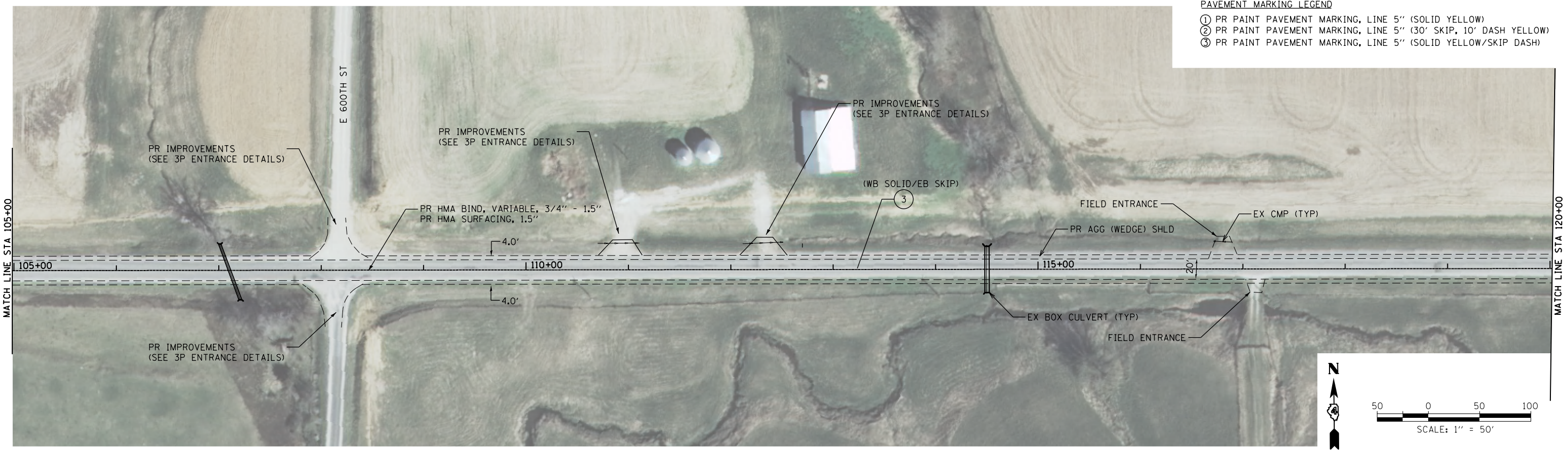

- PAVEMENT MARKING LEGEND**
- ① PR PAINT PAVEMENT MARKING, LINE 5" (SOLID YELLOW)
 - ② PR PAINT PAVEMENT MARKING, LINE 5" (30' SKIP, 10' DASH YELLOW)
 - ③ PR PAINT PAVEMENT MARKING, LINE 5" (SOLID YELLOW/SKIP DASH)

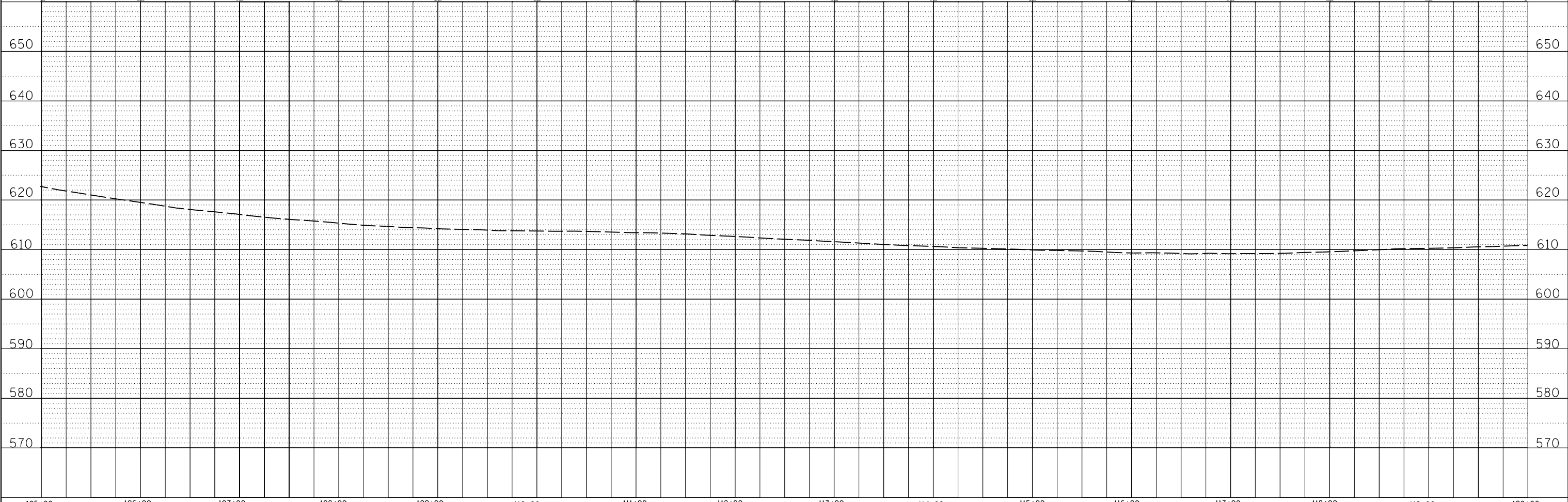
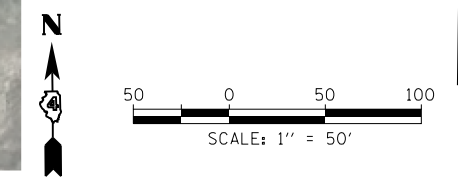

105+00	106+00	107+00	108+00	109+00	110+00	111+00	112+00	113+00	114+00	115+00	116+00	117+00	118+00	119+00	120+00
KLINGNER & ASSOCIATES, P.C. Engineers • Architects • Surveyors 616 N. 24TH ST. QUINCY, ILLINOIS 62301 217.223.3670 STATE OF ILLINOIS DESIGN FIRM NO. 184-2738				USER NAME = DESIGNED MCL DRAWN MCL CHECKED EBB DATE 8/10/20	REVISED - REVISED - REVISED - REVISED -	MCDONOUGH COUNTY HIGHWAY DEPARTMENT				FAS 435 (COUNTY HIGHWAY 24) PLAN AND PROFILE				F.A.S. 435 SECTION 19-00111-00-RS COUNTY MCDONOUGH CONTRACT NO. 89788	TOTAL SHEETS 20 SHEET NO. 13
SCALE: 1"=50'										SHEET 8 OF 14 SHEETS		STA. 105+00 TO STA. 115+00		ILLINOIS FED. AID PROJECT	

PLAN	SURVEYED	BY	DATE
	PLOTTED		
	GRADES CHECKED		
	STRUCTURE NOTATIONS CHECKED		
	NOTE BOOK NO.		
	FIELD FILE NAME		

PROFILE	SURVEYED	BY	DATE
	PLOTTED		
	GRADES CHECKED		
	STRUCTURE NOTATIONS CHECKED		
	NOTE BOOK NO.		
	FIELD FILE NAME		

- PAVEMENT MARKING LEGEND**
- ① PR PAINT PAVEMENT MARKING, LINE 5" (SOLID YELLOW)
 - ② PR PAINT PAVEMENT MARKING, LINE 5" (30' SKIP, 10' DASH YELLOW)
 - ③ PR PAINT PAVEMENT MARKING, LINE 5" (SOLID YELLOW/SKIP DASH)

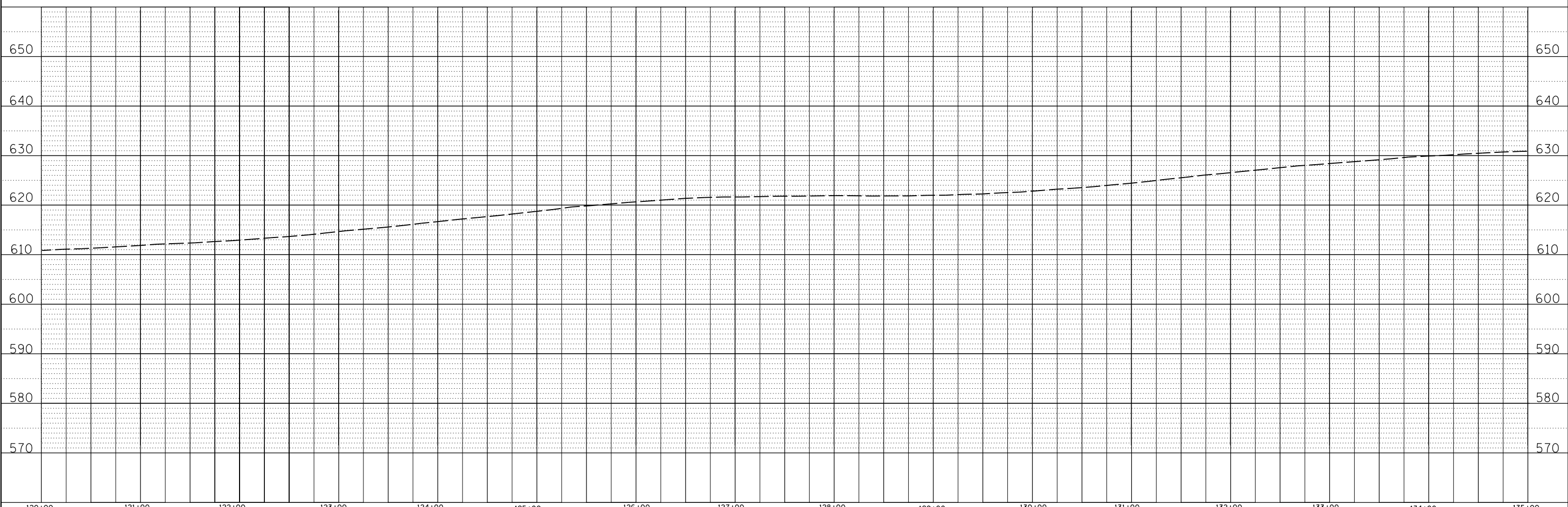
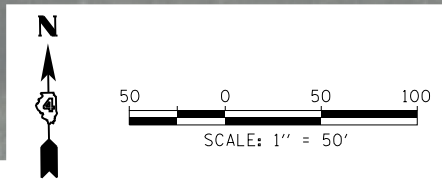
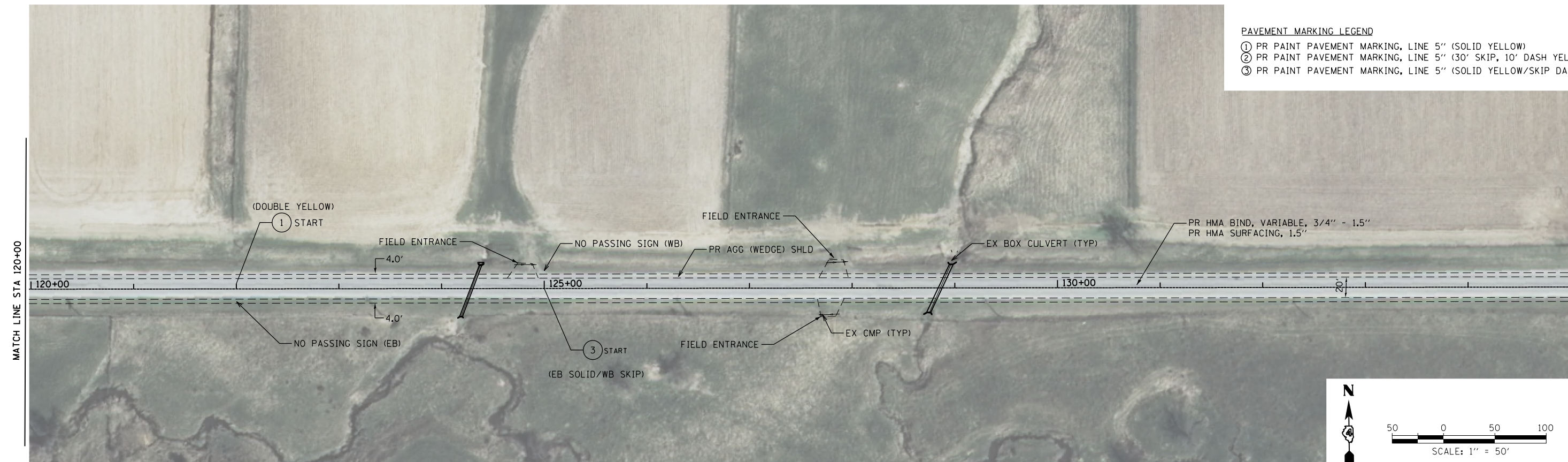

KLINGNER & ASSOCIATES, P.C. Engineers • Architects • Surveyors 616 N. 24TH ST. QUINCY, ILLINOIS 62301 217.223.3670 STATE OF ILLINOIS DESIGN FIRM NO. 184-2738	USER NAME =	DESIGNED MCL	REVISED -	MCDONOUGH COUNTY HIGHWAY DEPARTMENT	FAS 435 (COUNTY HIGHWAY 24) PLAN AND PROFILE				F.A.S.	SECTION	COUNTY	TOTAL SHEETS	SHEET NO.
		DRAWN MCL	REVISED -		435	19-00111-00-RS	MCDONOUGH	20	14				
	PLOT SCALE =	CHECKED EBB	REVISED -		SCALE: 1"=50' SHEET 9 OF 14 SHEETS STA. 120+00 TO STA. 135+00				CONTRACT NO. 89788				
	PLOT DATE	DATE 8/10/20	REVISED -		ILLINOIS FED. AID PROJECT								

PLAN	SURVEYED	DATE
	PLOTTED	BY
	ALIGNED	
	CHECKED	
	FILED	
	FILE NAME	
	NO.	

PROFILE	SURVEYED	DATE
	PLOTTED	BY
	GRADES CHECKED	
	STRUCTURE	NOT AT THIS OFFICE
	NO.	

PAVEMENT MARKING LEGEND

- ① PR PAINT PAVEMENT MARKING, LINE 5" (SOLID DOUBLE YELLOW)
- ② PR PAINT PAVEMENT MARKING, LINE 5" (30' SKIP, 10' DASH YELLOW)
- ③ PR PAINT PAVEMENT MARKING, LINE 5" (SOLID YELLOW/SKIP DASH)

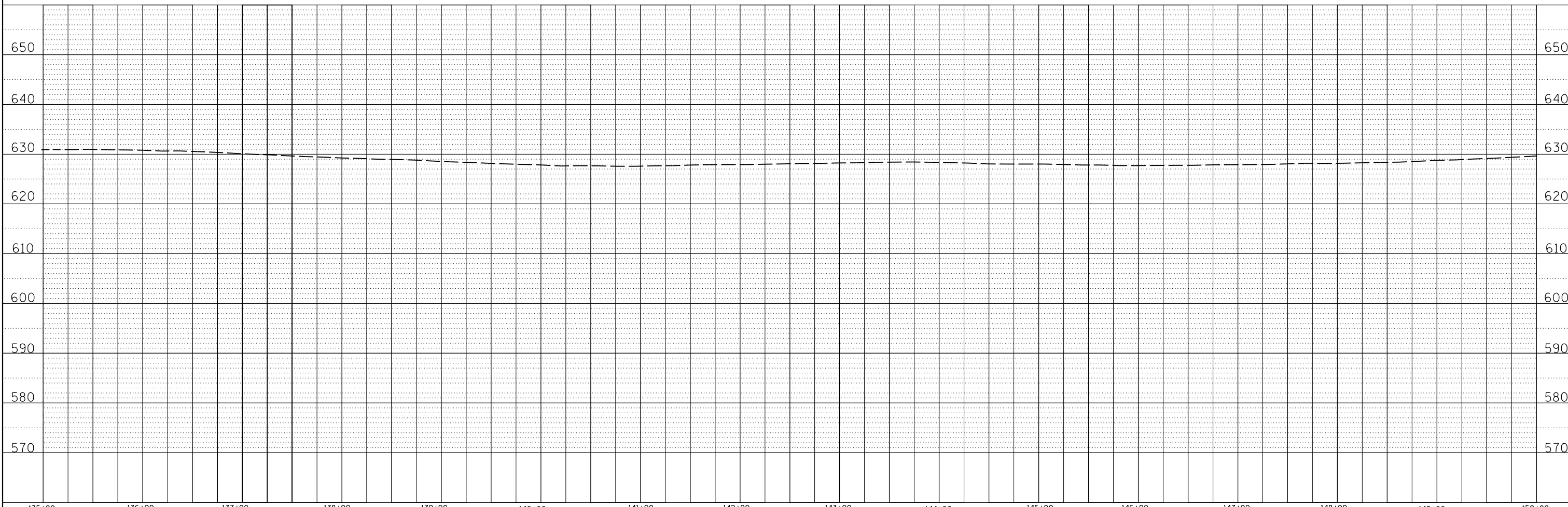
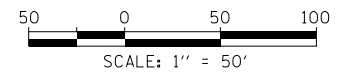
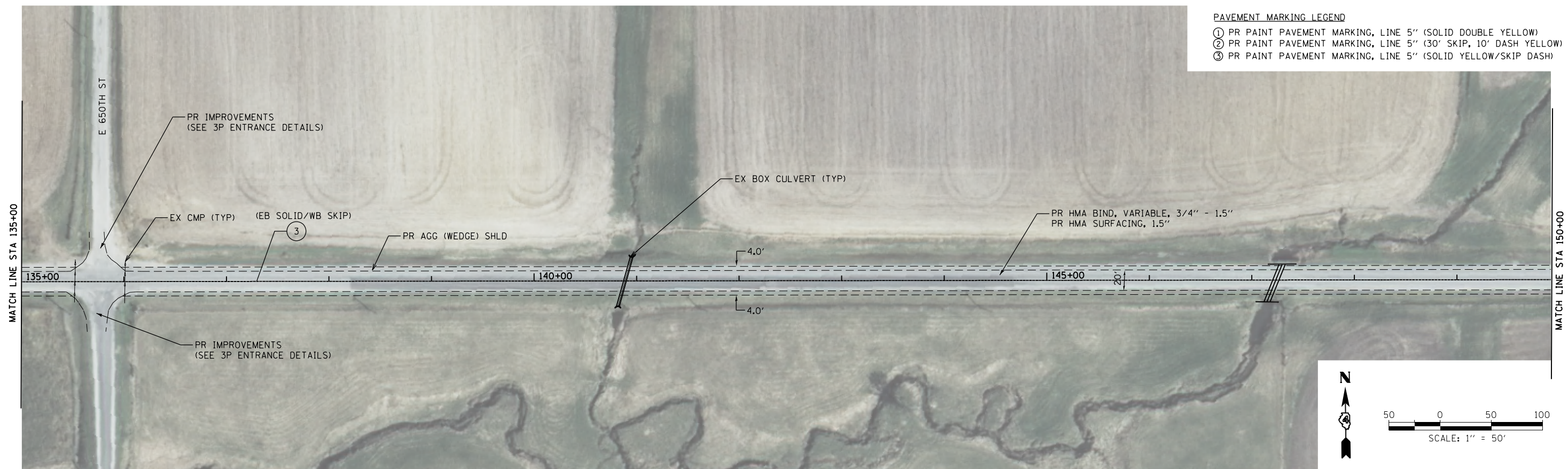

KLINGNER & ASSOCIATES, P.C. Engineers • Architects • Surveyors 616 N. 24TH ST. QUINCY, ILLINOIS 62301 217.223.3670 STATE OF ILLINOIS DESIGN FIRM NO. 184-2738	USER NAME =	DESIGNED MCL	REVISED -	MCDONOUGH COUNTY HIGHWAY DEPARTMENT	FAS 435 (COUNTY HIGHWAY 24) PLAN AND PROFILE				F.A.S.	SECTION	COUNTY	TOTAL SHEETS	SHEET NO.
		DRAWN MCL	REVISED -		435	19-00111-00-RS	MCDONOUGH	20	15				
	PLOT SCALE =	CHECKED EBB	REVISED -		SCALE: 1"=50'				SHEET 10 OF 14 SHEETS STA. 135+00 TO STA. 150+00				
	PLOT DATE	DATE 8/10/20	REVISED -		ILLINOIS FED. AID PROJECT								

PLAN	SURVEYED	DATE
	PLOTTED	
	ALIGNED	
	CHECKED	
	FILED	
	NO.	

PROFILE	SURVEYED	DATE
	PLOTTED	
	GRADES	
	CHECKED	
	STRUCTURE	
	NOTATIONS	
	NO.	

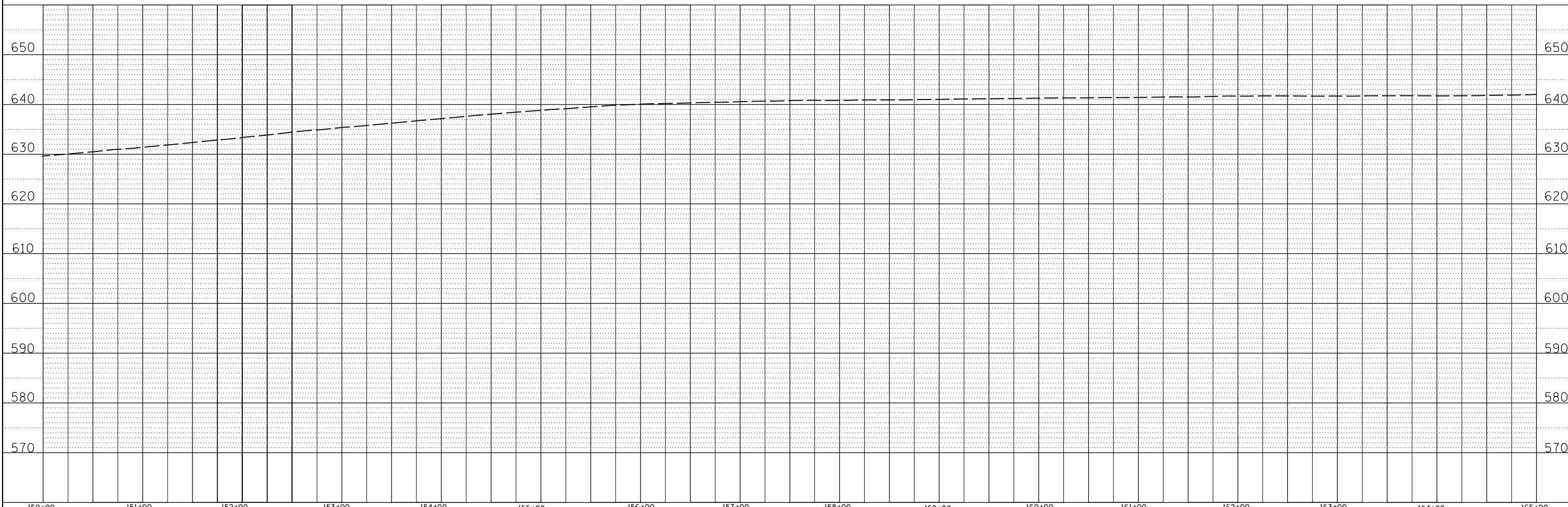
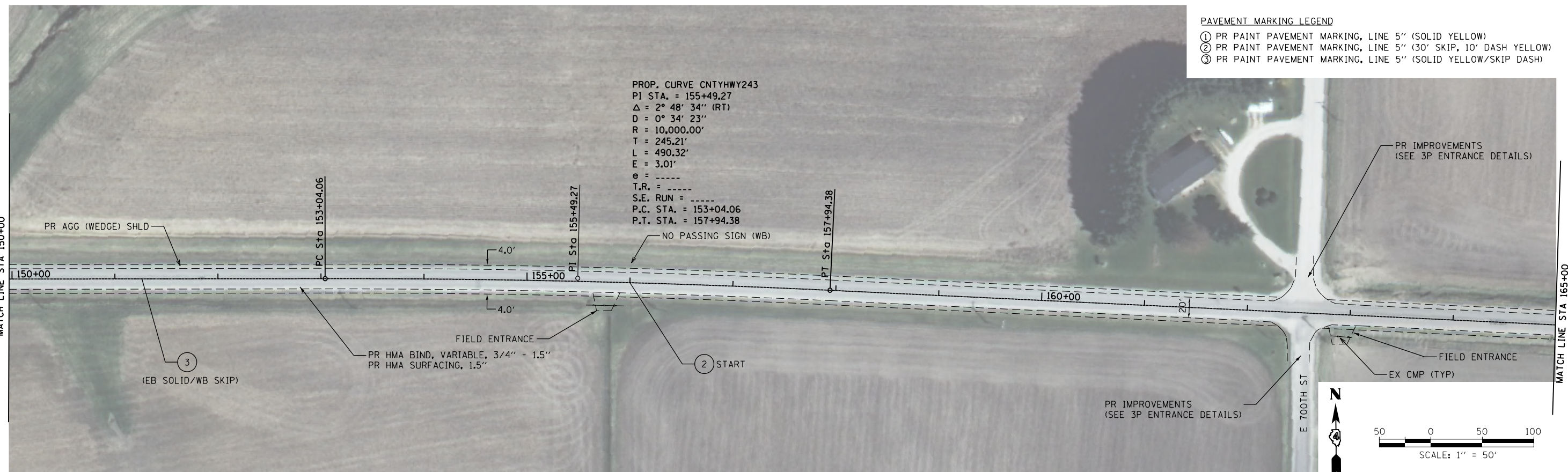

KLINGNER & ASSOCIATES, P.C. Engineers • Architects • Surveyors 616 N. 24TH ST., QUINCY, ILLINOIS 62301-2122, 618-297-7070 STATE OF ILLINOIS DESIGN FIRM NO. 184-2738	USER NAME =	DESIGNED MCL	REVISED -	MCDONOUGH COUNTY HIGHWAY DEPARTMENT	FAS 435 (COUNTY HIGHWAY 24) PLAN AND PROFILE			F.A.S.	SECTION	COUNTY	TOTAL SHEETS	SHEET NO.
		DRAWN MCL	REVISED -		435	19-00111-00-RS	MCDONOUGH	20	16			
PLOT SCALE =	CHECKED EBB	REVISED -	SCALE: 1"=50'			SHEET 11 OF 14 SHEETS STA. 150+00 TO STA. 165+00			CONTRACT NO. 89788			
PLOT DATE	DATE 8/10/20	REVISED -	ILLINOIS FED. AID PROJECT									

PLAN	SURVEYED	DATE
	PLOTTED	BY
	ALIGNED	
	CHECKED	
	FILED	
	CARD FILE NAME	
NO.		

PROFILE	SURVEYED	DATE
	PLOTTED	BY
	GRADES CHECKED	
	STRUCTURE	NOT AT THIS OFFICE
NO.		

PAVEMENT MARKING LEGEND

- ① PR PAINT PAVEMENT MARKING, LINE 5" (SOLID YELLOW)
- ② PR PAINT PAVEMENT MARKING, LINE 5" (30' SKIP, 10' DASH YELLOW)
- ③ PR PAINT PAVEMENT MARKING, LINE 5" (SOLID YELLOW/SKIP DASH)

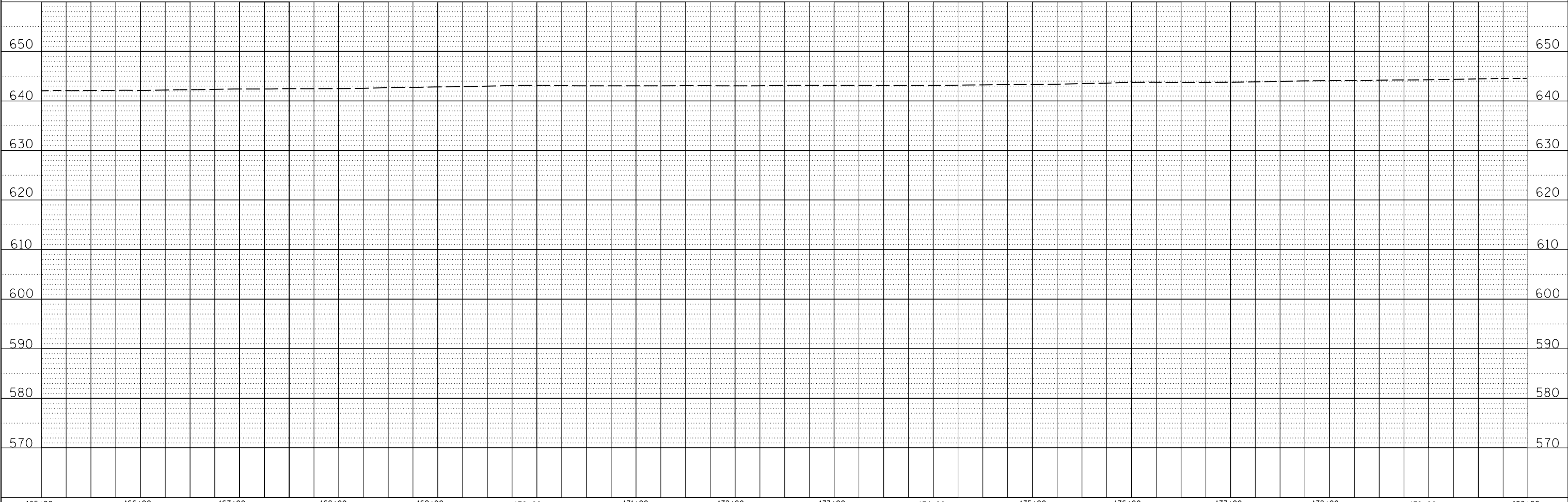
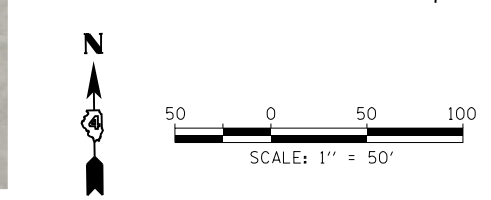
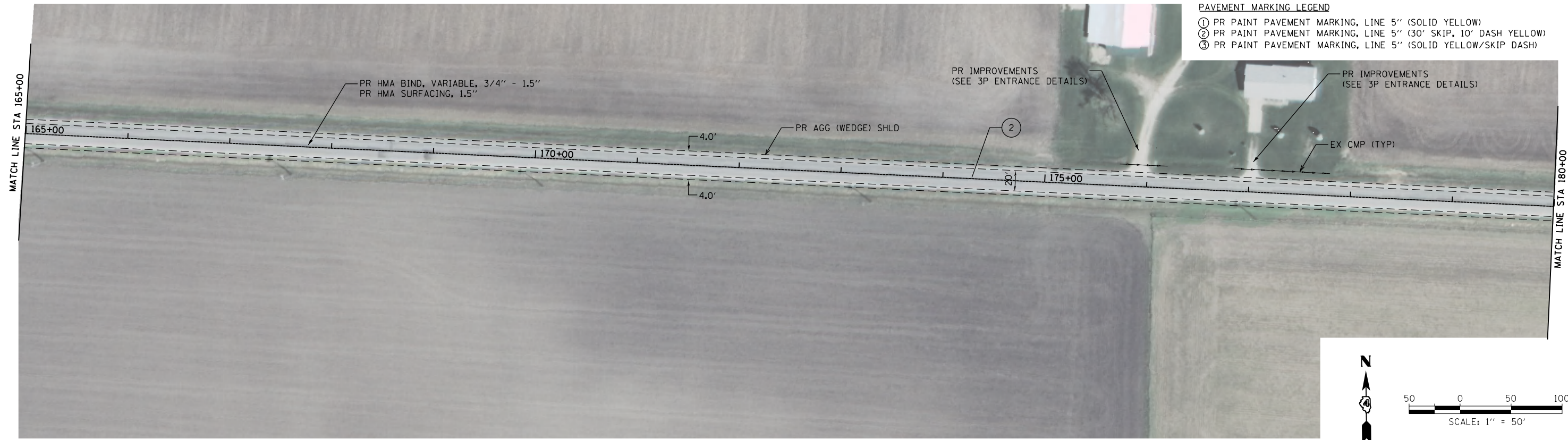

165+00	166+00	167+00	168+00	169+00	170+00	171+00	172+00	173+00	174+00	175+00	176+00	177+00	178+00	179+00	180+00
KLINGNER & ASSOCIATES, P.C. Engineers • Architects • Surveyors 615 N. 24TH ST. QUINCY, ILLINOIS 62301 217.223.3670 STATE OF ILLINOIS DESIGN FIRM NO. 184-2738			USER NAME = DESIGNED MCL DRAWN MCL CHECKED EBB DATE 8/10/20	REVISED - REVISED - REVISED - REVISED -	MCDONOUGH COUNTY HIGHWAY DEPARTMENT			FAS 435 (COUNTY HIGHWAY 24) PLAN AND PROFILE			F.A.S. 435 SECTION 19-00111-00-RS COUNTY MCDONOUGH CONTRACT NO. 89788	TOTAL SHEETS 20 SHEET NO. 17	SCALE: 1"=50' SHEET 12 OF 14 SHEETS STA. 165+00 TO STA. 180+00	ILLINOIS FED. AID PROJECT	

PLAN	SURVEYED	BY	DATE
	PLOTTED		
	ALIGNED		
	CHECKED		
	FILED		
	CADD FILE NAME		
	NO.		

PROFILE	SURVEYED	BY	DATE
	PLOTTED		
	GRADES CHECKED		
	STRUCTURE		
	NOTATIS		
	CIPAD		
	NO.		

- PAVEMENT MARKING LEGEND
- ① PR PAINT PAVEMENT MARKING, LINE 5" (SOLID YELLOW)
 - ② PR PAINT PAVEMENT MARKING, LINE 5" (30' SKIP, 10' DASH YELLOW)
 - ③ PR PAINT PAVEMENT MARKING, LINE 5" (SOLID YELLOW/SKIP DASH)

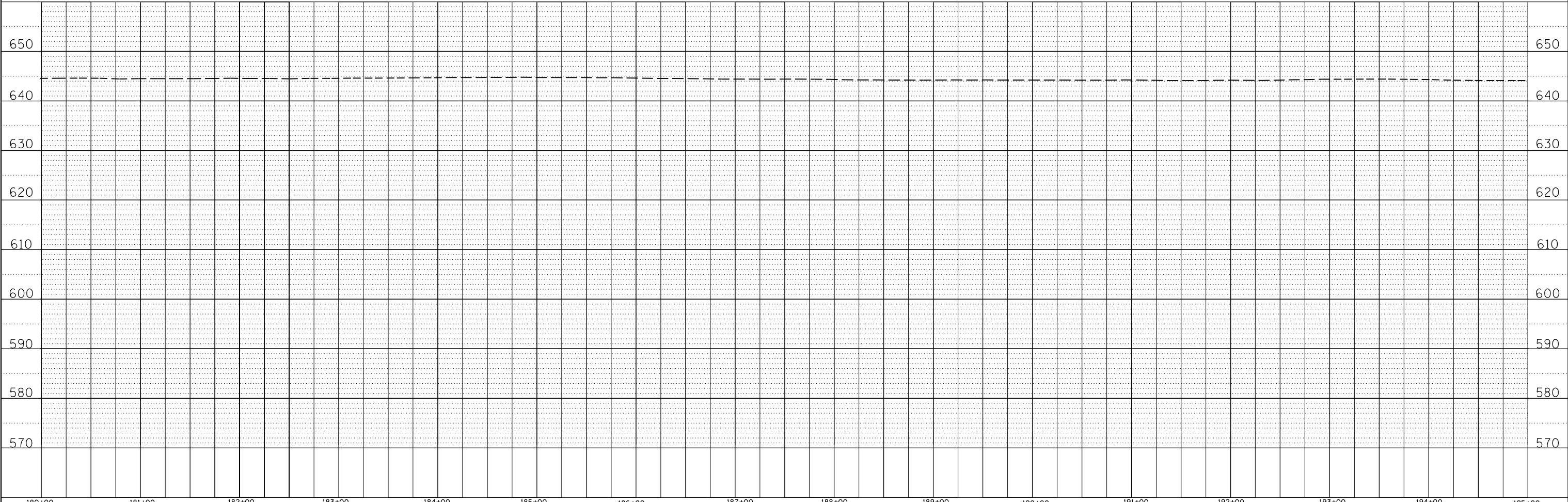
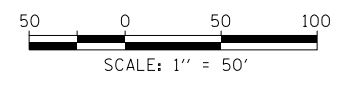
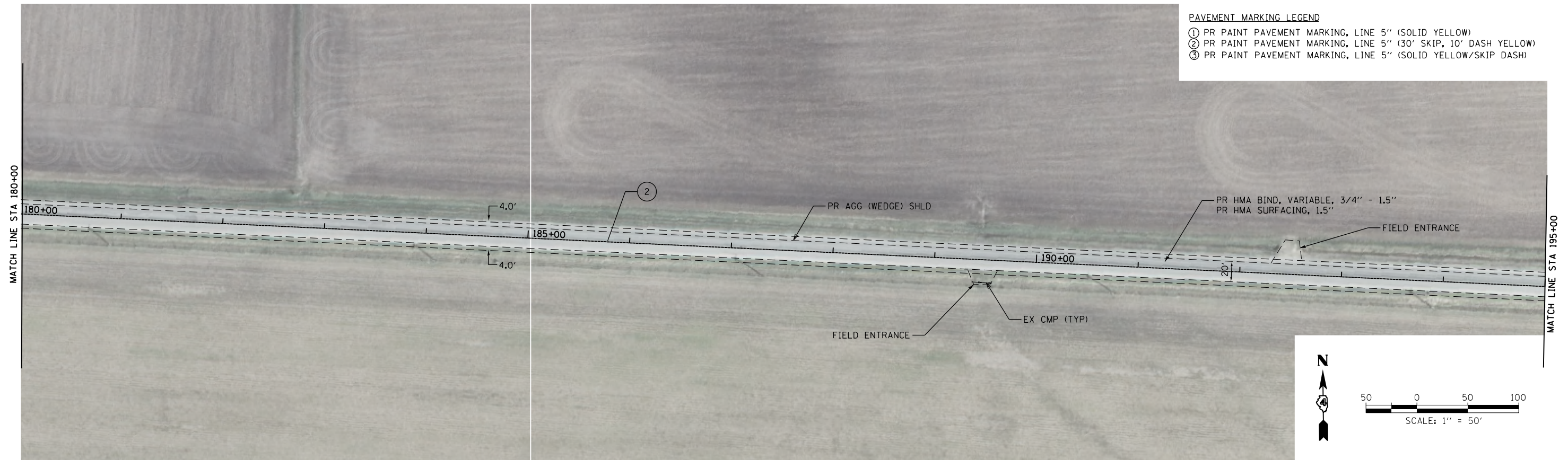

KLINGNER & ASSOCIATES, P.C. Engineers • Architects • Surveyors 616 N. 24TH ST. QUINCY, ILLINOIS 62301 217.223.3670 STATE OF ILLINOIS DESIGN FIRM NO. 184-2738	USER NAME =	DESIGNED MCL	REVISED -	MCDONOUGH COUNTY HIGHWAY DEPARTMENT	FAS 435 (COUNTY HIGHWAY 24) PLAN AND PROFILE				F.A.S.	SECTION	COUNTY	TOTAL SHEETS	SHEET NO.
	DRAWN MCL	REVISED -	SCALE: 1"=50'				435	19-00111-00-RS	MCDONOUGH	20	18		
	PLOT SCALE =	CHECKED EBB	REVISED -		SHEET 13 OF 14 SHEETS STA. 180+00 TO STA. 195+00				CONTRACT NO. 89788				
	PLOT DATE	DATE 8/10/20	REVISED -		ILLINOIS FED. AID PROJECT								

PLAN	SURVEYED	DATE
	PLOTTED	BY
	ALIGNED	
	CHECKED	
	FILED	
	FILE NAME	
	NO.	

PROFILE	SURVEYED	DATE
	PLOTTED	BY
	GRADES CHECKED	
	STRUCTURE NOTATIONS CHECKED	
	NO.	

- PAVEMENT MARKING LEGEND
- ① PR PAINT PAVEMENT MARKING, LINE 5" (SOLID YELLOW)
 - ② PR PAINT PAVEMENT MARKING, LINE 5" (30' SKIP, 10' DASH YELLOW)
 - ③ PR PAINT PAVEMENT MARKING, LINE 5" (SOLID YELLOW/SKIP DASH)

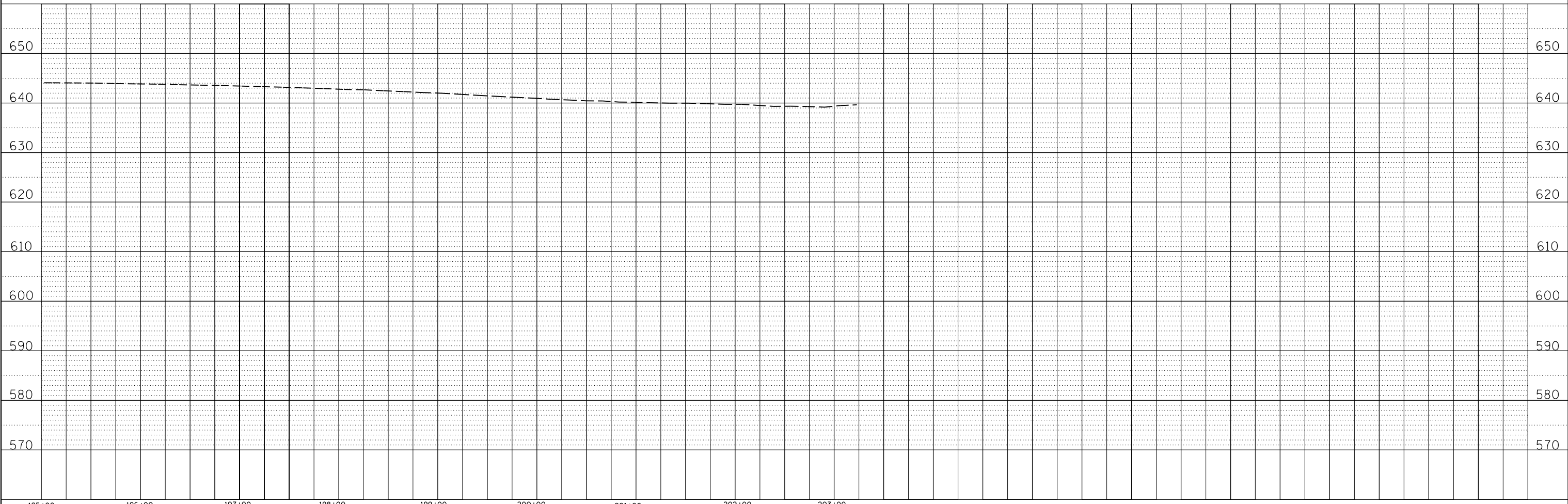
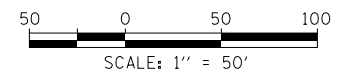
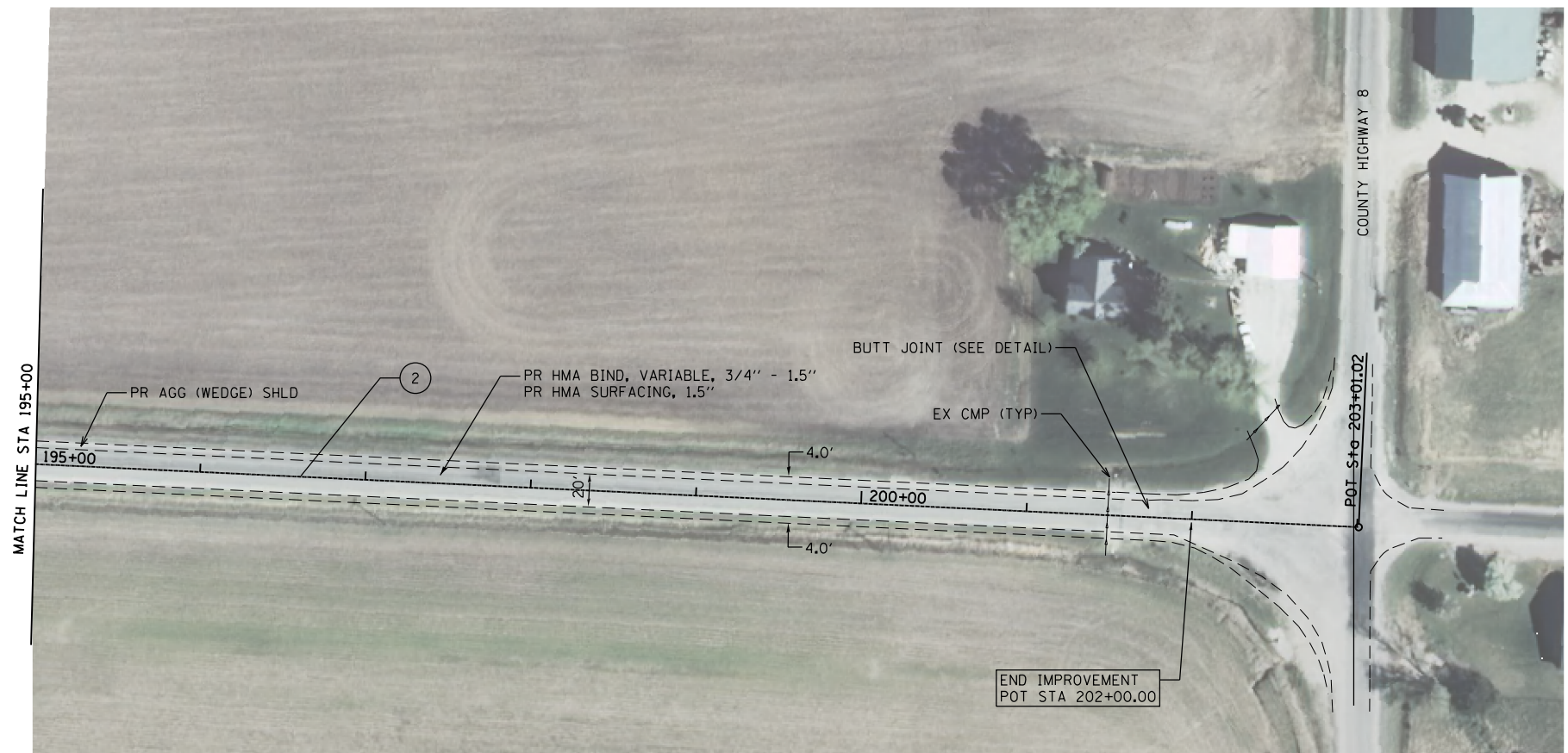

KLINGNER & ASSOCIATES, P.C. Engineers • Architects • Surveyors 616 N. 24TH ST. QUINCY, ILLINOIS 62301 217.223.3670 STATE OF ILLINOIS DESIGN FIRM NO. 184-2738	USER NAME =	DESIGNED MCL	REVISED -	MCDONOUGH COUNTY HIGHWAY DEPARTMENT	FAS 435 (COUNTY HIGHWAY 24) PLAN AND PROFILE				F.A.S.	SECTION	COUNTY	TOTAL SHEETS	SHEET NO.	
		DRAWN MCL	REVISED -		435	19-00111-00-RS	MCDONOUGH	20	19					
	PLOT SCALE =	CHECKED EBB	REVISED -		SCALE: 1"=50'				SHEET 14 OF 14 SHEETS		STA. 195+00 TO STA. 203+01		CONTRACT NO. 89788	
	PLOT DATE	DATE 8/10/20	REVISED -		ILLINOIS FED. AID PROJECT									

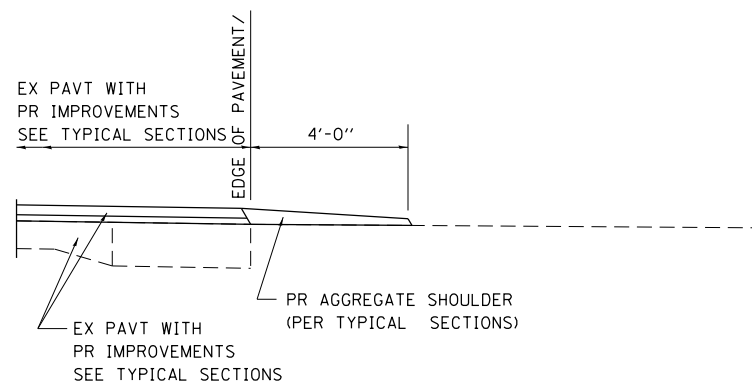

SECTION A-A FOR EX EARTH/AGGREGATE FE

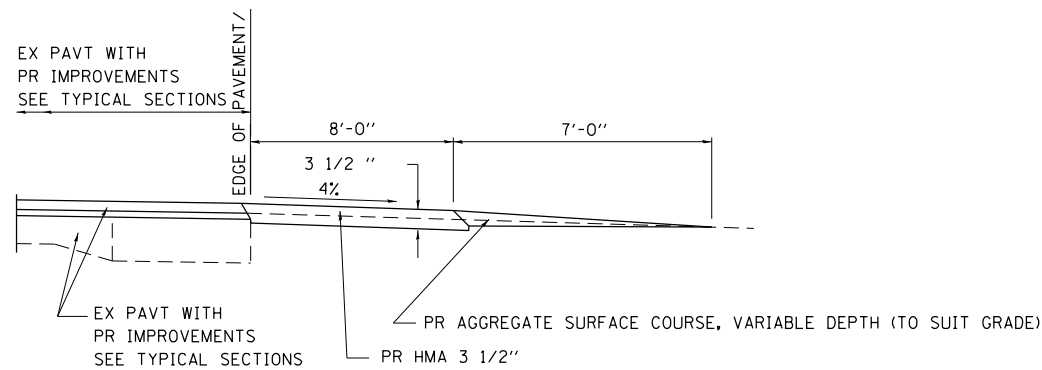

SECTION A-A FOR EX EARTH/AGGREGATE PE

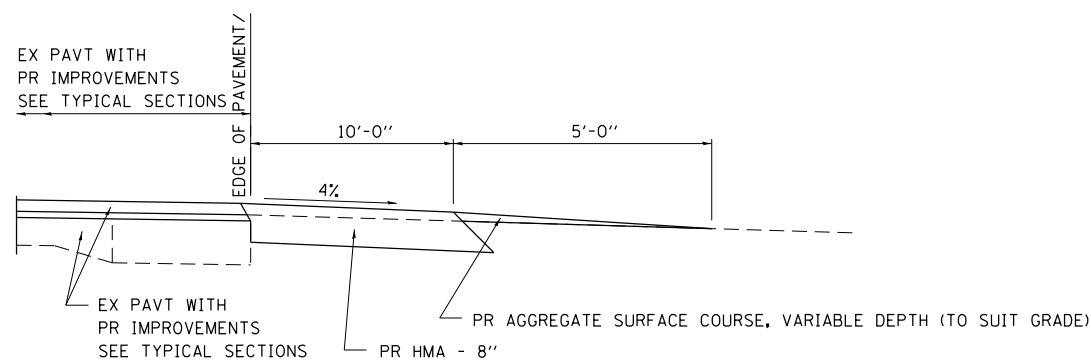

SECTION A-A FOR EX EARTH/AGGREGATE CE & SIDE ROAD

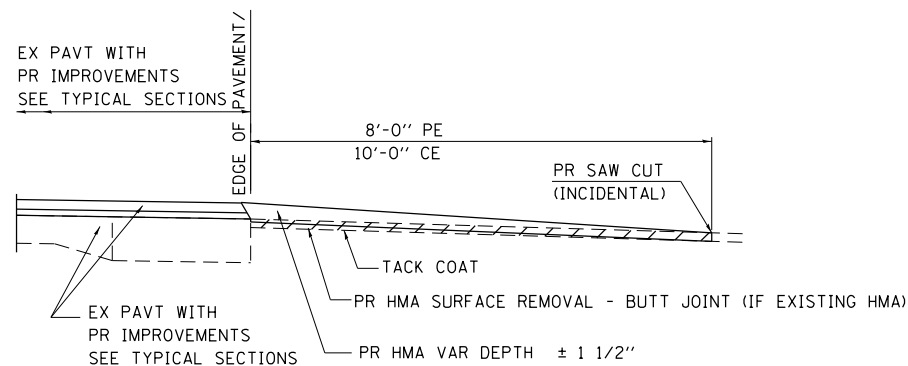

SECTION A-A FOR EX HMA/PC CONCRETE PE, CE & SIDE ROAD

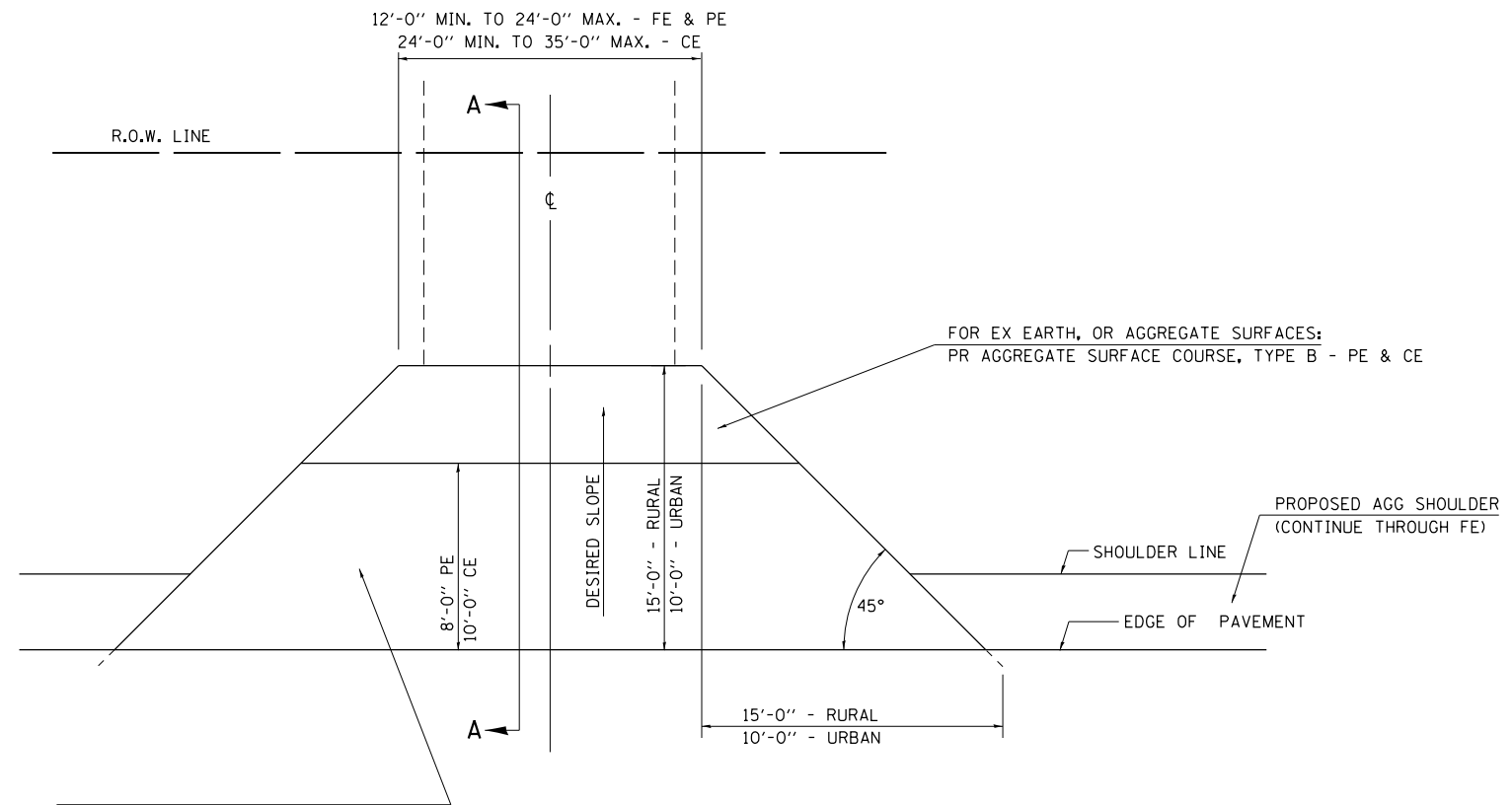

FOR EX EARTH OR AGGREGATE SURFACES:
 PR HMA SURFACE REMOVAL (IF APPLICABLE)
 PR AGGREGATE SHOULDER THRU - FE
 PR HMA CONCRETE 3 1/2" - PE
 PR HMA CONCRETE 8" - CE

FOR EX HMA CONCRETE SURFACES:
 PR HMA SURFACE REMOVAL-BUTT JOINT

GENERAL NOTES:

THE RESIDENT ENGINEER WILL DETERMINE THE EXACT TYPE OF IMPROVEMENT TO BE COMPLETED FOR ALL ENTRANCES, SIDEROADS AND MAILBOX TURNOUTS ON THIS PROJECT.

THE PLAN DETAILS AND SCHEDULES SHOULD BE USED AS A GUIDE FOR THE ENGINEER TO IMPLEMENT THE FINAL DESIGN. THE ENGINEER MAY DECIDE TO SALVAGE PORTIONS OF THE EXISTING ENTRANCE PAVEMENT STRUCTURE; THEREFORE, REDUCING PAY ITEM QUANTITIES. NO ADDITIONAL PAYMENT WILL BE ALLOWED FOR THIS REDUCTION IN QUANTITIES.

ANY WORK THE ENGINEER REQUIRES WHICH IS NOT COVERED BY A PAY ITEM CONTAINED IN THE PLANS WILL BE PAID FOR IN ACCORDANCE WITH ARTICLE 109.04 OF THE STANDARD SPECIFICATIONS.

HMA CONCRETE REQUIRED TO CONSTRUCT THE ENTRANCES SHALL BE IN ACCORDANCE WITH THE APPLICABLE PORTIONS OF SECTION 406 AND 408 OF THE STANDARD SPECIFICATIONS AND AS DIRECTED BY THE ENGINEER.

WHEN THE HMA CONCRETE PROPOSED FOR THE IMPROVEMENT IS THICKER THAN 3 INCHES AND REQUIRE PLACEMENT IN MORE THAN ONE LIFT. THE BOTTOM LIFT(S) SHALL MEET THE REQUIREMENTS OF HMA BASE COURSE IN SECTION 406 OF THE STANDARD SPECIFICATIONS AND THE TOP LIFT OF 2 INCHES SHALL MEET THE REQUIREMENTS OF HMA CONCRETE SURFACE COURSE, SUPERPAVE.

THIS WORK WILL BE PAID FOR IN ACCORDANCE WITH SECTIONS 351, 358, 408, 423 AND 440 OF THE STANDARD SPECIFICATIONS.

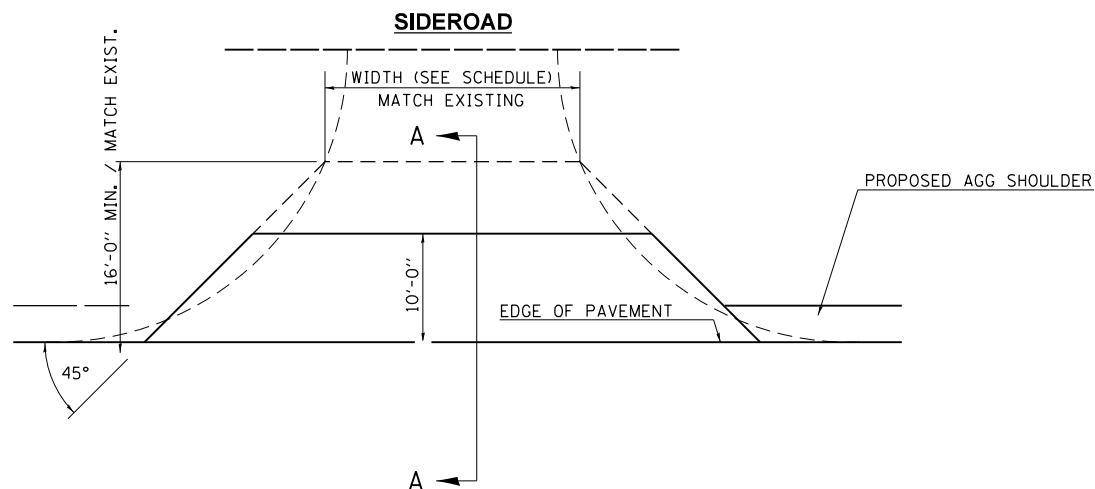

G:\2021\11\15\202003 (7595-002) McDonough County Highway - Highway 24\1817.transportation\ROAD Sheets\SH_Details.dgn

KLINGNER & ASSOCIATES, P.C.
 Engineers • Architects • Surveyors
 616 N. 24TH ST. QUINCY, ILLINOIS 62301 217.223.3670
 STATE OF ILLINOIS DESIGN FIRM NO. 184-2738

USER NAME = mcl	DESIGNED MCL	REVISED -
PLOT SCALE = 100.0000' / 1".	DRAWN MCL	REVISED -
PLOT DATE = 9/5/2020	CHECKED EBB	REVISED -
	DATE 08/10/2020	REVISED -

REVISED -
REVISED -
REVISED -
REVISED -

**MCDONOUGH COUNTY
 HIGHWAY DEPARTMENT**

**FAS 435 (COUNTY HIGHWAY 24)
 3P ENTRANCE DETAILS**

SHEET 1 OF 1 SHEETS STA. TO STA.

F.A.S.	SECTION	COUNTY	TOTAL SHEETS	SHEET NO.
435	19-00111-00-RS	MCDONOUGH	20	20
ILLINOIS FED. AID PROJECT			CONTRACT NO. 89788	