

FOR INDEX OF SHEETS, SEE SHEET NO. 2

STATE OF ILLINOIS

03-05-2021 LETTING ITEM 101

F.A.P. RTE.	SECTION	COUNTY	TOTAL SHEETS	SHEET NO.
395	2020 134-RS	COOK	45	1
		ILLINOIS	CONTRACT NO. 62M12	

DEPARTMENT OF TRANSPORTATION

D-91-534-20

PROJECT LOCATED IN THE CITY OF CHICAGO, CITY OF HOMETOWN, AND THE VILLAGE OF EVERGREEN PARK

PROPOSED HIGHWAY PLANS

FAP ROUTE 395: 87th STREET
KEELER AVE TO DAMEN AVE
SECTION 2020-134-RS
PROJECT NHPP-30JL(994)
SMART OVERLAY & ADA IMPROVEMENTS
COOK COUNTY

C-91-332-20



TRAFFIC DATA

2018 ADT = 20,300 TO 28,100 VPD

POSTED SPEED LIMIT

35 TO 40 MPH

IMPROVEMENTS BEGIN
STA 14+18.00

RAILROAD OMISSIONS

- STA 28+18 TO 30+41, WB
- STA 28+18 TO 30+15, EB
- STA 55+62 TO 55+83 WB & EB
- STA 121+96 TO 122+20 WB & EB

ROADWAY OMISSIONS

- STA 75+39 TO 87+87, WB & EB

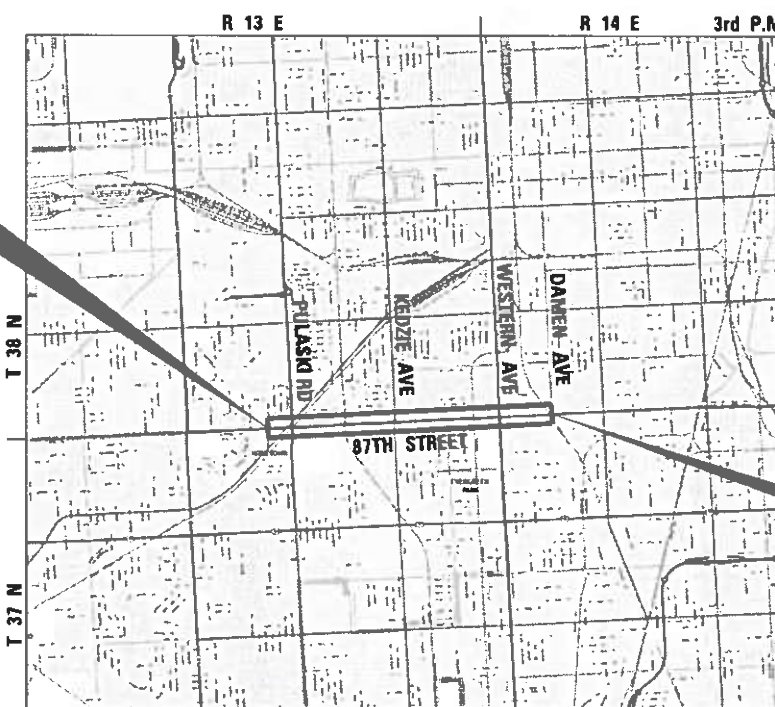

LAKE AND WORTH TOWNSHIPS
GROSS LENGTH = 14,730.5 FT. = 2.790 MILE
NET LENGTH = 13,214.5 FT. = 2.503 MILE

IMPROVEMENTS END
STA 161+48.50

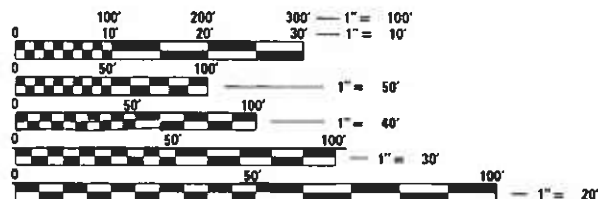

FULL SIZE PLANS HAVE BEEN PREPARED USING STANDARD ENGINEERING SCALES. REDUCED SIZED PLANS WILL NOT CONFORM TO STANDARD SCALES. IN MAKING MEASUREMENTS ON REDUCED PLANS, THE ABOVE SCALES MAY BE USED.

J.U.L.I.E.
JOINT UTILITY LOCATION INFORMATION FOR EXCAVATORS
1-800-892-0123 OR 811
C.U.A.N.
CHICAGO UTILITY ALERT NETWORK
1-312-744-7000 OR DIGGER 811

PROJECT ENGINEER: VESELIN VELICHKOV (847) 705-4432

PROJECT MANAGER: FAWAD AQUEEL (847) 705-4247

CONTRACT NO. 62M12



DECEMBER 4, 20 20
PAUL J. FITZPATRICK
ILLINOIS REG. PROFESSIONAL ENGINEER NO. 062-047687
EXPIRATION DATE 11-30-2021
SHEETS 1-14, 16-45

STATE OF ILLINOIS
DEPARTMENT OF TRANSPORTATION
SUBMITTED December 9, 20 20
Audrey G. Rungty P.E. REGIONAL ENGINEER
January 29, 2021
S. A. Elk ENGINEER OF DESIGN AND ENVIRONMENT
January 29, 2021
Gemma J. Jan DIRECTOR OF HIGHWAYS PROJECT IMPLEMENTATION 13

PRINTED BY THE AUTHORITY OF THE STATE OF ILLINOIS

INDEX OF SHEETS

SHEET NO.	DESCRIPTION
1	COVER SHEET
2	GENERAL NOTES, INDEX OF SHEETS & HIGHWAY STANDARDS
3-7	SUMMARY OF QUANTITIES
8	EXISTING AND PROPOSED TYPICAL SECTIONS
9-14	ROADWAY AND PAVEMENT MARKING PLANS
15	DETECTOR LOOP REPLACEMENT PLAN
16-26	ADA RAMP IMPROVEMENT PLANS
27	DETAILS FOR FRAMES AND LIDS ADJUSTMENT WITH MILLING (BD-08)
28	PAVEMENT PATCHING FOR HMA SURFACED PAVEMENT (BD-22)
29	CURB OR CURB AND GUTTER REMOVAL AND REPLACEMENT (BD-24)
30	BUTT JOINT AND HMA TAPER DETAILS (BD-32)
31	TRAFFIC CONTROL AND PROTECTION FOR SIDE ROADS, INTERSECTIONS, AND DRIVEWAYS (TC-10)
32	TYPICAL APPLICATIONS RAISED REFLECTIVE PAVEMENT MARKERS (SNOW-PLOW RESISTANT) (TC-11)
33	TRAFFIC CONTROL AND PROTECTION AT TURN BAYS (TO REMAIN OPEN TO TRAFFIC) (TC-14)
34	SHORT TERM PAVEMENT MARKING LETTERS AND SYMBOLS (TC-16)
35	ARTERIAL ROAD INFORMATION SIGN (TC-22)
36-37	TYPICAL SUPPLEMENTAL SIGNING AND PAVEMENT MARKING TREATMENT FOR RAILROAD CROSSINGS (TC-23)
38-40	CITY OF CHICAGO TYPICAL PAVEMENT MARKINGS (TC-24)
41	DISTRICT 1 - DETECTOR LOOP INSTALLATION DETAILS FOR ROADWAY RESURFACING (TS-07)
42	PROJECT DETAIL FOR SINGLE PERPENDICULAR CURB RAMPS (PD-01)
43	PROJECT DETAIL FOR SINGLE PERPENDICULAR CURB RAMPS W/ TURNING SPACE (PD-04)
44	EXISTING TRAFFIC CONTROL SIGNALS - 87TH STREET TO WESTERN AVE - FOR REFERENCE ONLY
45	EXISTING VEHICLE DETECTOR LOOP DETAIL 905 - FOR REFERENCE ONLY

INDEX OF HIGHWAY STANDARDS

STANDARD NO.	DESCRIPTION
000001-08	STANDARD SYMBOLS, ABBREVIATIONS AND PATTERNS
001006	DECIMAL OF AN INCH AND OF A FOOT
424001-11	PERPENDICULAR CURB RAMPS FOR SIDEWALK
424006-05	DIAGONAL CURB RAMPS FOR SIDEWALK
424011-04	CORNER PARALLEL CURB RAMPS FOR SIDEWALK
424021-06	DEPRESSED CORNER FOR SIDEWALK
442201-03	CLASS C AND D PATCHES
606001-07	CONCRETE CURB TYPE B AND COMBINATION CONCRETE CURB AND GUTTER
701011-04	OFF-ROAD MOVING OPERATIONS, 2L, 2W, DAY ONLY
701101-05	OFF-ROAD OPERATIONS, MULTILANE, 15' (4.5 m) TO 24" (600 mm) FROM PAVEMENT EDGE
701301-04	LANE CLOSURE, 2L, 2W, SHORT TIME OPERATIONS
701311-03	LANE CLOSURE, 2L, 2W, MOVING OPERATIONS-DAY ONLY
701427-05	LANE CLOSURE, MULTILANE, INTERMITTENT OR MOVING OPER., FOR SPEEDS <= 40 MPH
701501-06	URBAN LANE CLOSURE, 2L, 2W, UNDIVIDED
701601-09	URBAN LANE CLOSURE, MULTILANE, 1W OR 2W WITH NONTRAVERSABLE MEDIAN
701606-10	URBAN SINGLE LANE CLOSURE, MULTILANE, 2W WITH MOUNTABLE MEDIAN
701701-10	URBAN LANE CLOSURE, MULTILANE INTERSECTION
701801-06	SIDEWALK, CORNER OR CROSSWALK CLOSURE
701901-08	TRAFFIC CONTROL DEVICES
780001-05	TYPICAL PAVEMENT MARKINGS

GENERAL NOTES

- THE CONTRACTOR SHALL COORDINATE CONSTRUCTION ACTIVITIES WITH THE UTILITY COMPANIES, THE CITY OF CHICAGO, THE CITY OF HOMETOWN, AND THE VILLAGE OF EVERGREEN PARK. BEFORE STARTING ANY EXCAVATION, THE CONTRACTOR SHALL CALL "JULIE" AT 800-892-0123 AND "CUAN" 312-744-7000 FOR FIELD LOCATIONS OF BURIED UTILITIES (48 HOUR NOTIFICATIN REQUIRED).
- THE CONTRACTOR WILL NOT BE ALLOWED TO SETUP A YARD FOR FIELD OFFICE ON STATE PROPERTY WITHOUT WRITTEN PERMISSIONS FROM THE DEPARTMENT.
- THE CONTRACTOR SHALL CONTACT THE DISTRICT ONE TRAFFIC CONTROL SUPERVISOR AT KALPANA.KANNAN-HOSADURGA@ILLINOIS.GOV A MINIMUM OF 72 HOURS IN ADVANCE OF BEGINNING WORK.
- IT IS THE CONTRACTOR'S RESPONSIBILITY TO PROVIDE A FIELD LABORATORY FOR USE FOR ANY ON SITE TESTING BY THE ENVIRONMENTAL FIRM. NO TESTING OF ANY KIND, CONTAMINATED OR NON-CONTAMINATED FLUID OR SOILD SHALL BE PERMITTED IN THE ENGINEER'S FIELD OFFICE.
- IT SHALL BE THE CONTRACTOR'S RESPONSIBILITY TO VERIFY ALL DIMENSIONS AND CONDITIONS EXISTING IN THE FIELD PRIOR TO ORDERING MATERIALS AND BEGINNING CONSTRUCTION ACTIVITIES.
- BEFORE BEGINNING ANY WORK, THE CONTRACTOR SHALL RETAIN AND RECORD FOR FUTURE REFERENCE, ALL EXISTING PAVEMENT MARKING LINES (AND RAISED REFLECTIVE MARKERS) IN ORDER THAT THESE LOCATIONS CAN BE RE-ESTABLISHED FOR STRIPING. EXACT LOCATIONS OF ALL PAVEMENT MARKINGS SHALL BE AS DIRECTED BY THE ENGINEER.
- TEN (10) FOOT TRANSITIONS SHALL BE USED TO MATCH PROPOSED CURB AND GUTTERS AND MEDIAN ITEMS OF WORK TO EXISTING CURBS AND GUTTER AND MEDIANS IN THE FIELD, UNLESS OTHERWISE SHOWN. THE TRANSITIONS SHALL BE PAID AT THE CONTRACT UNIT PRICE FOR THE PROPOSED ITEMS OF WORK SPECIFIED.
- LIMITS OF RESURFACING ON SIDE STREETS THROUGHOUT THE PROJECT SHALL BE TO THE RADIUS RETURN, UNLESS OTHERWISE SHOWN ON THE PLANS OR AS DIRECTED BY THE RESIDENT ENGINEER / TECHNICIAN.
- THE CONTRACTOR SHALL BE REQUIRED TO PROVIDE ACCESS TO ABUTTING PROPERTY AT ALL TIMES DURING THE CONSTRUCTION OF THIS PROJECT.
- ALL PAVEMENT PATCHING, CURB AND GUTTER REMOVAL AND REPLACEMENT, DRAINAGE ADJUSTMENT LOCATIONS WILL BE DETERMINED IN THE FIELD BY THE ENGINEER.
- WHEN MILLED PAVEMENT IS OPEN TO TRAFFIC, THE MAXIMUM GRADE DIFFERENTIAL BETWEEN PASSES OF THE MILLING MACHINE SHALL NOT EXCEED 1½ INCHES WHERE THE SPEED LIMIT IS 45 MPH OR LESS, AND 1 INCH WHERE THE SPEED LIMIT IS GREATER THAN 45 MPH. WITH WRITTEN APPROVAL FROM THE ENGINEER, A MAXIMUM GRADE DIFFERENTIAL OF 3 INCHES MAY BE ALLOWED IF THE EDGE OF THE MILLING SLOPE IS A MINIMUM OF 1:3 (V:H).
- BUTT JOINTS SHALL BE INSTALLED AT THE ENDS OF ALL RESURFACING (WHERE RESURFACING MEETS EXISTING PAVEMENT), IN ACCORDANCE WITH THE "BUTT JOINT AND HMA TAPER DETAILS" SHEET INCLUDED IN THE PLANS, UNLESS OTHERWISE SPECIFIED.
- PAVEMENT MARKING TAPE, TYPE III SHALL BE USED FOR SHORT TERM PAVEMENT MARKINGS ON ALL FINAL SURFACES.
- DOUBLE LANE MARKERS SHALL BE USED AS SHOWN ON THE DISTRICT ONE DETAIL "TYPICAL APPLICATIONS - RAISED REFLECTIVE PAVEMENT MARKERS (SNOW-PLOW RESISTANT)" SHEET INCLUDED IN THE PLANS.
- ANY PAVEMENT MARKINGS AND RAISED REFLECTIVE PAVEMENT MARKERS OBLITERATED BY MILLING AND RESURFACING OPERATIONS ON SIDE STREETS AND ENTRANCES SHALL BE REPLACED AND PAID FOR IN KIND.
- THE RESIDENT ENGINEER SHALL CONTACT MR. EMAD ALHUSSEINI, AREA TRAFFIC FIELD ENGINEER, VIA EMAIL AT EMAD.ALHUSSEINI@ILLINOIS.GOV, A MINIMUM OF 2 WEEKS PRIOR TO PLACEMENT OF PERMANENT PAVEMENT MARKINGS.
- ALL FINAL PAVEMENT MARKINGS SHALL BE THERMOPLASTIC PAVEMENT MARKINGS (OF THE EXTRUDED TYPE).
- PROPOSED SIDEWALK RAMPS SHALL CONFORM TO CURRENT ADA REQUIREMENTS. APPLICATE STATE HIGHWAY STANDARDS, AND THESE PLANS, OR AS DETERMINED BY THE ENGINEER.
- DO NOT SCALE PLANS FOR CONSTRUCTION DIMENSIONS.

MODEL: D:\ef\it... FILE NAME: P:\9-1137-07_PTB193-16_87th St\DOT\CAD_Sheets\162M12-cht-egenotes.dgn

47 South Third Street
Suite 200
Geneva, Illinois 60134
630.333.8187 phone
www.kaskaskiaeng.com

PROFESSIONAL DESIGN FIRMS
Illinois Professional Design Firm
Professional Engineering Group

USER NAME = ndp	DESIGNED - NDP	REVISED -
	DRAWN - NDP	REVISED -
PLOT SCALE = 20.0000 ' / in.	CHECKED - PJF	REVISED -
PLOT DATE = 12/10/2020	DATE - 12/04/2020	REVISED -

**STATE OF ILLINOIS
DEPARTMENT OF TRANSPORTATION**

**GENERAL NOTES, INDEX OF SHEETS & HIGHWAY STANDARDS
87TH STREET (KEELER AVE TO DAMEN AVE)**

SCALE: SHEET 1 OF 1 SHEETS STA. TO STA.

F.A.P. RTE.	SECTION	COUNTY	TOTAL SHEETS	SHEET NO.
395	2020-134-R5	COOK	45	2
CONTRACT NO. 62M12				
		ILLINOIS	FED. AID PROJECT	

CODE NO.	ITEM	UNIT	TOTAL QUANTITY	CONSTRUCTION CODE	
				80% FED 20% STATE	100% STATE
				ROADWAY	ROADWAY
				0005	0005
				URBAN	URBAN
20200100	EARTH EXCAVATION	CU YD	100	100	
21101615	TOPSOIL FURNISH AND PLACE, 4"	SQ YD	38	38	
25200110	SODDING, SALT TOLERANT	SQ YD	38	38	
25200200	SUPPLEMENTAL WATERING	UNIT	1	1	
40600290	BITUMINOUS MATERIALS (TACK COAT)	POUND	47,661	47,661	
40600400	MIXTURE FOR CRACKS, JOINTS, AND FLANGWAYS	TON	159	159	
40600982	HOT-MIX ASPHALT SURFACE REMOVAL - BUTT JOINT	SQ YD	959	959	
40604172	POLYMERIZED HOT-MIX ASPHALT SURFACE COURSE, 1L-9.5, MIX "E", N70	TON	10,380	10,380	
42001300	PROTECTIVE COAT	SQ YD	613	613	
42300400	PORTLAND CEMENT CONCRETE DRIVEWAY PAVEMENT, 8 INCH	SQ YD	11	11	
42400200	PORTLAND CEMENT CONCRETE SIDEWALK 5 INCH	SQ FT	3,550	3,550	
42400800	DETECTABLE WARNINGS	SQ FT	386	386	
44000156	HOT-MIX ASPHALT SURFACE REMOVAL, 1 3/4"	SQ YD	105,913	105,913	
44000600	SIDEWALK REMOVAL	SQ FT	3,550	3,550	
44201789	CLASS D PATCHES, TYPE II, 12 INCH	SQ YD	574	574	

* SPECIALTY ITEM

MODEL: D:\p1\137\07_P1B137-16_87th_S01_IDOT\CAD_Sheets\162M12-ht-500_01.dwg
FILE NAME: P:\137\07_P1B137-16_87th_S01_IDOT\CAD_Sheets\162M12-ht-500_01.dwg



477 South Third Street
Suite 200
Geneva, Illinois 60134
630.333.8187 phone
www.kaskaskiaeng.com

PROFESSIONAL DESIGNER
Illinois Professional Design Firm
34-06713
38-388536

USER NAME = ndp	DESIGNED - NDP	REVISED -
	DRAWN - NDP	REVISED -
PLOT SCALE = 20.0000 ' / in.	CHECKED - PJF	REVISED -
PLOT DATE = 12/10/2020	DATE - 12/04/2020	REVISED -

**STATE OF ILLINOIS
DEPARTMENT OF TRANSPORTATION**

**SUMMARY OF QUANTITIES
87TH STREET (KEELER AVE TO DAMEN AVE)**

SCALE: SHEET 1 OF 5 SHEETS STA. TO STA.

F.A.P. RTE.	SECTION	COUNTY	TOTAL SHEETS	SHEET NO.
395	2020-134-R5	COOK	45	3
CONTRACT NO. 62M12				
ILLINOIS		FED. AID PROJECT		

CODE NO.	ITEM	UNIT	TOTAL QUANTITY	CONSTRUCTION CODE	
				80% FED 20% STATE	100% STATE
				ROADWAY	ROADWAY
				0005	0005
				URBAN	URBAN
44201794	CLASS D PATCHES, TYPE III, 12 INCH	SQ YD	180	180	
44201796	CLASS D PATCHES, TYPE IV, 12 INCH	SQ YD	60	60	
60252800	CATCH BASINS TO BE RECONSTRUCTED	EACH	5	5	
60300105	FRAMES AND GRATES TO BE ADJUSTED	EACH	5	5	
60300305	FRAMES AND LIDS TO BE ADJUSTED	EACH	21	21	
60300405	VALVE BOX FRAMES TO BE ADJUSTED	EACH	5	5	
* 66900200	NON-SPECIAL WASTE DISPOSAL	CU YD	100	100	
* 66900530	SOIL DISPOSAL ANALYSIS	EACH	3	3	
* 66901001	REGULATED SUBSTANCES PRE-CONSTRUCTION PLAN	LSUM	1	1	
* 66901003	REGULATED SUBSTANCES FINAL CONSTRUCTION REPORT	LSUM	1	1	
* 66901006	REGULATED SUBSTANCES MONITORING	CAL DA	10	10	
67000400	ENGINEER'S FIELD OFFICE, TYPE A	CAL MO	12	12	
67100100	MOBILIZATION	L SUM	1	1	
70102620	TRAFFIC CONTROL AND PROTECTION, STANDARD 701501	L SUM	1	1	
70102625	TRAFFIC CONTROL AND PROTECTION, STANDARD 701606	L SUM	1	1	

* SPECIALTY ITEM

MODEL: D:\64611
FILE NAME: P:\19-1137-07_PTB193-16_87th St\DOT\CAD_Sheets\162M12-ht-500_02.dwg



477 South Third Street
Suite 200
Geneva, Illinois 60134
630.333.8187 phone
www.kaskaskiaeng.com

PROFESSIONAL ENGINEER
Illinois Professional Design Firm
34-06713
38-388536

USER NAME = ndp	DESIGNED - NDP	REVISED -
	DRAWN - NDP	REVISED -
PLOT SCALE = 20.0000 ' / in.	CHECKED - PJF	REVISED -
PLOT DATE = 12/10/2020	DATE - 12/04/2020	REVISED -

**STATE OF ILLINOIS
DEPARTMENT OF TRANSPORTATION**

**SUMMARY OF QUANTITIES
87TH STREET (KEELER AVE TO DAMEN AVE)**

SCALE: SHEET 2 OF 5 SHEETS STA. TO STA.

F.A.P. RTE.	SECTION	COUNTY	TOTAL SHEETS	SHEET NO.
395	2020-134-R5	COOK	45	4
			CONTRACT NO. 62M12	
		ILLINOIS	FED. AID PROJECT	

CODE NO.	ITEM	UNIT	TOTAL QUANTITY	CONSTRUCTION CODE	
				80% FED 20% STATE	100% STATE
				ROADWAY	ROADWAY
				0005	0005
				URBAN	URBAN
70102630	TRAFFIC CONTROL AND PROTECTION, STANDARD 701601	L SUM	1	1	
70102634	TRAFFIC CONTROL AND PROTECTION, STANDARD 701611	L SUM	1	1	
70102635	TRAFFIC CONTROL AND PROTECTION, STANDARD 701701	L SUM	1	1	
70102640	TRAFFIC CONTROL AND PROTECTION, STANDARD 701801	L SUM	1	1	
70300100	SHORT TERM PAVEMENT MARKING	FOOT	8,773	8,773	
70300150	SHORT TERM PAVEMENT MARKING REMOVAL	SQ FT	4,889	4,889	
70300210	TEMPORARY PAVEMENT MARKING LETTERS AND SYMBOLS	SQ FT	2,025	2,025	
70300220	TEMPORARY PAVEMENT MARKING - LINE 4"	FOOT	34,601	34,601	
70300240	TEMPORARY PAVEMENT MARKING - LINE 6"	FOOT	2,930	2,930	
70300250	TEMPORARY PAVEMENT MARKING - LINE 8"	FOOT	114	114	
70300260	TEMPORARY PAVEMENT MARKING - LINE 12"	FOOT	306	306	
70300280	TEMPORARY PAVEMENT MARKING - LINE 24"	FOOT	4,230	4,230	
70300520	PAVEMENT MARKING TAPE, TYPE III 4"	FOOT	5,893	5,893	
* 78000100	THERMOPLASTIC PAVEMENT MARKING - LETTERS AND SYMBOLS	SQ FT	2,025	2,025	
* 78000200	THERMOPLASTIC PAVEMENT MARKING - LINE 4"	FOOT	34,601	34,601	
* 78000400	THERMOPLASTIC PAVEMENT MARKING - LINE 6"	FOOT	2,930	2,930	

* SPECIALTY ITEM

MODEL: Default
FILE NAME: P:\19-1137.07_PTB193-16_87th_SIG_IDOT\CAD_Sheets\162M12-2R-500_03.dgn



477 South Third Street
Nashville, TN 37203
615.382.8800
www.kaskaskia.com

USER NAME = ndp

PLOT SCALE = 20.0000' / in.

PLOT DATE = 12/10/2020

DESIGNED - NDP
DRAWN - NDP
CHECKED - PJF
DATE - 12/04/2020

REVISED -
REVISED -
REVISED -
REVISED -

**STATE OF ILLINOIS
DEPARTMENT OF TRANSPORTATION**

**SUMMARY OF QUANTITIES
87TH STREET (KEELER AVE TO DAMEN AVE)**

SCALE: SHEET 3 OF 5 SHEETS STA. TO STA.

F.A.P. RTE.	SECTION	COUNTY	TOTAL SHEETS	SHEET NO.
395	2020-134-R5	COOK	45	5
			CONTRACT NO. 62M12	
ILLINOIS FED. AID PROJECT				

REV-SEP

CODE NO.	ITEM	UNIT	TOTAL QUANTITY	CONSTRUCTION CODE	
				80% FED 20% STATE	100% STATE
				ROADWAY	ROADWAY
				0005	0005
				URBAN	URBAN
* 78000500	THERMOPLASTIC PAVEMENT MARKING - LINE 8"	FOOT	114	114	
* 78000600	THERMOPLASTIC PAVEMENT MARKING - LINE 12"	FOOT	306	306	
* 78000650	THERMOPLASTIC PAVEMENT MARKING - LINE 24"	FOOT	4,230	4,230	
* 78100100	RAISED REFLECTIVE PAVEMENT MARKER	EACH	982	982	
78300200	RAISED REFLECTIVE PAVEMENT MARKER REMOVAL	EACH	982	982	
* 85000200	MAINTENANCE OF EXISTING TRAFFIC SIGNAL INSTALLATION	EACH	6	6	
* 88600600	DETECTOR LOOP REPLACEMENT	FOOT	647	647	
* 89502376	REBUILD EXISTING HANDHOLE	EACH	1	1	
X0320050	CONSTRUCTION LAYOUT (SPECIAL)	L SUM	1	1	
X4400501	COMBINATION CURB AND GUTTER REMOVAL AND REPLACEMENT LESS THAN OR EQUAL TO 10 FEET	FOOT	315	315	
X5537800	STORM SEWERS TO BE CLEANED 12"	FOOT	1,520		1,520
X6030310	FRAMES AND LIDS TO BE ADJUSTED (SPECIAL)	EACH	175	175	
X7030005	TEMPORARY PAVEMENT MARKING REMOVAL	SQ FT	23,865	23,865	
X8130120	RELOCATE EXISTING JUNCTION BOX	EACH	1	1	

* SPECIALTY ITEM

REV-SEP

MODEL: Default
FILE NAME: P:\19-1137.07_PTB193-16_87th_SIG_IDOT\CAD_Sheets\162M12-2R-500_04.dgn



477 South Third Street
Naperville, Illinois 60563
630.332.3837 phone
www.kaskaskiaeng.com

USER NAME = ndp

PLOT SCALE = 20.0000' / in.

PLOT DATE = 12/10/2020

DESIGNED - NDP
DRAWN - NDP
CHECKED - PJF
DATE - 12/04/2020

REVISED -
REVISED -
REVISED +
REVISED -

**STATE OF ILLINOIS
DEPARTMENT OF TRANSPORTATION**

**SUMMARY OF QUANTITIES
87TH STREET (KEELER AVE TO DAMEN AVE)**

SCALE: SHEET 4 OF 5 SHEETS STA. TO STA.

F.A.P. RTE.	SECTION	COUNTY	TOTAL SHEETS	SHEET NO.
395	2020-134-R5	COOK	45	6
			CONTRACT NO. 62M12	
ILLINOIS FED. AID PROJECT				

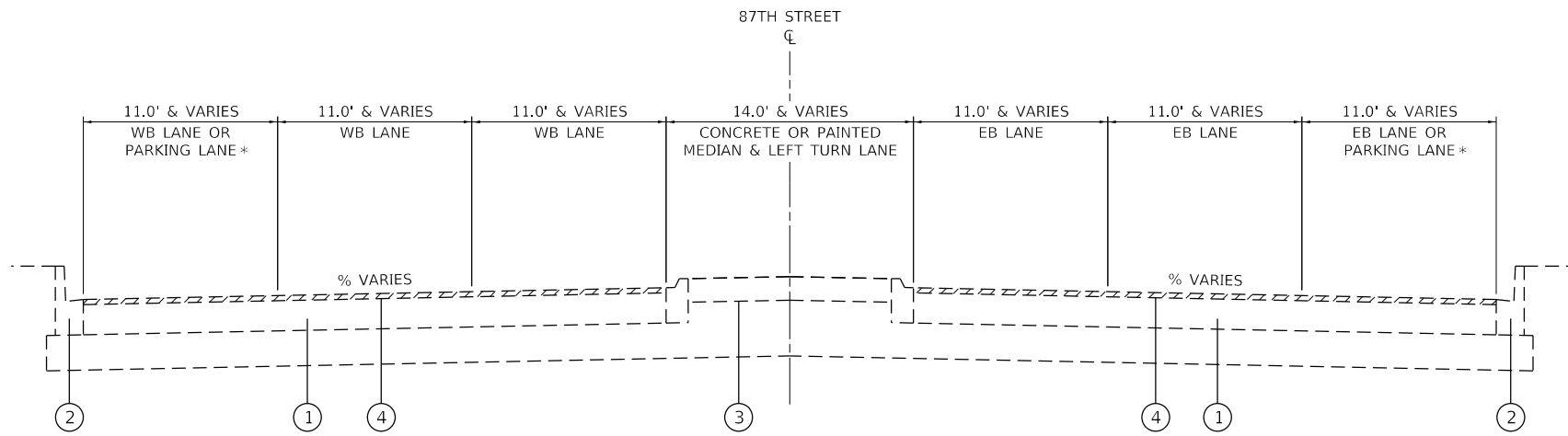

EXISTING TYPICAL SECTION

STA 14+18.00 TO STA 161+48.50
WITH OMISSIONS AS NOTED

* **PARKING LANES**
STA 14+18 TO STA 25+44, WB
STA 87+87 TO STA 121+62, WB/EB

RAILROAD OMISSIONS

STA 28+18 TO STA 30+41, WB
STA 28+18 TO STA 30+15, EB
STA 55+62 TO STA 55+83, WB/EB
STA 121+96 TO STA 122+20 WB/EB

ROADWAY OMISSIONS

STA 75+39 TO STA 87+87, WB/EB

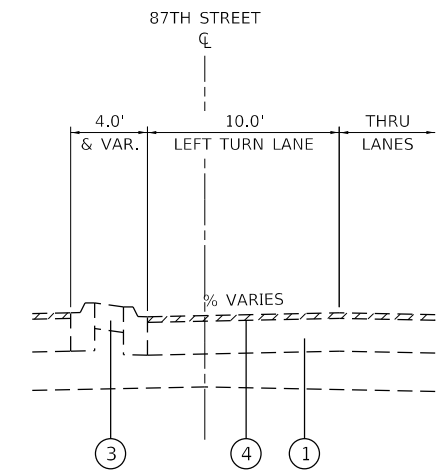

LEFT TURN LANE

LOCATIONS VARY, SEE PLANS

LEGEND

- ① EXISTING HMA PAVEMENT STRUCTURE
- ② EXISTING COMB CONCRETE CURB & GUTTER
- ③ EXISTING CONCRETE MEDIAN
- ④ PROPOSED HMA SURFACE REMOVAL, 1 3/4"
- ⑤ PROPOSED POLY HMA SURFACE COURSE, IL-9.5, MIX "E", N70, 1 3/4"

NOTES:

FOR THE EXISTING HMA SURFACE, THE CONTRACTOR SHALL PERFORM ALL PAVEMENT PATCHING PRIOR TO MILLING OPERATIONS. THEN THE CONTRACTOR MAY BEGINS MILLING THE ROADWAY. PER BD-22 DETAIL.

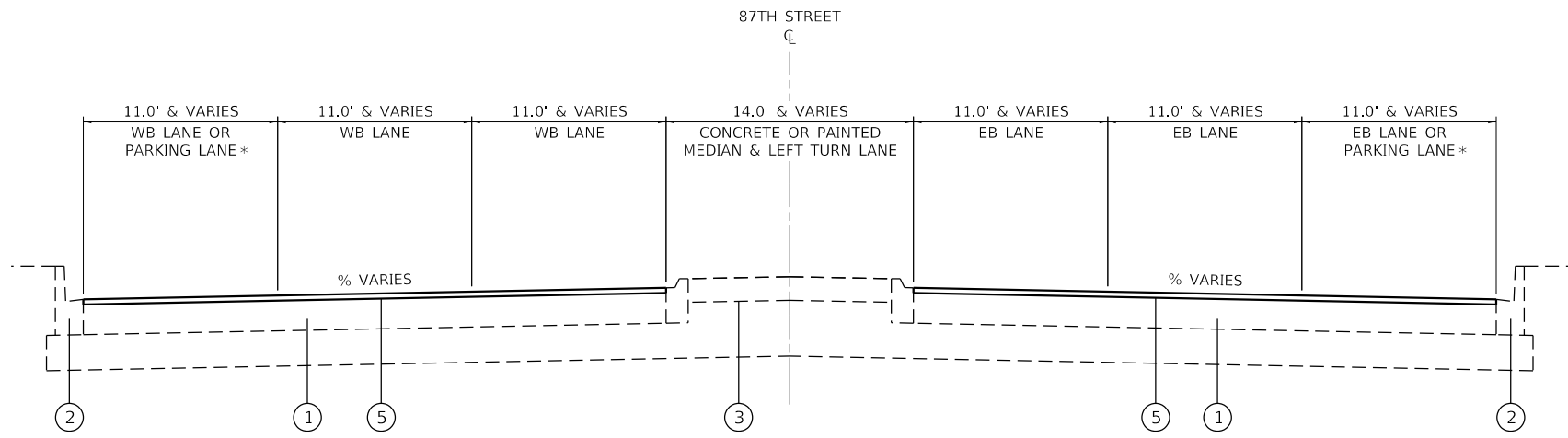

PROPOSED TYPICAL SECTION

STA 14+18.00 TO STA 161+48.50
WITH OMISSIONS AS NOTED

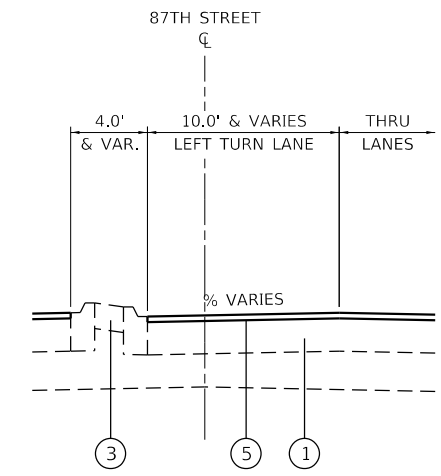

LEFT TURN LANE

LOCATIONS VARY, SEE PLANS

HOT-MIX ASPHALT MIXTURE REQUIREMENTS		QUALITY MANAGEMENT PLAN (QMP)
MIXTURE TYPE	AIR VOIDS(%) @ N _{DES}	
PAVEMENT RESURFACING		
POLYMERIZED HOT-MIX ASPHALT SURFACE COURSE, IL-9.5, MIX "E", N70, 1 3/4"	4% @ 70 GYR.	PPF
PAVEMENT PATCHING		
CLASS D PATCHES, (HMA BINDER IL-19.0 MM)	4% @ 70 GYR.	QC/QA
QMP DESIGNATION: QUALITY CONTROL/QUALITY ASSURANCE (QC/QA); QUALITY CONTROL FOR PERFORMANCE (QCP); PAY FOR PERFORMANCE (PFP)		

- NOTE 1: THE UNIT WEIGHT USED TO CALCULATE ALL HOT-MIX ASPHALT SURFACE MIXTURE QUANTITIES IS 112 LBS/SQ YD/IN.
- NOTE 2: THE "AC TYPE" FOR POLYMERIZED HMA MIXES SHALL BE "SBS/SBR PG 76-22" AND FOR NON-POLYMERIZED HMA THE "AC TYPE" SHALL BE "PG 64-22" UNLESS OTHERWISE MODIFIED BY SPECIAL PROVISIONS.
- NOTE 3: "QUALITY MANAGEMENT PROGRAM (QMP) IDENTIFIES THE PARTICULAR QUALITY CONTROL SPECIFICATION THAT APPLIES TO THE HMA MIXTURE.
- NOTE 4: THE LONGITUDINAL JOINT SEALANT SHALL BE PLACED OVER THE MILLED SURFACE.
- NOTE 5: FOR USE OF RECYCLED MATERIALS SEE SPECIAL PROVISIONS.

MODEL: D:\dgn\11... FILE NAME: P:\13-1137-07_P1B193-16_87th St_01\DOT\CAD_Sheets\162M12-ctb-typrcal.dgn



477 South Third Street Suite 200 Geneva, Illinois 60134 630.333.8187 phone www.kaskaskiaeng.com	USER NAME = ndp	DESIGNED - NDP	REVISED -
PROFESSIONAL ENGINEER Illinois Professional Design Firm 3436213 28-388536	PLOT SCALE = 10.0000' / in.	DRAWN - NDP	REVISED -
	PLOT DATE = 12/3/2020	CHECKED - PJF	REVISED -
		DATE - 12/04/2020	REVISED -

**STATE OF ILLINOIS
DEPARTMENT OF TRANSPORTATION**

EXISTING & PROPOSED TYPICAL SECTIONS	
87TH STREET (KEELER AVE TO DAMEN AVE)	
SCALE:	SHEET 1 OF 1 SHEETS STA. TO STA.

F.A.P. RTE.	SECTION	COUNTY	TOTAL SHEETS	SHEET NO.
395	2020-134-R5	COOK	45	8
CONTRACT NO. 62M12				
ILLINOIS FED. AID PROJECT				

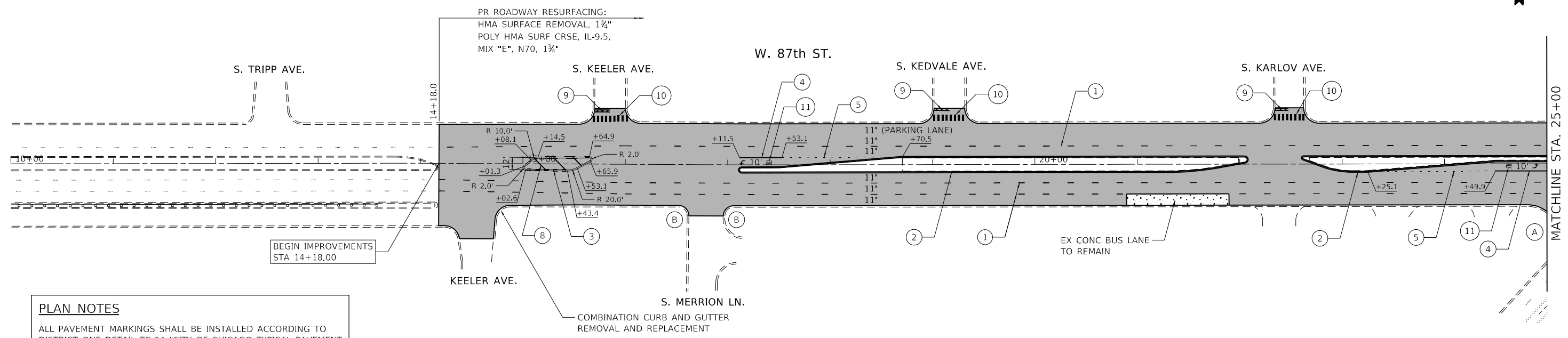

PLAN NOTES

ALL PAVEMENT MARKINGS SHALL BE INSTALLED ACCORDING TO DISTRICT ONE DETAIL TC-24 "CITY OF CHICAGO TYPICAL PAVEMENT MARKINGS."

RAISED REFLECTIVE PAVEMENT MARKERS SHALL BE INSTALLED ACCORDING TO DISTRICT ONE DETAIL TC-11 "RAISED REFLECTIVE PAVEMENT MARKERS (SNOW PLOW RESISTANT)."

EXISTING CONCRETE PATCHES ARE SHOWN FOR CONTRACTORS REFERENCE ONLY AND SHALL REMAIN IN PLACE. MILLING AND OVERLAY OPERATIONS SHALL BUTT AGAINST CONCRETE EDGES.

SIDEWALK LEGEND

(A)	PROPOSED ADA RAMP IMPROVEMENTS, SEE DETAIL SHEETS
(B)	PROPOSED ADA RAMP IMPROVEMENTS, SEE DETAIL PD-01B
(C)	PROPOSED ADA RAMP IMPROVEMENTS, SEE DETAIL PD-04A

PAVEMENT MARKING LEGEND

(1)	THERMOPLASTIC PAVEMENT MARKING LINE, 4" (WHITE SKIP DASH LINE - 18" SKIP, 6" DASH)	(5)	THERMOPLASTIC PAVEMENT MARKING LINE, 6" (WHITE SKIP DASH LINE - 6" SKIP, 2" DASH)	(9)	THERMOPLASTIC PAVEMENT MARKING LINE, 24" (WHITE SOLID LINE - STOP BAR)
(2)	THERMOPLASTIC PAVEMENT MARKING LINE, 4" (YELLOW SOLID LINE)	(6)	THERMOPLASTIC PAVEMENT MARKING LINE, 8" (WHITE SOLID LINE)	(10)	THERMOPLASTIC PAVEMENT MARKING LINE, 24" (WHITE SOLID LINE - CROSS WALKS)
(3)	THERMOPLASTIC PAVEMENT MARKING LINE, 4" (DOUBLE YELLOW SOLID LINES @ 8" C-C)	(7)	THERMOPLASTIC PAVEMENT MARKING LINE, 12" (WHITE SOLID LINE)	(11)	PAVEMENT MARKING LETTERS & SYMBOLS, SOLID WHITE
(4)	THERMOPLASTIC PAVEMENT MARKING LINE, 6" (WHITE SOLID LINE)	(8)	THERMOPLASTIC PAVEMENT MARKING LINE, 12" (YELLOW SOLID LINE)		

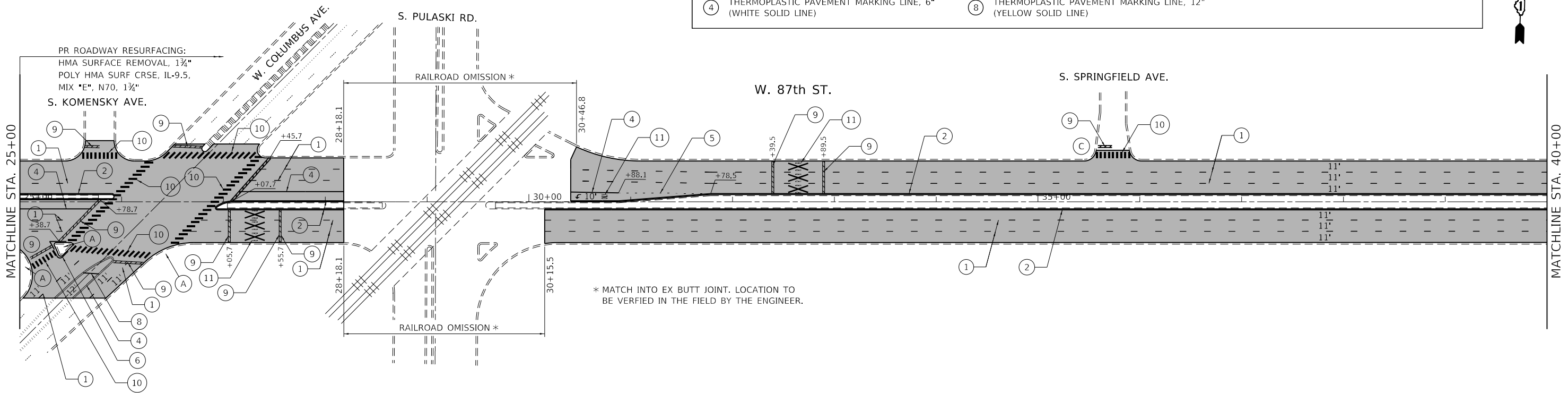

MODEL: Default; FILE: 87th St - 14+18.00 - 25+00.dwg; PLOT: 1/28/2021 10:11:11 AM; USER: ndp

Kaskaskia Engineering Group, LLC
 477 South Third Street
 Suite 200
 Geneva, Illinois 60134
 630.333.8107 phone
 www.kaskaskiaeng.com
 PROFESSIONAL REGISTERED ENGINEERS
 Illinois Professional Design Firm 34-067113
 1872041500
 38-088596

USER NAME = ndp	DESIGNED - NDP	REVISED -
PLOT SCALE = 100.0000' / in.	DRAWN - NDP	REVISED -
PLOT DATE = 1/28/2021	CHECKED - PJF	REVISED -
	DATE - 12/04/2020	REVISED -

**STATE OF ILLINOIS
DEPARTMENT OF TRANSPORTATION**

**ROADWAY & PAVEMENT MARKING PLAN
87TH STREET (KEELER AVE TO DAMEN AVE)**

SCALE: 1"=50'

SHEET 1 OF 6 SHEETS STA. 14+18.00 TO STA. 40+00.00

F.A.P. RTE.	SECTION	COUNTY	TOTAL SHEETS	SHEET NO.
395	2020-134-R5	COOK	45	9
CONTRACT NO. 62M12				
ILLINOIS FED. AID PROJECT				

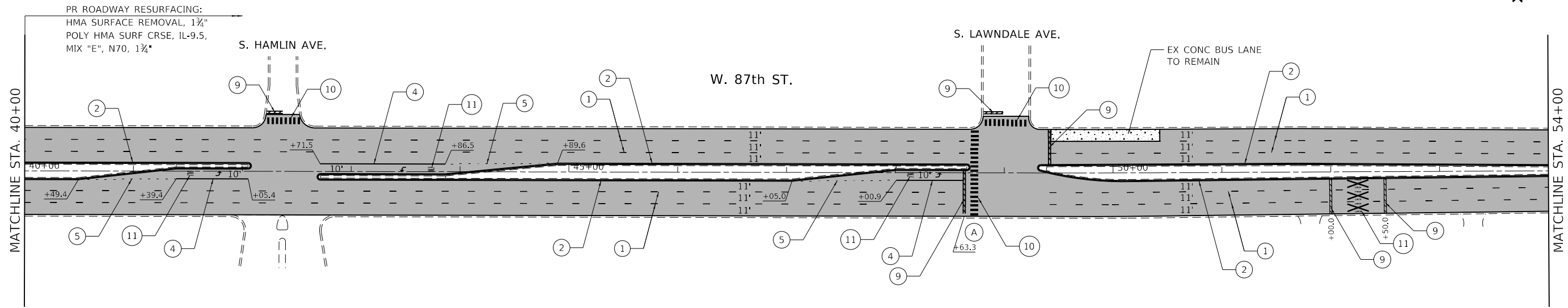

PLAN NOTES

ALL PAVEMENT MARKINGS SHALL BE INSTALLED ACCORDING TO DISTRICT ONE DETAIL TC-24 "CITY OF CHICAGO TYPICAL PAVEMENT MARKINGS."

RAISED REFLECTIVE PAVEMENT MARKERS SHALL BE INSTALLED ACCORDING TO DISTRICT ONE DETAIL TC-11 "RAISED REFLECTIVE PAVEMENT MARKERS (SNOW PLOW RESISTANT)."

EXISTING CONCRETE PATCHES ARE SHOWN FOR CONTRACTORS REFERENCE ONLY AND SHALL REMAIN IN PLACE. MILLING AND OVERLAY OPERATIONS SHALL BUTT AGAINST CONCRETE EDGES.

SIDEWALK LEGEND

- (A) PROPOSED ADA RAMP IMPROVEMENTS, SEE DETAIL SHEETS
- (B) PROPOSED ADA RAMP IMPROVEMENTS, SEE DETAIL PD-01B
- (C) PROPOSED ADA RAMP IMPROVEMENTS, SEE DETAIL PD-04A

PAVEMENT MARKING LEGEND

- (1) THERMOPLASTIC PAVEMENT MARKING LINE, 4" (WHITE SKIP DASH LINE - 18" SKIP, 6" DASH)
- (2) THERMOPLASTIC PAVEMENT MARKING LINE, 4" (YELLOW SOLID LINE)
- (3) THERMOPLASTIC PAVEMENT MARKING LINE, 4" (DOUBLE YELLOW SOLID LINES @ 8" C-C)
- (4) THERMOPLASTIC PAVEMENT MARKING LINE, 6" (WHITE SOLID LINE)
- (5) THERMOPLASTIC PAVEMENT MARKING LINE, 6" (WHITE SKIP DASH LINE - 6" SKIP, 2" DASH)
- (6) THERMOPLASTIC PAVEMENT MARKING LINE, 8" (WHITE SOLID LINE)
- (7) THERMOPLASTIC PAVEMENT MARKING LINE, 12" (WHITE SOLID LINE)
- (8) THERMOPLASTIC PAVEMENT MARKING LINE, 12" (YELLOW SOLID LINE)
- (9) THERMOPLASTIC PAVEMENT MARKING LINE, 24" (WHITE SOLID LINE - STOP BAR)
- (10) THERMOPLASTIC PAVEMENT MARKING LINE, 24" (WHITE SOLID LINE - CROSS WALKS)
- (11) PAVEMENT MARKING LETTERS & SYMBOLS, SOLID WHITE

PR ROADWAY RESURFACING:
HMA SURFACE REMOVAL, 1 3/4"
POLY HMA SURF CRSE, IL-9.5,
MIX "E", N70, 1 3/4"

S. CENTRAL PARK AVE.

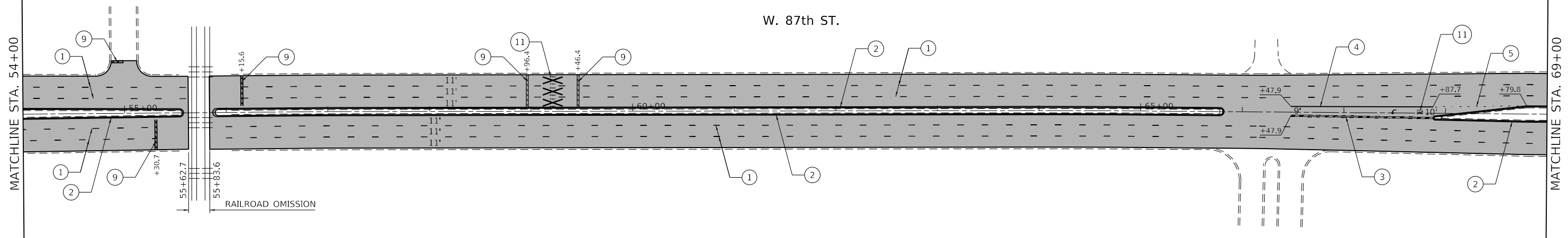

MODEL: Default
FILE NAME: P:\1317\07_PTB193-16_87th St\DOT\CAD_Sheets\162M12-ctb-design_02.dgn

Kaskaskia
Engineering Group, LLC
477 South Third Street
Suite 200
Geneva, Illinois 60134
630.333.8107 phone
www.kaskaskiaeng.com
PROFESSIONAL ENGINEERS
Illinois Professional Design Firm
34-06713
12/2/2020
38-388536

USER NAME = ndp	DESIGNED - NDP	REVISED -
PLOT SCALE = 100.0000' / in.	DRAWN - NDP	REVISED -
PLOT DATE = 12/3/2020	CHECKED - PJF	REVISED -
	DATE - 12/04/2020	REVISED -

**STATE OF ILLINOIS
DEPARTMENT OF TRANSPORTATION**

**ROADWAY & PAVEMENT MARKING PLAN
87TH STREET (KEELER AVE TO DAMEN AVE)**

SCALE: 1"=50' SHEET 2 OF 6 SHEETS STA. 40+00.00 TO STA. 69+00.00

F.A.P. RTE.	SECTION	COUNTY	TOTAL SHEETS	SHEET NO.
395	2020-134-R5	COOK	45	10
CONTRACT NO. 62M12				

ILLINOIS FED. AID PROJECT

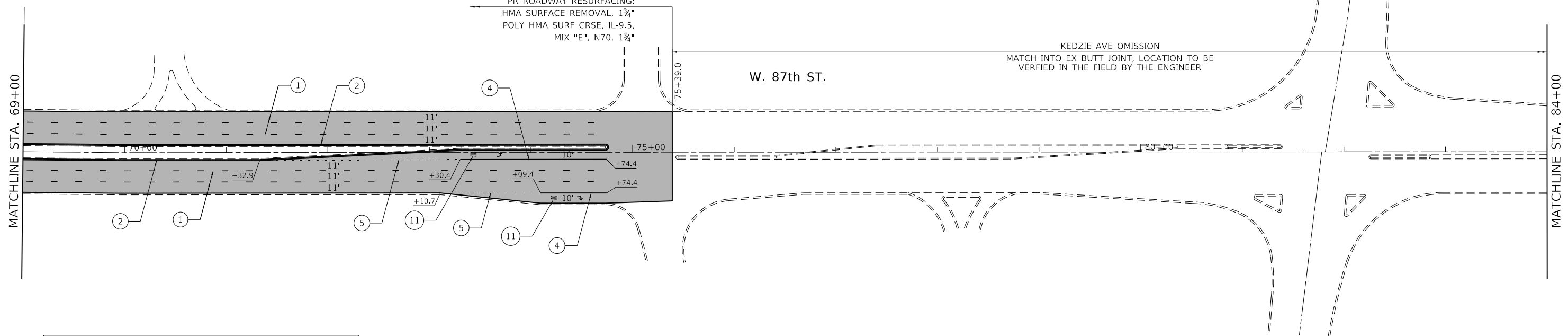

PLAN NOTES

ALL PAVEMENT MARKINGS SHALL BE INSTALLED ACCORDING TO DISTRICT ONE DETAIL TC-24 "CITY OF CHICAGO TYPICAL PAVEMENT MARKINGS."

RAISED REFLECTIVE PAVEMENT MARKERS SHALL BE INSTALLED ACCORDING TO DISTRICT ONE DETAIL TC-11 "RAISED REFLECTIVE PAVEMENT MARKERS (SNOW PLOW RESISTANT)."

EXISTING CONCRETE PATCHES ARE SHOWN FOR CONTRACTORS REFERENCE ONLY AND SHALL REMAIN IN PLACE. MILLING AND OVERLAY OPERATIONS SHALL BUTT AGAINST CONCRETE EDGES.

SIDEWALK LEGEND

- (A) PROPOSED ADA RAMP IMPROVEMENTS, SEE DETAIL SHEETS
- (B) PROPOSED ADA RAMP IMPROVEMENTS, SEE DETAIL PD-01B
- (C) PROPOSED ADA RAMP IMPROVEMENTS, SEE DETAIL PD-04A

PAVEMENT MARKING LEGEND

- (1) THERMOPLASTIC PAVEMENT MARKING LINE, 4" (WHITE SKIP DASH LINE - 18' SKIP, 6' DASH)
- (2) THERMOPLASTIC PAVEMENT MARKING LINE, 4" (YELLOW SOLID LINE)
- (3) THERMOPLASTIC PAVEMENT MARKING LINE, 4" (DOUBLE YELLOW SOLID LINES @ 8" C-C)
- (4) THERMOPLASTIC PAVEMENT MARKING LINE, 6" (WHITE SOLID LINE)
- (5) THERMOPLASTIC PAVEMENT MARKING LINE, 6" (WHITE SKIP DASH LINE - 6' SKIP, 2' DASH)
- (6) THERMOPLASTIC PAVEMENT MARKING LINE, 8" (WHITE SOLID LINE)
- (7) THERMOPLASTIC PAVEMENT MARKING LINE, 12" (WHITE SOLID LINE)
- (8) THERMOPLASTIC PAVEMENT MARKING LINE, 12" (YELLOW SOLID LINE)
- (9) THERMOPLASTIC PAVEMENT MARKING LINE, 24" (WHITE SOLID LINE - STOP BAR)
- (10) THERMOPLASTIC PAVEMENT MARKING LINE, 24" (WHITE SOLID LINE - CROSS WALKS)
- (11) PAVEMENT MARKING LETTERS & SYMBOLS, SOLID WHITE

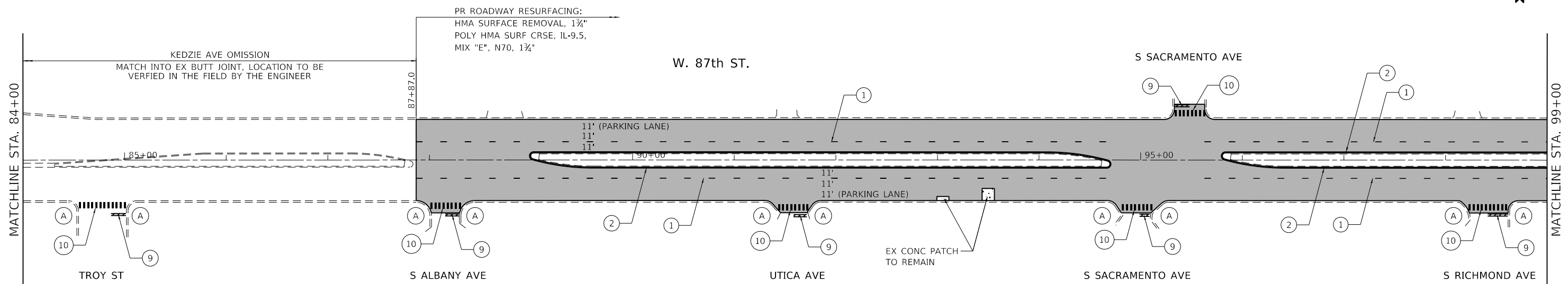

MODEL: D:\dgn\11... FILE NAME: P:\13137.07_PTB193-16_87th St\DOT\CAD_Sheets\162M12-cht-ede\p1_03.dgn



USER NAME = ndp	DESIGNED - NDP	REVISED -
PLOT SCALE = 100.0000' / in.	DRAWN - NDP	REVISED -
PLOT DATE = 12/3/2020	CHECKED - PJF	REVISED -
	DATE - 12/04/2020	REVISED -

**STATE OF ILLINOIS
DEPARTMENT OF TRANSPORTATION**

**ROADWAY & PAVEMENT MARKING PLAN
87TH STREET (KEELER AVE TO DAMEN AVE)**

SCALE: 1"=50' SHEET 3 OF 6 SHEETS STA. 69+00.00 TO STA. 99+00.00

F.A.P. RTE.	SECTION	COUNTY	TOTAL SHEETS	SHEET NO.
395	2020-134-R5	COOK	45	11
CONTRACT NO. 62M12				
ILLINOIS FED. AID PROJECT				

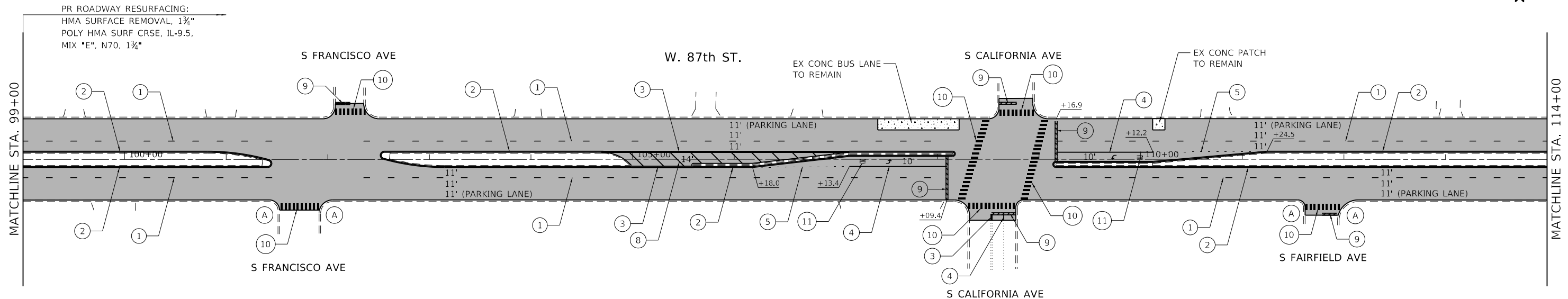

PLAN NOTES

ALL PAVEMENT MARKINGS SHALL BE INSTALLED ACCORDING TO DISTRICT ONE DETAIL TC-24 "CITY OF CHICAGO TYPICAL PAVEMENT MARKINGS."

RAISED REFLECTIVE PAVEMENT MARKERS SHALL BE INSTALLED ACCORDING TO DISTRICT ONE DETAIL TC-11 "RAISED REFLECTIVE PAVEMENT MARKERS (SNOW PLOW RESISTANT)."

EXISTING CONCRETE PATCHES ARE SHOWN FOR CONTRACTORS REFERENCE ONLY AND SHALL REMAIN IN PLACE. MILLING AND OVERLAY OPERATIONS SHALL BUTT AGAINST CONCRETE EDGES.

SIDEWALK LEGEND

- (A) PROPOSED ADA RAMP IMPROVEMENTS, SEE DETAIL SHEETS
- (B) PROPOSED ADA RAMP IMPROVEMENTS, SEE DETAIL PD-01B
- (C) PROPOSED ADA RAMP IMPROVEMENTS, SEE DETAIL PD-04A

PAVEMENT MARKING LEGEND

- ① THERMOPLASTIC PAVEMENT MARKING LINE, 4" (WHITE SKIP DASH LINE - 18" SKIP, 6" DASH)
- ② THERMOPLASTIC PAVEMENT MARKING LINE, 4" (YELLOW SOLID LINE)
- ③ THERMOPLASTIC PAVEMENT MARKING LINE, 4" (DOUBLE YELLOW SOLID LINES @ 8" C-C)
- ④ THERMOPLASTIC PAVEMENT MARKING LINE, 6" (WHITE SOLID LINE)
- ⑤ THERMOPLASTIC PAVEMENT MARKING LINE, 6" (WHITE SKIP DASH LINE - 6' SKIP, 2' DASH)
- ⑥ THERMOPLASTIC PAVEMENT MARKING LINE, 8" (WHITE SOLID LINE)
- ⑦ THERMOPLASTIC PAVEMENT MARKING LINE, 12" (WHITE SOLID LINE)
- ⑧ THERMOPLASTIC PAVEMENT MARKING LINE, 12" (YELLOW SOLID LINE)
- ⑨ THERMOPLASTIC PAVEMENT MARKING LINE, 24" (WHITE SOLID LINE - STOP BAR)
- ⑩ THERMOPLASTIC PAVEMENT MARKING LINE, 24" (WHITE SOLID LINE - CROSS WALKS)
- ⑪ PAVEMENT MARKING LETTERS & SYMBOLS, SOLID WHITE

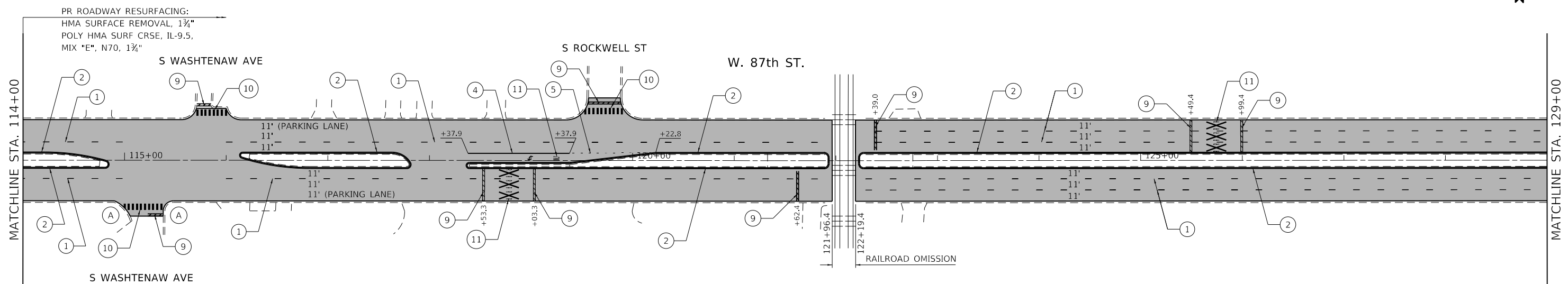

MODEL: D:\p\1137\07_PTB193-16_87th St\DOT\CAD_Sheets\162M12-ctb-ede\p_04.dgn
 FILE NAME: P:\1137\07_PTB193-16_87th St\DOT\CAD_Sheets\162M12-ctb-ede\p_04.dgn

Kaskaskia
 Engineering Group, LLC
 477 South Third Street
 Suite 200
 Geneva, Illinois 60134
 630.333.8107 phone
 www.kaskaskiaeng.com
 PROFESSIONAL ENGINEERING
 Illinois Professional Design Firm 34-06713
 12/2/2020
 Professional Engineering Group 28-388536

USER NAME = ndp	DESIGNED - NDP	REVISED -
PLOT SCALE = 100,0000 ' / in.	DRAWN - NDP	REVISED -
PLOT DATE = 12/3/2020	CHECKED - PJF	REVISED -
	DATE - 12/04/2020	REVISED -

**STATE OF ILLINOIS
 DEPARTMENT OF TRANSPORTATION**

**ROADWAY & PAVEMENT MARKING PLAN
 87TH STREET (KEELER AVE TO DAMEN AVE)**
 SCALE: 1"=50' SHEET 4 OF 6 SHEETS STA. 99+00.00 TO STA. 129+00.00

F.A.P. RTE.	SECTION	COUNTY	TOTAL SHEETS	SHEET NO.
395	2020-134-R5	COOK	45	12
CONTRACT NO. 62M12				
ILLINOIS FED. AID PROJECT				

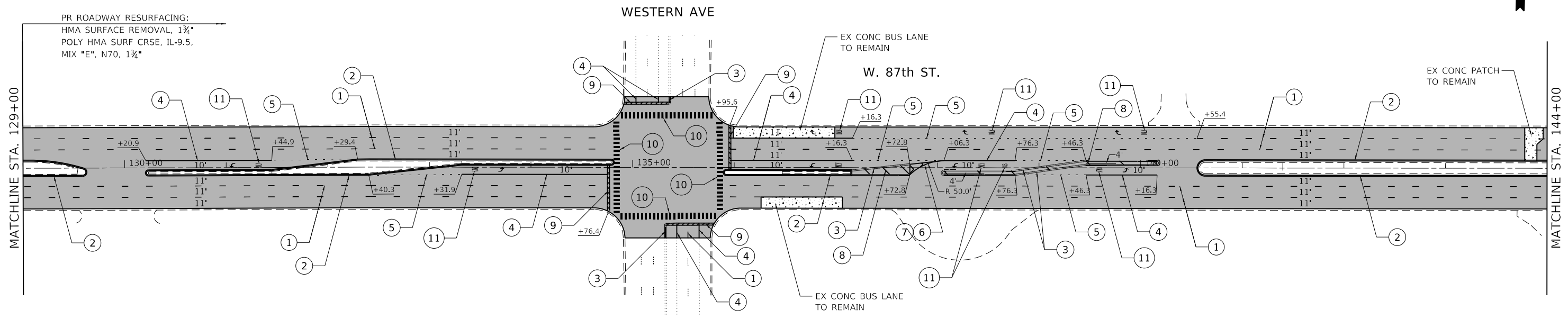

PLAN NOTES

ALL PAVEMENT MARKINGS SHALL BE INSTALLED ACCORDING TO DISTRICT ONE DETAIL TC-24 "CITY OF CHICAGO TYPICAL PAVEMENT MARKINGS."

RAISED REFLECTIVE PAVEMENT MARKERS SHALL BE INSTALLED ACCORDING TO DISTRICT ONE DETAIL TC-11 "RAISED REFLECTIVE PAVEMENT MARKERS (SNOW PLOW RESISTANT)."

EXISTING CONCRETE PATCHES ARE SHOWN FOR CONTRACTORS REFERENCE ONLY AND SHALL REMAIN IN PLACE. MILLING AND OVERLAY OPERATIONS SHALL BUTT AGAINST CONCRETE EDGES.

SIDEWALK LEGEND

(A) PROPOSED ADA RAMP IMPROVEMENTS, SEE DETAIL SHEETS

(B) PROPOSED ADA RAMP IMPROVEMENTS, SEE DETAIL PD-01B

(C) PROPOSED ADA RAMP IMPROVEMENTS, SEE DETAIL PD-04A

PAVEMENT MARKING LEGEND

(1) THERMOPLASTIC PAVEMENT MARKING LINE, 4" (WHITE SKIP DASH LINE - 18" SKIP, 6" DASH)

(2) THERMOPLASTIC PAVEMENT MARKING LINE, 4" (YELLOW SOLID LINE)

(3) THERMOPLASTIC PAVEMENT MARKING LINE, 4" (DOUBLE YELLOW SOLID LINES @ 8" C-C)

(4) THERMOPLASTIC PAVEMENT MARKING LINE, 6" (WHITE SOLID LINE)

(5) THERMOPLASTIC PAVEMENT MARKING LINE, 6" (WHITE SKIP DASH LINE - 6' SKIP, 2' DASH)

(6) THERMOPLASTIC PAVEMENT MARKING LINE, 8" (WHITE SOLID LINE)

(7) THERMOPLASTIC PAVEMENT MARKING LINE, 12" (WHITE SOLID LINE)

(8) THERMOPLASTIC PAVEMENT MARKING LINE, 12" (YELLOW SOLID LINE)

(9) THERMOPLASTIC PAVEMENT MARKING LINE, 24" (WHITE SOLID LINE - STOP BAR)

(10) THERMOPLASTIC PAVEMENT MARKING LINE, 24" (WHITE SOLID LINE - CROSS WALKS)

(11) PAVEMENT MARKING LETTERS & SYMBOLS, SOLID WHITE

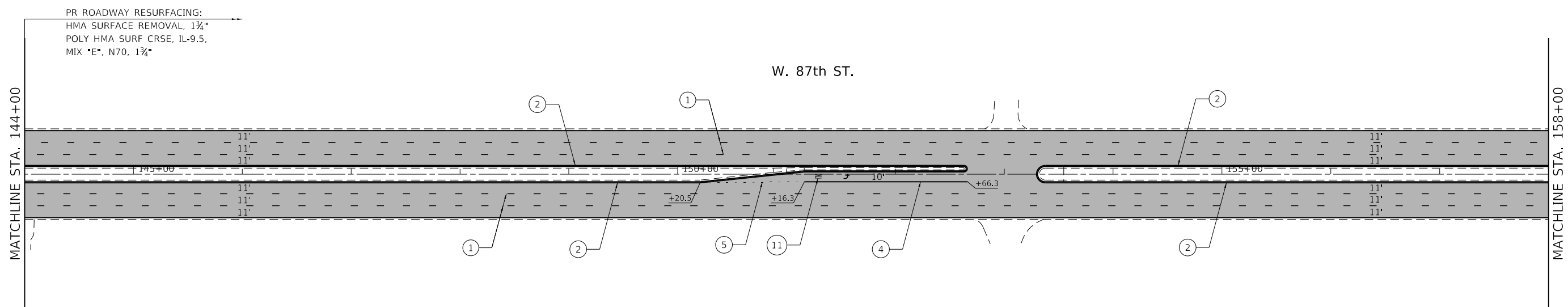

MODEL: D:\64\11... FILE NAME: P:\13137.07_PTB193-16_87th St_12-21-2020.dwg



USER NAME = ndp	DESIGNED - NDP	REVISED -
PLOT SCALE = 100.0000' / in.	DRAWN - NDP	REVISED -
PLOT DATE = 12/3/2020	CHECKED - PJF	REVISED -
	DATE - 12/04/2020	REVISED -

**STATE OF ILLINOIS
DEPARTMENT OF TRANSPORTATION**

**ROADWAY & PAVEMENT MARKING PLAN
87TH STREET (KEELER AVE TO DAMEN AVE)**

SCALE: 1"=50' SHEET 5 OF 6 SHEETS STA. 129+00.00 TO STA. 158+00.00

F.A.P. RTE. 395	SECTION 2020-134-R5	COUNTY COOK	TOTAL SHEETS 45	SHEET NO. 13
CONTRACT NO. 62M12				
ILLINOIS FED. AID PROJECT				

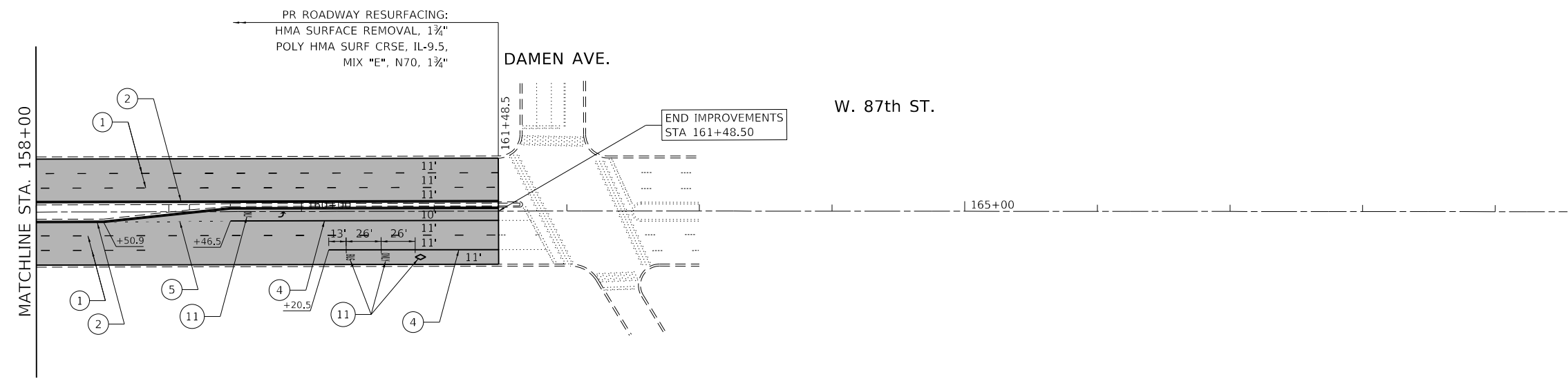

PLAN NOTES

ALL PAVEMENT MARKINGS SHALL BE INSTALLED ACCORDING TO DISTRICT ONE DETAIL TC-24 "CITY OF CHICAGO TYPICAL PAVEMENT MARKINGS."

RAISED REFLECTIVE PAVEMENT MARKERS SHALL BE INSTALLED ACCORDING TO DISTRICT ONE DETAIL TC-11 "RAISED REFLECTIVE PAVEMENT MARKERS (SNOW PLOW RESISTANT)."

EXISTING CONCRETE PATCHES ARE SHOWN FOR CONTRACTORS REFERENCE ONLY AND SHALL REMAIN IN PLACE. MILLING AND OVERLAY OPERATIONS SHALL BUTT AGAINST CONCRETE EDGES.

SIDEWALK LEGEND

(A) PROPOSED ADA RAMP IMPROVEMENTS, SEE DETAIL SHEETS
 (B) PROPOSED ADA RAMP IMPROVEMENTS, SEE DETAIL PD-01B
 (C) PROPOSED ADA RAMP IMPROVEMENTS, SEE DETAIL PD-04A

PAVEMENT MARKING LEGEND

(1) THERMOPLASTIC PAVEMENT MARKING LINE, 4" (WHITE SKIP DASH LINE - 18' SKIP, 6' DASH)	(5) THERMOPLASTIC PAVEMENT MARKING LINE, 6" (WHITE SKIP DASH LINE - 6' SKIP, 2' DASH)	(9) THERMOPLASTIC PAVEMENT MARKING LINE, 24" (WHITE SOLID LINE - STOP BAR)
(2) THERMOPLASTIC PAVEMENT MARKING LINE, 4" (YELLOW SOLID LINE)	(6) THERMOPLASTIC PAVEMENT MARKING LINE, 8" (WHITE SOLID LINE)	(10) THERMOPLASTIC PAVEMENT MARKING LINE, 24" (WHITE SOLID LINE - CROSS WALKS)
(3) THERMOPLASTIC PAVEMENT MARKING LINE, 4" (DOUBLE YELLOW SOLID LINES @ 8" C-C)	(7) THERMOPLASTIC PAVEMENT MARKING LINE, 12" (WHITE SOLID LINE)	(11) PAVEMENT MARKING LETTERS & SYMBOLS, SOLID WHITE
(4) THERMOPLASTIC PAVEMENT MARKING LINE, 6" (WHITE SOLID LINE)	(8) THERMOPLASTIC PAVEMENT MARKING LINE, 12" (YELLOW SOLID LINE)	

MODEL: D:\64611... FILE NAME: P:\19-1137-07_PTB193-16_87th St\DOT\CAD_Sheets\162M12-ht-design_06.dgn



USER NAME = ndp	DESIGNED - NDP	REVISED -
PLOT SCALE = 100.0000' / in.	DRAWN - NDP	REVISED -
PLOT DATE = 12/3/2020	CHECKED - PJF	REVISED -
	DATE - 12/04/2020	REVISED -

**STATE OF ILLINOIS
 DEPARTMENT OF TRANSPORTATION**

**ROADWAY & PAVEMENT MARKING PLAN
 87TH STREET (KEELER AVE TO DAMEN AVE)**

SCALE: 1"=50' SHEET 6 OF 6 SHEETS STA. 158+00.00 TO STA. 161+48.50

F.A.P. RTE.	SECTION	COUNTY	TOTAL SHEETS	SHEET NO.
395	2020-134-R5	COOK	45	14
CONTRACT NO. 62M12				
ILLINOIS FED. AID PROJECT				

87TH STREET

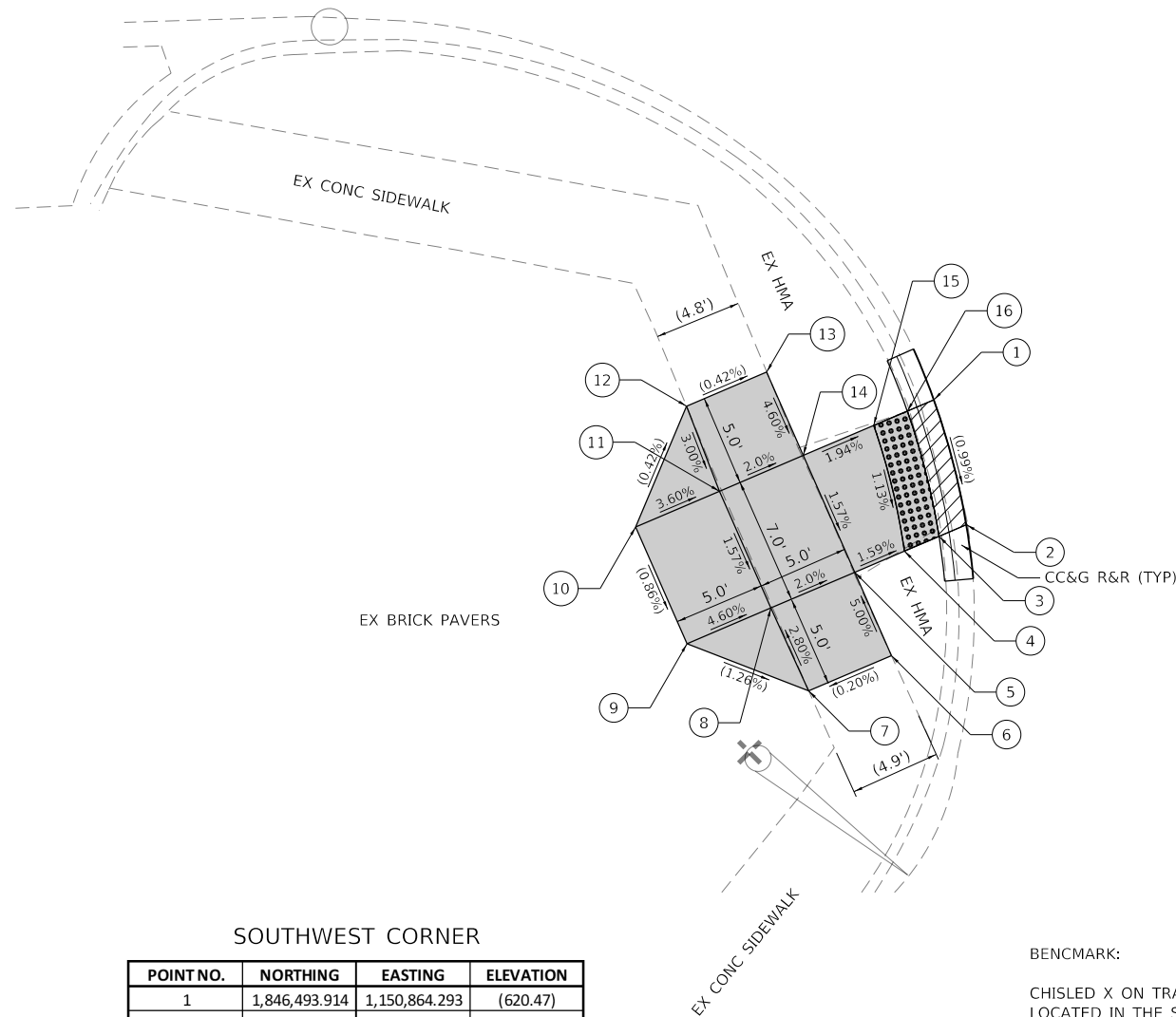

SOUTHWEST CORNER

POINT NO.	NORTHING	EASTING	ELEVATION
1	1,846,493.914	1,150,864.293	(620.47)
2	1,846,487.064	1,150,866.074	(620.40)
3	1,846,486.426	1,150,864.577	620.39
4	1,846,485.616	1,150,862.676	620.42
5	1,846,484.455	1,150,859.954	620.47
6	1,846,479.878	1,150,861.967	(620.72)
7	1,846,477.944	1,150,857.431	(620.71)
8	1,846,482.494	1,150,855.354	620.57
9	1,846,480.534	1,150,850.754	(620.80)
10	1,846,486.942	1,150,847.936	(620.86)
11	1,846,488.903	1,150,852.536	620.68
12	1,846,493.568	1,150,850.729	(620.83)
13	1,846,495.441	1,150,855.123	(620.81)
14	1,846,490.863	1,150,857.136	620.58
15	1,846,492.508	1,150,860.994	620.50
16	1,846,493.294	1,150,862.837	620.46

BENCHMARK:

CHISLED X ON TRAFFIC SIGNAL FOUNDATION
 LOCATED IN THE SOUTHWEST CORNER OF
 87TH STREET AND COLUMBUS AVE.
 ELEVATION = 621.16

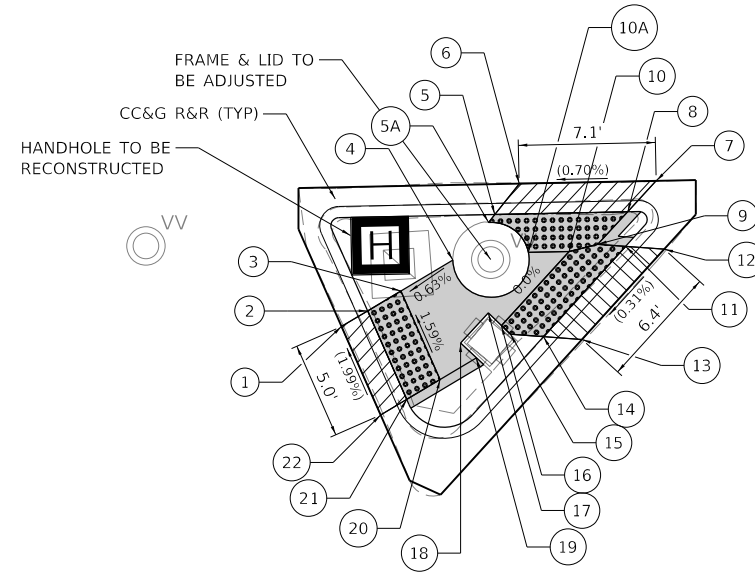
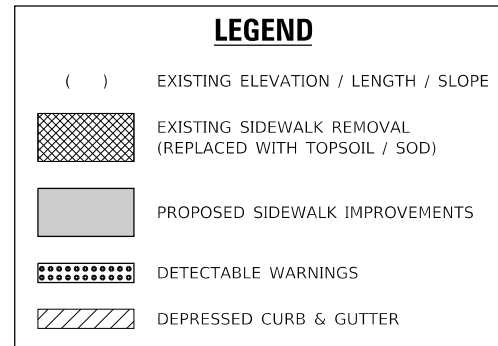

NOTE:
 EX TRAFFIC SIGNAL & FOUNDATION
 TO REMAIN UNDISTURBED.

COLUMBUS AVE

SOUTHWEST ISLAND

POINT NO.	NORTHING	EASTING	ELEVATION
1	1,846,509.467	1,150,890.052	(620.64)
2	1,846,510.283	1,150,891.419	620.63
3	1,846,511.315	1,150,893.149	620.65
4	1,846,512.927	1,150,895.851	620.67
5	1,846,515.303	1,150,898.036	620.67
5A	1,846,514.897	1,150,897.714	620.67
6	1,846,516.909	1,150,899.307	(620.69)
7	1,846,517.053	1,150,906.445	(620.74)
8	1,846,515.443	1,150,904.962	620.72
9	1,846,513.750	1,150,903.403	620.73
10	1,846,513.381	1,150,901.912	620.73
10A	1,846,513.338	1,150,899.786	620.74
11	1,846,513.646	1,150,904.857	620.70
12	1,846,513.503	1,150,906.863	(620.73)
13	1,846,508.796	1,150,902.580	(620.71)
14	1,846,508.940	1,150,900.574	620.70
15	1,846,509.063	1,150,898.850	620.73
16	1,846,509.510	1,150,898.389	620.73
17	1,846,510.178	1,150,897.701	620.73
18	1,846,508.605	1,150,896.255	620.69
19	1,846,507.839	1,150,897.081	620.69
20	1,846,506.707	1,150,895.184	620.73
21	1,846,505.675	1,150,893.454	620.73
22	1,846,504.859	1,150,892.087	(620.74)

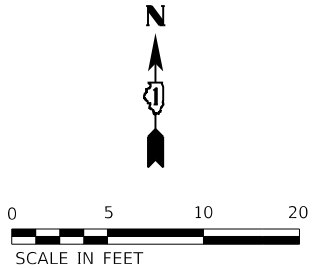

MODEL: D:\64611
 FILE NAME: P:\13-1137-07_PTB193-16_87th_SWO_IDOT\CAD_Sheets\162M12-sh-ADA_01.dwg



477 South Third Street Suite 200 Geneva, Illinois 60134 630.333.8187 phone www.kaskaskiaeng.com	USER NAME = ndp	DESIGNED - NDP	REVISED -
PROFESSIONAL DESIGNER Illinois Professional Design Firm 343724133 38-388536	PLOT SCALE = 10.0000" / in.	DRAWN - NDP	REVISED -
	PLOT DATE = 12/3/2020	CHECKED - PJF	REVISED -
		DATE - 12/04/2020	REVISED -

STATE OF ILLINOIS
 DEPARTMENT OF TRANSPORTATION

ADA RAMP IMPROVEMENT PLAN
 87TH STREET & COLUMBUS AVE

SCALE: 1"=5' SHEET 1 OF 11 SHEETS STA. TO STA.

F.A.P. RTE. 395	SECTION 2020-134-R5	COUNTY COOK	TOTAL SHEETS 45	SHEET NO. 16
CONTRACT NO. 62M12				
ILLINOIS FED. AID PROJECT				

COLUMBUS AVE

87TH STREET

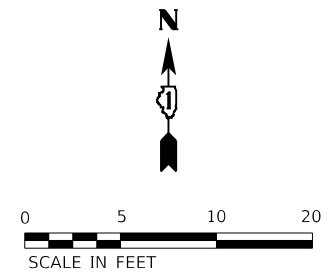
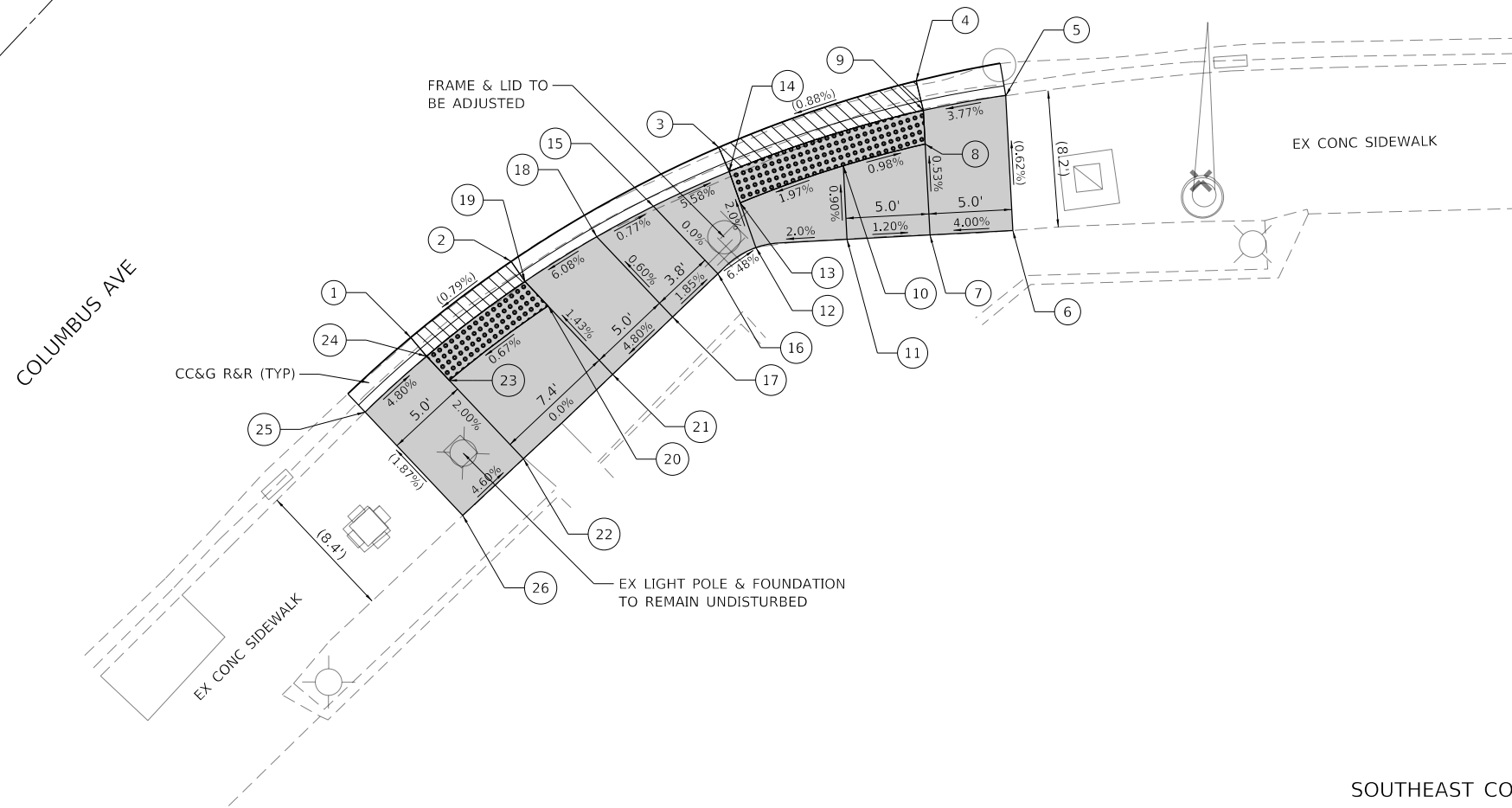

BENCHMARK:

CHISLED X ON TRAFFIC SIGNAL FOUNDATION
LOCATED IN THE SOUTHEAST CORNER OF
87TH STREET AND COLUMBUS AVE.
ELEVATION = 621.14

LEGEND	
()	EXISTING ELEVATION / LENGTH / SLOPE
	EXISTING SIDEWALK REMOVAL (REPLACED WITH TOPSOIL / SOD)
	PROPOSED SIDEWALK IMPROVEMENTS
	DETECTABLE WARNINGS
	DEPRESSED CURB & GUTTER

SOUTHEAST CORNER

POINT NO.	NORTHING	EASTING	ELEVATION
1	1,846,503.319	1,150,979.133	(620.69)
2	1,846,507.899	1,150,985.185	(620.75)
3	1,846,514.770	1,150,997.685	(620.75)
4	1,846,518.767	1,151,009.574	(620.86)
5	1,846,517.874	1,151,014.973	(621.04)
6	1,846,509.760	1,151,015.400	(621.09)
7	1,846,509.495	1,151,010.407	620.89
8	1,846,514.968	1,151,010.117	620.86
9	1,846,516.993	1,151,010.010	620.85
10	1,846,513.659	1,151,005.180	620.91
11	1,846,509.231	1,151,005.415	620.95
12	1,846,508.737	1,150,999.924	620.84
13	1,846,511.423	1,150,998.979	620.78
14	1,846,513.313	1,150,998.314	620.74
15	1,846,511.222	1,150,993.749	621.02
16	1,846,507.162	1,150,997.635	621.02
17	1,846,504.551	1,150,994.907	621.09
18	1,846,509.387	1,150,990.337	621.05
19	1,846,506.686	1,150,986.010	620.74
20	1,846,505.212	1,150,987.403	620.77
21	1,846,501.094	1,150,991.295	620.85
22	1,846,496.015	1,150,985.917	620.85
23	1846500.736	1150981.455	620.72
24	1846502.192	1150980.079	620.68
25	1846498.827	1150976.379	(620.92)
26	1846492.601	1150982.264	(621.08)

MODEL: D:\d\p\11... FILE NAME: P:\19-1137-07_PTB193-16_87th_SVC_IDOT\CAD_Sheets\162M12-sh-ADA_02.dwg

Kaskaskia
Engineering Group, LLC
477 South Third Street
Suite 200
Geneva, Illinois 60134
630.333.8187 phone
www.kaskaskiaeng.com
PROFESSIONAL REGISTERED ENGINEERS
Illinois Professional Design Firm
34372641
38-388536

USER NAME = ndp	DESIGNED - NDP	REVISED -
PLOT SCALE = 10.0000' / in.	DRAWN - NDP	REVISED -
PLOT DATE = 12/3/2020	CHECKED - PJF	REVISED -
	DATE - 12/04/2020	REVISED -

STATE OF ILLINOIS
DEPARTMENT OF TRANSPORTATION

ADA RAMP IMPROVEMENT PLAN
87TH STREET & COLUMBUS AVE

SCALE: 1"=5' SHEET 2 OF 11 SHEETS STA. TO STA.

F.A.P. RTE. 395	SECTION 2020-134-R5	COUNTY COOK	TOTAL SHEETS 45	SHEET NO. 17
CONTRACT NO. 62M12				
ILLINOIS FED. AID PROJECT				

87TH STREET

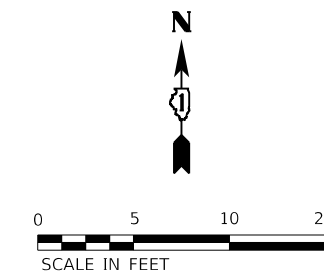
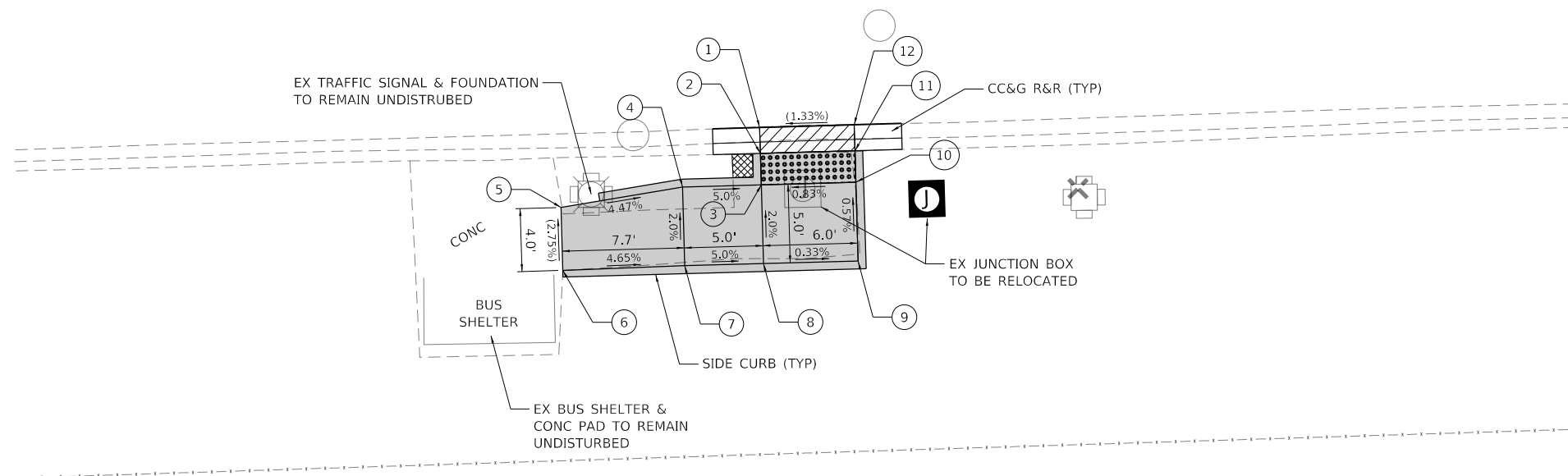

BENCHMARK:

CHISLED X ON TRAFFIC SIGNAL FOUNDATION
 LOCATED IN THE ON THE SOUTH SIDE OF
 87TH STREET, TO THE EAST OF THE PROPOSED
 IMPROVEMENTS.
 ELEVATION = 621.14

LEGEND	
()	EXISTING ELEVATION / LENGTH / SLOPE
	EXISTING SIDEWALK REMOVAL (REPLACED WITH TOPSOIL / SOD)
	PROPOSED SIDEWALK IMPROVEMENTS
	DETECTABLE WARNINGS
	DEPRESSED CURB & GUTTER

S. LAWDALE AVE - BUS SHELTER ACCESS

POINT NO.	NORTHING	EASTING	ELEVATION
1	1,846,586.958	1,153,222.638	(621.35)
2	1,846,585.318	1,153,222.686	621.34
3	1,846,583.319	1,153,222.744	621.38
4	1,846,583.182	1,153,217.746	621.63
5	1,846,581.886	1,153,210.032	(621.98)
6	1,846,577.888	1,153,210.148	(622.09)
7	1,846,578.184	1,153,217.884	621.73
8	1,846,578.321	1,153,222.882	621.48
9	1,846,578.485	1,153,228.879	621.46
10	1,846,583.484	1,153,228.742	621.43
11	1,846,585.483	1,153,228.684	621.42
12	1,846,587.129	1,153,228.636	(621.43)

MODEL: D:\64611... FILE NAME: P:\19-1137-07_PTB193-16_87th St_01DOT\CAD_Sheets\162M12-ht-ADA_03.dwg

Kaskaskia
 Engineering Group, LLC
 477 South Third Street
 Suite 200
 Geneva, Illinois 60134
 630.333.8187 phone
 www.kaskaskiaeng.com
 PROFESSIONAL ENGINEERING
 Illinois Professional Design Firm
 34-067-13
 28-388536

USER NAME = ndp	DESIGNED - NDP	REVISED -
PLOT SCALE = 10.0000 ' / in.	DRAWN - NDP	REVISED -
PLOT DATE = 12/3/2020	CHECKED - PJF	REVISED -
	DATE - 12/04/2020	REVISED -

**STATE OF ILLINOIS
 DEPARTMENT OF TRANSPORTATION**

**ADA RAMP IMPROVEMENT PLAN
 87TH STREET & S LAWDALE AVE**

SCALE: 1"=5' SHEET 3 OF 11 SHEETS STA. TO STA.

F.A.P. RTE.	SECTION	COUNTY	TOTAL SHEETS	SHEET NO.
395	2020-134-R5	COOK	45	18
CONTRACT NO. 62M12				
ILLINOIS FED. AID PROJECT				

87TH STREET

UTICA AVE

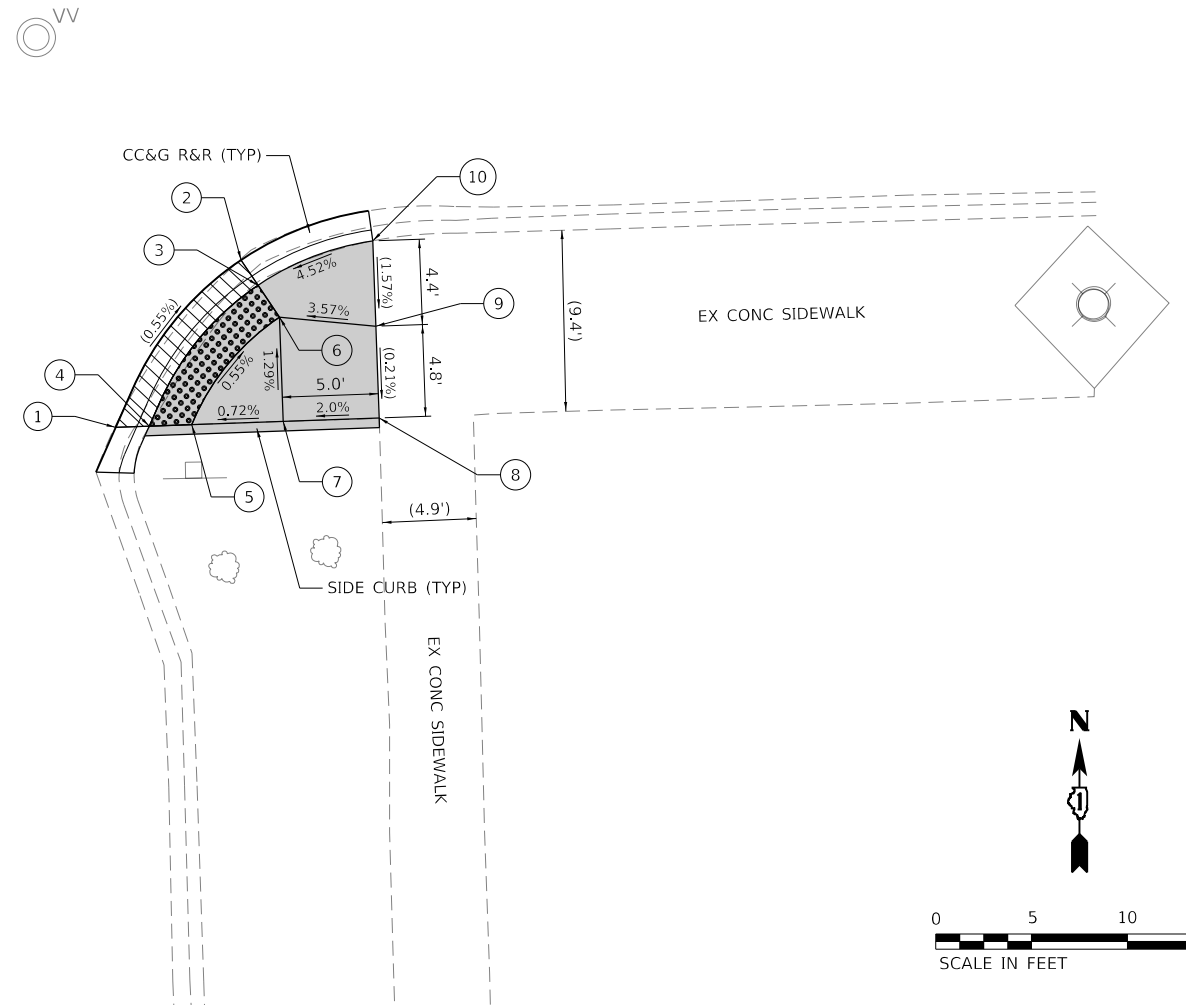
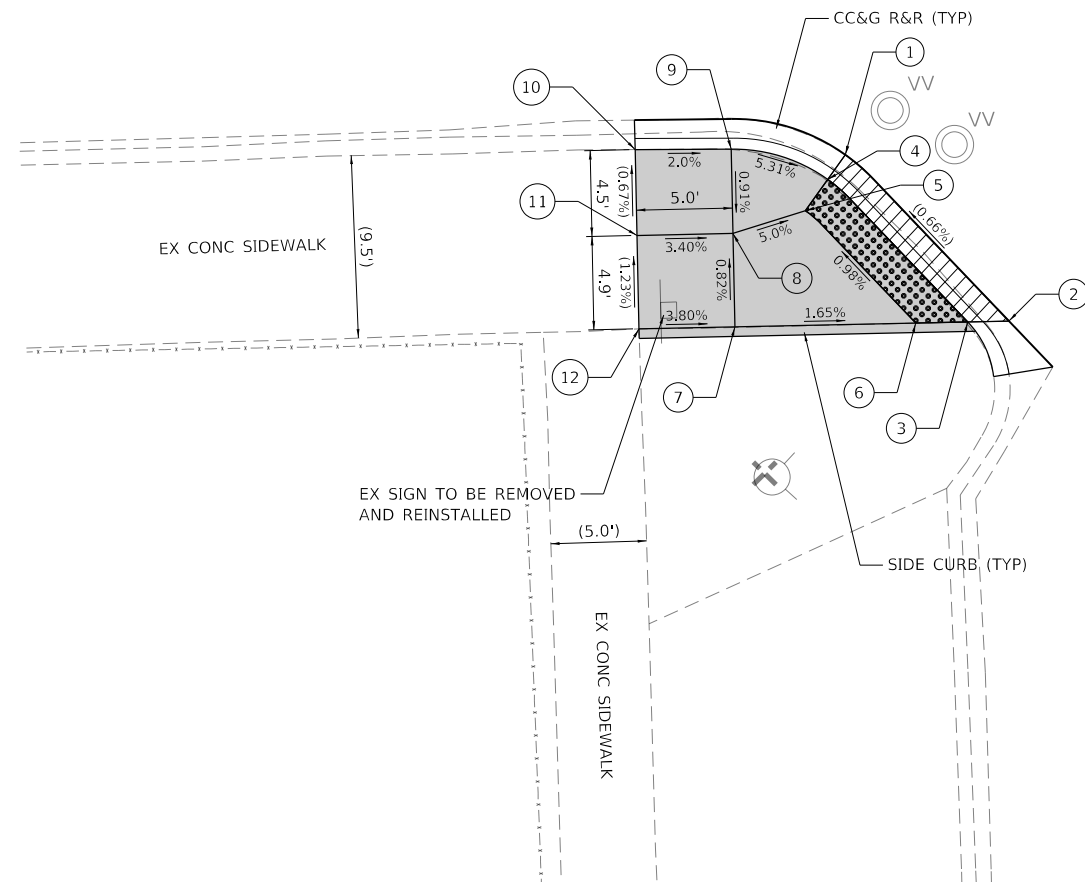

SOUTHWEST CORNER

POINT NO.	NORTHING	EASTING	ELEVATION
1	1,846,714.265	1,157,486.664	(624.82)
2	1,846,705.603	1,157,495.182	(624.90)
3	1,846,705.558	1,157,493.040	624.89
4	1,846,712.981	1,157,485.744	624.81
5	1,846,711.355	1,157,484.580	624.85
6	1,846,705.500	1,157,490.328	624.93
7	1,846,705.301	1,157,480.906	625.09
8	1,846,710.167	1,157,480.803	625.05
9	1,846,714.555	1,157,480.710	625.09
10	1,846,714.536	1,157,475.709	(625.19)
11	1,846,710.061	1,157,475.804	(625.22)
12	1,846,705.195	1,157,475.907	(625.28)

BENCHMARK:

NORTHWEST BOLT ON FIRE HYDRANT LOCATED IN THE SOUTHWEST CORNER OF 87TH STREET AND UTICA AVE.
ELEVATION = 625.84

SOUTHEAST CORNER

POINT NO.	NORTHING	EASTING	ELEVATION
1	1,846,706.473	1,157,523.454	(624.88)
2	1,846,715.186	1,157,529.992	(624.82)
3	1,846,713.876	1,157,530.875	624.81
4	1,846,706.535	1,157,525.208	624.87
5	1,846,706.614	1,157,527.429	624.89
6	1,846,712.217	1,157,531.992	624.85
7	1,846,706.783	1,157,532.185	624.92
8	1,846,706.960	1,157,537.182	(625.02)
9	1,846,711.743	1,157,537.012	(625.03)
10	1,846,716.186	1,157,536.855	(625.10)

LEGEND

- () EXISTING ELEVATION / LENGTH / SLOPE
- EXISTING SIDEWALK REMOVAL (REPLACED WITH TOPSOIL / SOD)
- PROPOSED SIDEWALK IMPROVEMENTS
- DETECTABLE WARNINGS
- DEPRESSED CURB & GUTTER

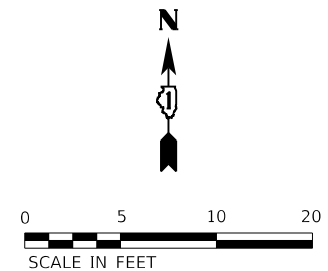

MODEL: D:\64\11... FILE NAME: P:\19-1137-07_PTB193-16_87th St_Utica Ave_Sheets\162M12-sh-a04_06.dwg

Kaskaskia
Engineering Group, LLC
477 South Third Street
Suite 200
Geneva, Illinois 60134
630.333.8187 phone
www.kaskaskiaeng.com
Professional Engineering Group

USER NAME = ndp	DESIGNED - NDP	REVISED -
PLOT SCALE = 10.0000' / in.	DRAWN - NDP	REVISED -
PLOT DATE = 12/3/2020	CHECKED - PJF	REVISED -
	DATE - 12/04/2020	REVISED -

STATE OF ILLINOIS
DEPARTMENT OF TRANSPORTATION

ADA RAMP IMPROVEMENT PLAN
87TH STREET & UTICA AVE

SCALE: 1"=5' SHEET 6 OF 11 SHEETS STA. TO STA.

F.A.P. RTE.	SECTION	COUNTY	TOTAL SHEETS	SHEET NO.
395	2020-134-R5	COOK	45	21
CONTRACT NO. 62M12				
ILLINOIS FED. AID PROJECT				

87TH STREET

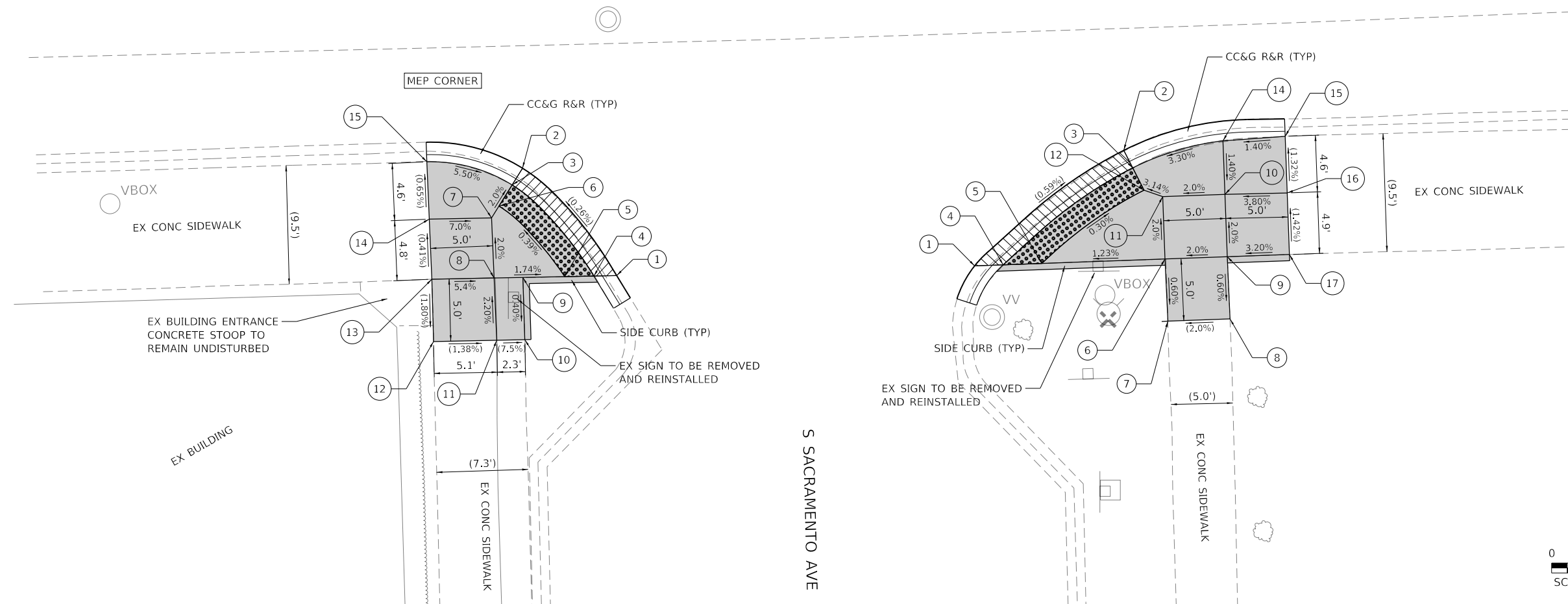

SOUTHWEST CORNER

POINT NO.	NORTHING	EASTING	ELEVATION
1	1,846,715.612	1,157,831.893	(624.98)
2	1,846,724.228	1,157,824.332	(624.95)
3	1,846,722.887	1,157,823.496	624.94
4	1,846,715.577	1,157,830.062	624.97
5	1,846,715.532	1,157,827.724	625.01
6	1,846,721.190	1,157,822.438	624.98
7	1,846,720.245	1,157,821.849	625.01
8	1,846,715.422	1,157,822.050	625.11
9	1,846,715.467	1,157,824.357	625.07
10	1,846,710.469	1,157,824.520	(625.05)
11	1,846,710.425	1,157,822.258	(625.22)
12	1,846,710.327	1,157,817.185	(625.29)
13	1,846,715.325	1,157,817.048	(625.38)
14	1,846,720.148	1,157,816.846	(625.36)
15	1,846,724.738	1,157,816.654	(625.33)

BENCHMARK:

SOUTH BOLT ON FIRE HYDRANT LOCATED IN THE SOUTHEAST CORNER OF 87TH STREET AND S SACRAMENTO AVE. ELEVATION = 627.32

LEGEND

- () EXISTING ELEVATION / LENGTH / SLOPE
- EXISTING SIDEWALK REMOVAL (REPLACED WITH TOPSOIL / SOD)
- PROPOSED SIDEWALK IMPROVEMENTS
- DETECTABLE WARNINGS
- DEPRESSED CURB & GUTTER

SOUTHEAST CORNER

POINT NO.	NORTHING	EASTING	ELEVATION
1	1,846,716.397	1,157,860.624	(625.01)
2	1,846,725.663	1,157,872.603	(624.92)
3	1,846,724.253	1,157,873.316	624.91
4	1,846,716.480	1,157,862.909	624.94
5	1,846,716.594	1,157,866.010	624.98
6	1,846,716.950	1,157,875.903	625.10
7	1,846,711.955	1,157,876.136	(625.07)
8	1,846,712.136	1,157,881.126	(625.17)
9	1,846,717.131	1,157,880.900	625.20
10	1,846,722.127	1,157,880.719	625.10
11	1,846,721.946	1,157,875.723	625.00
12	1,846,722.468	1,157,874.218	624.95
14	1,846,726.420	1,157,880.564	625.16
15	1,846,726.789	1,157,885.554	(625.23)
16	1,846,722.239	1,157,885.719	(625.29)
17	1,846,717.305	1,157,885.897	(625.36)

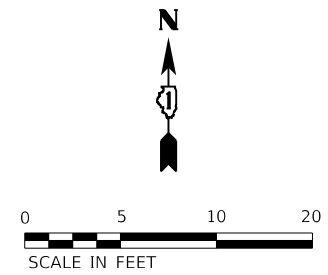

MODEL: D:\64\11... FILE NAME: P:\19-1137-07_PTB193-16_87th St_01.DOT\CAD_Sheets\162M12-sh-a04_07.dwg



USER NAME = ndp	DESIGNED - NDP	REVISED -
PLOT SCALE = 10.0000' / in.	DRAWN - NDP	REVISED -
PLOT DATE = 12/3/2020	CHECKED - PJF	REVISED -
	DATE - 12/04/2020	REVISED -

**STATE OF ILLINOIS
DEPARTMENT OF TRANSPORTATION**

**ADA RAMP IMPROVEMENT PLAN
87TH STREET & S SACRAMENTO AVE**

SCALE: 1"=5' SHEET 7 OF 11 SHEETS STA. TO STA.

F.A.P. RTE. 395	SECTION 2020-134-R5	COUNTY COOK	TOTAL SHEETS 45	SHEET NO. 22
CONTRACT NO. 62M12				
ILLINOIS FED. AID PROJECT				

87TH STREET

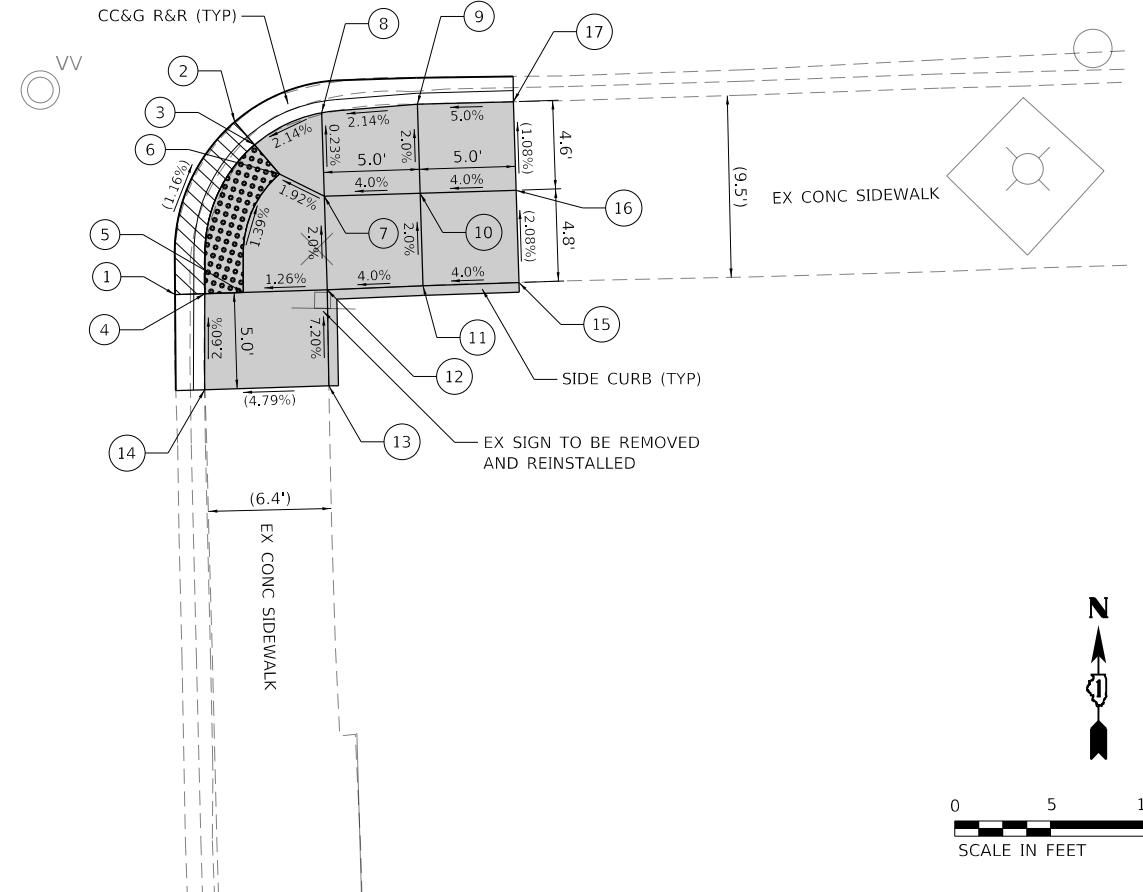
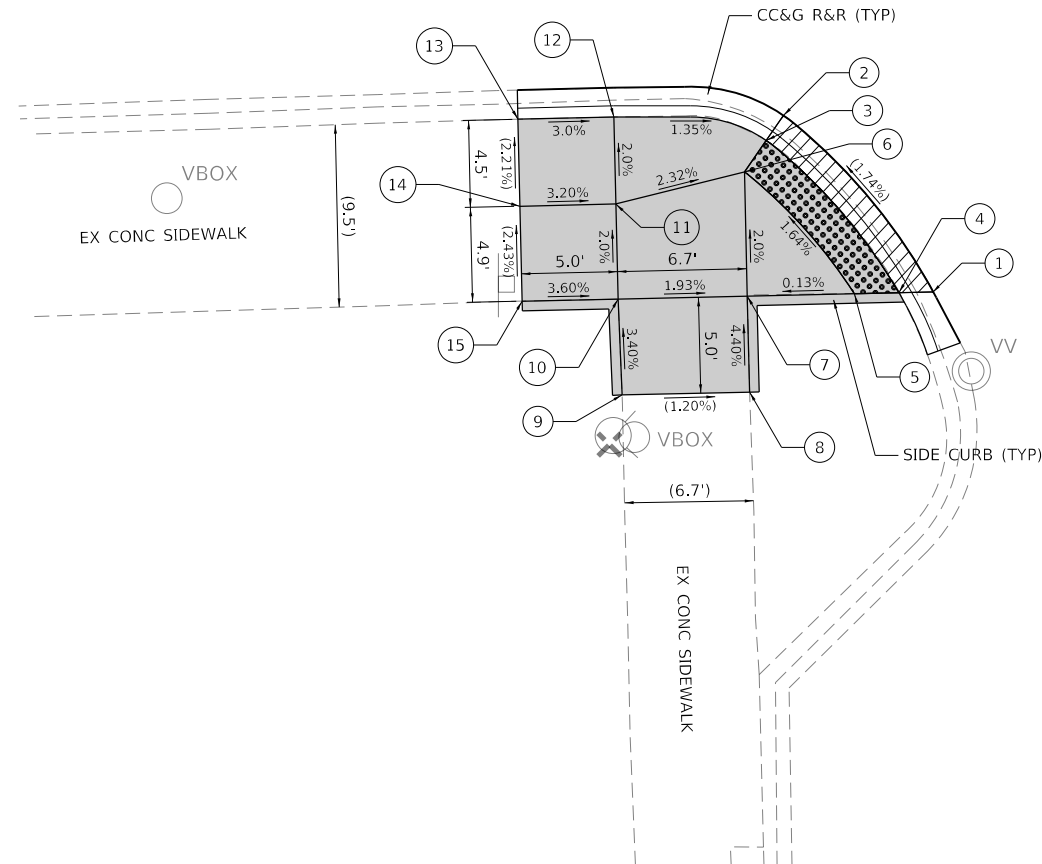

SOUTHWEST CORNER

POINT NO.	NORTHING	EASTING	ELEVATION
1	1,846,725.653	1,158,173.167	(625.36)
2	1,846,734.887	1,158,165.409	(625.15)
3	1,846,733.587	1,158,164.512	625.14
4	1,846,725.654	1,158,171.424	625.32
5	1,846,725.601	1,158,169.112	625.32
6	1,846,731.941	1,158,163.376	625.18
7	1,846,725.474	1,158,163.523	625.31
8	1,846,720.476	1,158,163.649	(625.53)
9	1,846,720.325	1,158,156.998	(625.61)
10	1,846,725.321	1,158,156.789	625.44
11	1,846,730.272	1,158,156.676	625.34
12	1,846,734.805	1,158,156.573	625.25
13	1,846,734.692	1,158,151.575	(625.40)
14	1,846,730.159	1,158,151.678	(625.50)
15	1,846,725.212	1,158,151.790	(625.62)

BENCHMARK:

SOUTHWEST BOLT ON FIRE HYDRANT LOCATED IN THE SOUTHWEST CORNER OF 87TH STREET AND S RICHMOND AVE.
ELEVATION = 626.86

LEGEND

- () EXISTING ELEVATION / LENGTH / SLOPE
- EXISTING SIDEWALK REMOVAL (REPLACED WITH TOPSOIL / SOD)
- PROPOSED SIDEWALK IMPROVEMENTS
- DETECTABLE WARNINGS
- DEPRESSED CURB & GUTTER

SOUTHEAST CORNER

POINT NO.	NORTHING	EASTING	ELEVATION
1	1,846,727.011	1,158,212.118	(625.13)
2	1,846,736.012	1,158,215.229	(625.02)
3	1,846,734.815	1,158,216.260	625.01
4	1,846,727.060	1,158,213.675	625.12
5	1,846,727.122	1,158,215.675	625.14
6	1,846,733.299	1,158,217.565	625.05
7	1,846,732.143	1,158,219.893	625.10
8	1,846,736.489	1,158,219.758	625.09
9	1,846,736.927	1,158,224.747	625.20
10	1,846,732.298	1,158,224.890	625.30
11	1,846,727.472	1,158,225.040	625.40
12	1,846,727.257	1,158,220.044	625.20
13	1,846,722.257	1,158,220.133	(625.56)
14	1,846,722.057	1,158,213.661	(625.25)
15	1,846,727.645	1,158,230.037	(625.60)
16	1,846,732.453	1,158,229.888	(625.50)
17	1,846,737.065	1,158,229.745	(625.45)

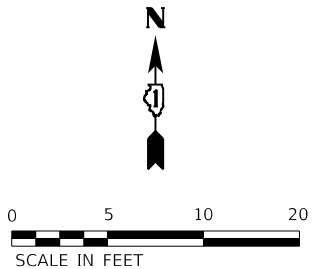

MODEL: D:\62112\87th St & S Richmond Ave\87th St & S Richmond Ave.dwg

Kaskaskia
Engineering Group, LLC
477 South Third Street
Suite 200
Geneva, Illinois 60134
630.333.8187 phone
www.kaskaskiaeng.com
Professional Engineering Group

USER NAME = ndp	DESIGNED - NDP	REVISD -
PLOT SCALE = 10.0000' / in.	DRAWN - NDP	REVISD -
PLOT DATE = 12/3/2020	CHECKED - PJF	REVISD -
	DATE - 12/04/2020	REVISD -

DESIGNED - NDP	REVISD -
DRAWN - NDP	REVISD -
CHECKED - PJF	REVISD -
DATE - 12/04/2020	REVISD -

**STATE OF ILLINOIS
DEPARTMENT OF TRANSPORTATION**

**ADA RAMP IMPROVEMENT PLAN
87TH STREET & S RICHMOND AVE**

SCALE: 1"=5' SHEET 8 OF 11 SHEETS STA. TO STA.

F.A.P. RTE. 395	SECTION 2020-134-R5	COUNTY COOK	TOTAL SHEETS 45	SHEET NO. 23
CONTRACT NO. 62M12				
ILLINOIS FED. AID PROJECT				

87TH STREET

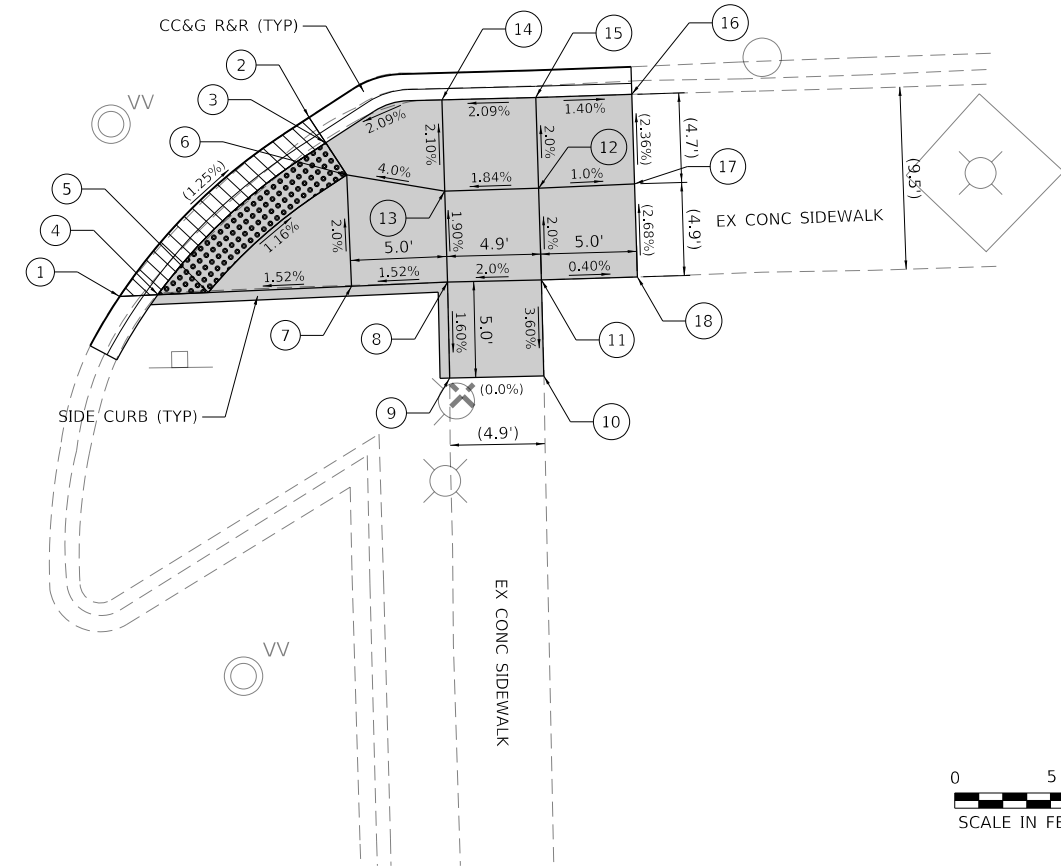
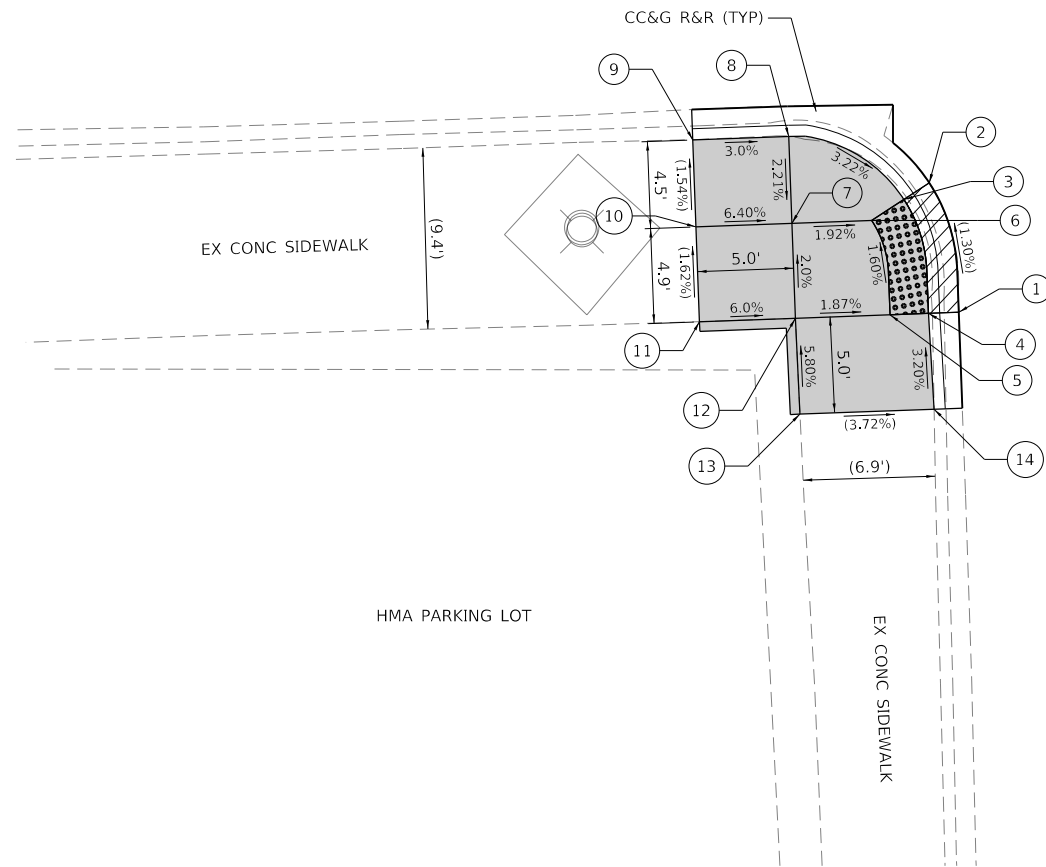

SOUTHWEST CORNER

POINT NO.	NORTHING	EASTING	ELEVATION
1	1,846,766.265	1,159,511.542	(626.62)
2	1,846,773.003	1,159,510.010	(626.53)
3	1,846,772.141	1,159,508.686	626.52
4	1,846,766.207	1,159,509.963	626.61
5	1,846,766.134	1,159,507.964	626.65
6	1,846,771.050	1,159,507.010	626.56
7	1,846,770.897	1,159,502.851	626.64
8	1,846,775.420	1,159,502.685	626.74
9	1,846,775.246	1,159,497.688	(626.89)
10	1,846,770.714	1,159,497.854	(626.96)
11	1,846,765.770	1,159,498.035	(627.04)
12	1,846,765.953	1,159,503.032	626.74
13	1,846,760.958	1,159,503.268	(627.03)
14	1,846,761.215	1,159,510.261	(626.77)

BENCHMARK:

EAST BOLT ON FIRE HYDRANT LOCATED IN THE SOUTHEAST CORNER OF 87TH STREET AND S FAIRFIELD AVE. ELEVATION = 627.99

LEGEND

- () EXISTING ELEVATION / LENGTH / SLOPE
- EXISTING SIDEWALK REMOVAL (REPLACED WITH TOPSOIL / SOD)
- PROPOSED SIDEWALK IMPROVEMENTS
- DETECTABLE WARNINGS
- DEPRESSED CURB & GUTTER

SOUTHEAST CORNER

POINT NO.	NORTHING	EASTING	ELEVATION
1	1,846,767.092	1,159,546.912	(626.70)
2	1,846,776.415	1,159,556.791	(626.53)
3	1,846,775.091	1,159,557.653	626.52
4	1,846,767.179	1,159,548.904	626.65
5	1,846,767.294	1,159,551.526	626.66
6	1,846,773.415	1,159,558.745	626.55
7	1,846,767.619	1,159,558.998	626.67
8	1,846,767.837	1,159,563.993	626.85
9	1,846,762.838	1,159,564.108	(626.77)
10	1,846,762.952	1,159,569.016	(626.77)
11	1,846,767.950	1,159,568.890	(626.95)
12	1,846,772.728	1,159,568.741	(626.83)
13	1,846,772.575	1,159,563.846	626.76
14	1,846,777.328	1,159,563.698	626.69
15	1,846,777.458	1,159,568.594	(626.71)

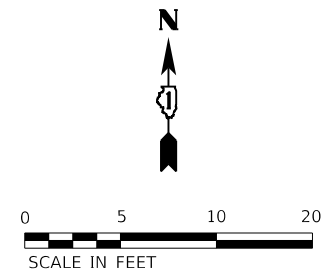

MODEL: D:\64\11... FILE NAME: P:\19-1137-07_PTB193-16_87th SW DOT\CAD_Sheets\162M12-sh-a04_10.dgn

Kaskaskia
Engineering Group, LLC
477 South Third Street
Suite 200
Geneva, Illinois 60134
630.333.8187 phone
www.kaskaskiaeng.com
PROFESSIONAL DESIGN FIRMS
Illinois Professional Design Firm
34372413
38-388536

USER NAME = ndp	DESIGNED - NDP	REVISED -
PLOT SCALE = 10.0000' / in.	DRAWN - NDP	REVISED -
PLOT DATE = 12/3/2020	CHECKED - PJF	REVISED -
	DATE - 12/04/2020	REVISED -

**STATE OF ILLINOIS
DEPARTMENT OF TRANSPORTATION**

**ADA RAMP IMPROVEMENT PLAN
87TH STREET & S FAIRFIELD AVE**

SCALE: 1"=5' SHEET 10 OF 11 SHEETS STA. TO STA.

F.A.P. RTE. 395	SECTION 2020-134-R5	COUNTY COOK	TOTAL SHEETS 45	SHEET NO. 25
CONTRACT NO. 62M12				
ILLINOIS FED. AID PROJECT				

87TH STREET

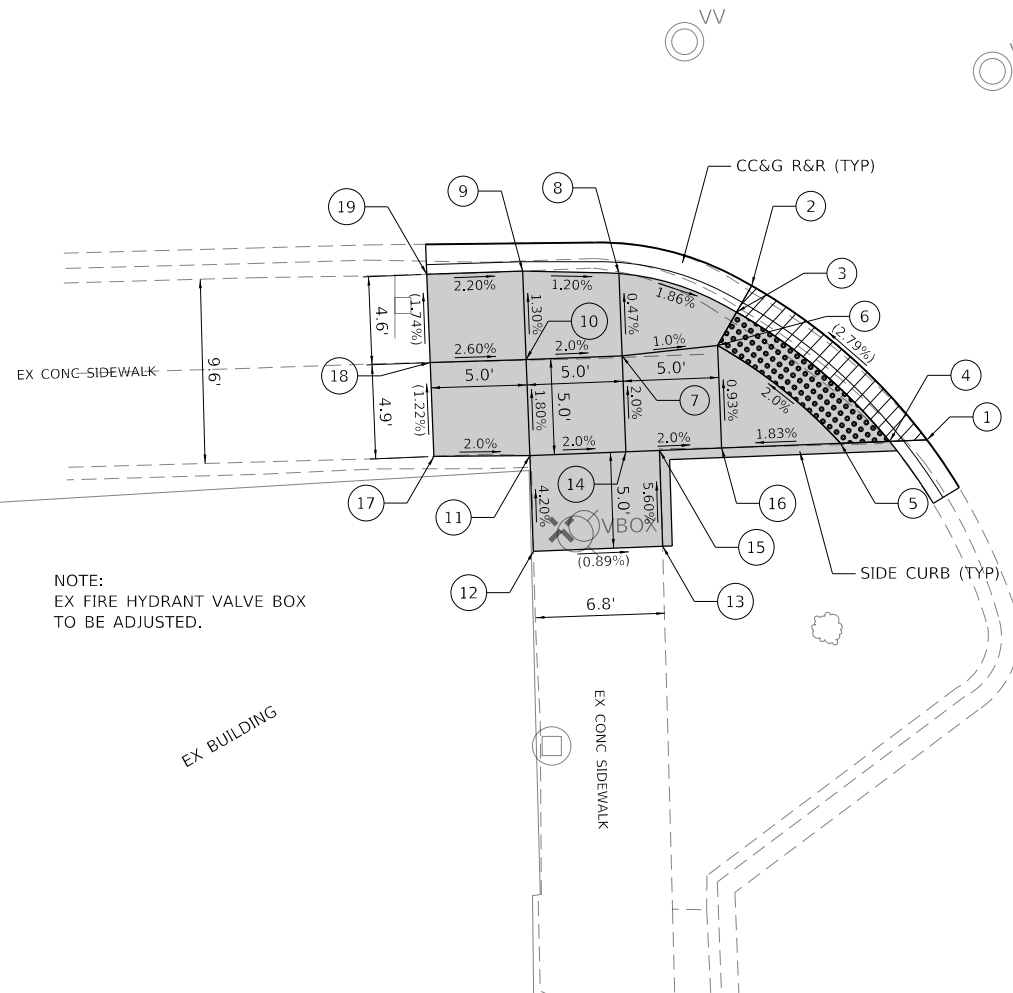

NOTE:
EX FIRE HYDRANT VALVE BOX
TO BE ADJUSTED.

SOUTHWEST CORNER

POINT NO.	NORTHING	EASTING	ELEVATION
1	1,846,776.661	1,159,852.296	(628.90)
2	1,846,784.696	1,159,843.161	(628.56)
3	1,846,783.322	1,159,842.379	628.55
4	1,846,776.585	1,159,850.349	628.85
5	1,846,776.485	1,159,847.791	628.80
6	1,846,781.584	1,159,841.391	628.64
7	1,846,781.044	1,159,836.408	628.69
8	1,846,785.332	1,159,836.240	628.67
9	1,846,785.453	1,159,831.232	628.73
10	1,846,780.848	1,159,831.412	628.79
11	1,846,775.852	1,159,831.607	628.88
12	1,846,770.855	1,159,831.790	(629.09)
13	1,846,771.119	1,159,838.526	(629.03)
14	1,846,776.047	1,159,836.603	628.79
15	1,846,776.116	1,159,838.364	628.75
16	1,846,776.243	1,159,841.599	628.69
17	1,846,775.798	1,159,826.605	(628.98)
18	1,846,780.693	1,159,826.414	(628.92)
19	1,846,785.288	1,159,826.234	(628.84)

BENCHMARK:

WEST BOLT ON FIRE HYDRANT LOCATED
IN THE SOUTHWEST CORNER OF 87TH STREET
AND WASHTENAW AVE.
ELEVATION = 630.41

LEGEND

- () EXISTING ELEVATION / LENGTH / SLOPE
- EXISTING SIDEWALK REMOVAL (REPLACED WITH TOPSOIL / SOD)
- PROPOSED SIDEWALK IMPROVEMENTS
- DETECTABLE WARNINGS
- DEPRESSED CURB & GUTTER

WASHTENAW AVE

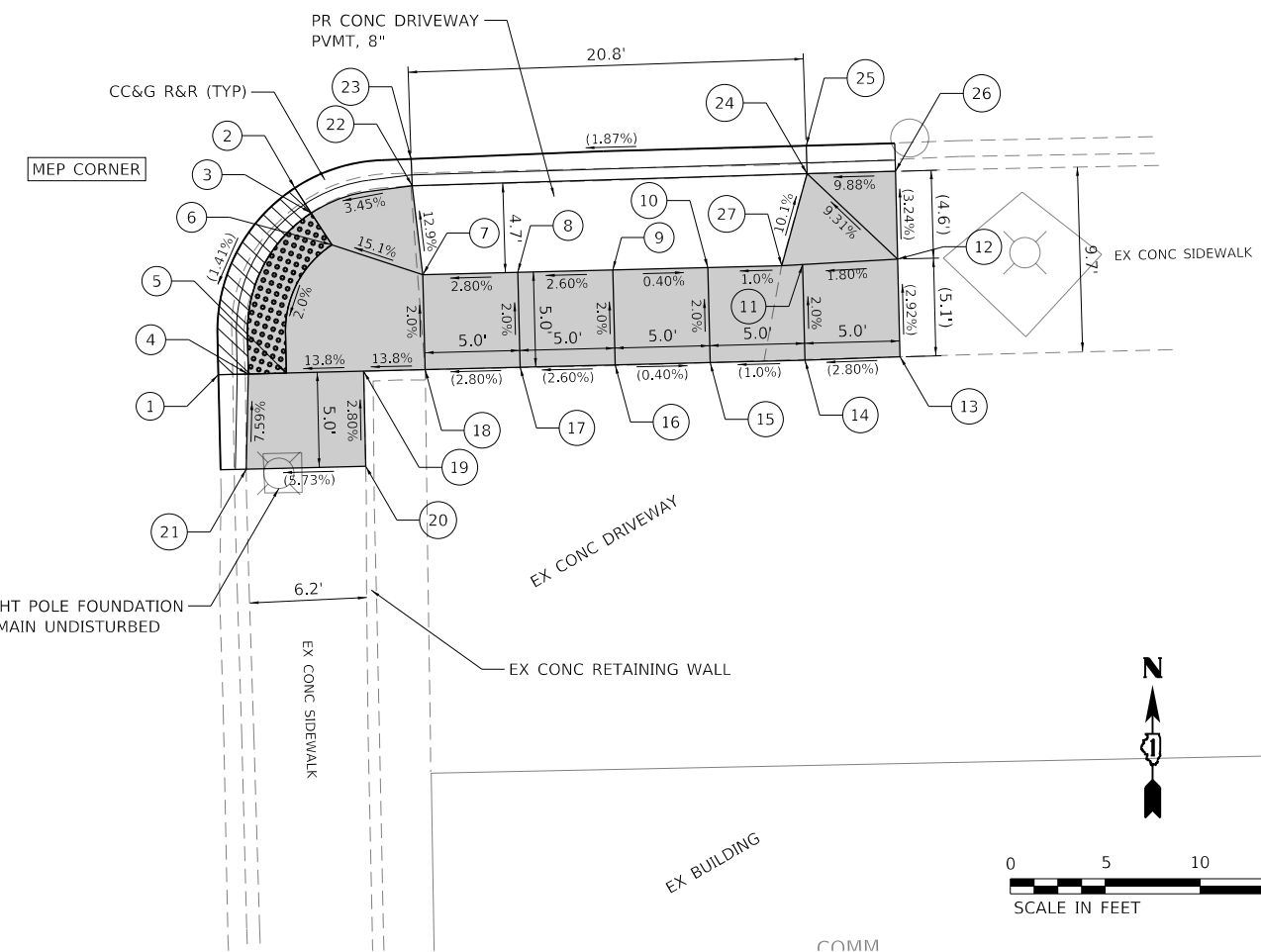

SOUTHEAST CORNER

POINT NO.	NORTHING	EASTING	ELEVATION
1	1,846,777.659	1,159,888.587	(628.79)
2	1,846,787.501	1,159,892.613	(628.94)
3	1,846,786.179	1,159,893.478	628.93
4	1,846,777.698	1,159,890.167	628.78
5	1,846,777.748	1,159,892.166	628.82
6	1,846,784.505	1,159,894.572	628.97
7	1,846,782.929	1,159,899.353	629.73
8	1,846,783.054	1,159,904.352	629.87
9	1,846,783.179	1,159,909.350	630.00
10	1,846,783.304	1,159,914.348	629.98
11	1,846,783.465	1,159,919.346	630.03
12	1,846,783.751	1,159,924.340	(630.12)
13	1,846,778.609	1,159,924.469	(630.27)
14	1,846,778.431	1,159,919.472	(630.13)

POINT NO.	NORTHING	EASTING	ELEVATION
15	1,846,778.306	1,159,914.473	(630.08)
16	1,846,778.181	1,159,909.475	(630.10)
17	1,846,778.056	1,159,904.476	(629.97)
18	1,846,777.931	1,159,899.478	(629.83)
19	1,846,777.850	1,159,896.236	629.38
20	1,846,772.851	1,159,896.343	(629.52)
21	1,846,772.694	1,159,890.059	(629.16)
22	1,846,787.609	1,159,898.794	629.12
23	1,846,789.024	1,159,898.736	(629.05)
24	1,846,788.249	1,159,919.572	629.51
25	1,846,789.725	1,159,919.532	(629.44)
26	1,846,788.375	1,159,924.225	(629.97)
27	1,846,783.401	1,159,918.236	630.02

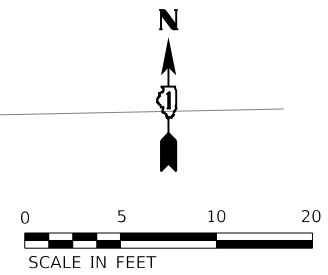

MODEL: D:\64611... FILE NAME: P:\13137.07_PTB193-16_87th SW_1DOTCAD_Sheets\162M12-2ht-ADA_11.dwg

Kaskaskia
Engineering Group, LLC
477 South Third Street
Suite 200
Geneva, Illinois 60134
630.333.8187 phone
www.kaskaskiaeng.com
ILLINOIS REGISTERED
Professional Design Firm
34-067-13
Professional Engineering Group
38-088586

USER NAME = ndp	DESIGNED - NDP	REVISED -
PLOT SCALE = 10.0000' / in.	DRAWN - NDP	REVISED -
PLOT DATE = 12/3/2020	CHECKED - PJF	REVISED -
	DATE - 12/04/2020	REVISED -

**STATE OF ILLINOIS
DEPARTMENT OF TRANSPORTATION**

**ADA RAMP IMPROVEMENT PLAN
87TH STREET & WASHTENAW AVE**

SCALE: 1"=5' SHEET 11 OF 11 SHEETS STA. TO STA.

F.A.P. R.T.E. 395	SECTION 2020-134-R5	COUNTY COOK	TOTAL SHEETS 45	SHEET NO. 26
CONTRACT NO. 62M12				
ILLINOIS FED. AID PROJECT				

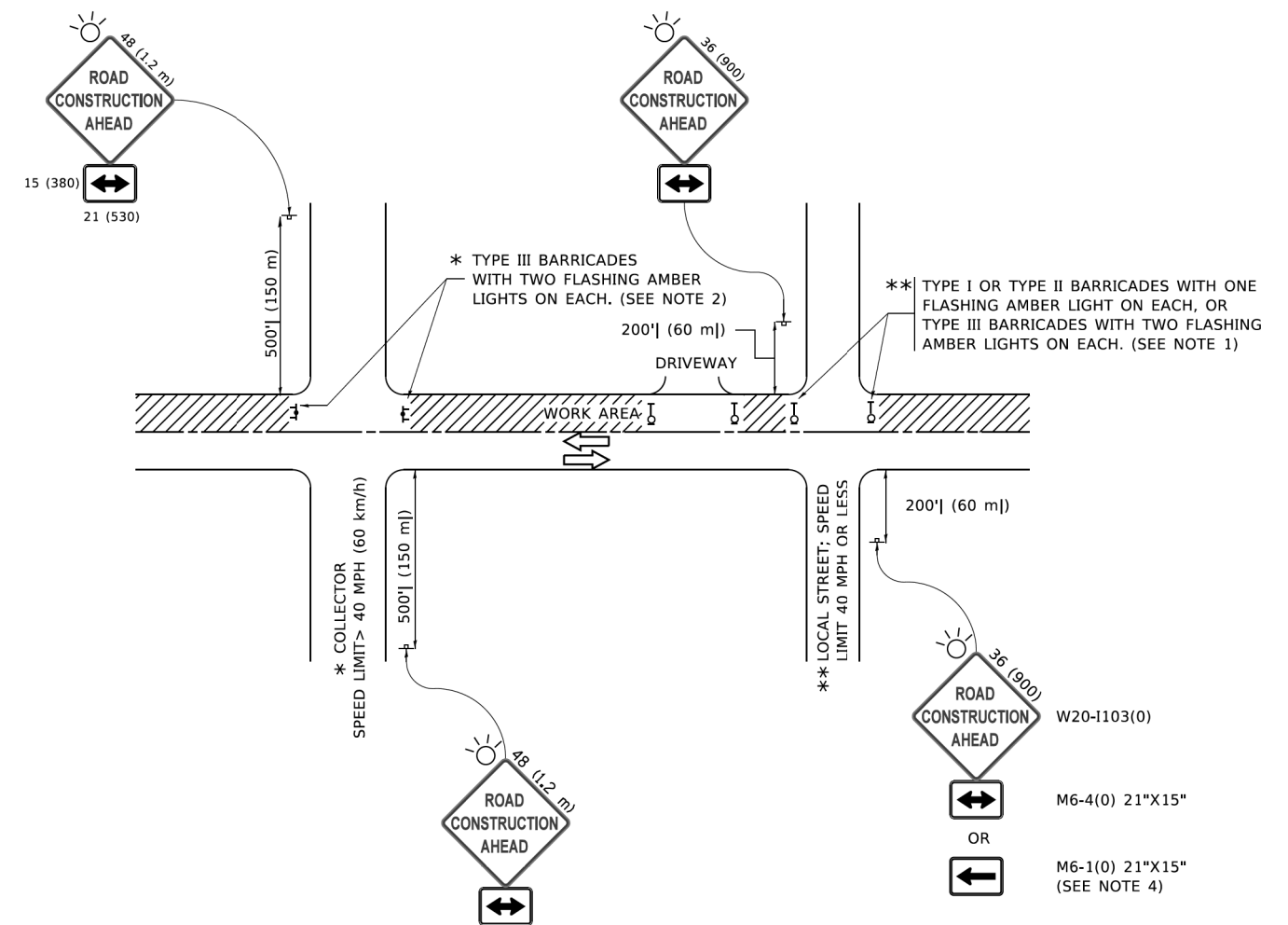

NOTES:

1. SIDE ROAD WITH A SPEED LIMIT OF 40 MPH (60 km/h) OR LESS AS SHOWN ON THE DRAWING AND AS DIRECTED BY THE ENGINEER:
 - a) ONE "ROAD CONSTRUCTION AHEAD" SIGN 36 x 36 (900x900) WITH A FLASHER MOUNTED ON IT APPROXIMATELY 200' (60 m) IN ADVANCE OF THE MAIN ROUTE.
 - b) THE CLOSED PORTION OF THE MAIN ROUTE SHALL BE PROTECTED BY BLOCKING WITH TYPE I, TYPE II OR TYPE III BARRICADES, 1/3 OF THE CROSS SECTION OF THE CLOSED PORTION.
2. SIDE ROAD WITH A SPEED LIMIT GREATER THAN 40 MPH (60 km/h) AS SHOWN ON THE DRAWING AND AS DIRECTED BY THE ENGINEER:
 - a) ONE "ROAD CONSTRUCTION AHEAD" SIGN 48 x 48 (1.2 m x 1.2 m) WITH A FLASHER MOUNTED ON IT APPROXIMATELY 500' (150 m) IN ADVANCE OF THE MAIN ROUTE.
 - b) BLOCKING WITH TYPE III BARRICADES, 1/2 OF THE CROSS SECTION OF THE CLOSED PORTION.
3. CONES MAY BE SUBSTITUTED FOR BARRICADES OR DRUMS AT HALF THE SPACING DURING DAY OPERATIONS. CONES SHALL BE A MINIMUM OF 28 (710) IN HEIGHT.
4. SIGNING AND THE WORK ZONE, A SINGLE HEADED ARROW (M6-1) SHALL BE USED IN LIEU OF THE DOUBLE HEADED ARROW (M6-4).
5. WHEN WORK IS BEING PERFORMED ON A SIDE ROAD OR DRIVEWAY, FOLLOW THE APPLICABLE STANDARD(S). THE DIRECTIONAL ARROW (M6-1 OR M6-4) SHALL BE COVERED OR REMOVED WHEN NO LONGER CONSISTENT WITH THE TRAFFIC CONTROL SET-UP.
6. ADVANCE WARNING SIGNS ARE TO BE OMITTED ON DRIVEWAYS UNLESS OTHERWISE SPECIFIED IN THE PLANS OR BY THE ENGINEER.
7. THE TRAFFIC CONTROL AND PROTECTION FOR SIDE ROADS, INTERSECTIONS, AND DRIVEWAYS SHALL BE INCLUDED IN THE COST OF SPECIFIED TRAFFIC CONTROL STANDARDS OR ITEMS.

All dimensions are in inches (millimeters) unless otherwise shown.

MODEL: Default
 FILE: \\NAME: P:\A\1808\BIDD\INTERSECTIONS\BIDD\TC\TC-10\TC-10.dgn

USER NAME = footemj	DESIGNED - L.H.A.	REVISED - A. HOUSEH 10-15-96
	DRAWN -	REVISED - T. RAMMACHER 01-06-00
PLOT SCALE = 50,0000 ' / ft.	CHECKED -	REVISED - A. SCHUETZE 07-01-13
PLOT DATE = 3/4/2019	DATE - 06-89	REVISED - A. SCHUETZE 09-15-16

**STATE OF ILLINOIS
DEPARTMENT OF TRANSPORTATION**

**TRAFFIC CONTROL AND PROTECTION FOR
SIDE ROADS, INTERSECTIONS, AND DRIVEWAYS**

SCALE: NONE SHEET 1 OF 1 SHEETS STA. TO STA.

F.A.P. RTE.	SECTION	COUNTY	TOTAL SHEETS	SHEET NO.
395	2020-134-R5	COOK	45	31
TC-10			CONTRACT NO. 62M12	
ILLINOIS FED. AID PROJECT				

ADA DETAIL FOR SINGLE PERPENDICULAR CURB RAMPS W/ TURNING SPACE

PD-04A

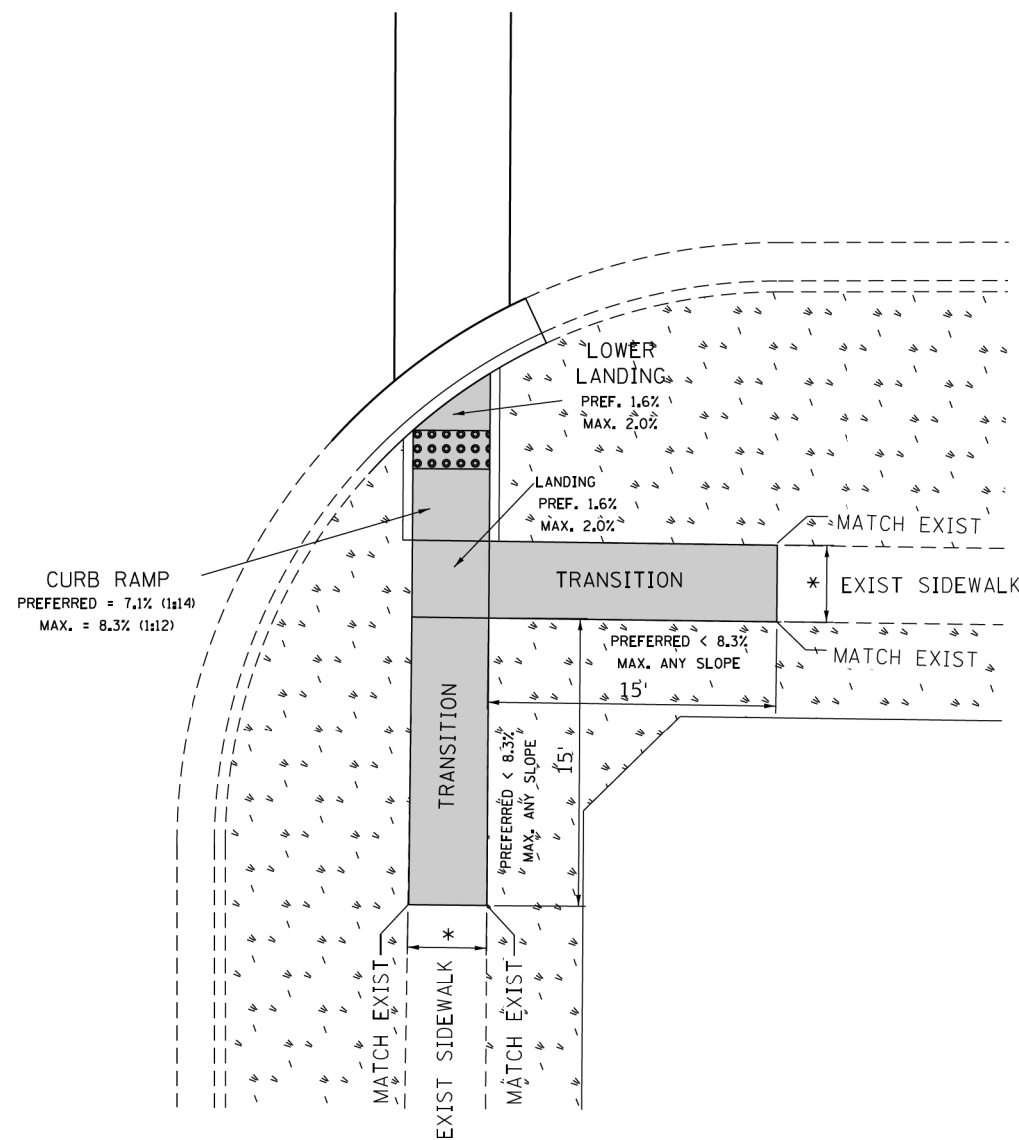

PD-04B

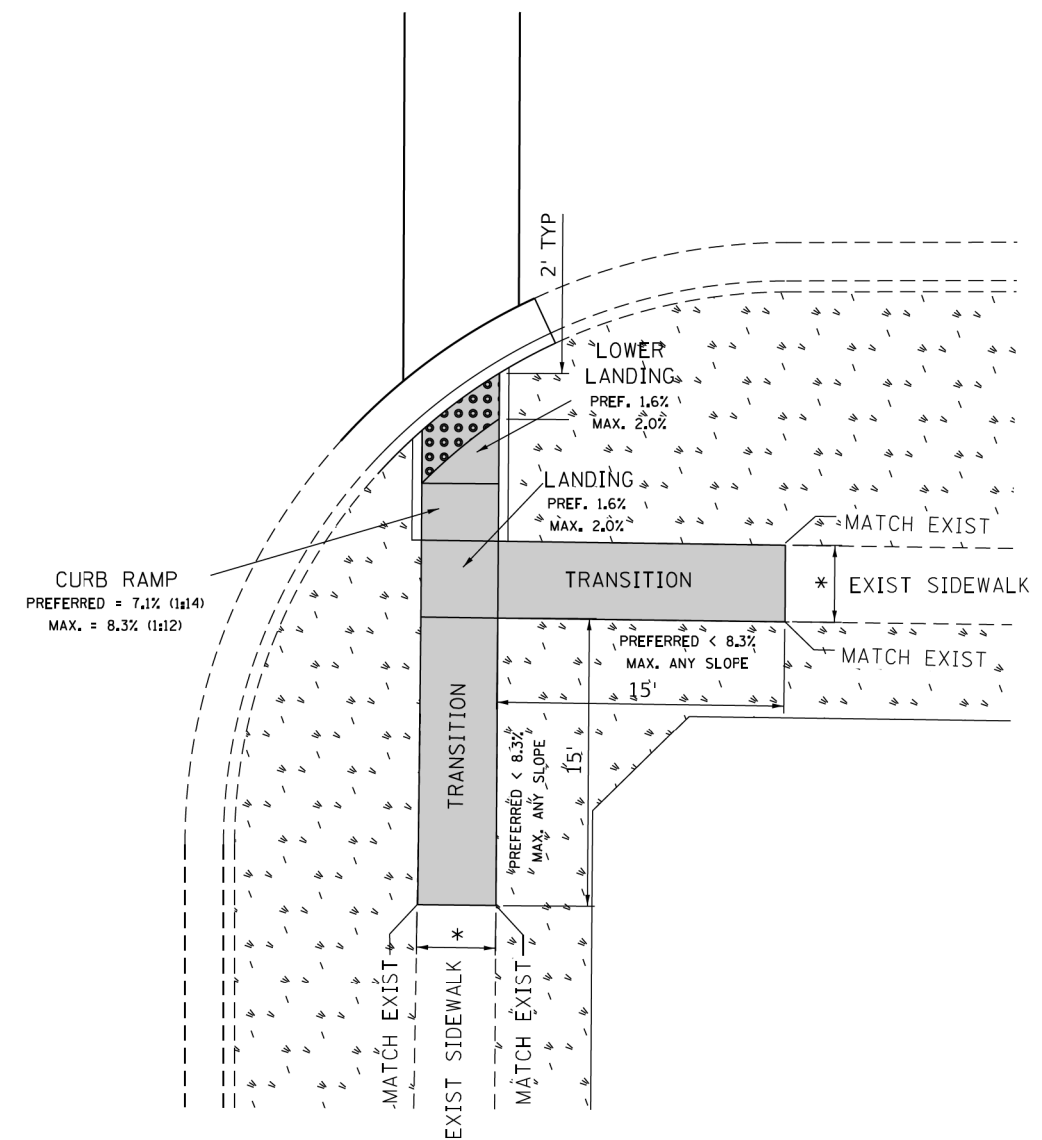

LEGEND

- PROPOSED SIDE CURB
- EXIST. GRASS
- PROPOSED SIDEWALK
- DETECTABLE WARNINGS

CONSTRUCTION NOTES:

1) ALL CROSS SLOPES ARE PREFERRED 1.6% (1:64), MAXIMUM 2% (1:50) EXCEPT WHEN TRANSITIONING TO EXISTING SIDEWALK

* MATCH EXISTING SIDEWALK WIDTH

MODEL: D:\64\11... FILE NAME: RL\91137\07_PTB193-16_87th_S&D\DOT\CAD_Sheets\1621M12-shd-d1-detail_PD-04.dgn

FILE NAME =	USER NAME = ledeznorm	DESIGNED -	REVISED -
Default		DRAWN - RL 11/12/2019	REVISED -
		CHECKED -	REVISED -
		DATE -	REVISED -

**STATE OF ILLINOIS
DEPARTMENT OF TRANSPORTATION**

**PROJECT DETAIL FOR SINGLE PERPENDICULAR CURB RAMPS
W/TURNING SPACE (PD-04)**

SCALE: SHEET OF SHEETS STA. TO STA.

F.A.P. RTE.	SECTION	COUNTY	TOTAL SHEETS	SHEET NO.
395	2020-134-R5	COOK	45	43
PD-04			CONTRACT NO. 62M12	
ILLINOIS FED. AID PROJECT				

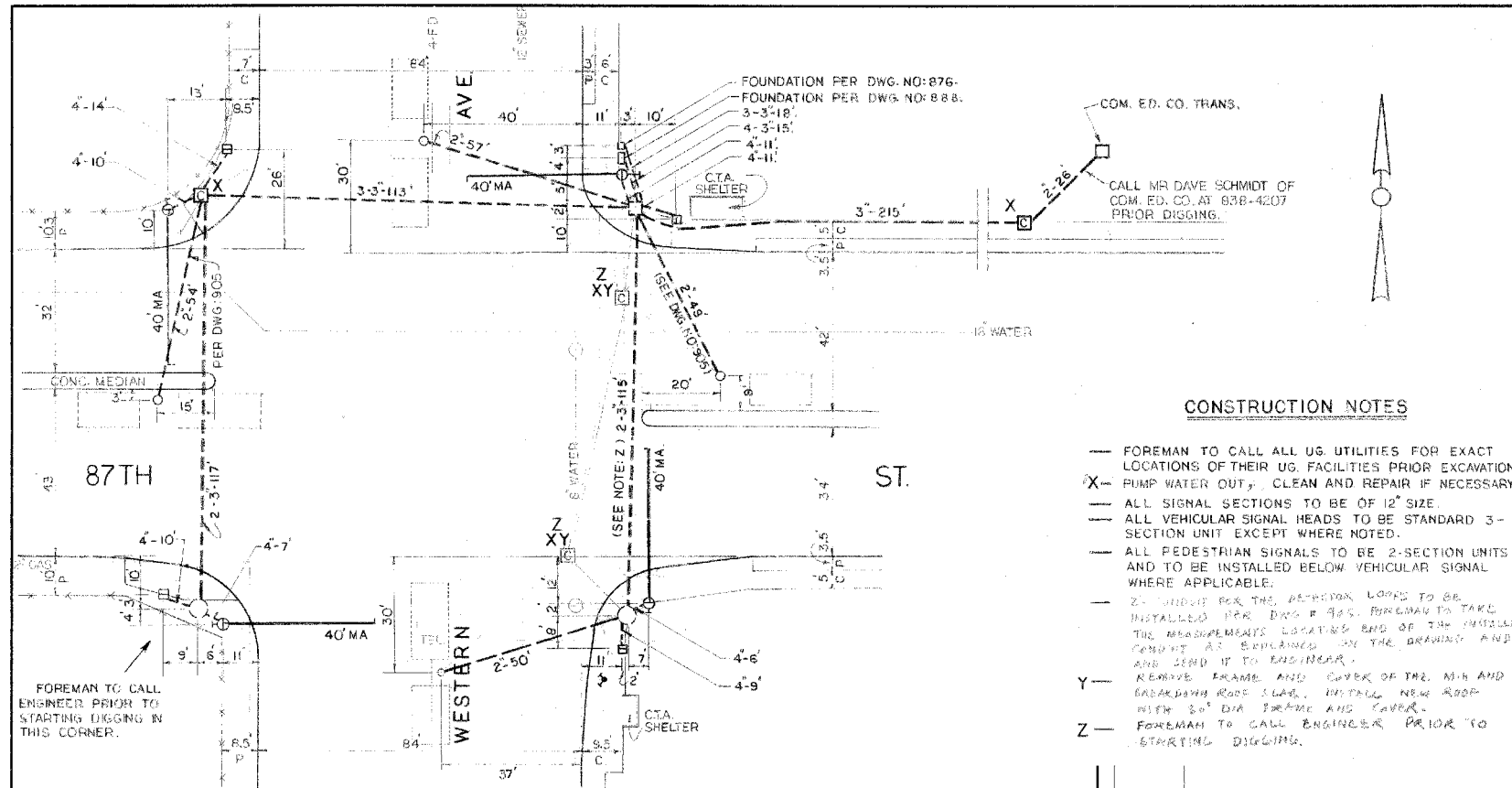

CONSTRUCTION NOTES

- FOREMAN TO CALL ALL UG UTILITIES FOR EXACT LOCATIONS OF THEIR UG FACILITIES PRIOR EXCAVATION. PUMP WATER OUT, CLEAN AND REPAIR IF NECESSARY.
- X — ALL SIGNAL SECTIONS TO BE OF 12" SIZE.
- ALL VEHICULAR SIGNAL HEADS TO BE STANDARD 3-SECTION UNIT EXCEPT WHERE NOTED.
- ALL PEDESTRIAN SIGNALS TO BE 2-SECTION UNITS AND TO BE INSTALLED BELOW VEHICULAR SIGNAL WHERE APPLICABLE.
- Z — 2" UNITS PER THE DETENTION LOOKS TO BE INSTALLED PER DWG # 945. FOREMAN TO TAKE THE MEASUREMENT LOCATED END OF THE UNITS AND REPORT AS EXPLAINED IN THE DRAWING AND SEND IT TO ENGINEER.
- Y — REMOVE FRAME AND CURB OF THE N.H. AND REBAR/RRR ROAD SLAB. INSTALL NEW ROOF WITH 30" DIA FRAME AND COVER.
- Z — FOREMAN TO CALL ENGINEER PRIOR TO STARTING DIGGING.

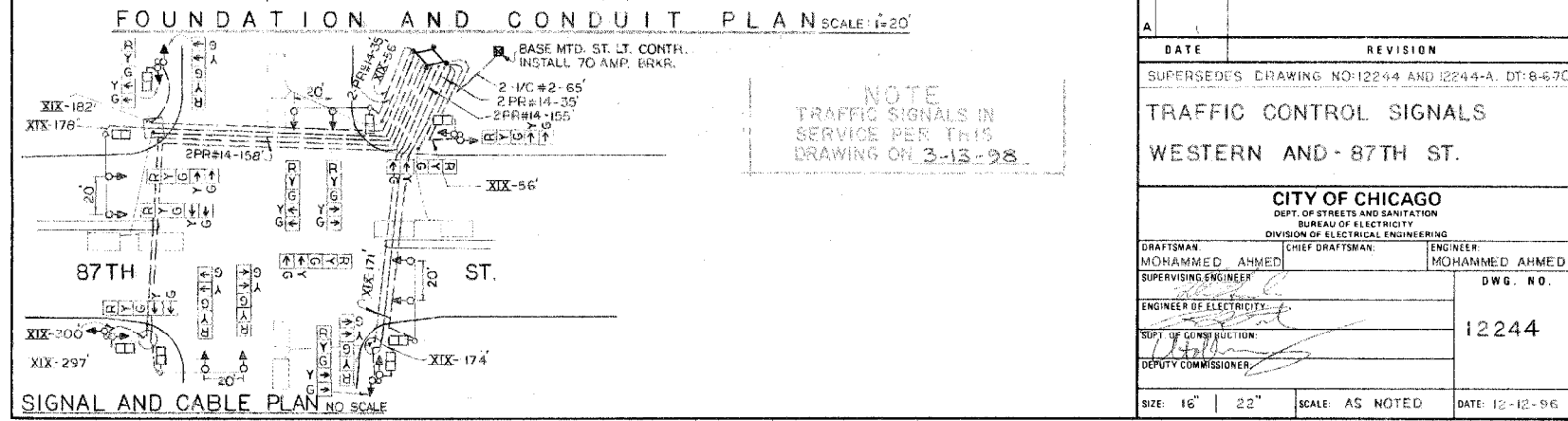

DATE	REVISION
	SUPERSEDES DRAWING NO-12244 AND 12244-A. DT: 6-670

**TRAFFIC CONTROL SIGNALS
WESTERN AND - 87TH ST.**

CITY OF CHICAGO
DEPT. OF STREETS AND SANITATION
BUREAU OF ELECTRICITY
DIVISION OF ELECTRICAL ENGINEERING

DRAFTSMAN: MOHAMMED AHMED	ENGINEER: MOHAMMED AHMED
SUPERVISING ENGINEER:	DWG. NO. 12244
ENGINEER OF ELECTRICITY:	
SUPT. OF CONSTRUCTION:	
DEPUTY COMMISSIONER:	

SIZE: 16" | 22" SCALE: AS NOTED DATE: 12-12-96

APPROVED AS WORKING PLAN BY	FEDERAL-AID ROUTE NO.	SECTION
REVISIONS OF WORKING PLAN	FHWA REG. NO.	ILLINOIS PROJECT

ADJUSTMENT OF STREET LIGHTING EQUIPMENT

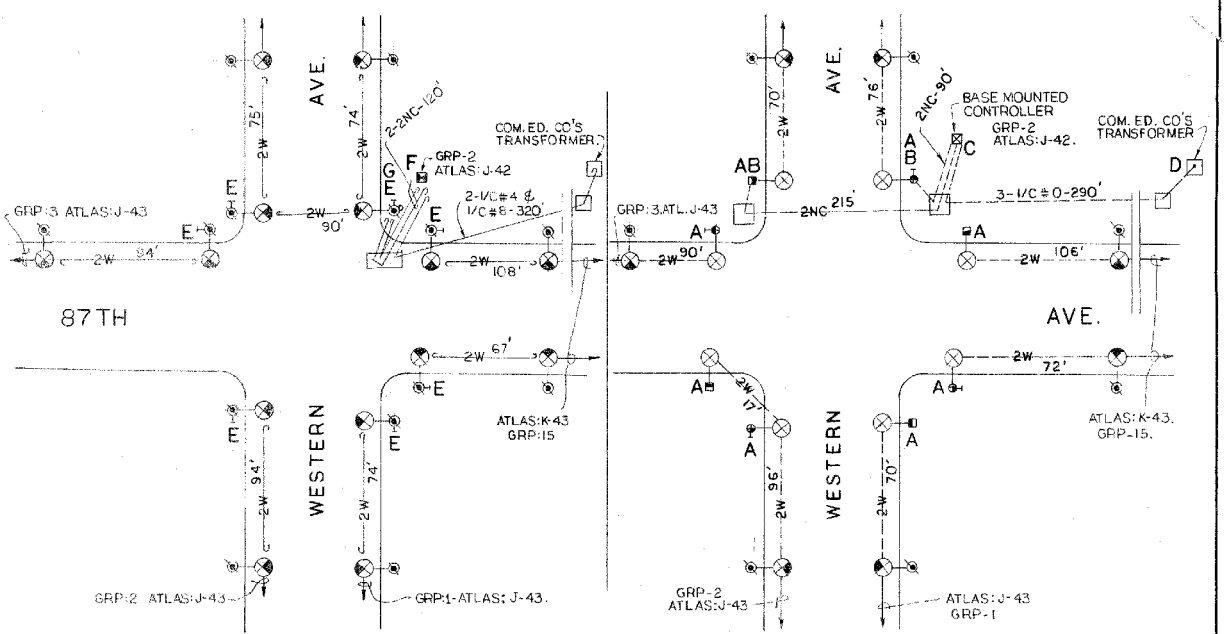

- REMOVAL PLAN NO SCALE**
- E — REMOVE 310W H.P.S.V. LUMINAIRE, 12 MA. 2-W RACK AND EMBEDDED POLE.
 - F — REMOVE ST. LT. CONTROLLER, POST AND BREAKDOWN FOUNDATION.
 - G — REMOVE LATERAL UP POLE.

- INSTALLATION PLAN NO SCALE**
- A — INSTALL 15' MA, 310W H.P.S.V. LUM. AND 2-W RACK.
 - B — INSTALL 1 1/4" ENTRANCE HEAD ON POLE TOP.
 - C — INSTALL BASE MOUNTED STREET LIGHT CONTROLLER.
 - D — FOR SERVICE CONNECTION CALL MR. DAVE SCHMIDT AT PHONE NO: 838-4207.

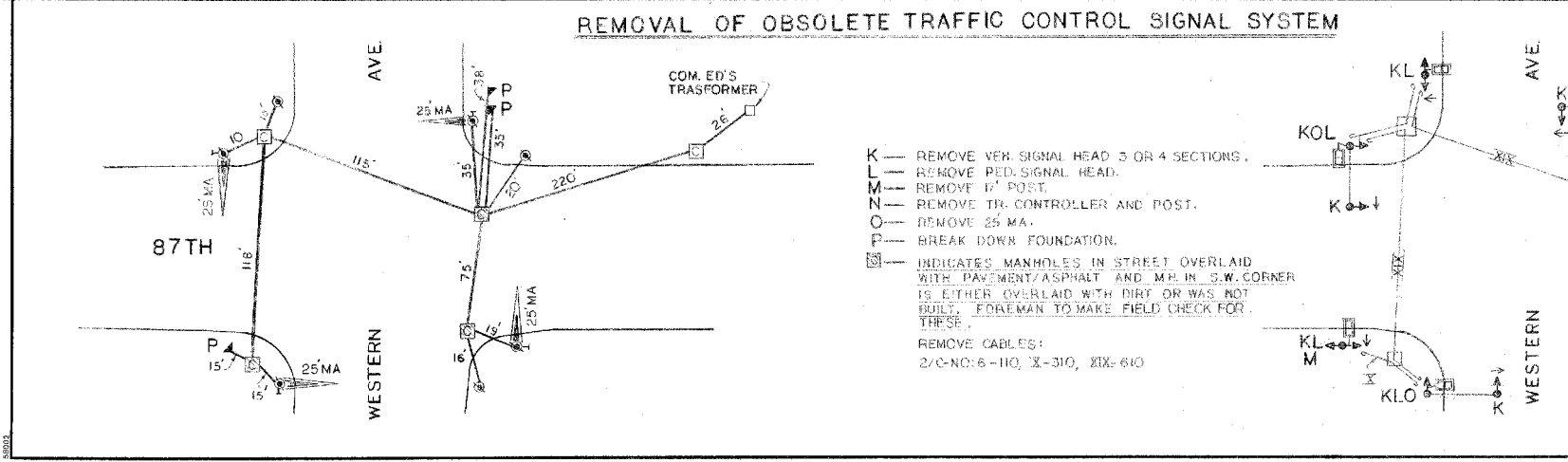

- K — REMOVE VEH. SIGNAL HEAD 3 OR 4 SECTIONS.
 - L — REMOVE PED. SIGNAL HEAD.
 - M — REMOVE 17' POST.
 - N — REMOVE TR. CONTROLLER AND POST.
 - O — REMOVE 25 MA.
 - P — BREAK DOWN FOUNDATION.
 - INDICATES MANHOLES IN STREET OVERLAID WITH PAVEMENT/ASPHALT AND M.H. IN S.W. CORNER IS EITHER OVERLAID WITH DIRT OR WAS NOT BUILT. FOREMAN TO MAKE FIELD CHECK FOR THESE.
- REMOVE CABLES:
2/C-NO:6-HQ, X-310, XIX-610

DATE	REVISION

WORK ORDER NO. 1613032 DATE _____
COST ALLOCATION ACCOUNT _____
APPROPRIATION ACCOUNT { MATERIAL _____
LABOR _____

**TRAFFIC CONTROL SIGNALS
WESTERN AVE - 87TH ST**

CITY OF CHICAGO
DEPT. OF STREETS AND SANITATION
BUREAU OF ELECTRICITY
DIVISION OF ELECTRICAL ENGINEERING

DRAFTSMAN: MOHAMMED AHMED	ENGINEER: MOHAMMED AHMED
SUPERVISING ENGINEER:	DWG. NO. 12244
ENGINEER OF ELECTRICITY:	
SUPT. OF CONSTRUCTION:	
DEPUTY COMMISSIONER:	

SIZE: 22" | 36" SCALE: AS NOTED DATE: 12-12-96

MODEL: Dwg-111; FILE NAME: P:\91137.07_PTB193-16_87th St. DOT\CAD_Sheets\162412-28-D1\recll_0x1.dgn

Kaskaskia
Engineering Group, LLC
47 South Third Street
Suite 200
Geneva, Illinois 60134
630.333.8107 phone
www.kaskaskiaeng.com

USER NAME = ndp	DESIGNED - NDP	REVISED -
PLOT SCALE = 2,000' / in.	DRAWN - NDP	REVISED -
PLOT DATE = 12/3/2020	CHECKED - PJF	REVISED -
	DATE - 12/04/2020	REVISED -

**STATE OF ILLINOIS
DEPARTMENT OF TRANSPORTATION**

**EXISTING TRAFFIC CONTROL SIGNALS - 87TH STREET AT WESTERN AVE
FOR REFERENCE ONLY**

SCALE: SHEET OF SHEETS STA. TO STA.

F.A.P. RTE. 395	SECTION 2020-134-R5	COUNTY COOK	TOTAL SHEETS 45	SHEET NO. 44
ILLINOIS FED. AID PROJECT				

CONTRACT NO. 62M12

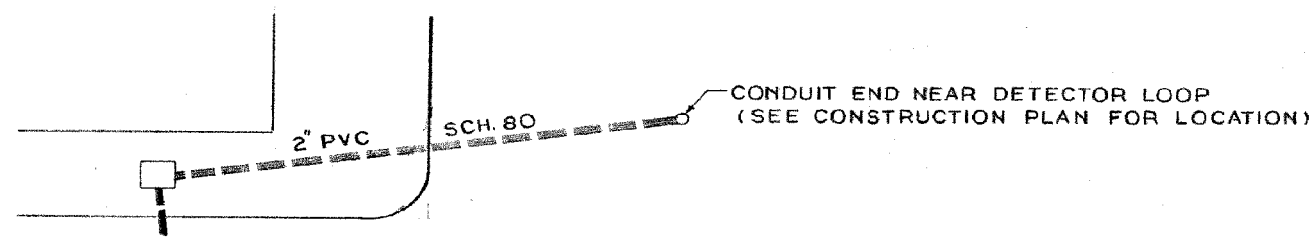

TYPICAL LAYOUT OF CONDUIT LEAD UP TO NEAR VEHICLE DETECTOR LOOPS

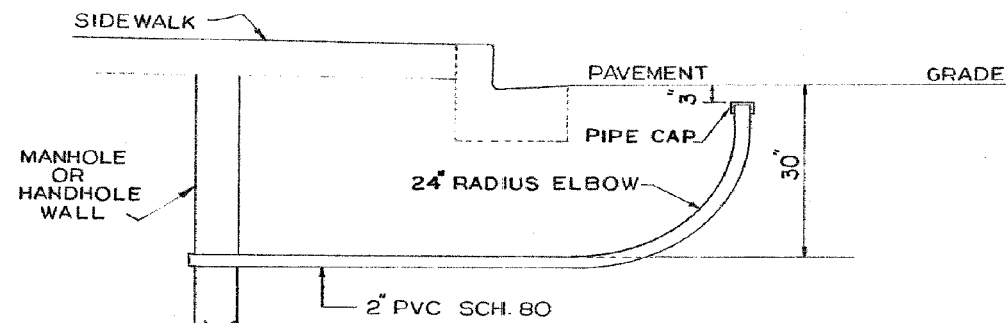

TYPICAL SECTION ALONG CONDUIT LEAD UP TO NEAR VEHICLE DETECTOR LOOPS

THE CONDUIT INSTALLATION NOTES

- INSTALL 2" PVC (SCH. 80) CONDUIT 30" BELOW GRADE FROM MH/HH TO NEAR THE LOCATION OF END OF THE CONDUIT LEAD AS SHOWN ON PLAN.
- INSTALL (24" RADIUS) ELBOW AT END OF THE CONDUIT AS SHOWN, KEEP END OF THE ELBOW ABOUT 3" BELOW GRADE AND INSTALL PIPE CAP ON IT.
- FOREMAN TO TAKE EXACT MEASUREMENTS FROM CENTER OF THE PIPE CAP TO THREE REFERENCE POINTS (LIKE - CORNER OF BUILDING, CENTER OF FIRE HYDRANT, CENTER OF MANHOLE COVER ETC.) AS ILLUSTRATED BELOW OR CALL ENGINEER.

ILLUSTRATION OF TAKING MEASUREMENTS LOCATING THE CONDUIT END

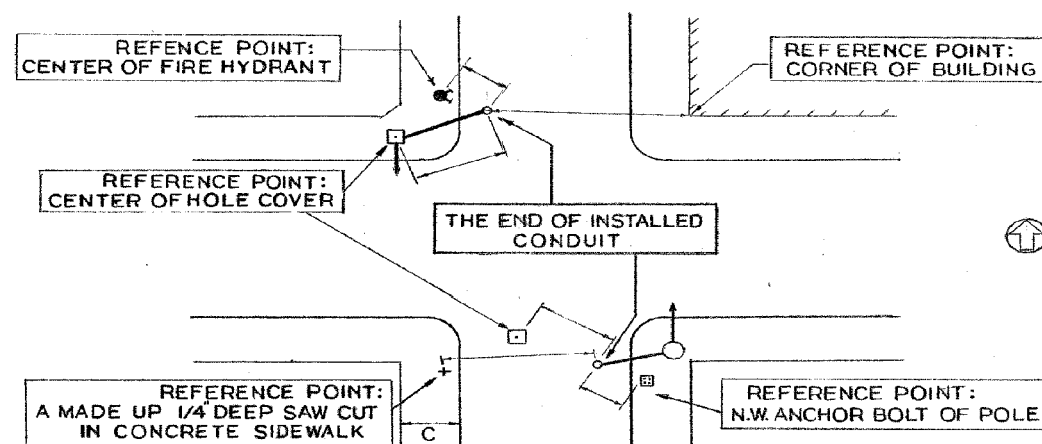

THE END OF CONDUIT WILL BE 3" BELOW PAVEMENT SURFACE. THEREFORE TO ACCURATELY LOCATE THE HIDDEN END OF CONDUIT...

- PRIOR COVERING UP THE CAP OF CONDUIT END, SELECT THREE REFERENCE POINTS IN DIFFERENT DIRECTIONS AROUND THE CONDUIT END.
- MEASURE EXACT DISTANCES BETWEEN CENTER OF THE CONDUIT END AND THE REFERENCE POINTS.
- SUBMIT A SKETCH SHOWING THE MEASUREMENTS TO OFFICE FOR RECORD.

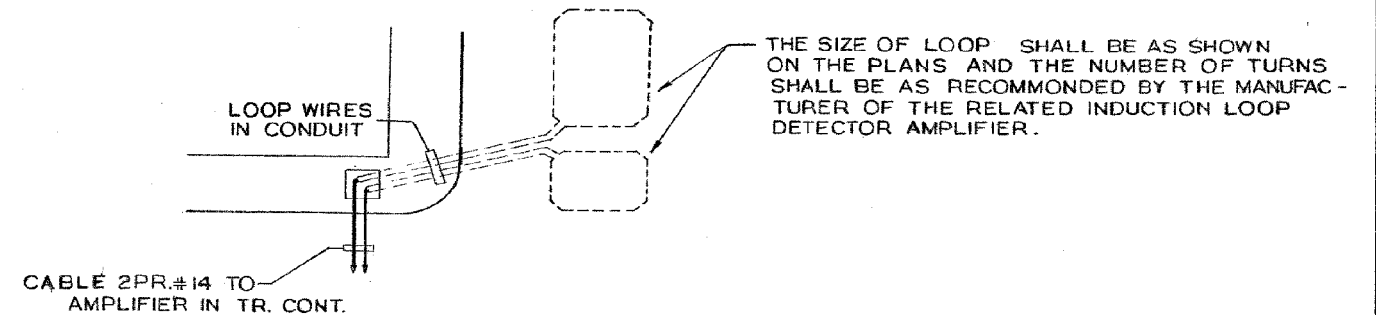

LOOP WIRE INSTALLATION NOTES

- THE SAW CUT (1/4" WIDE) SHALL BE CONTINUOUS FROM EDGE OF THE DETECTOR LOOP TO AND THROUGH ONE SIDE OF THE PVC ELBOW.
- AFTER THE LOOP WIRE AND RETAINERS ARE INSTALLED THE SAW CUT THROUGH THE SIDE OF THE PIPE ELBOW BE PLUGGED WITH A PLIABLE PUTTY TO PREVENT THE ENTRANCE OF THE LIQUID EPOXY LOOP SEALER.
- THE LOOP WIRE TO BE SPLICED TO SHEILDLED LEAD CABLE IN H.H. OR M.H. IN ACCORDANCE WITH PROCEDURE EXPLAINED IN SPECIAL PROVISION FOR DETECTOR LOOP'S CONSTRUCTION SPECIFICATIONS.

DATE		REVISION	
INSTALLATION OF 2" PVC CONDUIT UP TO THE VEHICLE DETECTOR LOOP			
CITY OF CHICAGO DEPT. OF STREETS AND SANITATION BUREAU OF ELECTRICITY DIVISION OF ELECTRICAL ENGINEERING			
DRAFTSMAN: MOHAMMED AHMED	CHIEF DRAFTSMAN:	ENGINEER: MOHAMMED AHMED	DWG. NO. 905
SUPERVISING ENGINEER:			DATE: 2 29 96
ENGINEER OF ELECTRICITY:			
SUPT. OF CONSTRUCTION:			
DEPUTY COMMISSIONER:			
SIZE: 16" 22"	SCALE: NONE		

MODEL: Dwg.dwg
 FILE NAME: P:\9-1137-07_PTB193-16_87th SW_IDOT\CAD_Sheets\162M12-CH-D1\Detail_905.dwg
 59002
 CENTURY BLUEPRINT 1000H

Kaskaskia
Engineering Group, LLC
477 South Third Street
Suite 200
Geneva, Illinois 60134
630.333.8107 phone
www.kaskaskiaeng.com
ILLINOIS
Professional Engineering Firm
38-088586

USER NAME = ndp	DESIGNED - NDP	REVISED -
PLOT SCALE = 2,000' / in.	DRAWN - NDP	REVISED -
PLOT DATE = 12/3/2020	CHECKED - PJF	REVISED -
	DATE - 12/04/2020	REVISED -

STATE OF ILLINOIS
DEPARTMENT OF TRANSPORTATION

EXISTING VEHICLE DETECTOR LOOP DETAIL 905
FOR REFERENCE ONLY

SCALE: SHEET OF SHEETS STA. TO STA.

F.A.P. RTE.	SECTION	COUNTY	TOTAL SHEETS	SHEET NO.
395	2020-134-R5	COOK	45	45
CONTRACT NO. 62M12				
ILLINOIS FED. AID PROJECT				