

STATE OF ILLINOIS
DEPARTMENT OF TRANSPORTATION

F.A. RTE.	SECTION	COUNTY	TOTAL SHEETS	SHEET NO.
VAR.	FY21 BRIDGE DECK SEALING	VARIOUS	22	1
		ILLINOIS	CONTRACT NO. 70E78	

FOR INDEX OF SHEETS, SEE SHEET NO. 2

PROPOSED
HIGHWAY PLANS

VARIOUS ROUTES
SECTION FY2021 BRIDGE DECK SEALING
PROJECT STP - WMAV(478)
BRIDGE PRESERVATION
DEWITT, PIATT & MCLEAN COUNTIES

C-95-101-20

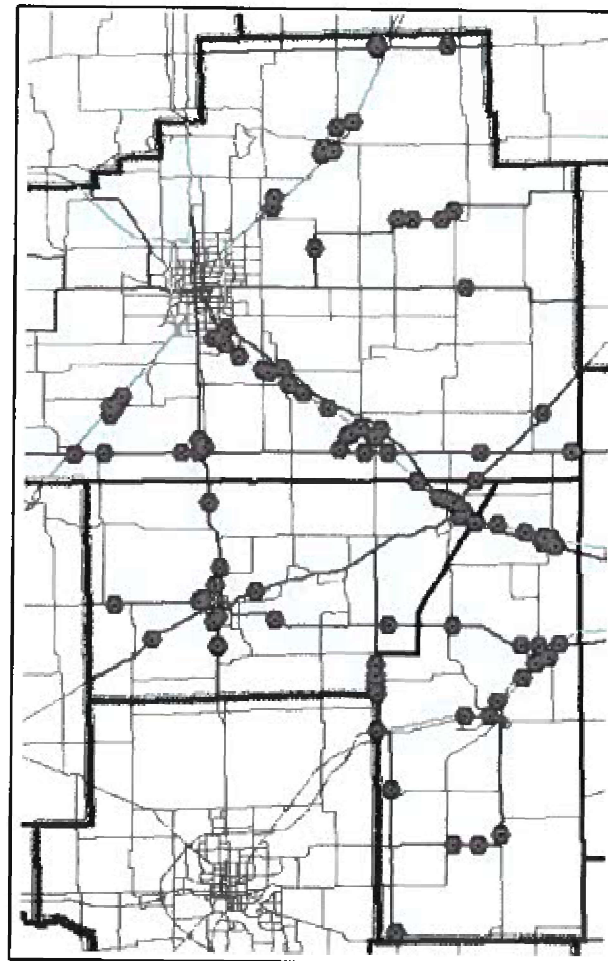
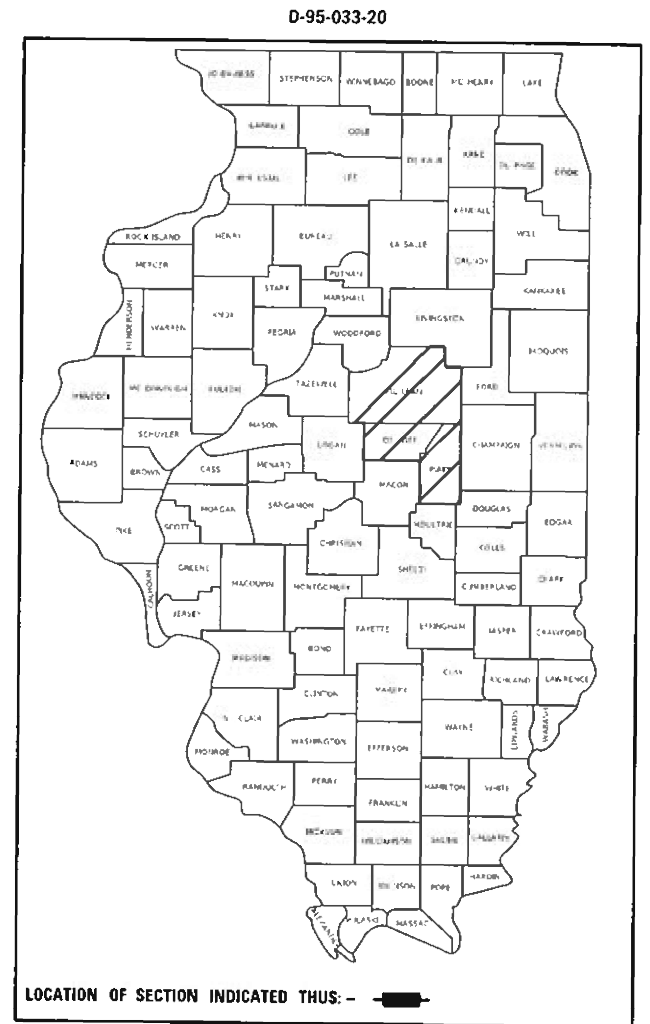

GROSS LENGTH = x.xx FT. = x.xxx MILE
NET LENGTH = x.xx FT. = x.xxx MILE

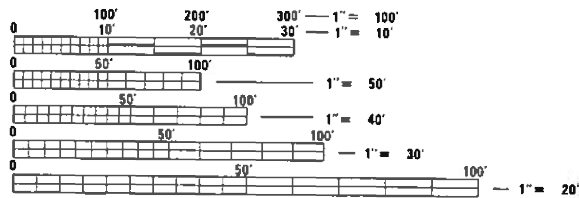

FULL SIZE PLANS HAVE BEEN PREPARED USING STANDARD ENGINEERING SCALES. REDUCED SIZED PLANS WILL NOT CONFORM TO STANDARD SCALES. IN MAKING MEASUREMENTS ON REDUCED PLANS, THE ABOVE SCALES MAY BE USED.

J.U.L.I.E.
JOINT UTILITY LOCATION INFORMATION FOR EXCAVATION
1-800-892-0123
OR 811

PROJECT ENGINEER: TIM BRANDENBURG (217) 465-4181
PROJECT MANAGER:

CONTRACT NO. 70E78

STATE OF ILLINOIS
DEPARTMENT OF TRANSPORTATION

SUBMITTED November 7, 2020
[Signature] REGIONAL ENGINEER

January 29, 2021
[Signature] ENGINEER OF DESIGN AND ENVIRONMENT

January 29, 2021
[Signature] DIRECTOR OF HIGHWAYS PROJECT IMPLEMENTATION

PRINTED BY THE AUTHORITY
OF THE STATE OF ILLINOIS

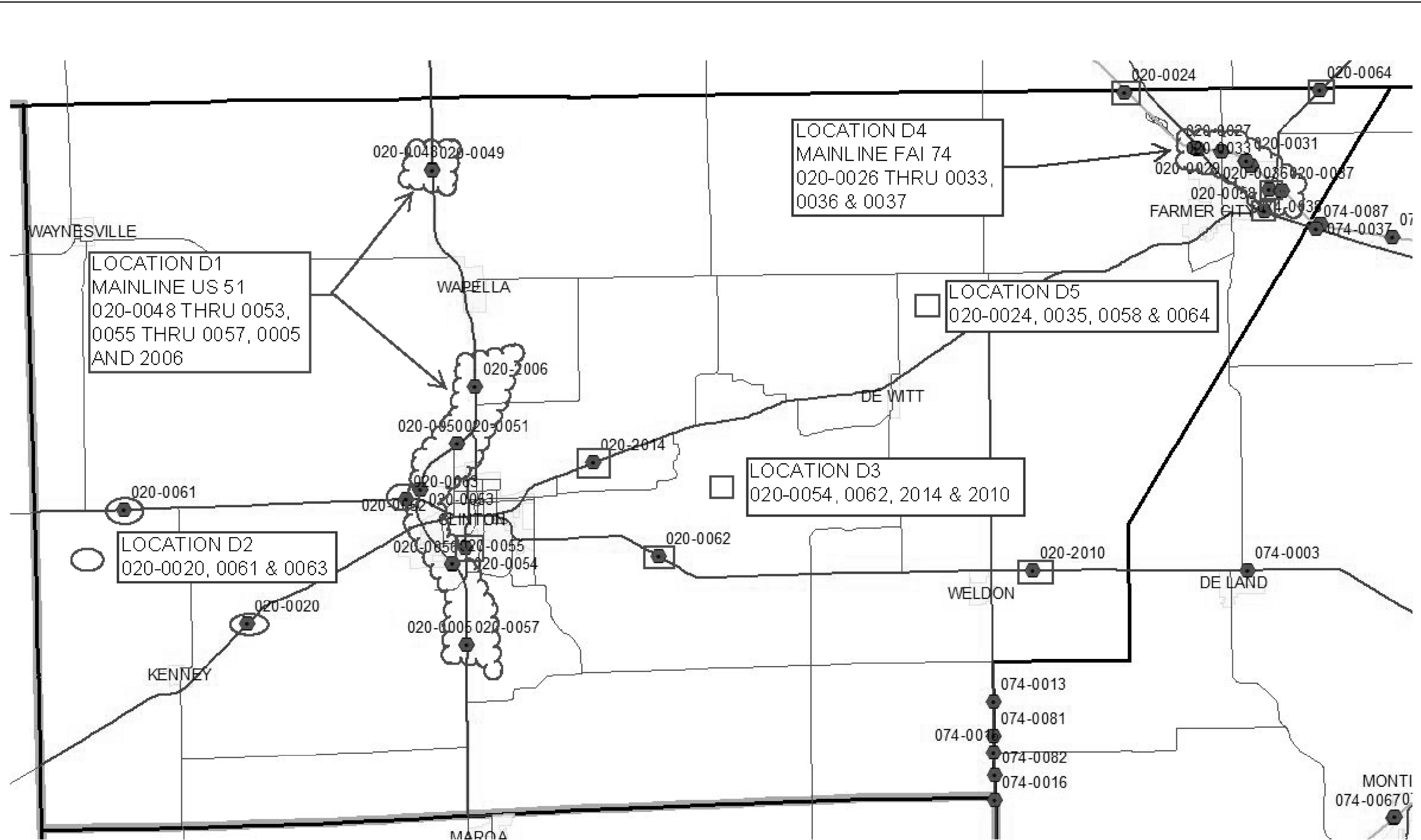

LOCATION D1
 MAINLINE US 51
 020-0048 THRU 0053,
 0055 THRU 0057, 0005
 AND 2006

LOCATION D4
 MAINLINE FAI 74
 020-0026 THRU 0033,
 0036 & 0037

LOCATION D5
 020-0024, 0035, 0058 & 0064

LOCATION D3
 020-0054, 0062, 2014 & 2010

LOCATION D2
 020-0020, 0061 & 0063

MODEL: \\MODEL\NAME
 FILE NAME: \\PUB\GIS\DATA\ILLINOIS\DOT\Documents\DOT_Offices\DeWitt\3\Projects\05707878\CADD\DATA\Hydraulics\05707878-hydraulics.dwg

USER NAME = brandenburgj	DESIGNED - TJB	REVISED -
DRAWN -	REVISED -	
PLOT SCALE = 40,0000' / in.	CHECKED -	REVISED -
PLOT DATE = 10/21/2020	DATE - 5/4/2020	REVISED -

**STATE OF ILLINOIS
 DEPARTMENT OF TRANSPORTATION**

DEWITT COUNTY LOCATION MAP

SCALE: _____ SHEET 1 OF 5 SHEETS STA. _____ TO STA. _____

F.A. RTE.	SECTION	COUNTY	TOTAL SHEETS	SHEET NO.
VAR.	FY21 BRIDGE DECK SEALING	VARIOUS	22	3
			CONTRACT NO. 70E78	
		ILLINOIS	FED. AID PROJECT	

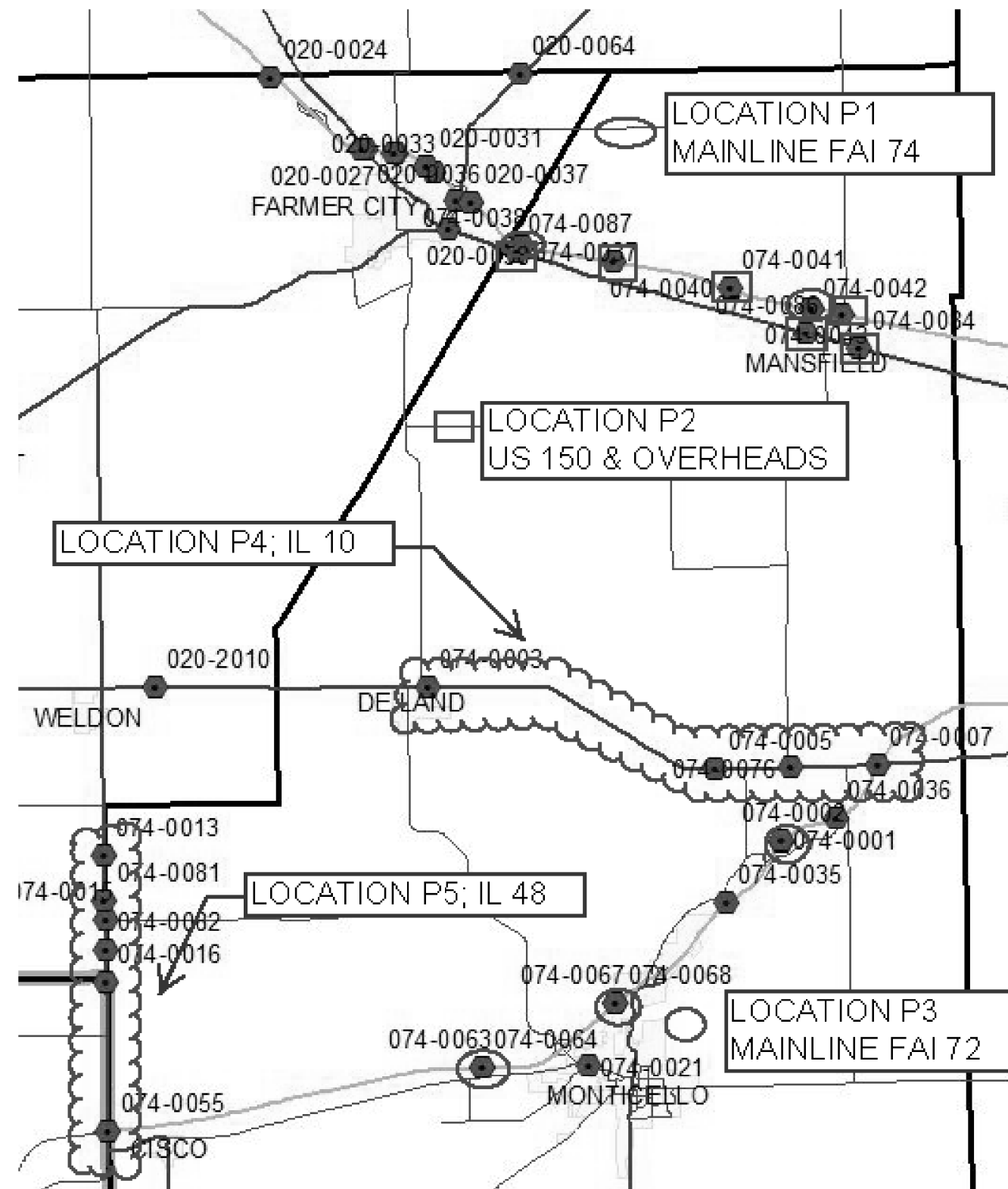

MODEL: \\MODEL\MAME
 FILE: \\MAILS:PIATT\GIS\GISDATA\DOT\Documents\DOT_Offices\District 5\Projects\0570E78\CADD\DATA\Hydraulics\0570E78_rch.mxd.dgn

USER NAME = brandenburgj	DESIGNED - TJB	REVISED - _____
	DRAWN - _____	REVISED - _____
PLOT SCALE = 40,0000' / in.	CHECKED - _____	REVISED - _____
PLOT DATE = 10/21/2020	DATE - 5/4/2020	REVISED - _____

STATE OF ILLINOIS
DEPARTMENT OF TRANSPORTATION

PIATT COUNTY LOCATION MAP - NORTH

SCALE: _____ SHEET 2 OF 5 SHEETS STA. _____ TO STA. _____

F.A. RTE.	SECTION	COUNTY	TOTAL SHEETS	SHEET NO.
VAR.	FY21 BRIDGE DECK SEALING	VARIOUS	22	4
			CONTRACT NO. 70E78	
ILLINOIS FED. AID PROJECT				

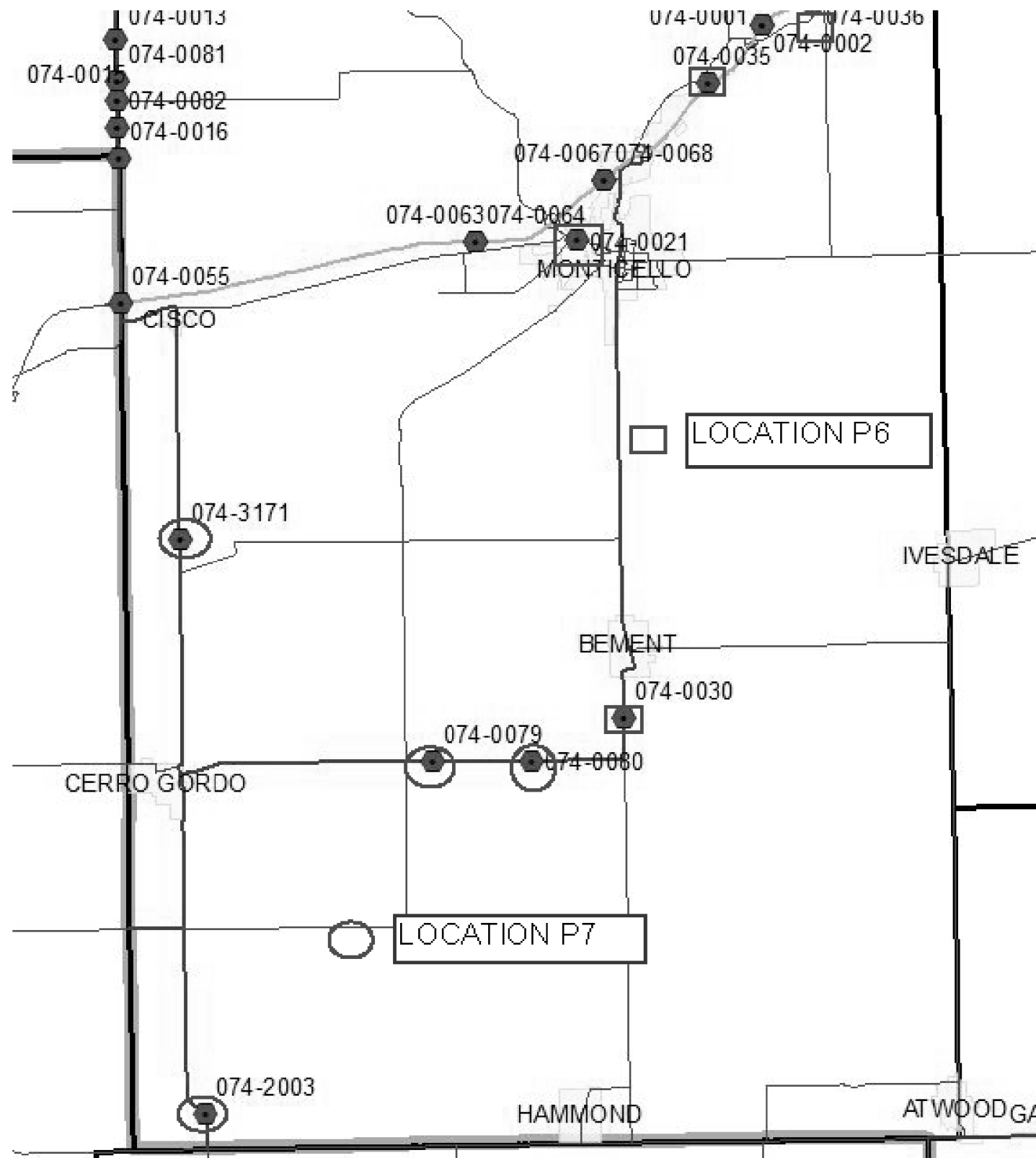

MODEL: \\MODEL\MAME
 FILE: \\MAILS:PIATT\GIS\GISDATA\DOT\Documents\DOT_Offices\District 5\Projects\0570E78\CADD\Hydraulics\0570E78_rpt.mxd.dwg

USER NAME = brandenburgtj	DESIGNED - TJB	REVISED - _____
	DRAWN - _____	REVISED - _____
PLOT SCALE = 40,0000' / in.	CHECKED - _____	REVISED - _____
PLOT DATE = 10/21/2020	DATE - 5/4/2020	REVISED - _____

STATE OF ILLINOIS
DEPARTMENT OF TRANSPORTATION

PIATT COUNTY LOCATION MAP - SOUTH

SCALE: _____ SHEET 3 OF 5 SHEETS STA. _____ TO STA. _____

F.A. RTE.	SECTION	COUNTY	TOTAL SHEETS	SHEET NO.
VAR.	FY21 BRIDGE DECK SEALING	VARIOUS	22	5
			CONTRACT NO. 70E78	
		ILLINOIS	FED. AID PROJECT	

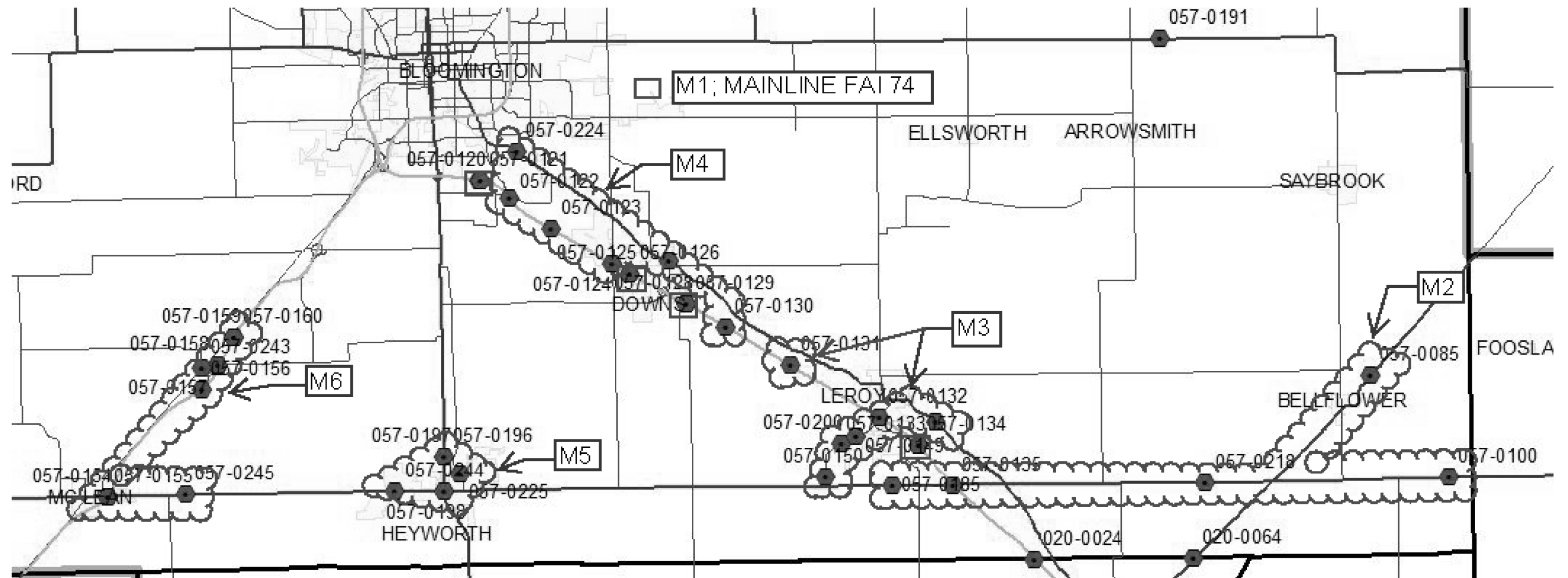

MODEL: \\MODEL\M1M5
 FILE: \\models\pub\blm\com\data\illinois\dot\Documents\DOT_Offices\Bldgct\Projects\05707E7B\CADD\data\Hydraulics\05707E7B\blm\m1m5.dwg

USER NAME = brandenburgj	DESIGNED - TJB	REVISED - _____
	DRAWN - _____	REVISED - _____
PLOT SCALE = 40,0000' / in.	CHECKED - _____	REVISED - _____
PLOT DATE = 10/21/2020	DATE - 5/4/2020	REVISED - _____

STATE OF ILLINOIS
DEPARTMENT OF TRANSPORTATION

MCLEAN COUNTY LOCATION MAP - SOUTH

SCALE: _____ SHEET 4 OF 5 SHEETS STA. _____ TO STA. _____

F.A. RTE.	SECTION	COUNTY	TOTAL SHEETS	SHEET NO.
VAR.	FY21 BRIDGE DECK SEALING	VARIOUS	22	6
			CONTRACT NO. 70E78	
ILLINOIS FED. AID PROJECT				

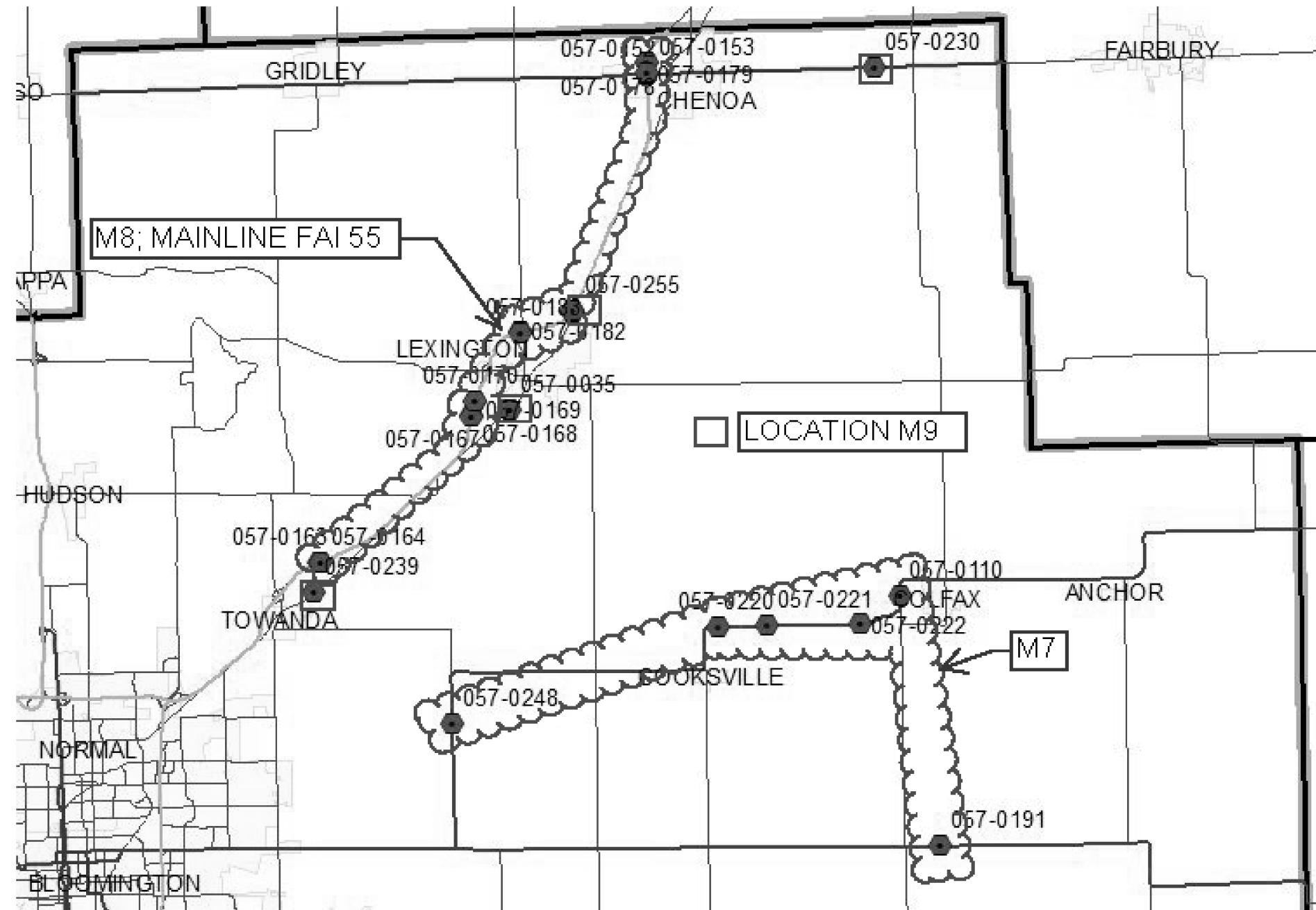

MODEL: \\MODEL\M8\M8
 FILE: \\MAILS:pub\pub\mcom\data\links\gov\HWIDOT\Documents\IBDOT_Offices\District 5\Projects\0570E78\CADD\data\Hydraulics\0570E78-hydraulics.dgn

USER NAME = brandenburgj	DESIGNED - TJB	REVISED - _____
	DRAWN - _____	REVISED - _____
PLOT SCALE = 40,0000' / in.	CHECKED - _____	REVISED - _____
PLOT DATE = 10/21/2020	DATE - 5/4/2020	REVISED - _____

STATE OF ILLINOIS
DEPARTMENT OF TRANSPORTATION

MCLEAN COUNTY LOCATION MAP - NORTH

SCALE: _____ SHEET 5 OF 5 SHEETS STA. _____ TO STA. _____

F.A. RTE.	SECTION	COUNTY	TOTAL SHEETS	SHEET NO.
VAR.	FY21 BRIDGE DECK SEALING	VARIOUS	22	7
			CONTRACT NO. 70E78	
		ILLINOIS	FED. AID PROJECT	

LOCATION OF WORK:
 FUNDING BREAKOUT:
 CONSTRUCTION TYPE CODE:

VARIOUS ROUTES SECTION FY2021 BRIDGE DECK SEALING INTERSTATE, MULTI-LANE AND TWO-LANE HIGHWAYS 80% FEDERAL / 20% STATE BRIDGE PRESERVATION 0047	
DEWITT COUNTY	
RURAL	URBAN

VARIOUS ROUTES SECTION FY2021 BRIDGE DECK SEALING INTERSTATE, MULTI-LANE AND TWO-LANE HIGHWAYS 80% FEDERAL / 20% STATE BRIDGE PRESERVATION 0047	
PIATT COUNTY	
RURAL	URBAN

VARIOUS ROUTES SECTION FY2021 BRIDGE DECK SEALING INTERSTATE, MULTI-LANE AND TWO-LANE HIGHWAYS 80% FEDERAL / 20% STATE BRIDGE PRESERVATION 0047	
MCLEAN COUNTY	
RURAL	URBAN

CODE NO	ITEM	UNIT	TOTAL QUANTITY	QUANTITY	QUANTITY	QUANTITY	QUANTITY	QUANTITY	QUANTITY
67100100	MOBILIZATION	L SUM	1.0	0.2	0.1	0.2	0.1	0.3	0.1
70100420	TRAFFIC CONTROL & PROTECTION, STANDARD 701411	EACH	10.0	2.0	0.0	2.0	0.0	6.0	0.0
70100450	TRAFFIC CONTROL & PROTECTION, STANDARD 701201	L SUM	1.0	0.2	0.0	0.3	0.0	0.5	0.0
70107025	CHANGEABLE MESSAGE SIGN	CAL DA	140.0	56.0	0.0	28.0	0.0	56.0	0.0
X5870015	BRIDGE DECK CONCRETE SEALER	SQ FT	1,230,202.0	182,733.0	120,478.0	248,664.0	92,794.0	480,181.0	105,352.0

NO SPECIALTY ITEMS

MODEL: s:\MODEL\MHFS
 FILE: MHFS: s:\p\h\m\com\ma\data\illinois\p\w\DOT\Documents\DOT_Offices\District 5\Projects\0570E78\CADD\Hydraulics\0570E78\hfs-00a.dgn

USER NAME = brandenburgtj	DESIGNED - TJB	REVISED - TJB
	DRAWN - _____	REVISED - _____
PLOT SCALE = 40.0000 ' / in.	CHECKED - _____	REVISED - _____
PLOT DATE = 11/6/2020	DATE - 5/7/2020	REVISED - 8/5/2020

**STATE OF ILLINOIS
 DEPARTMENT OF TRANSPORTATION**

SUMMARY OF QUANTITIES			
SCALE: _____	SHEET 1	OF 1 SHEETS	STA. _____ TO STA. _____

F.A. RTE.	SECTION	COUNTY	TOTAL SHEETS	SHEET NO.
VAR.	FY21 BRIDGE DECK SEALING	VARIOUS	22	8
			CONTRACT NO. 70E78	
		ILLINOIS	FED. AID PROJECT	

STATE OF ILLINOIS
DEPARTMENT OF TRANSPORTATION

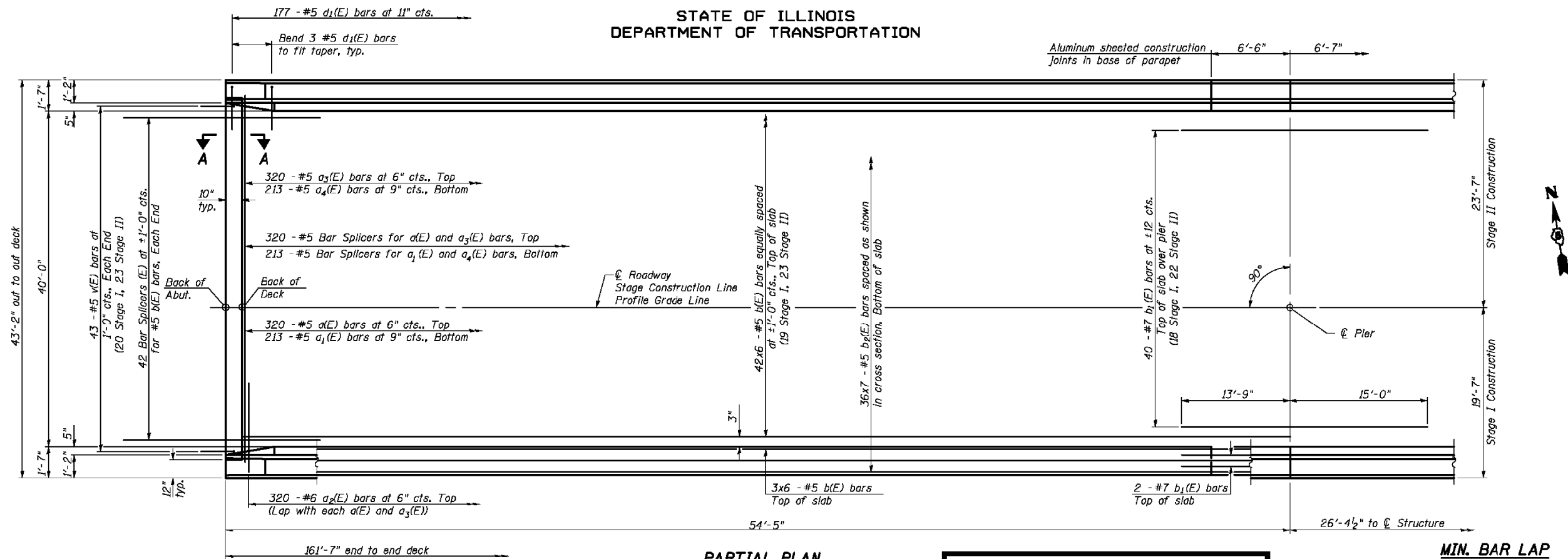

PARTIAL PLAN

PROPOSED BRIDGE DECK CONCRETE SEALER

MIN. BAR LAP
#5 Bar = 1'-8"

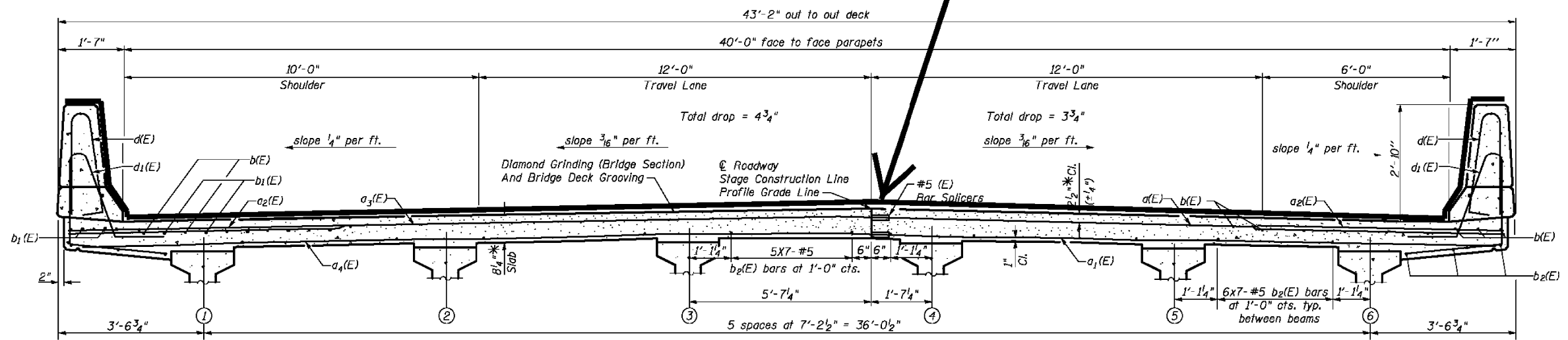

TYPICAL SECTION; FOUR-LANE WITH PARAPET; DUAL STRUCTURES

NEAR PIER

NEAR MIDSPAN

SUPERSTRUCTURE
I-74 OVER LITTLE KICKAPOO CREEK
STRUCTURE NO. 057-0120
AND 057-0121

STRAND ASSOCIATES, INC.

DESIGNED	RRD
CHECKED	AJS
DRAWN	KAS
CHECKED	JAR

Notes:
See Sheet 12 of 27 for superstructure details and Bill of Material.
Bars indicated thus 20 x 3-#5 etc. indicates 20 lines of bars with 3 lengths per line.
See Sheet 12 of 27 for parapet reinforcement.
See Sheet 27 of 27 for bar splicers details.
See Sheet 11 of 27 for diaphragm details.

CROSS SECTION
(Looking Upstation Westbound)
(Looking Downstation Eastbound)

* Prior to grinding

SHEET NO. 10	F.A.I. RTE.	SECTION	COUNTY	TOTAL SHEETS	SHEET NO.
	74	(57-21B)BR	MCLEAN	61	22
27 SHEETS	SUPERSTRUCTURE DETAILS (1 OF 3)		CONTRACT NO. 70641		
FED. ROAD DIST. NO. 7 ILLINOIS FED. AID PROJECT					

STATE OF ILLINOIS
DEPARTMENT OF TRANSPORTATION

TYPICAL SECTIONS

SCALE: _____ SHEET 1 OF 5 SHEETS STA. _____ TO STA. _____

F.A.I. RTE.	SECTION	COUNTY	TOTAL SHEETS	SHEET NO.
VAR.	FY21 BRIDGE DECK SEALING	VARIOUS	22	9
CONTRACT NO. 70E78				
ILLINOIS FED. AID PROJECT				

MODEL: \\MODEL\MAT\... FILE NAME: ...

STATE OF ILLINOIS
DEPARTMENT OF PUBLIC WORKS & BUILDINGS
DIVISION OF HIGHWAYS

PROJECT NO.	SECTION	COUNTY	TOTAL SHEETS	SHEET NO.
74	57-17B	MCLEAN	19	6
F.A.R.T. 74		ILLINOIS		FED. AID PROJECT

SHEET NO. 6
8 SHEETS

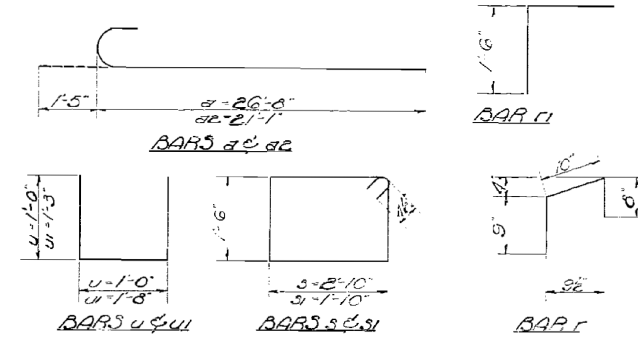
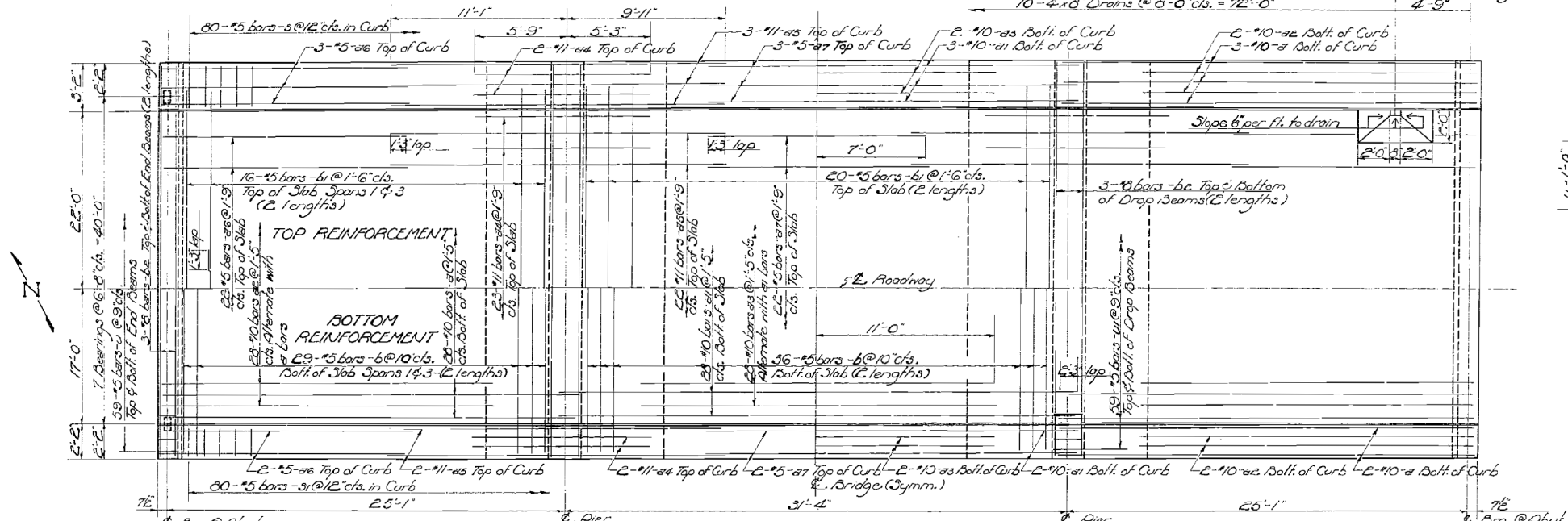
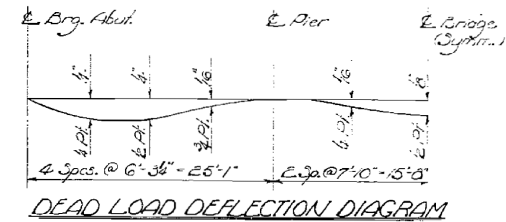
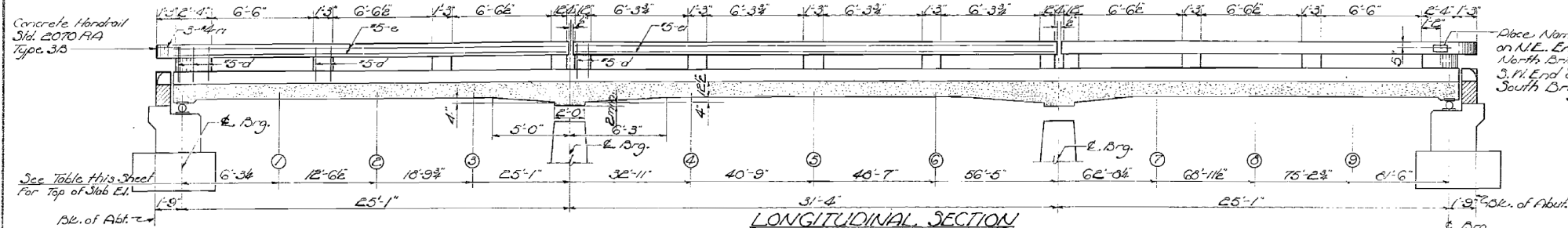

BILL OF MATERIAL - E BRIDGES

Bar	No.	Size	Length	Splice
#1	132	#10	25'-1"	
#1	66	#10	33'-6"	
#2	128	#10	22'-6"	
#2	64	#10	22'-0"	
#3	108	#11	11'-0"	
#3	108	#11	21'-0"	
#4	100	#5	15'-9"	
#4	54	#5	14'-0"	
#5	376	#5	22'-3"	
#5	208	#5	21'-6"	
#6	96	#8	23'-0"	
#7	160	#5	9'-5"	
#7	160	#5	7'-5"	
#8	472	#3	3'-0"	
#8	472	#3	4'-2"	
#9	216	#5	2'-9"	
#9	32	#5	25'-6"	
#9	16	#5	31'-0"	
#9	112	#4	2'-3"	
#9	24	#4	3'-0"	
Class A Concrete		Cu. Yds.	334.1	
Handrail Concrete		Cu. Yds.	2.0	
Reinforcement Bars		Lbs.	32,830	
Structural Steel		Lbs.	20,040	
Name Plates		Each	2	

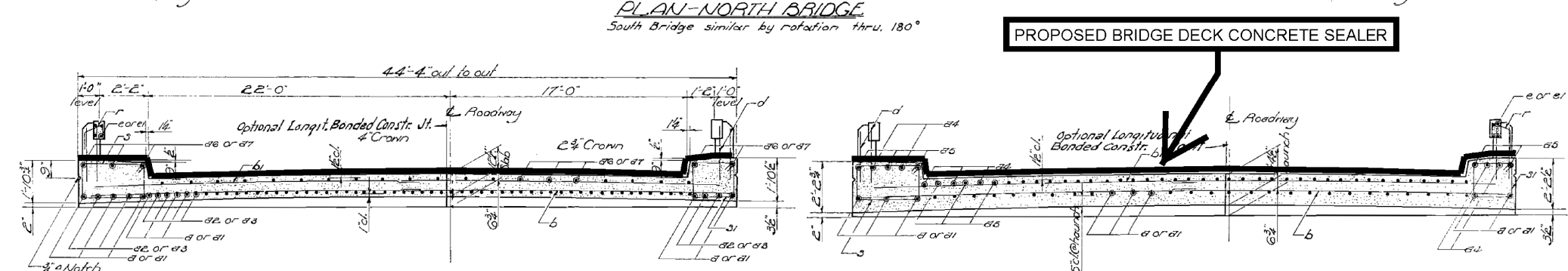

TYPICAL SECTION; FOUR-LANE WITH CURB; DUAL STRUCTURES

Location	E. Brg. Abut. (1)	(2)	(3)	E. Pier 1 (4)	(5)	(6)	E. Pier 2 (7)	(8)	E. Brg. Abut. (9)		
Theoretical Elevation	755.75	755.78	755.81	755.85	755.88	755.93	756.02	756.10	756.14	756.18	756.22
Theoretical El. + 2' Defl.	755.75	755.80	755.83	755.86	755.88	755.93	756.02	756.07	756.11	756.16	756.22

ROADWAY NORTH & SOUTH LANES

DESIGNED: Joseph W. Lomic
CHECKED: C. W. Slick
DRAWN: R. W. L. III
CHECKED: C. W. S.

APR 13 1961

EXAMINED: H. E. Bauman
PASSED: E. H. ...
APPROVED: R. R. ...

SUPERSTRUCTURE
F.A.R.T. 74 - SEC. 57-17B
MCLEAN COUNTY
STA. 1512+64

Added Long. Bonded Constr. (Main). A. D. 12/12/63.

MODEL: S:\MODEL\MAME... FILE NAME: P:\pub\mcom\da\illinois\gov\pww\DOT\Documents\DOT - Office\Drawings\Projects\5707E7B\CADD\DATA\Hydraulics\5707E7B-Sub-Details.dwg

STATE OF ILLINOIS
DEPARTMENT OF TRANSPORTATION

ROUTE NO.	SECTION	COUNTY	TOTAL SHEETS	SHEET NO.	SHEET NO.
F.A.I. 57	10-32HB-3,K	CHAMPAIGN	352	119	27 SHEETS
FED. ROAD DIST. NO. 7	ILLINOIS	FED. AID PROJECT			

Contract #90758

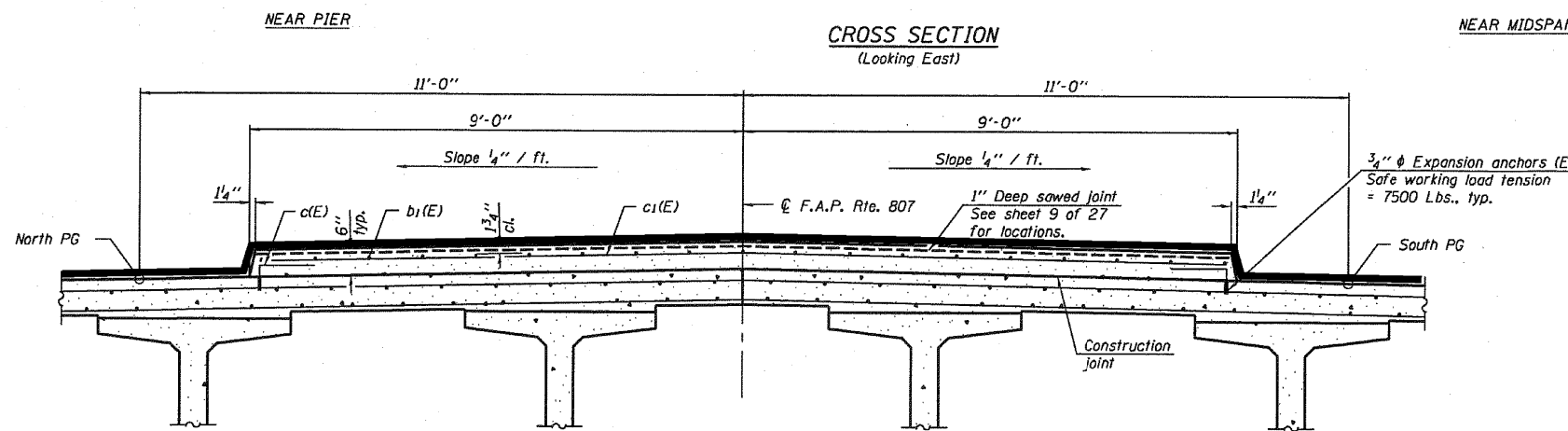
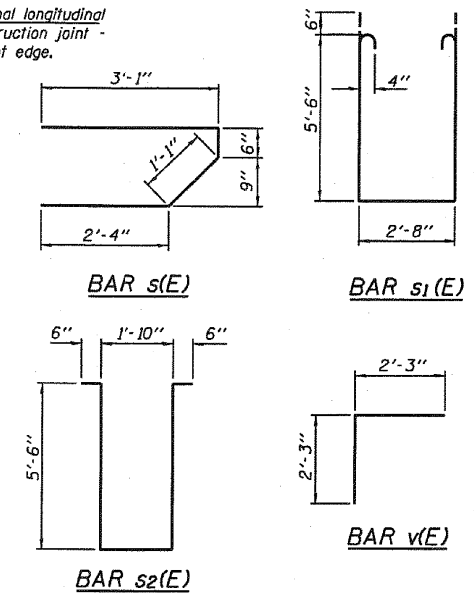
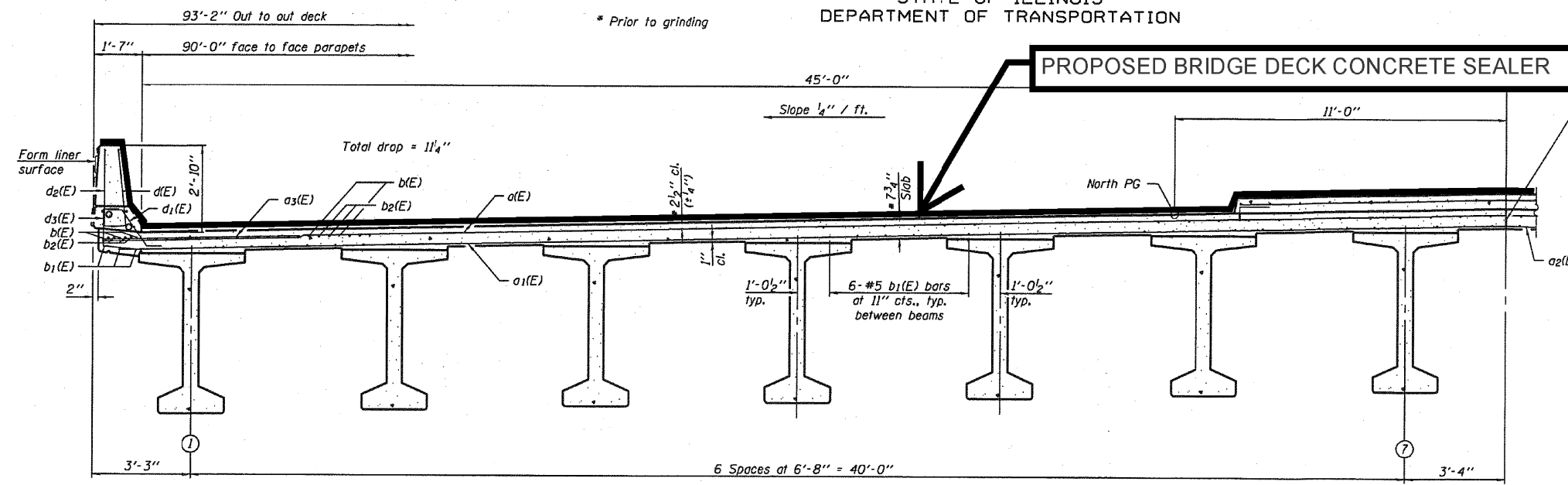

TYPICAL SECTION WITH MEDIAN

SECTION THRU MEDIAN
(Looking East)

Notes:
See sheet 11 of 27 for additional superstructure details and Bill of Material.
For diaphragm details, see sheets 12 and 13 of 27.
Reinforcement bars designated (E) shall be epoxy coated.
Bars indicated thus 20 x 3-#5 etc. indicates 20 lines of bars with 3 lengths per line.
See sheet 11 of 27 for parapet reinforcement.
Limestone Form Liner Textured Surface to be used on outside face of parapet. Utilize Teton Dry Stack (Scott system #189) or equivalent.
The depth of relief of the Form Liner Textured Surface is limited to 1". The relief should not compromise the reinforcement clearance in the parapet.
Cost of expansion anchors (E) included in the cost of Reinforcement Bars, Epoxy Coated.

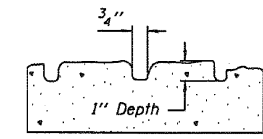
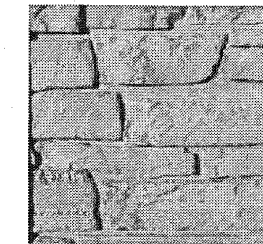

FORM LINER TEXTURE DETAIL
See Special Provisions.

SUPERSTRUCTURE DETAILS
F.A.I. ROUTE 57 SEC. 10-32HB-3,K
CHAMPAIGN COUNTY
STATION 297+20.45
STRUCTURE NO. 010-0272

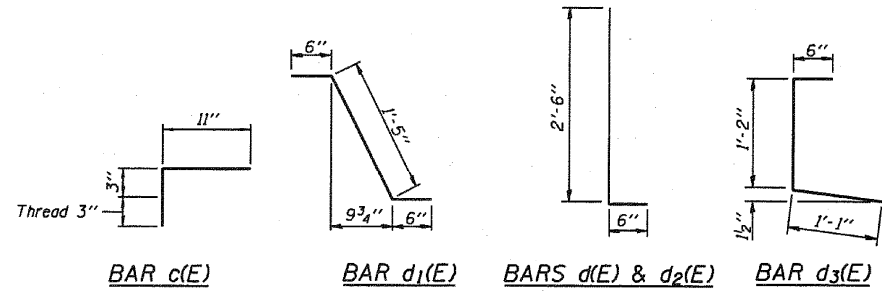

DESIGNED	Gholam R. Ahanchi
CHECKED	Rebecca L. Thorp
DRAWN	Michael B. Mossman
CHECKED	G.R.A. / R.L.T.

April 28, 2006
EXAMINED *Thomas J. Donagalli*
PASSED *Ralph E. Anderson*
ENGINEER OF BRIDGES AND STRUCTURES

STATE OF ILLINOIS
DEPARTMENT OF TRANSPORTATION

TYPICAL SECTIONS

USER NAME = brandenburgjt	DESIGNED - TJB	REVISED -
PLOT SCALE = 40.0000 ' / in.	CHECKED -	REVISED -
PLOT DATE = 10/21/2020	DATE - 5/4/2020	REVISED -

SCALE: _____ SHEET 5 OF 5 SHEETS STA. _____ TO STA. _____

F.A. RTE.	SECTION	COUNTY	TOTAL SHEETS	SHEET NO.
VAR. FY21 BRIDGE DECK SEALING	VARIOUS	ILLINOIS	22	13
CONTRACT NO. 70E78				

MODEL: S:\MODEL\MAR15... FILE NAME: P:\pub\mossman\adad\illinois\pwr\DOT\Documents\DOT Office\Drawings\Project\5707E78\CADD\Bridges\Hydraulics\5707E78-shs-detailed.dwg

DEWITT COUNTY STRUCTURES SCHEDULE OF QUANTITIES

ACTUAL MEASUREMENTS

SN	ROUTE CARRIED	FEATURE CROSSED	SIMS INFORMATION		DECK			APPROACH SLABS					PARAPETS (HUB, FACE & TOP)			TYPE B CURB (FACE & TOP)			TOTAL (SQ FT)	RURAL	URBAN	FIELD MEASURED		
			LENGTH	WIDTH	LENGTH (E-E)	WIDTH (F-F)	AREA (SQ FT)	LENGTH (FT)	DIMENSIONS INSIDE PARAPET / CURB		DIMENSIONS BEYOND PARAPET / CURB		AREA (SQ FT)	HEIGHT	LENGTH (FT)		AREA (SQ FT)	HEIGHT					LENGTH	
									LENGTH	WIDTH	LENGTH	WIDTH			3.6 FT TYPICAL	ALONG DECK							ALONG APPR.	9 INCH TYPICAL
020-0005	US 51 (SB)(FAP 322)	SALT CREEK	309.5	43.2	306.5	40.0	12260.0	30.0	11.5	40.0	18.5	24.0	1808.0	3.60	306.5	11.5	2372.4	0.75	4.5	13.5	16454.0	X		YES
020-0020	IL 54 (FAP 71)	SALT CREEK	393.0	35.2	389.6	32.0	12467.2	21.0	0	32.0	21.0	33.2	1394.4	3.60	389.6	0.0	2805.1	0.75	20.0	60.0	16727.0	X		YES
020-0024	TR 5 RELOCATED	I-74	256.5	30.0	256.5	26.5	6797.3	20.0	0	26.5	20.0	33.2	1328.0	3.80	256.5	0.0	1949.4	0.00	20.0	0.0	10075.0	X		
020-0026	I-74(EB)	US 150 & CNRR	366.7	42.5	364.4	39.0	14210.4	40.0	13.5	24.0	26.5	24.0	1920.0	3.20	364.4	13.5	2504.8	0.00	26.5	0.0	18636.0	X		
020-0027	I-74(WB)	US 150 & CNRR	366.7	42.5	364.4	39.0	14210.4	40.0	13.5	24.0	26.5	24.0	1920.0	3.20	364.4	13.5	2504.8	0.00	26.5	0.0	18636.0	X		
020-0028	I-74(EB)	FAS 2495	109.0	42.0	106.7	38.5	4106.8	40.0	10.0	24.0	30.0	24.0	1920.0	3.20	106.7	10.0	810.7	0.00	30.0	0.0	6838.0		X	
020-0029	I-74(WB)	FAS 2495	109.0	42.0	106.7	38.5	4106.8	40.0	10.0	24.0	30.0	24.0	1920.0	3.20	106.7	10.0	810.7	0.00	30.0	0.0	6838.0		X	
020-0030	I-74(EB)	ICRR	150.0	42.0	147.7	38.5	5685.3	40.0	11.5	24.0	28.5	24.0	1920.0	3.20	147.7	11.5	1092.3	0.00	28.5	0.0	8698.0		X	
020-0031	I-74(WB)	ICRR	150.0	42.0	147.7	38.5	5685.3	40.0	11.5	24.0	28.5	24.0	1920.0	3.20	147.7	11.5	1092.3	0.00	28.5	0.0	8698.0		X	
020-0032	I-74(EB)	TRIB TO SALT CREEK	162.6	42.0	160.3	38.5	6170.4	40.0	13.5	24.0	26.5	24.0	1920.0	3.20	160.3	13.5	1198.5	0.00	26.5	0.0	9289.0		X	
020-0033	I-74(WB)	TRIB TO SALT CREEK	162.6	42.0	160.3	38.5	6170.4	40.0	13.5	24.0	26.5	24.0	1920.0	3.20	160.3	13.5	1198.5	0.00	26.5	0.0	9289.0		X	
020-0035	IL 54 (FAP 71)	TRIB TO SALT CREEK	108.5	66.7	107.5	65.0	6987.5	30.0	13.5	65.0	16.5	66.2	3939.6	3.60	107.5	13.5	968.4	0.75	16.5	49.5	11945.0	X		
020-0036	I-74(EB)	SALT CREEK	185.5	43.2	183.2	39.7	7271.8	40.0	13.5	24.0	26.5	24.0	1920.0	3.20	183.2	13.5	1345.1	0.00	26.5	0.0	10537.0	X		
020-0037	I-74(WB)	SALT CREEK	185.5	43.2	183.2	39.7	7271.8	40.0	13.5	24.0	26.5	24.0	1920.0	3.20	183.2	13.5	1345.1	0.00	26.5	0.0	10537.0	X		
020-0048	US 51 (SB)(FAP 322)	LONG POINT CREEK	153.0	43.2	149.8	40.0	5992.0	20.0	20	16.0	0.0	24.0	640.0	3.60	149.8	16.0	1309.0	0.75	4.0	12.0	7953.0	X		YES
020-0049	US 51 (NB)(FAP 322)	LONG POINT CREEK	153.0	43.2	149.8	40.0	5992.0	20.0	20	16.0	0.0	24.0	640.0	3.60	149.8	16.0	1309.0	0.75	4.0	12.0	7953.0	X		YES
020-0050	US 51 (SB)(FAP 322)	TEN MILE CREEK	98.0	43.2	94.3	40.0	3772.0	13.5	13.5	16.0	0.0	24.0	432.0	3.60	94.3	13.5	873.4	0.75	0.0	0.0	5078.0		X	YES
020-0051	US 51 (NB)(FAP 322)	TEN MILE CREEK	98.0	43.2	94.3	40.0	3772.0	13.5	13.5	16.0	0.0	24.0	432.0	3.60	94.3	13.5	873.4	0.75	0.0	0.0	5078.0		X	YES
020-0052	US 51 (NB)(FAP 322)	TEN MILE CREEK	191.2	43.2	187.8	40.0	7512.0	16.0	16	16.0	0.0	24.0	512.0	3.60	187.8	13.5	1546.6	0.75	3.0	9.0	9580.0		X	YES
020-0053	US 51 (SB)(FAP 322)	TEN MILE CREEK	191.2	43.2	187.8	40.0	7512.0	16.0	16	16.0	0.0	24.0	512.0	3.60	187.8	13.5	1546.6	0.75	3.0	9.0	9580.0		X	YES
020-0054	US 51 BUSN(FAP 708)	COON CREEK	95.3	43.2	91.6	40.0	3664.0	28.0	18	40.0	10.0	24.0	1920.0	3.60	91.6	13.5	853.9	0.75	4.5	13.5	6452.0		X	YES
020-0055	US 51 (SB)(FAP 322)	COON CREEK	243.0	43.2	239.2	40.0	9568.0	16.0	16	16.0	0.0	24.0	512.0	3.60	239.2	13.5	1916.6	0.75	2.5	7.5	12005.0		X	YES
020-0056	US 51 (NB)(FAP 322)	COON CREEK	243.0	43.2	239.2	40.0	9568.0	16.0	16	16.0	0.0	24.0	512.0	3.60	239.2	13.5	1916.6	0.75	2.5	7.5	12005.0		X	YES
020-0057	US 51 (NB)(FAP 322)	SALT CREEK	300.0	43.2	296.5	40.0	11860.0	18.5	18.5	16.0	0.0	24.0	592.0	3.60	296.5	13.5	2329.2	0.75	5.0	15.0	14797.0	X		YES
020-0058	FAS 1517(US 150)	SALT CREEK	175.0	35.2	175.0	32.0	5600.0	30.0	0	32.0	30.0	33.2	1992.0	3.60	175.0	0.0	1260.0	0.75	30.0	90.0	8942.0	X		
020-0061	IL 10 (FAP 717)	CREEK	53.0	35.2	53.0	32.0	1696.0	30.0	30	32.0	0.0	32.0	1920.0	3.60	53.0	0.0	381.6	0.75	30.0	90.0	4088.0	X		YES
020-0062	IL 10 (FAP 721)	SALT CREEK	188.0	35.2	188.0	32.0	6016.0	30.0	0	32.0	30.0	32.8	1968.0	3.60	188.0	0.0	1353.6	0.75	30.0	90.0	9428.0	X		YES
020-0063	IL 10 (FAP 717)	CREEK	160.0	35.2	160.0	32.0	5120.0	30.0	0	32.0	30.0	32.8	1968.0	3.60	160.0	0.0	1152.0	0.75	30.0	90.0	8331.0		X	YES
020-0064	FAP 71 (IL 54)	SALT CREEK	172.7	35.2	172.7	32.0	5526.4	30.0	15	32.0	15.0	33.8	1974.0	3.60	172.7	15.0	1459.4	0.75	15.0	45.0	9005.0	X		
020-2006	US 51 (NB)(FAP 322)	TEN MILE CREEK	53.0	41.5	52.0	40.0	2080.0	12.0	12	16.0	0.0	24.0	384.0	2.10	52.0	0.0	218.4	0.75	12.0	36.0	2719.0		X	YES
020-2010	IL 10 (FAP 721)	FRIENDS CREEK DITCH	25.0	34.7	25.0	32.0	800.0	30.0	30	32.0	0.0	24.0	1920.0	2.10	27.0	0.0	113.4	0.75	30.0	90.0	2924.0	X		YES
020-2014	IL 54 (FAP 71)	COON CREEK	42.8	40.0	42.8	37.0	1583.6	30.0	30	37.0	0.0	24.0	2220.0	2.25	42.8	0.0	192.6	0.83	30.0	99.6	4096.0	X		YES
32	AS-BUILT CORRECTIONS FROM 70C72 IN 2018 NOTED AS FIELD MEASURED; NO AS-BUILT CORRECTIONS FROM CONTRACTS 70917 IN 2012 OR 70B94 IN 2017																	TOTALS (SQ FT)			303,211	182,733	120,478	
																	EST. WD'S (80,000 SQ FT/DAY)			4	2	2		

MODEL: I:\MODEL\MHFE
 FILE: MHFE - 2018\Illinois\DOT\Documents\DOT - Office\Drawings\DOT\Drawings\Hydraulics\DOTS70E78-Sub-Structure.dwg

USER NAME = brandenburgj	DESIGNED - TJB	REVISED - _____
	DRAWN - _____	REVISED - _____
PLOT SCALE = 40.0000 ' / in.	CHECKED - _____	REVISED - _____
PLOT DATE = 11/6/2020	DATE - 5/4/2020	REVISED - _____

**STATE OF ILLINOIS
DEPARTMENT OF TRANSPORTATION**

DEWITT COUNTY SCHEDULE OF QUANTITIES			
SCALE: _____	SHEET 1	OF 8 SHEETS	TO STA. _____

F.A. RTE.	SECTION	COUNTY	TOTAL SHEETS	SHEET NO.
VAR.	FY21 BRIDGE DECK SEALING	VARIOUS	22	14
CONTRACT NO. 70E78				
		ILLINOIS	FED. AID PROJECT	

PIATT COUNTY STRUCTURES SCHEDULE OF QUANTITIES

ACTUAL MEASUREMENTS

SN	ROUTE CARRIED	FEATURE CROSSED	SIMS INFORMATION		DECK			APPROACH SLABS					PARAPETS (HUB, FACE & TOP)				TYPE B CURB (FACE & TOP)			TOTAL (SQ FT)	RURAL	URBAN	FIELD MEASURED	
			LENGTH	WIDTH	LENGTH (E - E)	WIDTH (F-F)	AREA (SQ FT)	LENGTH (FT)	DIMENSIONS INSIDE PARAPET / CURB		DIMENSIONS BEYOND PARAPET / CURB		AREA (SQ FT)	HEIGHT	LENGTH (FT)		AREA (SQ FT)	HEIGHT	LENGTH					AREA (SQ FT)
									LENGTH	WIDTH	LENGTH	WIDTH			3.6 FT TYPICAL	ALONG DECK								
074-0001	I-72 (EB)	IC RR	151.7	41.6	149.4	38.4	5735.8	29.5	14.76	38.4	14.8	41.6	2362.4	4.15	149.4	14.8	1484.8	0.75	14.8	44.3	9628.0	X		
074-0002	I-72 (WB)	IC RR	151.7	41.6	149.4	38.4	5735.8	29.5	14.76	38.4	14.8	41.6	2362.4	4.15	149.4	14.8	1484.8	0.75	14.8	44.3	9628.0	X		
074-0003	IL 10 (FAP 721)	GOOSE CREEK	41.9	33.0	39.9	33.0	1316.7	30.0	0	33.0	30.0	33.0	1980.0	0.00	0.0	0.0	0.0	0.00	0.0	0.0	3297.0	X		
074-0005	IL 10 (FAP 721)	MADDEN CREEK	151.4	32.0	149.1	32.0	4770.2	0.0	0	32.0	0.0	32.0	0.0	0.00	0.0	0.0	0.0	0.00	0.0	0.0	4771.0	X		
074-0007	IL 10 (FAP 721)	I-72	269.2	36.2	266.9	33.0	8806.7	30.0	0	33.0	30.0	36.2	2172.0	4.15	266.9	0.0	2215.0	0.75	30.0	90.0	13284.0	X		
074-0013	IL 48(FAP 760)	CREEK	32.0	42.2	29.7	38.5	1142.3	20.0	0	38.5	20.0	42.2	1688.0	0.00	29.7	0.0	145.7	0.75	5.0	15.0	2992.0	X		
074-0015	IL 48(FAP 760)	CREEK	47.6	35.2	45.3	32.0	1448.6	20.0	0	32.0	20.0	35.2	1330.0	4.15	45.3	0.0	375.7	0.75	5.0	15.0	3170.0	X		
074-0016	IL 48(FAP 760)	CREEK	25.4	42.2	23.1	38.5	888.2	20.0	0	38.5	20.0	42.2	1688.0	0.00	23.1	0.0	117.6	0.75	5.0	15.0	2709.0	X		
074-0021	FAS 538(BRIDGE ST)	SANGAMON RIVER	530.7	39.2	528.4	36.0	19021.3	30.0	13.5	36.0	16.5	39.2	2265.6	4.15	528.4	13.5	4609.6	0.75	16.5	49.5	25946.0		X	YES
074-0030	IL 105(FAP 741)	CREEK	29.0	45.3	26.7	42.3	1128.9	20.0	0	42.3	20.0	45.3	1812.0	2.25	26.7	0.0	120.0	0.75	5.0	15.0	3076.0	X		
074-0035	TR 87	I-72	223.2	27.7	220.9	22.0	4859.1	0.0	0	22.0	0.0	27.7	0.0	3.32	220.9	0.0	1466.6	0.75	0.0	0.0	6714.8	X		
074-0036	FAS 1532 (TR 154)	I-72	233.4	29.8	231.1	24.0	5545.7	0.0	0	24.0	0.0	29.8	0.0	3.32	231.1	0.0	1534.3	0.75	0.0	0.0	0.0	X		
074-0037	I-74(EB)	S BRANCH SALT CREEK	117.3	42.0	115.0	38.5	4426.3	40.0	10.0	24.0	30.0	24.0	1920.0	3.20	115.0	10.0	863.8	0.00	30.0	0.0	7211.0	X		YES
074-0038	I-74(WB)	S BRANCH SALT CREEK	117.3	42.0	115.0	38.5	4426.3	40.0	10.0	24.0	30.0	24.0	1920.0	3.20	115.0	10.0	863.8	0.00	30.0	0.0	7211.0	X		YES
074-0040	TR 80	I-74	254.9	30.0	252.6	28.0	7072.0	0.0	0	28.0	0.0	30.0	0.0	3.32	252.6	0.0	1677.1	0.75	0.0	0.0	8750.0	X		
074-0041	TR 96	I-74	260.6	30.0	258.3	28.0	7231.6	0.0	0	28.0	0.0	30.0	0.0	3.32	258.3	0.0	1714.9	0.75	0.0	0.0	8947.0	X		
074-0042	I-74(EB)	NSRR & MADDEN CREEK	236.5	42.0	234.2	38.5	9015.5	40.0	11.5	24.0	28.5	24.0	1920.0	3.20	234.2	11.5	1645.9	0.00	28.5	0.0	12582.0	X		YES
074-0043	I-74(WB)	NSRR & MADDEN CREEK	236.5	42.0	234.2	38.5	9015.5	40.0	11.5	24.0	28.5	24.0	1920.0	3.20	234.2	11.5	1645.9	0.00	28.5	0.0	12582.0	X		YES
074-0044	FAS 495	I-74	251.7	68.0	249.4	64.8	16159.2	0.0	0	64.8	0.0	68.0	0.0	4.32	249.4	0.0	2154.6	0.75	0.0	0.0	18314.0	X		
074-0055	IL 48 (FAP 760)	I-72	250.8	68.0	248.5	64.8	16338.9	0.0	0	64.8	0.0	68.0	155.0	3.46	248.5	5.0	1788.6	0.75	5.0	15.0	18298.0	X		
074-0063	I-72 (EB)	WILDCAT CREEK	107.2	42.0	104.9	38.8	4069.0	0.0	0	38.8	0.0	42.0	0.0	3.43	104.9	0.0	719.4	0.75	0.0	0.0	4789.0	X		
074-0064	I-72 (WB)	WILDCAT CREEK	107.2	42.0	104.9	38.8	4069.0	0.0	0	38.8	0.0	42.0	0.0	3.43	104.9	0.0	719.4	0.75	0.0	0.0	4789.0	X		
074-0067	I-72 (EB)	SANGAMON RIVER	677.9	42.0	675.6	38.5	26009.4	0.0	0	38.5	0.0	42.0	2928.7	3.32	675.6	0.0	4485.8	0.75	0.0	0.0	33424.0		X	YES
074-0068	I-72 (WB)	SANGAMON RIVER	677.9	42.0	675.6	38.5	26009.4	0.0	0	38.5	0.0	42.0	2928.7	3.32	675.6	0.0	4485.8	0.75	0.0	0.0	33424.0		X	YES
074-0076	IL 10(FAP 721)	SANGAMON RIVER	590.0	34.0	587.7	32.0	18805.4	0.0	0	32.0	0.0	34.0	0.0	4.15	587.7	13.5	5101.8	0.75	0.0	0.0	23908.0	X		
074-0079	IL 105(FAP 741)	CREEK	52.5	43.2	50.2	40.0	2006.8	20.0	0	40.0	20.0	43.2	1470.6	4.15	50.2	0.0	416.4	0.75	5.0	15.0	3909.0	X		
074-0080	IL 105(FAP 741)	STREAM	42.0	43.2	39.7	40.0	1586.8	20.0	0	40.0	20.0	43.2	1470.6	4.15	39.7	0.0	329.3	0.75	5.0	15.0	3402.0	X		
074-0081	IL 48(FAP 760)	STREAM	82.0	35.2	79.7	32.0	2549.4	20.0	0	32.0	20.0	35.2	1470.6	4.15	79.7	0.0	661.3	0.75	5.0	15.0	4697.0	X		
074-0082	IL 48(FAP 760)	FRIENDS CREEK DITCH	147.5	35.2	145.2	32.0	4645.4	20.0	0	32.0	20.0	35.2	1287.0	4.15	145.2	0.0	1204.9	0.75	5.0	15.0	7153.0	X		
074-0084	FAS 1517(US 150)	MADDEN CREEK	66.5	35.2	64.2	32.0	2053.4	30.0	0	32.0	30.0	35.2	2112.0	4.15	64.2	0.0	532.6	0.75	30.0	90.0	4789.0	X		
074-0086	US 150 (FAS 1517)	N & W RR	164.0	35.2	161.7	32.0	5173.4	30.0	15	32.0	15.0	35.2	2016.0	4.15	161.7	15.0	1590.9	0.75	15.0	45.0	8826.0	X		
074-0087	FAS 1517 (US 150)	S BRANCH SALT CREEK	113.0	35.2	110.7	32.0	3541.4	30.0	15	32.0	15.0	35.2	2016.0	4.15	110.7	15.0	1167.6	0.75	15.0	45.0	6771.0	X		
074-2003	FAP 758(IL 32)	STREAM	45.3	63.8	43.0	32.0	1375.0	30.0	0	32.0	30.0	35.0	2100.0	2.25	43.0	0.0	193.4	0.75	30.0	90.0	3759.0	X		
074-3171	FAP 760 (CH 17)	SANGAMON RIVER	372.0	36.2	369.7	34.0	12568.8	30.0	15	34.0	15.0	36.2	2820.0	4.15	369.7	15.0	3317.3	0.75	0.0	0.0	18707.0	X		

33 NO AS-BUILT CORRECTIONS FROM CONTRACTS 70918 IN 2014 OR 70B94 IN 2017 TOTALS (SQ FT) 341,458 248,664 92,794

074-0036 DECK RATING IS "4"; MUST BE >= "5" FOR BRIDGE PRESERVATION DECK SEALING EST. WD'S (80,000 SQ FT/DAY) 4 3 1

MODEL: I:\MODEL\MHFS FILE: MHFS_Plan\p10m\p10m.dwg PROJECT: 05707E\FACILITY\DATA\Hydraulics\05707E\FACILITY.dgn

USER NAME = brandenburgj	DESIGNED - TJB	REVISED - _____
	DRAWN - _____	REVISED - _____
PLOT SCALE = 40.0000 ' / in.	CHECKED - _____	REVISED - _____
PLOT DATE = 11/6/2020	DATE - 5/4/2020	REVISED - _____

**STATE OF ILLINOIS
DEPARTMENT OF TRANSPORTATION**

PIATT COUNTY SCHEDULE OF QUANTITIES	
SCALE: _____	SHEET 2 OF 8 SHEETS STA. _____ TO STA. _____

F.A. RTE.	SECTION	COUNTY	TOTAL SHEETS	SHEET NO.
VAR.	FY21 BRIDGE DECK SEALING	VARIOUS	22	15
CONTRACT NO. 70E78				
ILLINOIS FED. AID PROJECT				

DEWITT COUNTY STRUCTURES SCHEDULE OF QUANTITIES															
TRAFFIC CONTROL & PROTECTION															
PROSECUTION & PROGRESS															
SN	ROUTE CARRIED	FEATURE CROSSED	701201	701411 (DL ONLY)	701426 SPECIAL	701427 SPECIAL	701446	D5 DETAIL 70200000 ROAD CLOSURE	LOCATION	SUMMARY	CHANGEABLE MESSAGE SIGN (Calendar Days)	WORKING DAYS	PROSECUTION	RURAL	URBAN
020-0020	IL 54 (FAP 71)	SALT CREEK	2											X	
020-0061	IL 10 (FAP 717)	CREEK	2						D2	6-701201; 1WD; 3SN		1	2 HRS PER LOC.	X	
020-0063	IL 10 (FAP 717)	CREEK	2												X
020-0024	TR 5 RELOCATED	I-74						1						X	
020-0035	IL 54 (FAP 71)	TRIB TO SALT CREEK	2						D5	6-701201; 1WD; 4SN		1	2 HRS PER LOC.	X	
020-0058	FAS 1517(US 150)	SALT CREEK	2							1-ROAD CLOSURE				X	
020-0064	FAP 71 (IL 54)	SALT CREEK	2											X	
020-0026	I-74(EB)	US 150 & CNRR			1									X	
020-0027	I-74(WB)	US 150 & CNRR			INCL.									X	
020-0028	I-74(EB)	FAS 2495			INCL.										X
020-0029	I-74(WB)	FAS 2495			INCL.					2 - CMS ON FAI 74 EB & WB;					X
020-0030	I-74(EB)	ICRR			INCL.				D4	2 - 701411;	DUAL DISPLAY;	2	2 HRS PER LOC.		X
020-0031	I-74(WB)	ICRR		1	INCL.					4 - 701426 SPECIAL;	7 CAL. DAYS PRIOR;				X
020-0032	I-74(EB)	TRIB TO SALT CREEK			INCL.					10 SN	TOTAL 28 CAL. DAYS				X
020-0033	I-74(WB)	TRIB TO SALT CREEK		1	1										X
020-0036	I-74(EB)	SALT CREEK			1									X	
020-0037	I-74(WB)	SALT CREEK			1									X	
020-0048	US 51 (SB)(FAP 322)	LONG POINT CREEK			1									X	
020-0049	US 51 (NB)(FAP 322)	LONG POINT CREEK			1									X	
020-0050	US 51 (SB)(FAP 322)	TEN MILE CREEK			1										X
020-0051	US 51 (NB)(FAP 322)	TEN MILE CREEK			INCL.					2 - CMS ON US 51 NB & SB;					X
020-0052	US 51 (NB)(FAP 322)	TEN MILE CREEK			INCL.				D1	4 - 701426 SPECIAL;	DUAL DISPLAY;	2	2 HRS PER LOC.		X
020-0053	US 51 (SB)(FAP 322)	TEN MILE CREEK			INCL.					11 SN	7 CAL. DAYS PRIOR;				X
020-0055	US 51 (SB)(FAP 322)	COON CREEK			INCL.						TOTAL 28 CAL. DAYS				X
020-0056	US 51 (NB)(FAP 322)	COON CREEK			INCL.										X
020-0005	US 51 (SB)(FAP 322)	SALT CREEK			INCL.									X	
020-0057	US 51 (NB)(FAP 322)	SALT CREEK			1									X	
020-2006	US 51 (NB)(FAP 322)	TEN MILE CREEK			INCL.										X
020-0054	US 51 BUSN(FAP 708)	COON CREEK	2												X
020-0062	IL 10 (FAP 721)	SALT CREEK	2						D3	8-701201; 1WD; 4SN		1	2 HRS PER LOC.	X	
020-2010	IL 10 (FAP 721)	FRIENDS CREEK DITCH	2											X	
020-2014	IL 54 (FAP 71)	COON CREEK	2											X	
TC&P SET-UPS & CMS CALENDAR DAYS			20	2	8	0	0	1			56	7			
WORKING DAYS PER STANDARD			3		4						USE AT RE'S DIRECTION				

MODEL: \\MODEL\MARIS
 FILE: \\MARIS_Plan\p10m\comad\data\illinois\p10m\DOT\Documents\DOT_Offices\Illinet\Projects\0570E78\CADD\Drawings\Hydraulics\0570E78-tpb-schedule.dgn

USER NAME = brandenburgj	DESIGNED - TJB	REVISED - _____
	DRAWN - _____	REVISED - _____
PLOT SCALE = 40,0000 ' / in.	CHECKED - _____	REVISED - _____
PLOT DATE = 11/6/2020	DATE - 5/4/2020	REVISED - _____

**STATE OF ILLINOIS
DEPARTMENT OF TRANSPORTATION**

DEWITT COUNTY SCHEDULE OF QUANTITIES			
SCALE: _____	SHEET 5	OF 8 SHEETS	STA. _____ TO STA. _____

F.A. RTE.	SECTION	COUNTY	TOTAL SHEETS	SHEET NO.
VAR.	FY21 BRIDGE DECK SEALING	VARIOUS	22	18
			CONTRACT NO. 70E78	
		ILLINOIS	FED. AID PROJECT	

PIATT COUNTY STRUCTURES SCHEDULE OF QUANTITIES																	
TRAFFIC CONTROL & PROTECTION																	
PROSECUTION & PROGRESS																	
SN	ROUTE CARRIED	FEATURE CROSSED	701201	701411 (DL ONLY)	701426 SPECIAL	701427 SPECIAL	701446	D5 DETAIL 70200000 ROAD CLOSURE	LOCATION	SUMMARY	CHANGEABLE MESSAGE SIGN (Calendar Days)	WORKING DAYS	PROSECUTION	RURAL	URBAN		
074-0001	I-72 (EB)	IC RR			2				P3			1	2 HRS PER LOC.	X			
074-0002	I-72 (WB)	IC RR			2					2 - CMS ON FAI 72 EB & WB;					X		
074-0063	I-72 (EB)	WILDCAT CREEK			2					12-701426 SPECIAL;	DUAL DISPLAY;					X	
074-0064	I-72 (WB)	WILDCAT CREEK			2					1WD;	7 CAL. DAYS PRIOR;					X	
074-0067	I-72 (EB)	SANGAMON RIVER			2					6 SN	TOTAL 28 CAL. DAYS						X
074-0068	I-72 (WB)	SANGAMON RIVER			2												X
074-0003	IL 10 (FAP 721)	GOOSE CREEK	2						P4	8-701201; 1WD; 4SN		1	2 HRS PER LOC.	X			
074-0005	IL 10 (FAP 721)	MADDEN CREEK	2											X			
074-0007	IL 10 (FAP 721)	I-72	2											X			
074-0076	IL 10(FAP 721)	SANGAMON RIVER	2											X			
074-0013	IL 48(FAP 760)	CREEK	2						P5	8-701201; 1WD; 6SN		1	2 HRS PER LOC.	X			
074-0015	IL 48(FAP 760)	CREEK	INCL.											X			
074-0016	IL 48(FAP 760)	CREEK	2											X			
074-0055	IL 48 (FAP 760)	I-72	2											X			
074-0081	IL 48(FAP 760)	STREAM	2											X			
074-0082	IL 48(FAP 760)	FRIENDS CREEK DITCH	INCL.											X			
074-0021	FAS 538(BRIDGE ST)	SANGAMON RIVER	2						P6	4-701201; 1WD; 3SN 1-ROAD CLOSURE		1	2 HRS PER LOC.		X		
074-0030	IL 105(FAP 741)	CREEK	2											X			
074-0035	TR 87	I-72						1						X			
074-0036	FAS 1532 (TR 154)	I-72	-	-	-			0									
074-0037	I-74(EB)	S BRANCH SALT CREEK		1	1				P1	2-701411; 2-701426 SPECIAL; 4 SN	INCL. W/ D4	1	2 HRS PER LOC.	X			
074-0038	I-74(WB)	S BRANCH SALT CREEK			INCL.									X			
074-0042	I-74(EB)	NSRR & MADDEN CREEK			INCL.									X			
074-0043	I-74(WB)	NSRR & MADDEN CREEK		1	1									X			
074-0084	FAS 1517(US 150)	MADDEN CREEK	2						P2	8-701201; 1WD; 6SN 2-ROAD CLOSURE		1	2 HRS PER LOC.	X			
074-0086	US 150 (FAS 1517)	N & W RR	2											X			
074-0087	FAS 1517 (US 150)	S BRANCH SALT CREEK	2											X			
074-0040	TR 80	I-74						1						X			
074-0041	TR 96	I-74						1						X			
074-0044	FAS 495	I-74	2											X			
074-0079	IL 105(FAP 741)	CREEK	2						P7	8-701201; 1WD; 4SN		1	2 HRS PER LOC.	X			
074-0080	IL 105(FAP 741)	STREAM	2											X			
074-2003	FAP 758(IL 32)	STREAM	2											X			
074-3171	FAP 760 (CH 17)	SANGAMON RIVER	2											X			
TC&P SET-UPS & CMS CALENDAR DAYS			36	2	14			3			28	7					
WORKING DAYS PER STANDARD			5		2						USE AT RE'S DIRECTION						

MODEL: \\MODEL\MARIS
 FILE: \\MARIS_P:\pub\mcom\mdata\links\gov\PIATT\DOT\Documents\DOT_Offices\I\I\dot\5\Projects\0570E7B\CADD\Bridges\Hydraulics\0570E7B\sh-schedule.dgn

USER NAME = brandenburgj	DESIGNED - TJB	REVISED - _____
	DRAWN - _____	REVISED - _____
PLOT SCALE = 40.0000' / in.	CHECKED - _____	REVISED - _____
PLOT DATE = 11/6/2020	DATE - 6/21/2019	REVISED - _____

**STATE OF ILLINOIS
DEPARTMENT OF TRANSPORTATION**

PIATT COUNTY SCHEDULE OF QUANTITIES			
SCALE: _____	SHEET 6	OF 8 SHEETS	STA. _____ TO STA. _____

F.A. RTE.	SECTION	COUNTY	TOTAL SHEETS	SHEET NO.
VAR.	FY21 BRIDGE DECK SEALING	VARIOUS	22	19
			CONTRACT NO. 70E78	
		ILLINOIS	FED. AID PROJECT	

