

F.A.P. RTE.	SECTION	COUNTY	TOTAL SHEETS	SHEET NO.
373	0707-608 HB-I-4	COOK	40	12
STA.		TO STA.		
FED. ROAD DIST. NO.		ILLINOIS	FED. AID PROJECT	

CONTRACT NO. 60C94

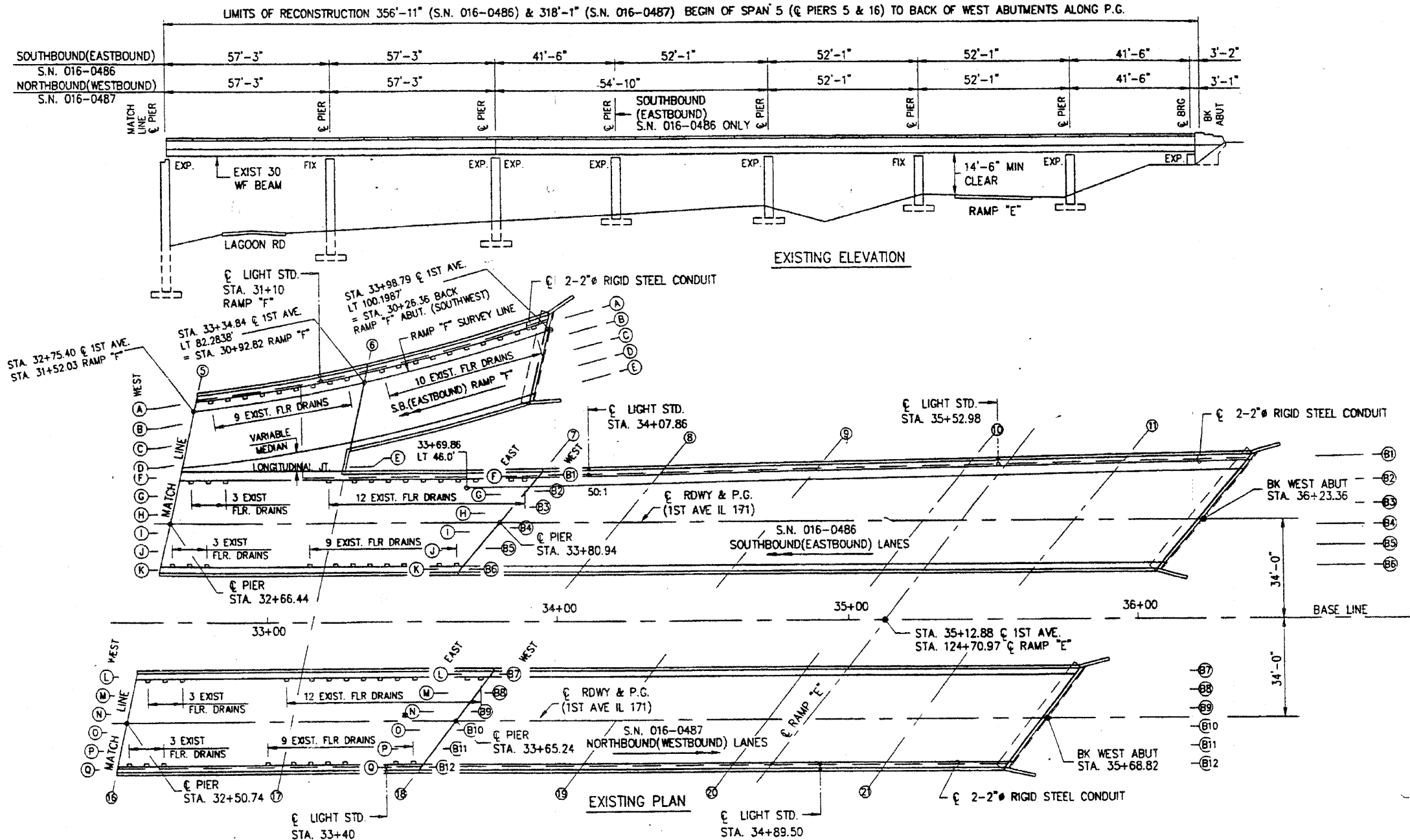
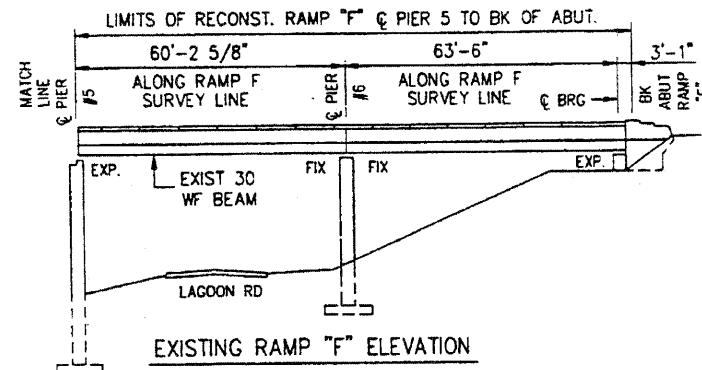

NOTE (A) S.N. 016-0486 S.B.(EASTBOUND) LANES

- VARIABLE MEDIAN LONGITUDINAL JT.
- VARIES AS FOLLOWS
- 27'-4"± AT EAST ABUTMENT
- 29'-5"± AT PIER 2
- 38'-9 5/8"± AT PIER 5 (EAST) RAMP "F" APPROACH
- 12'-0" AT PIER 5 (WEST)
- 12'-0" AT STA. 33+69.86
- 12'-6"± AT PIER 7
- 17'-5"± AT WEST ABUTMENT

NOTE (B) S.N. 016-0487 N.B.(WESTBOUND) LANES

- VARIES FROM 14'-7"± AT BK OF EAST ABUT. TO 12'-0" AT STA. 28+27.07 AND REMAINS 12'-0" TO THE BK OF WEST ABUT.

**FOR INFORMATION ONLY**

REVISIONS	
NAME	DATE

ILLINOIS DEPARTMENT OF TRANSPORTATION  
GENERAL PLAN & ELEVATION  
1ST AVE. (IL. RTE. 171)  
OVER  
F.A.I. I-55  
F.A.P. RTE. 373 SECTION: 0707-608 HB-I-4  
COOK COUNTY STATION 41+24.08  
S.N. 016-0486 & S.N. 016-0487  
SCALE: NONE DRAWN BY: D.L./F.M.  
DATE: DECEMBER 8, 2008 CHECKED BY: B.N.S./J.C.N.  
**CHRISTIAN-ROGE & ASSOC., INC.**  
CHICAGO ILLINOIS