

F.A.P. RTE.	SECTION	COUNTY	TOTAL SHEETS	SHEET NO.
373	0707-608 HB-I-4	COOK	40	16
STA.	TO STA.			
FED. ROAD DIST. NO.	ILLINOIS	FED. AID PROJECT		

CONTRACT NO. 60C94

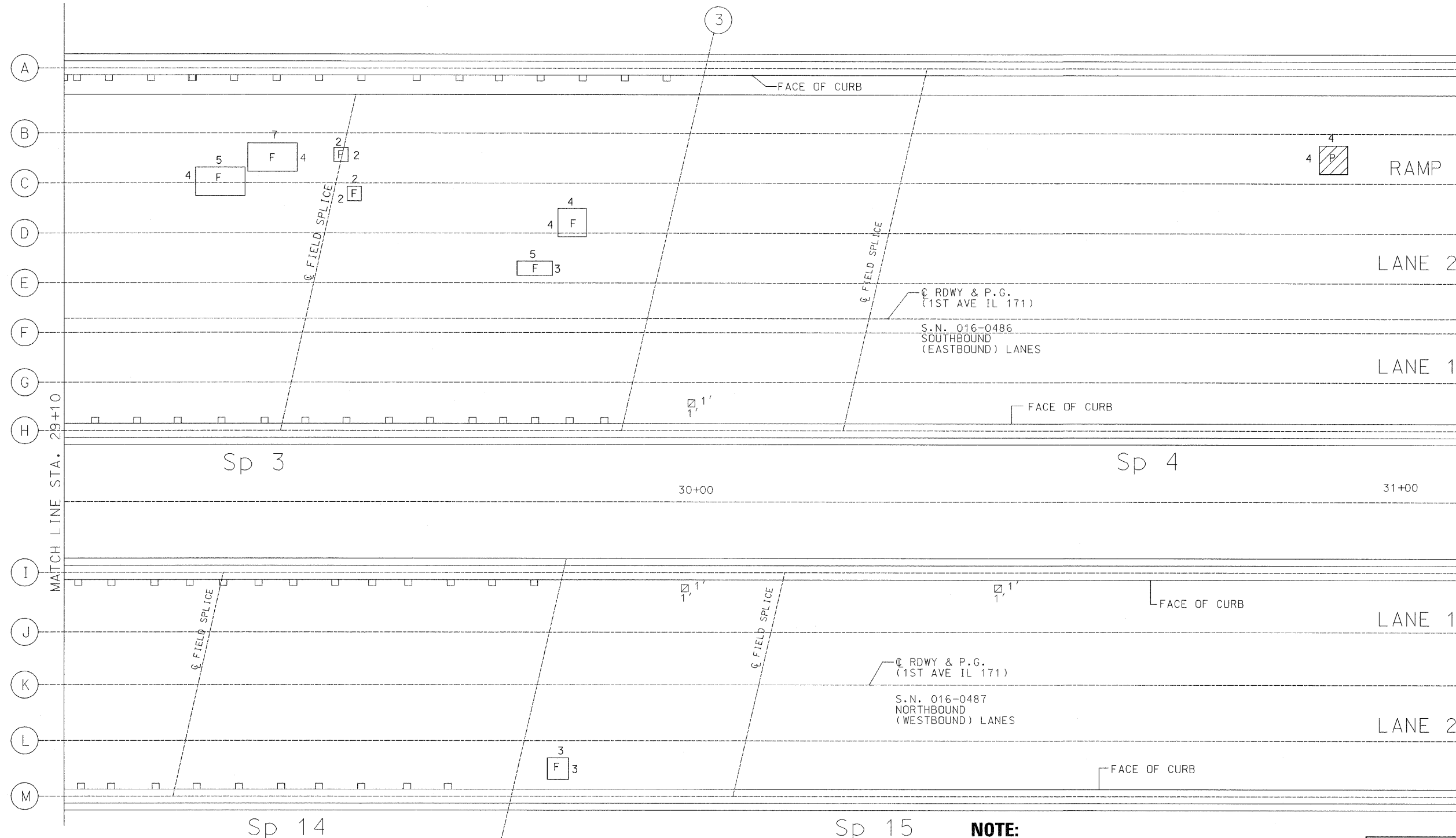
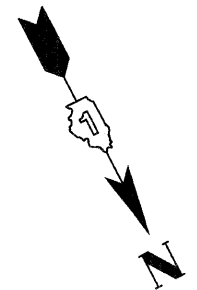

S.N. 016-0486

S.N. 016-0487

SUPERSTRUCTURE REPAIR PLAN

NOTE:
 SPANS 4 & 15 PARTIAL DEPTH PATCHING ARE ON THIS PLAN AND LISTED IN THE TABLES ON SHT. NO. 15. FOR REMAINDER OF AREAS AT SPANS 4 & 15 AND SPANS 5 & 16, NO PATCHING IS SHOWN IN THE TABLES AND ARE OMITTED. TABLES SHOWING THE PATCHES WERE RECEIVED FROM I.D.O.T. FIELD MAINTENANCE ENGINEER.

- LEGEND:**
- (F) FD = FULL DEPTH
 - (P) PD = PARTIAL DEPTH

REVISIONS	
NAME	DATE

ILLINOIS DEPARTMENT OF TRANSPORTATION

DECK CONCRETE PATCHING
 1ST AVE. (IL. RTE. 171) OVER
 F.A.I. I-55

F.A.P. RTE. 373 SECTION: 0707-608 HB-I-4
 COOK COUNTY STATION 41+24.08
 S.N. 016-0486 & S.N. 016-0487

SCALE: NONE DRAWN BY: D.L./F.M.
 DATE: DECEMBER 8, 2008 CHECKED BY: B.N.S./J.C.N.

CHRISTIAN-ROGE & ASSOC., INC.
 CHICAGO ILLINOIS