

**TYPICAL ENTRANCE/EXIT RAMP COMBINATION PAVEMENT MARKINGS**

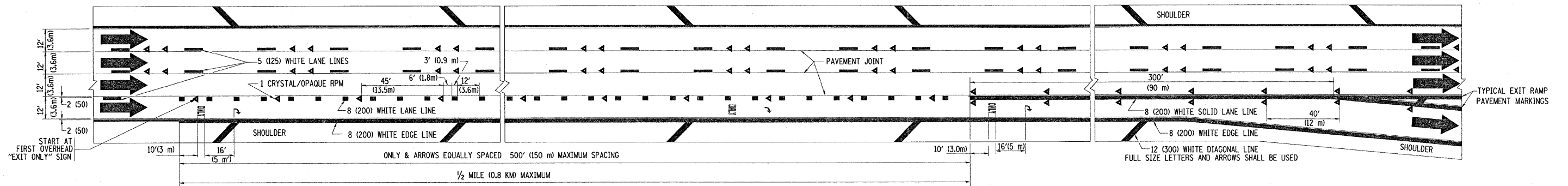

**TYPICAL EXIT ONLY LANE PAVEMENT MARKINGS**

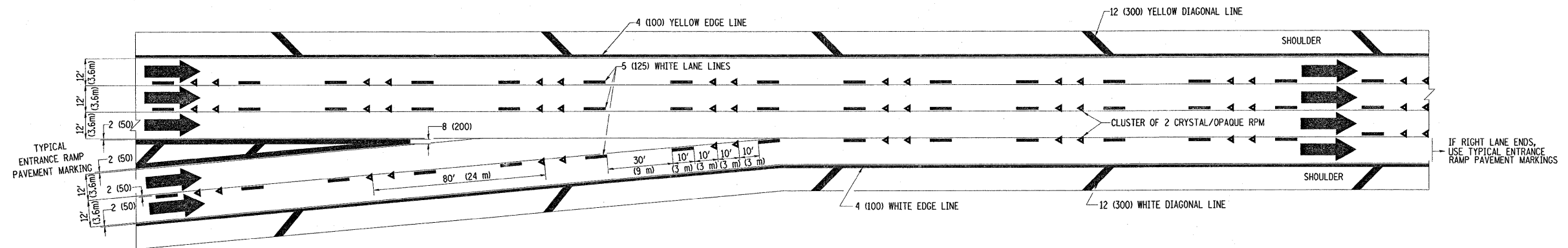

**TYPICAL TWO LANE ENTRANCE RAMP PAVEMENT MARKINGS**

FILE NAME = c:\pwork\VPWIDOT\GALBANNB\dms89502\01-01.dgn	USER NAME = galbannb	DESIGNED - D.W.S.	REVISED - A.H. 03-96	<b>STATE OF ILLINOIS DEPARTMENT OF TRANSPORTATION</b>	<b>MULTI-LANE FREEWAY PAVEMENT MARKING DETAILS</b>		F.A.I. RTE. 290	SECTION 2008-055 1	COUNTY COOK	TOTAL SHEETS 55	SHEET NO. 50
	PLOT SCALE = 50.0000' / 1"	CHECKED -	REVISED - J.A.F. 02-06				SCALE: NONE	SHEET NO. 2 OF 2 SHEETS	STA. TO STA.	FED. ROAD DIST. NO. 1 ILLINOIS FED. AID PROJECT	CONTRACT NO. 60F10
	PLOT DATE = 12/18/2008	DATE - 01-90	REVISED - S.P.B. 01-07				REVISED - D.W.S. 07-96	TC-12			