

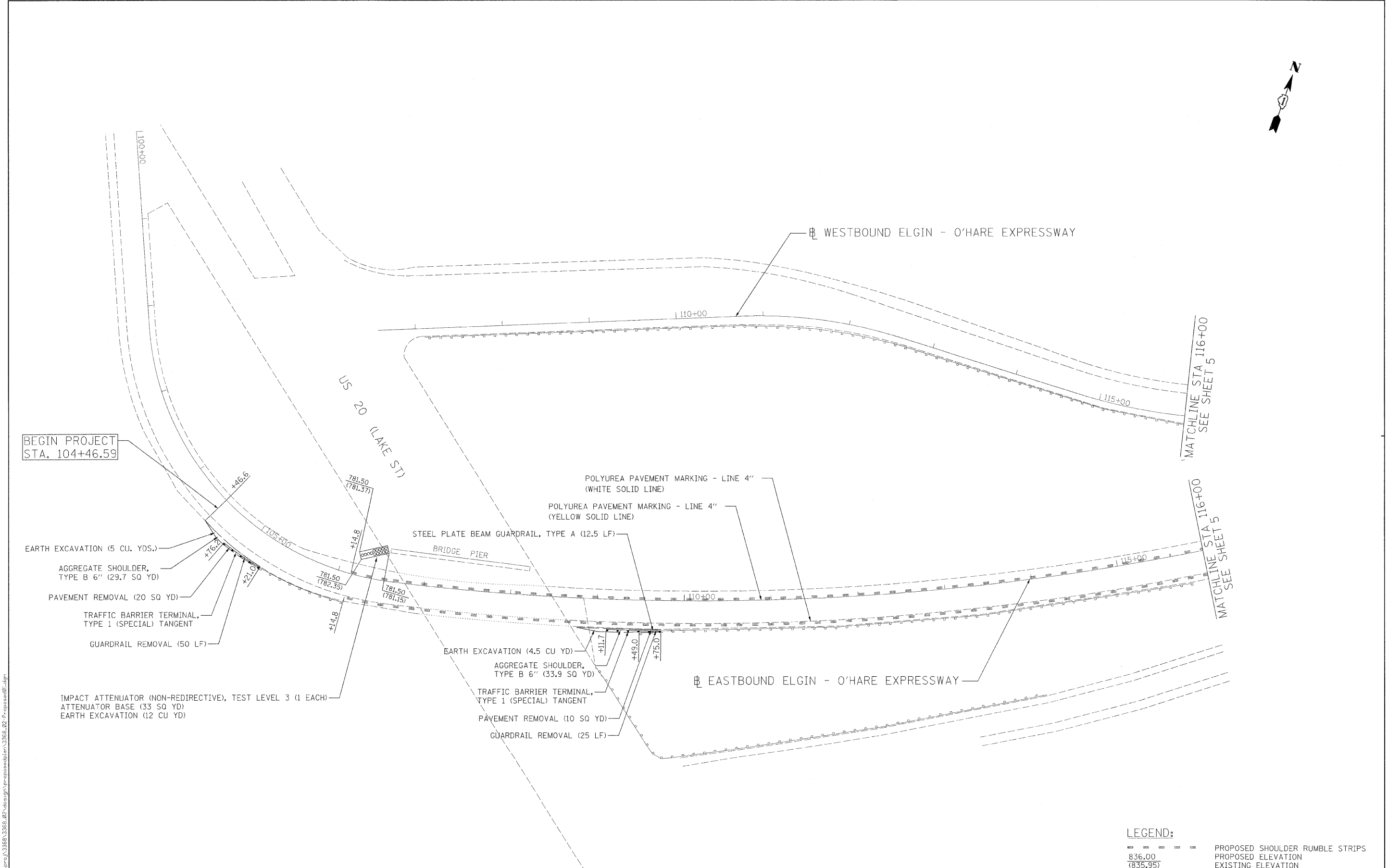

PLAN	DATE
BY	
REVISIONS	
NO.	DESCRIPTION
1	AS SHOWN

PROFILE	DATE
BY	
REVISIONS	
NO.	DESCRIPTION
1	AS SHOWN



BEGIN PROJECT STA. 104+46.59

- EARTH EXCAVATION (5 CU. YDS.)
- AGGREGATE SHOULDER, TYPE B 6" (29.7 SQ YD)
- PAVEMENT REMOVAL (20 SQ YD)
- TRAFFIC BARRIER TERMINAL, TYPE 1 (SPECIAL) TANGENT
- GUARDRAIL REMOVAL (50 LF)
- IMPACT ATTENUATOR (NON-REDIRECTIVE), TEST LEVEL 3 (1 EACH)
- ATTENUATOR BASE (33 SQ YD)
- EARTH EXCAVATION (12 CU YD)

- EARTH EXCAVATION (4.5 CU YD)
- AGGREGATE SHOULDER, TYPE B 6" (33.9 SQ YD)
- TRAFFIC BARRIER TERMINAL, TYPE 1 (SPECIAL) TANGENT
- PAVEMENT REMOVAL (10 SQ YD)
- GUARDRAIL REMOVAL (25 LF)

POLYUREA PAVEMENT MARKING - LINE 4" (WHITE SOLID LINE)
 POLYUREA PAVEMENT MARKING - LINE 4" (YELLOW SOLID LINE)

LEGEND:

--- --- ---	PROPOSED SHOULDER RUMBLE STRIPS
836.00	PROPOSED ELEVATION
(835.95)	EXISTING ELEVATION

FILE NAME: s:\proj\33668\33668.dwg; P:\proj\33668\33668.dwg; P:\proj\33668\33668.dwg

Ciorba Group, Inc.
 CONSULTING ENGINEERS
 5507 North Cumberland Avenue, Suite 402
 Chicago, Illinois 60656
 Tel. 773.775.4008 Fax 773.775.4014

USER NAME = mready	DESIGNED - NT	REVISED -
PLOT SCALE = 50.0000' / IN.	DRAWN - NT	REVISED -
PLOT DATE = 12/23/2008	CHECKED - WBL	REVISED -
	DATE - 12/23/2008	REVISED -

**STATE OF ILLINOIS
 DEPARTMENT OF TRANSPORTATION**

**FAP 345 / ELGIN O'HARE EXPRESSWAY
 US 20 (LAKE ST.) TO I-290
 ROADWAY PLAN**

F.A.P. RTE. 345	SECTION 2008-076 I	COUNTY COOK/DUPAGE	TOTAL SHEETS 19	SHEET NO. 4
SCALE: SHEET NO. OF SHEETS STA. TO STA.		CONTRACT NO. 60F77		
FED. ROAD DIST. NO. ILLINOIS FED. AID PROJECT				