

F.A.P. RTE.	SECTION	COUNTY	TOTAL SHEETS	SHEET NO.
333	2002-101N	LAKE	75	24
STA.		TO STA.		
FED. ROAD DIST. NO.		ILLINOIS FED. AID PROJECT		

PROJECT BEGINS  
STATION 123+96.9

IL ROUTE 120 (STA. 127+99) =  
BACON ROAD (STA. 513+99)

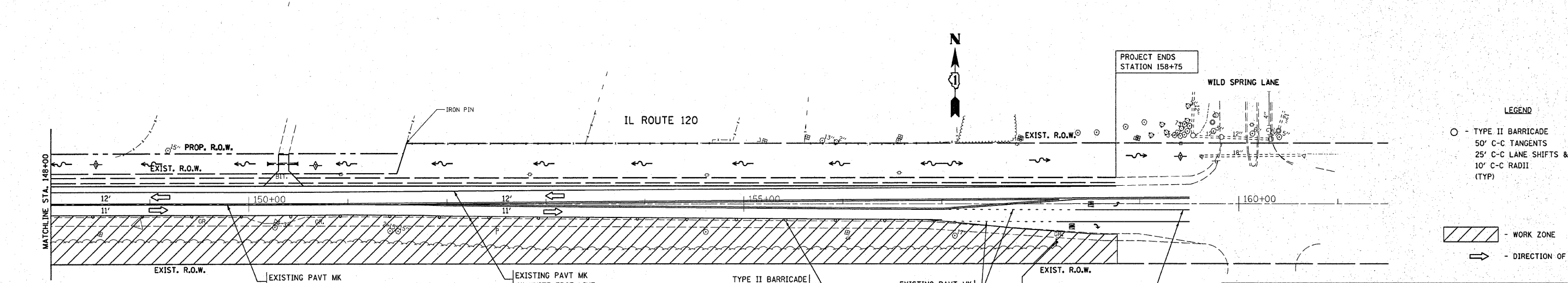
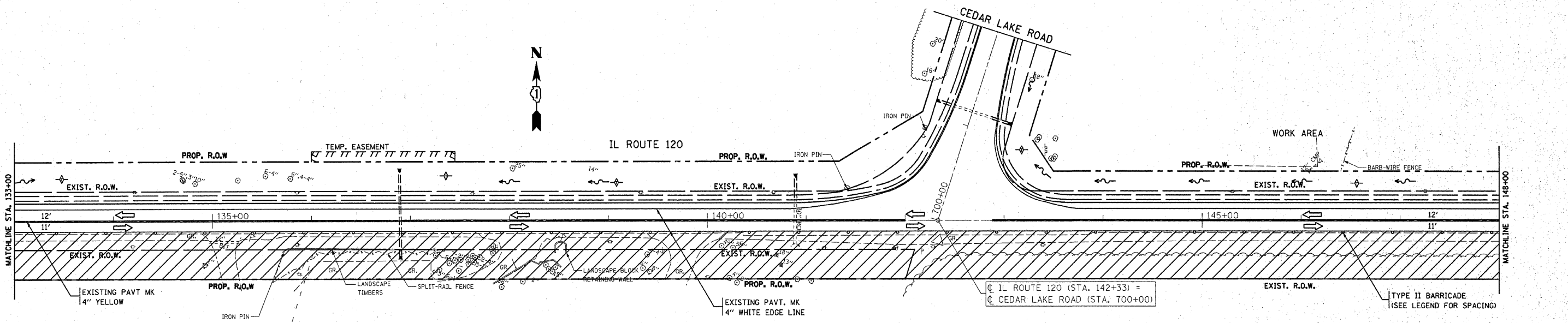
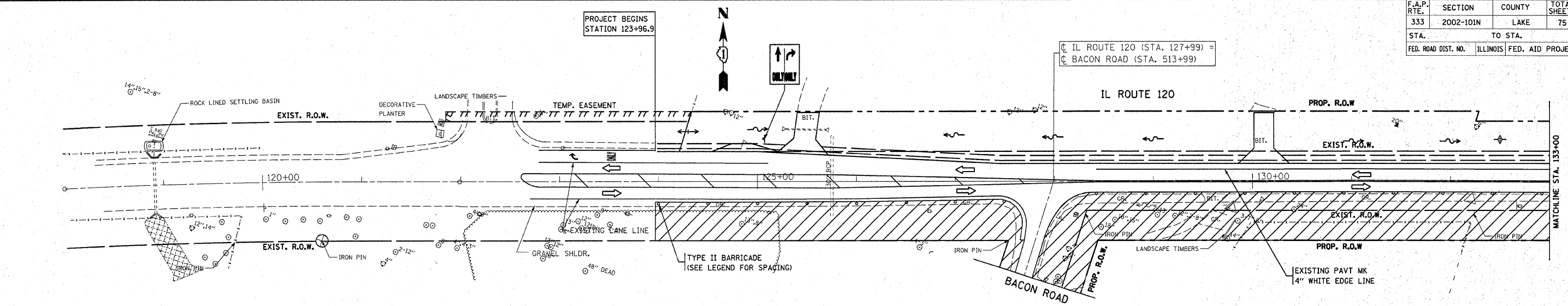

- LEGEND**
- - TYPE II BARRICADE
  - - 50' C-C TANGENTS
  - - 25' C-C LANE SHIFTS & TAPERS
  - - 10' C-C RADII (TYP)

- WORK ZONE
- DIRECTION OF TRAFFIC

REVISIONS	
NAME	DATE

ILLINOIS DEPARTMENT OF TRANSPORTATION  
**SUGGESTED STAGING AND TRAFFIC CONTROL**  
(MAINLINE-IL 120)  
STAGE II

SCALE: VERT. \_\_\_\_\_  
HORIZ. \_\_\_\_\_  
DATE \_\_\_\_\_

DRAWN BY \_\_\_\_\_  
CHECKED BY \_\_\_\_\_