

DATE	
BY	
SURVEYED	
ALIGNED	
CHECKED	
NO. OF WAYS CHECKED	
JOB FILE NAME	

DATE	
BY	
SURVEYED	
GRADES CHECKED	
B.M. NOTED	
STRUCTURE NOTATIONS OK'D	

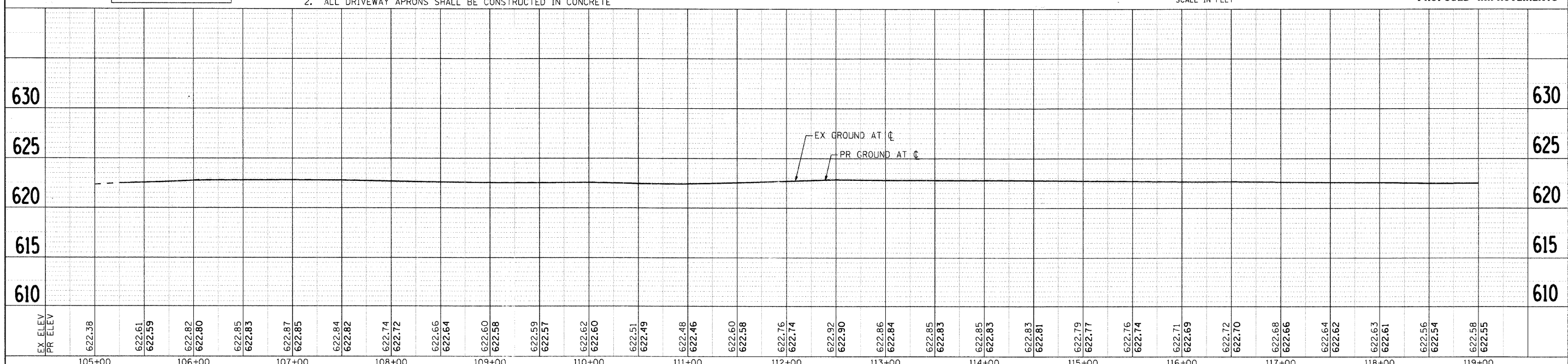
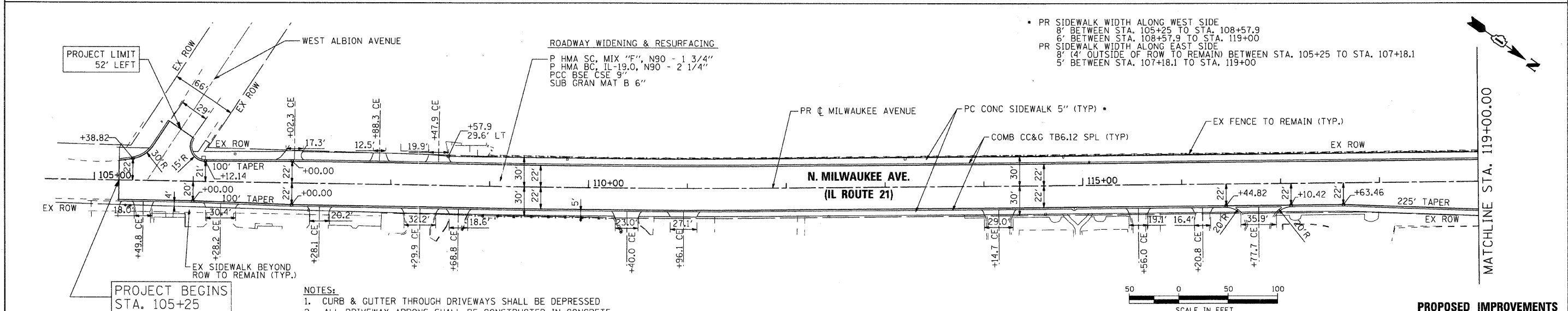
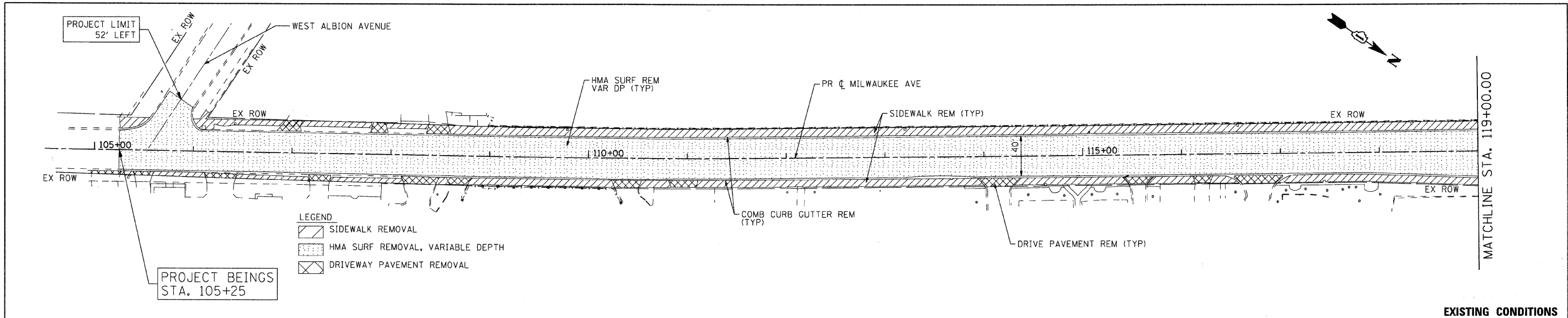

EX ELEV	PR ELEV	105+00	106+00	107+00	108+00	109+00	110+00	111+00	112+00	113+00	114+00	115+00	116+00	117+00	118+00	119+00
622.38	622.61	622.59	622.82	622.80	622.85	622.83	622.87	622.85	622.84	622.82	622.74	622.72	622.66	622.64	622.56	622.54
622.57	622.55	622.53	622.51	622.49	622.48	622.46	622.60	622.58	622.76	622.74	622.92	622.90	622.86	622.84	622.83	622.81
622.79	622.77	622.76	622.74	622.71	622.69	622.72	622.70	622.68	622.66	622.64	622.62	622.63	622.61	622.56	622.54	622.52

SEC Group, Inc.
 Engineering
 Surveying
 Planning
 Landscape Architecture
 McHenry • Yorkville • New Lenox • Chicago
 www.secgroup.com

USER NAME = charlke	DESIGNED - JPA	REVISED
	DRAWN - JPA	REVISED
PLOT SCALE = 1" = 50'	CHECKED - JLP	REVISED
PLOT DATE = 12/22/2008	DATE - 12/16/08	REVISED

VILLAGE OF NILES

**ROADWAY PLAN AND PROFILE
 N. MILWAUKEE AVE (IL ROUTE 21)**
 SCALE: 1" = 50' SHEET NO. 1 OF 6 SHEETS STA. BEGIN TO STA. 119+00

F.A.U. RTE.	SECTION	COUNTY	TOTAL SHEETS	SHEET NO.
3513	08-00107-00-PV	COOK	169	14
CONTRACT NO. 00000000			FED. ROAD DIST. NO. ILLINOIS FED. AID PROJECT M-80031723	