

INSTALLATION NOTES

PAVERS SHALL BE INSTALLED ON TOP OF THE SAND LAYER, LAYING ALL FULL STONES POSSIBLE FIRST. SMALL CUT PLACES WILL THEN BE INSTALLED.

CONTRACTOR SHALL COMPACT PAVING STONES INTO THE SAND LAYER WITH A MECHANICAL PLATE COMPACTOR WITH A FORCE OF 2500-3500 LBS.

POLYMERIC SAND IS THEN SWEEPED INTO THE JOINTS AND VIBRATED UNTIL THE JOINT ARE FULL.

THE PAVERS SHALL BE PLACED ACCORDING TO MANUFACTURER SPECIFICATIONS AND INTERLOCKING CONCRETE PAVEMENT INSTITUTE SPECIFICATIONS.

THE PAVERS SHALL BE ARRANGED IN A HERRINGBONE PATTERN

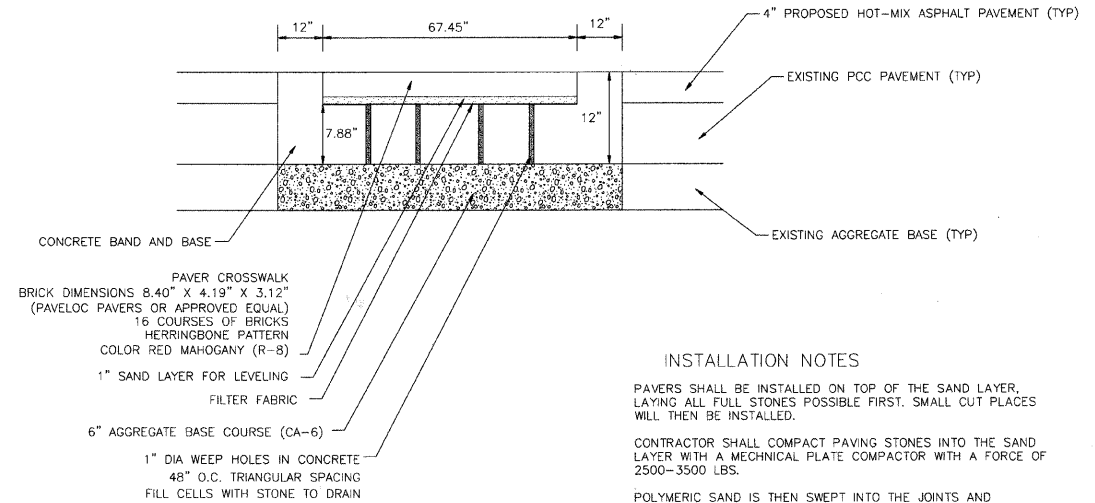

INSTALLATION NOTES

PAVERS SHALL BE INSTALLED ON TOP OF THE SAND LAYER, LAYING ALL FULL STONES POSSIBLE FIRST. SMALL CUT PLACES WILL THEN BE INSTALLED.

CONTRACTOR SHALL COMPACT PAVING STONES INTO THE SAND LAYER WITH A MECHANICAL PLATE COMPACTOR WITH A FORCE OF 2500-3500 LBS.

POLYMERIC SAND IS THEN SWEEPED INTO THE JOINTS AND VIBRATED UNTIL THE JOINT ARE FULL.

THE PAVERS SHALL BE PLACED ACCORDING TO MANUFACTURER SPECIFICATIONS AND INTERLOCKING CONCRETE PAVEMENT INSTITUTE SPECIFICATIONS.

THE PAVERS SHALL BE ARRANGED IN A HERRINGBONE PATTERN

BRICK PAVER ACCENT STRIP

N.T.S.

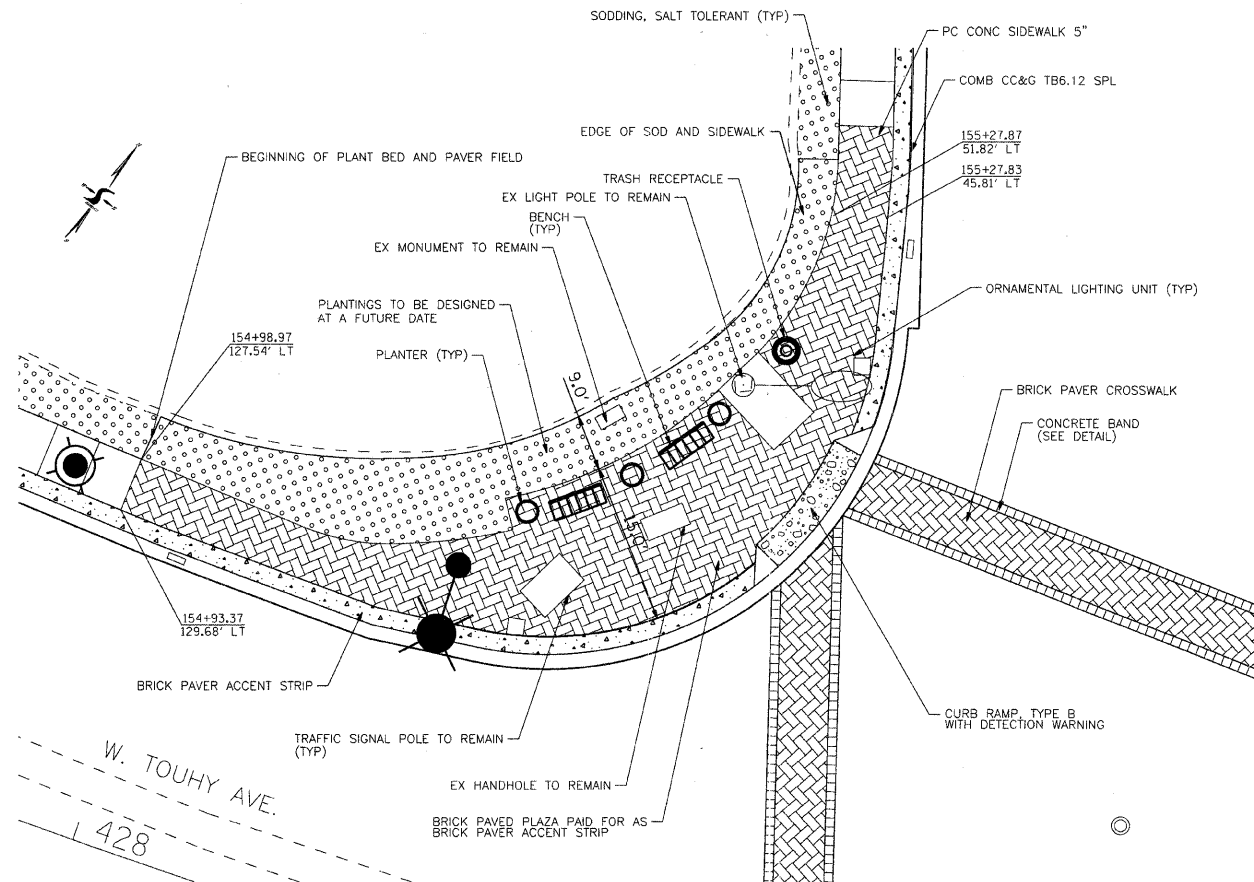

DETAIL "A"

1" = 10'

BRICK PAVER CROSSWALK (HARTS RD.)

N.T.S.

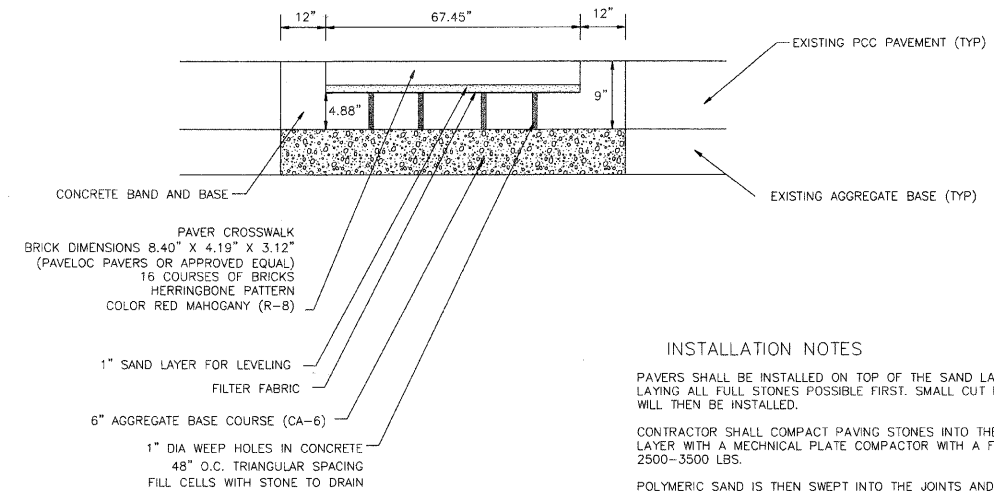

INSTALLATION NOTES

PAVERS SHALL BE INSTALLED ON TOP OF THE SAND LAYER, LAYING ALL FULL STONES POSSIBLE FIRST. SMALL CUT PLACES WILL THEN BE INSTALLED.

CONTRACTOR SHALL COMPACT PAVING STONES INTO THE SAND LAYER WITH A MECHANICAL PLATE COMPACTOR WITH A FORCE OF 2500-3500 LBS.

POLYMERIC SAND IS THEN SWEEPED INTO THE JOINTS AND VIBRATED UNTIL THE JOINT ARE FULL.

THE PAVERS SHALL BE PLACED ACCORDING TO THE PAVELOC AND INTERLOCKING CONCRETE PAVEMENT INSTITUTE SPECIFICATIONS.

THE PAVERS SHALL BE ARRANGED IN A HERRINGBONE PATTERN

BRICK PAVER CROSSWALK (WAUKEGAN RD. AND TOUHY AVE.)

N.T.S.



USER NAME = char-ke	DESIGNED - MAC	REVISED -
PLOT SCALE = 1" = 20'	DRAWN - CMH	REVISED -
PLOT DATE = 1/6/2009	CHECKED - CMH	REVISED -
	DATE - 12/16/08	REVISED -

VILLAGE OF NILES

LANDSCAPE PLAN - DETAILS

SCALE: 1" = 20' SHEET NO. 4 OF 7 SHEETS STA. TO STA.

F.A.U. RTE. 3513	SECTION 08-00107-00-PV	COUNTY COOK	TOTAL SHEETS 169	SHEET NO. 55
FED. ROAD DIST. NO. ILLINOIS		FED. AID PROJECT M-8003(723)	CONTRACT NO. 08-00107-00-PV	