

NOTES FOR TEMPORARY TRAFFIC SIGNALS

- ALL CONTROL EQUIPMENT INCLUDING EMERGENCY PRE-EMPTION AND COMMUNICATION DEVICES FOR THE TEMPORARY TRAFFIC SIGNAL(S) SHALL BE FURNISHED BY THE CONTRACTOR.
- ONLY CONTROLLERS SUPPLIED BY ONE OF THE DISTRICT APPROVED CLOSED LOOP EQUIPMENT MANUFACTURERS WILL BE APPROVED FOR USE AT TEMPORARY SIGNAL LOCATIONS. ALL CONTROLLERS USED FOR TEMPORARY TRAFFIC SIGNALS SHALL BE FULLY ACTUATED NEMA MICROPROCESSOR BASED WITH RS232 DATA ENTRY PORTS COMPATIBLE WITH EXISTING MONITORING SOFTWARE APPROVED BY IDOT DISTRICT 1, INSTALLED IN A NEMA TS1 OR TS2 CABINET. ONLY ONE BRAND OF CONTROLLER WILL BE ACCEPTED FOR ANY ONE CONTRACT.
- ALL TRAFFIC SIGNAL SECTIONS AND PEDESTRIAN SIGNAL SECTIONS SHALL BE 12". HEADS SHALL BE PLACED AS INDICATED ON THE TEMPORARY TRAFFIC SIGNAL PLAN OR AS DIRECTED BY THE ENGINEER. THE CONTRACTOR SHALL FURNISH ENOUGH CABLE SLACK TO RELOCATE HEADS TO ANY POSITION ON THE SPAN WIRE OR AT LOCATIONS ILLUSTRATED ON THE PLANS FOR CONSTRUCTION STAGING. THE TEMPORARY TRAFFIC SIGNAL SHALL REMAIN IN OPERATION DURING ALL SIGNAL HEAD RELOCATIONS. EACH TEMPORARY TRAFFIC SIGNAL HEAD SHALL HAVE ITS OWN CABLE FROM THE CONTROLLER CABINET TO THE SIGNAL HEAD.
- ANY TEMPORARY SIGNAL WITHIN AN EXISTING CLOSED LOOP TRAFFIC SIGNAL SYSTEM SHALL BE INTERCONNECTED TO THAT SYSTEM USING SIMILAR BRAND CONTROL EQUIPMENT.
- THE TEMPORARY TRAFFIC SIGNAL SHALL HAVE THE SIGNAL HEAD DISPLAYS, SIGNAL HEAD PLACEMENTS AND CONTROLLER PHASING MATCH THE EXISTING TRAFFIC SIGNAL AT THE TIME OF THE TURN ON. IF NO TRAFFIC STAGING IS IN PLACE OR WILL NOT BE STAGED ON THE DAY OF THE TURN ON.
- ALL EXISTING STREET NAME AND INTERSECTION REGULATORY SIGNS SHALL BE REMOVED FROM EXISTING POLES, RELOCATED AND SECURELY FASTENED TO THE SIGNAL SPAN WIRE OR WOOD POLE AS DIRECTED BY THE ENGINEER.
- THE TRAFFIC SIGNAL CONTROL EQUIPMENT FOR THIS PROJECT SHALL BE "ECONOLITE" TO MATCH THE EXISTING ADJACENT SYSTEM.
- ALL LABOR AND MATERIALS NECESSARY TO COMPLY WITH THESE REQUIREMENTS SHALL BE CONSIDERED INCLUDED IN THE CONTRACT UNIT PRICE EACH FOR TEMPORARY TRAFFIC SIGNAL INSTALLATION.
- FINAL CAMERA POSITION TO BE DETERMINED BY THE CONTRACTOR'S CAMERA REPRESENTATIVE TO ENSURE CORRECT ZONE COVERAGE, INCLUDING FAR-OUT DETECTION.
- EXISTING TRAFFIC SIGNAL CONTROLLER AND FOUNDATION TO BE REMOVED. EXISTING LIGHT DETECTOR AMPLIFIER, INDUCTIVE LOOP DETECTORS AND ALL OTHER CONTROLEQUIPMENT TO BE RE-USED FOR PERMANENT INSTALLATION.

EXISTING EQUIPMENT TO BE REMOVED LEGEND

- ◁ EXISTING SIGNAL HEAD TO BE REMOVED
- "E" ■ EXISTING SERVICE INSTALLATION TO BE REMOVED
- EXISTING SIGNAL POST AND FOUNDATION TO BE REMOVED
- "E" ⊠ EXISTING CONTROLLER AND FOUNDATION TO BE REMOVED
- "E" □ EXISTING HANDHOLE TO BE REMOVED
- "E" ⊞ EXISTING HEAVY-DUTY HANDHOLE TO BE REMOVED
- EXISTING ALUMINUM MAST ARM POLE AND FOUNDATION TO BE REMOVED
- EXISTING STEEL MAST ARM POLE AND FOUNDATION TO BE REMOVED
- ⊞ EXISTING PEDESTRIAN SIGNAL HEAD TO BE REMOVED
- ⊙ EXISTING PEDESTRIAN PUSH BUTTON TO BE REMOVED
- ▷ EXISTING EMERGENCY VEHICLE LIGHT DETECTOR TO BE REMOVED
- ▷ EXISTING CONFIRMATION BEACON TO BE REMOVED

THE FOLLOWING ITEMS SHALL BE REMOVED BY THE CONTRACTOR AND SHALL BE DISPOSED OF BY THEM OUTSIDE THE RIGHT-OF-WAY AT THEIR OWN EXPENSE. THE SALVAGE VALUE OF THE REMOVED EQUIPMENT SHALL BE REFLECTED IN THE CONTRACT BID PRICE.

- 2 EACH STEEL MAST ARM ASSEMBLY AND POLE
- 7 EACH SIGNAL HEAD, 1-FACE, 3 SECTION
- 1 EACH SIGNAL HEAD, 2-FACE, 2-3 SECTION
- 4 EACH TRAFFIC SIGNAL BACKPLATES
- 2 EACH PEDESTRIAN SIGNAL HEAD, 1-FACE
- 2 EACH PEDESTRIAN SIGNAL HEAD, 2-FACE
- 4 EACH PEDESTRIAN PUSHBUTTON
- 4 EACH SIGNAL POST
- 3 EACH CONFIRMATION BEACON
- 3 EACH EMERGENCY VEHICLE LIGHT DETECTOR
- 1 EACH CONTROLLER AND CABINET

NOTE:

FINAL CAMERA POSITION TO BE DETERMINED BY THE CONTRACTOR'S CAMERA REPRESENTATIVE TO INSURE CORRECT ZONE COVERAGE, INCLUDING FAR-OUT DETECTION.

NOTE:

EXISTING TRAFFIC SIGNAL CONTROLLER AND FOUNDATION TO REMAIN. EXISTING LIGHT DETECTOR AMPLIFIER, INDUCTIVE LOOP DETECTORS AND ALL OTHER CONTROL EQUIPMENT TO BE RE-USED FOR PERMANENT INSTALLATION.

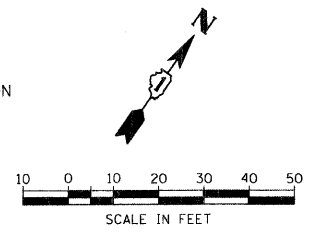
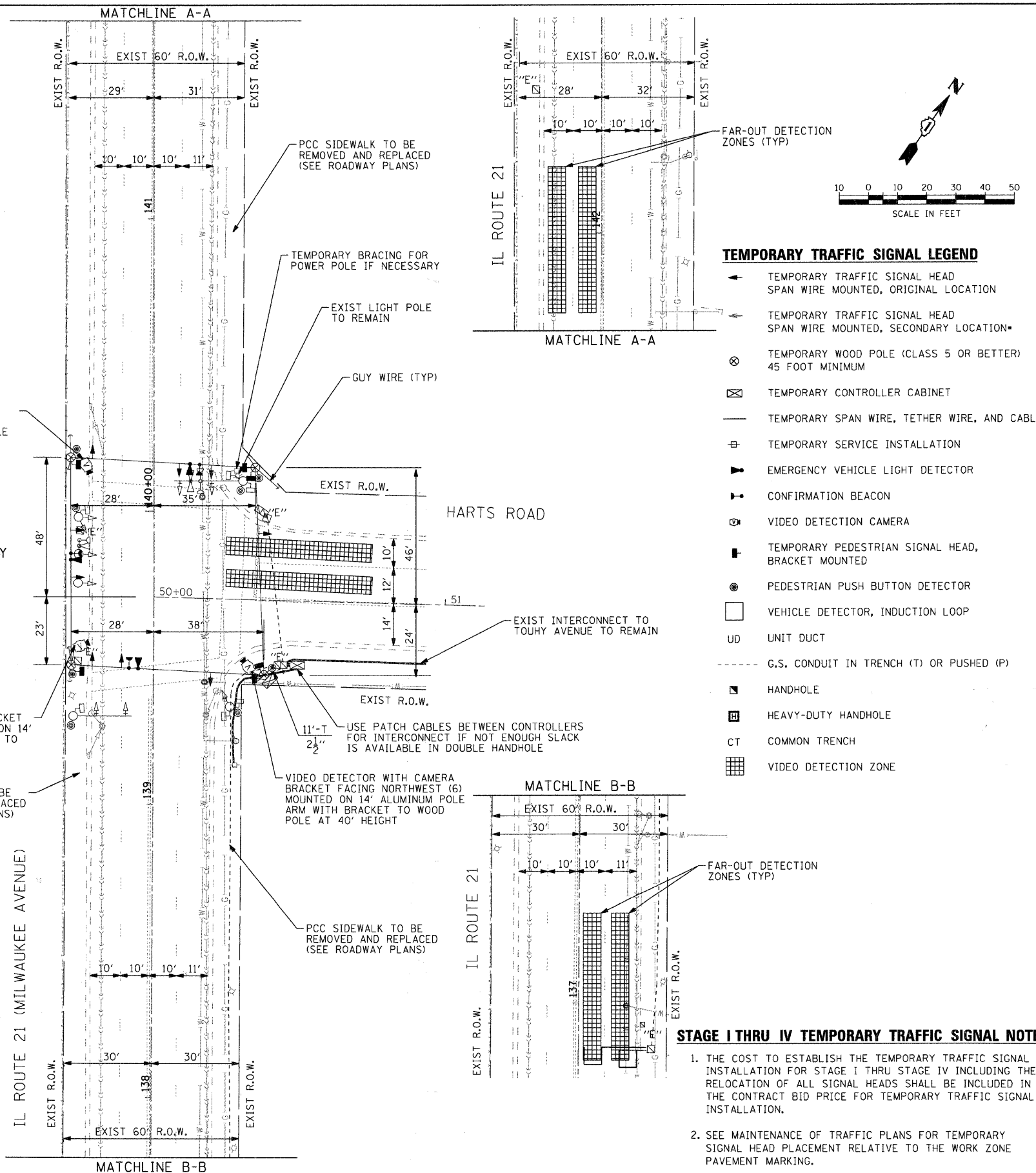

TEMPORARY TRAFFIC SIGNAL LEGEND

- ◁ TEMPORARY TRAFFIC SIGNAL HEAD SPAN WIRE MOUNTED, ORIGINAL LOCATION
- ◁ TEMPORARY TRAFFIC SIGNAL HEAD SPAN WIRE MOUNTED, SECONDARY LOCATION
- ⊗ TEMPORARY WOOD POLE (CLASS 5 OR BETTER) 45 FOOT MINIMUM
- ⊠ TEMPORARY CONTROLLER CABINET
- TEMPORARY SPAN WIRE, TETHER WIRE, AND CABLE
- ⊞ TEMPORARY SERVICE INSTALLATION
- ▷ EMERGENCY VEHICLE LIGHT DETECTOR
- ▷ CONFIRMATION BEACON
- ⊙ VIDEO DETECTION CAMERA
- ⊞ TEMPORARY PEDESTRIAN SIGNAL HEAD, BRACKET MOUNTED
- ⊙ PEDESTRIAN PUSH BUTTON DETECTOR
- VEHICLE DETECTOR, INDUCTIVE LOOP
- UD UNIT DUCT
- G.S. CONDUIT IN TRENCH (T) OR PUSHED (P)
- HANDHOLE
- ⊞ HEAVY-DUTY HANDHOLE
- CT COMMON TRENCH
- ⊞ VIDEO DETECTION ZONE

STAGE I THRU IV TEMPORARY TRAFFIC SIGNAL NOTES

- THE COST TO ESTABLISH THE TEMPORARY TRAFFIC SIGNAL INSTALLATION FOR STAGE I THRU STAGE IV INCLUDING THE RELOCATION OF ALL SIGNAL HEADS SHALL BE INCLUDED IN THE CONTRACT BID PRICE FOR TEMPORARY TRAFFIC SIGNAL INSTALLATION.
- SEE MAINTENANCE OF TRAFFIC PLANS FOR TEMPORARY SIGNAL HEAD PLACEMENT RELATIVE TO THE WORK ZONE PAVEMENT MARKING.



USER NAME = csh-rlk	DESIGNED - JJS	REVISED -
PLOT SCALE = 20	DRAWN - JJS	REVISED -
PLOT DATE = 12/22/2008	CHECKED - APS	REVISED -
	DATE - 12/16/08	REVISED -

VILLAGE OF NILES

TEMPORARY TRAFFIC SIGNAL INSTALLATION AND REMOVE EXISTING TRAFFIC SIGNAL EQUIPMENT STAGES I THRU IV MILWAUKEE AVE AT HARTS RD			
SCALE: 20	SHEET NO. 6 OF 16 SHEETS	STA.	TO STA.

F.A.U. RTE. 3513	SECTION 08-00107-00-PV	COUNTY COOK	TOTAL SHEETS 169	SHEET NO. 63
FED. ROAD DIST. NO. ILLINOIS FED. AID PROJECT		CONTRACT NO. M-8003(723)		