

FOR INDEX OF SHEETS, SEE SHEET NO. 2

FOR INDEX OF HIGHWAY STANDARDS, SEE SHEET NO. 2

STATE OF ILLINOIS  
DEPARTMENT OF TRANSPORTATION  
DIVISION OF HIGHWAYS

PLANS FOR PROPOSED  
FEDERAL AID PROJECT

METRA STATION PEDESTRIAN ACCESS IMPROVEMENTS PROJECT - PHASE III  
SIDEWALK IMPROVEMENTS

PROJECT NO.: CMM-8003(780)

SECTION NO.: 07-00087-00-SW

CITY OF OAK FOREST

COOK COUNTY

JOB NO.: C-91-175-07

THIS PROJECT IS  
LOCATED WITHIN  
THE CITY OF  
OAK FOREST

LAVERGNE AVENUE  
IMPROVEMENT ENDS  
STA. 47 + 38

LAPORTE AVENUE  
IMPROVEMENT ENDS  
STA. 13 + 94

LAPORTE AVENUE  
OMISSION  
STA. 8 + 23 TO 8 + 50

LECLAIRE AVENUE  
IMPROVEMENT ENDS  
STA. 47 + 35

LECLAIRE AVENUE  
OMISSION  
STA. 42 + 33 TO STA. 42 + 47

LAVERGNE AVENUE  
OMISSION  
STA. 42 + 18 TO STA. 42 + 34

LECLAIRE AVENUE  
IMPROVEMENT BEGINS  
STA. 1 + 13

LAVERGNE AVENUE  
IMPROVEMENT BEGINS  
STA. 0 + 59

LACROSSE AVENUE  
IMPROVEMENT ENDS  
STA. 13 + 97

LACROSSE AVENUE  
IMPROVEMENT BEGINS  
STA. 1 + 25

LAPORTE AVENUE  
IMPROVEMENT BEGINS  
STA. 1 + 35

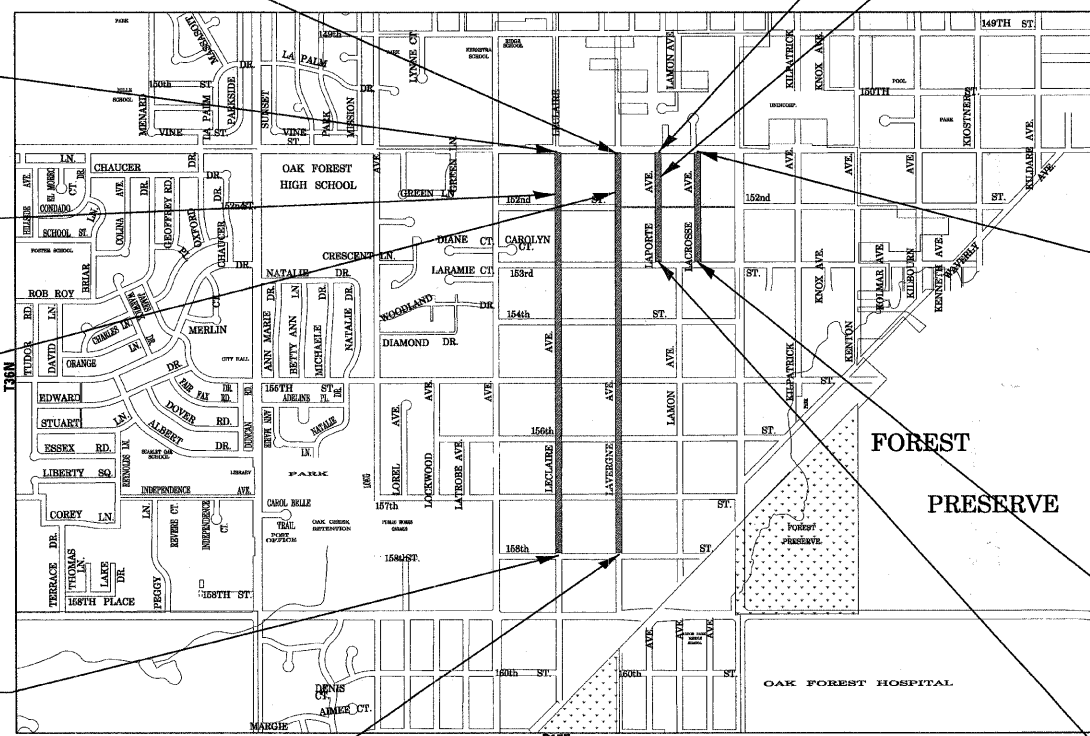

LOCATION MAP

SCALE: 1" = 1000'

GROSS LENGTH OF IMPROVEMENT = 11,832 LF OR 2.24 MILES  
NET LENGTH OF IMPROVEMENT = 11,775 LF OR 2.23 MILES



CALL 48 HOURS BEFORE YOU DIG

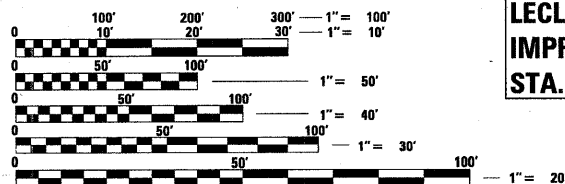

FULL SIZE PLANS HAVE BEEN PREPARED USING STANDARD  
ENGINEERING SCALES. REDUCED SIZED PLANS WILL NOT  
CONFORM TO STANDARD SCALES. IN MAKING MEASUREMENTS  
ON REDUCED PLANS, THE ABOVE SCALES MAY BE USED.

J.U.I.E.  
JOINT UTILITY LOCATION INFORMATION FOR EXCAVATION  
1-800-892-0123

BAXTER & WOODMAN, INC.  
STATE OF ILLINOIS - PROFESSIONAL DESIGN FIRM  
LICENSE NO. - 184-001121 - EXPIRES 4/30/2009

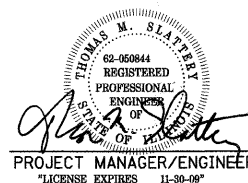

F.A.U. RTE.	SECTION	COUNTY	TOTAL SHEETS	SHEET NO.
	07-00087-00-SW	COOK	48	1
STA.	TO STA.			
FED. ROAD DIST. NO.	ILLINOIS	FED AID PROJECT CMM-8003 (780)		

C-91-175-07  
CONTRACT 63104



LOCATION OF SECTION INDICATED THUS: [Symbol]

STATE OF ILLINOIS  
DEPARTMENT OF TRANSPORTATION  
DIVISION OF HIGHWAYS

APPROVED 11/8/08  
*Greg Sollen*  
CITY OF OAK FOREST, DIRECTOR OF PUBLIC WORKS  
PASSED DECEMBER 18, 2008  
*Christopher Holt*  
DISTRICT 1 ENGINEER OF LOCAL ROADS & STREETS

RELEASING FOR BID  
BASED ON LIMITED  
REVIEW DECEMBER 16, 2008  
*Diana M. O'Keefe*  
DEPUTY DIRECTOR OF  
HIGHWAYS, REGION 1 ENGINEER

PRINTED BY THE AUTHORITY  
OF THE STATE OF ILLINOIS

CONTRACT NO. 63104

Burlington, Wisconsin (Crystal Lake, Illinois) DeKalb, Illinois Itasca, Illinois Mokena, Illinois Grayslake, Illinois Plainfield, Illinois Rockford, Illinois Madison, Wisconsin  
262.763.7834 815.459.1260 815.787.3111 630.773.1870 708.560.7070 847.223.5088 815.609.7425 815.489.1551 608.347.1542

(OFFICE WHICH PREPARED PLANS)

B&W PROJECT NO.: 061562

DATE: 11-17-08

COPYRIGHT © 2007 BY BAXTER & WOODMAN, INC.  
LICENSE NO. 184-001121 EXPIRES 4/30/2009  
FIELD ENGINEER: MELCHOR MANGOBA, P.E. 847 705-4408