

F.A.U. RTE.	SECTION	COUNTY	TOTAL SHEETS	SHEET NO.
1369	08-00082-00-BR	DUPAGE	13	1

STRUCTURE NO. 22-3021

STATE OF ILLINOIS
DEPARTMENT OF TRANSPORTATION
DIVISION OF HIGHWAYS

PLANS FOR PROPOSED
FEDERAL AID HIGHWAY

F.A.U. ROUTE 1369 (SCHICK ROAD)
SECTION 08-00082-00-BR
BRIDGE REHABILITATION
PROJECT M-9003(226)
C-91-314-07
VILLAGE OF BARTLETT, DUPAGE COUNTY

INDEX OF SHEETS

- 1 COVER SHEET
- 2 GENERAL NOTES AND SUGGESTED SEQUENCE OF WORK
- 3 SUMMARY OF QUANTITIES
- 4 EXISTING TYPICAL SECTIONS
- 5 PROPOSED TYPICAL SECTIONS
- 6 PLAN AND PROFILE
- 7 TRAFFIC CONTROL AND DETOUR PLAN
- 8 PILE BENT ENCASUREMENT DETAIL AND LOCATIONS
- 9 ABUTMENT CURTAIN WALL DETAIL
- 10 BRIDGE APPROACH PAVEMENT DETAIL
- 11 STEEL PLATE BEAM GUARD RAIL DETAIL
- 12 CROSS SECTIONS STA. 10+9 TO 11+20
- 13 CROSS SECTIONS STA. 11+20 TO 12+25

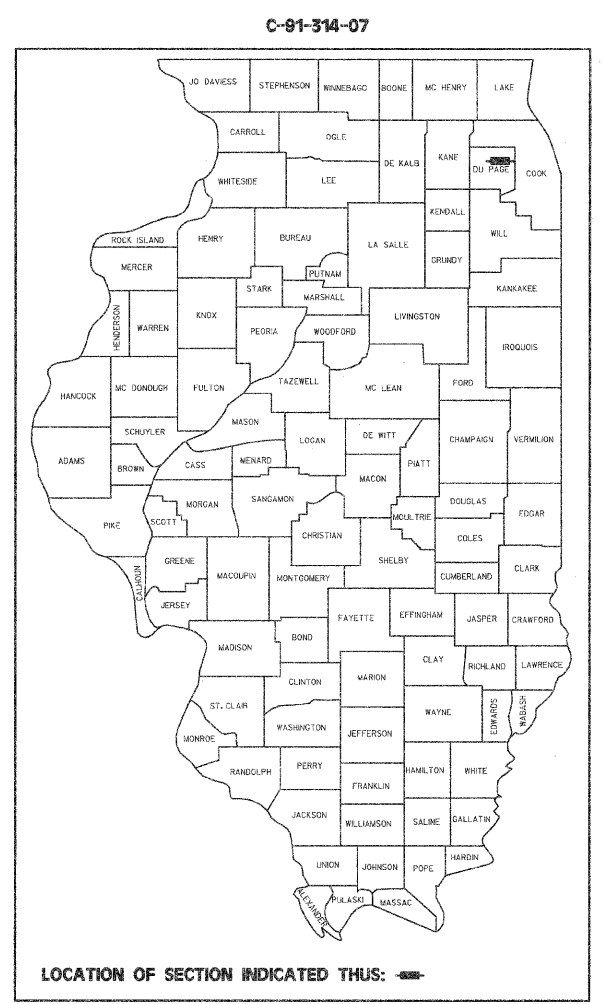
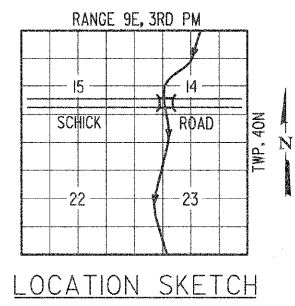

IDOT FEDERAL AID DESIGN ENGINEER: KEVIN STALLWORTH (847) 705-4169

HIGHWAY STANDARDS

- 606001-04 CONCRETE CURB TYPE B AND COMBINATION CONCRETE CURB AND GUTTER
- 701901-01 TRAFFIC CONTROL DEVICES
- 780001-02 TYPICAL PAVEMENT MARKINGS
- 781001-03 TYPICAL APPLICATIONS RAISED REFLECTIVE PAVEMENT MARKERS (SNOW PLOW RESISTANT)
- 630001-08 STEEL PLATE BEAM GUARDRAIL
- 630201-06 PCC/HMA STABILIZATION AT STEEL PLATE BEAM GUARDRAIL
- 631006-06 TRAFFIC BARRIER TERMINAL, TYPE 1B
- 630301-05 SHOULDER WIDENING FOR TYPE I (SPECIAL) GUARDRAIL TERMINALS
- 701502-03 URBAN LANE CLOSURE, 2L, 2W, WITH BIDIRECTIONAL LEFT TURN LANE
- 420401-07 Bridge Approach Pavement Connector

TRAFFIC DATA

POSTED SPEED LIMIT = 35 MPH
ADT = 16,350 (CURRENT)
ADT = 21,250 (2030)
TRUCK TRAFFIC = 2%
FUNCTIONAL CLASSIFICATION: MINOR ARTERIAL ROAD

FOR JOINT UTILITY INFORMATION

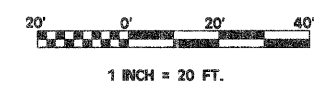

BENCHMARK

DUPAGE COUNTY FLAG IN NORTH EAST WINGWALL OF SCHICK ROAD BRIDGE OVER WEST BRANCH DUPAGE RIVER
ELEVATION = 745.35

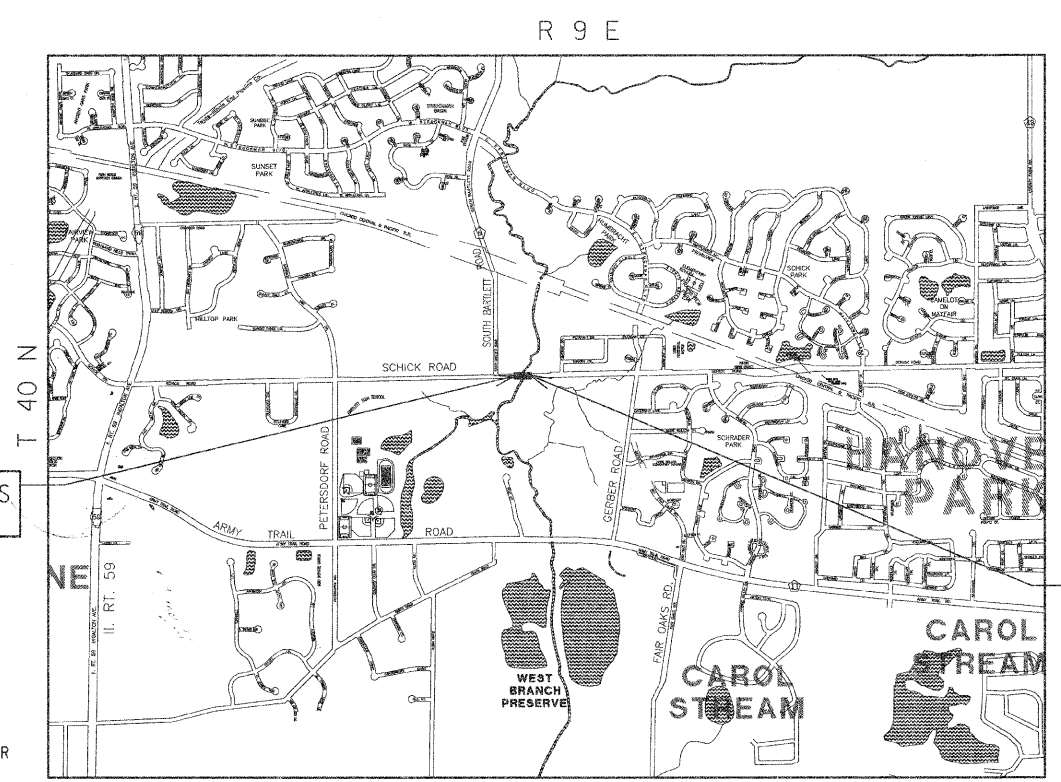

PROJECT ENDS STA. 12+20

DALE V. MARTING
REGISTERED PROFESSIONAL ENGINEER
No. 062-25264
EXPIRES 11/30/09

STATE OF ILLINOIS
DEPARTMENT OF TRANSPORTATION
DIVISION OF HIGHWAYS

APPROVED: [Signature] 12-19-08
DIRECTOR OF PUBLIC WORKS

PASSED: [Signature] DECEMBER 19, 2008
DISTRICT ENGINEER OF LOCAL ROADS & STREETS

RELEASING FOR BID BASED ON LIMITED REVIEW: [Signature] JANUARY 6, 2009
DEPUTY DIRECTOR OF HIGHWAYS, REGION I ENGINEER

PAVIA-MARTING & CO.
910 WEST LAKE STREET
ROSELLE, IL 60172-3352
(630) 529-8800 FAX (630) 894-4910
Design Firm Professional Registration #184002376