

STATE OF ILLINOIS  
DEPARTMENT OF TRANSPORTATION  
DIVISION OF HIGHWAYS

**PROPOSED  
HIGHWAY PLANS**

FAP ROUTE 301 (US 20)  
SECTION 21T-2  
PROJECT NHF-0301(054)  
STEPHENSON COUNTY  
CULVERT REPLACEMENTS

F.A.P. RTE.	SECTION	COUNTY	TOTAL SHEETS	SHEET NO.
301	21T-2	STEPHENSON	56	1
FED. ROAD DIST. NO.	ILLINOIS	CONTRACT NO. 64C63		

FOR INDEX OF SHEETS, SEE SHEET NO. 2  
FOR STATE STANDARDS, SEE SHEET NO. 2

ERIN TOWNSHIP, SECTION 14

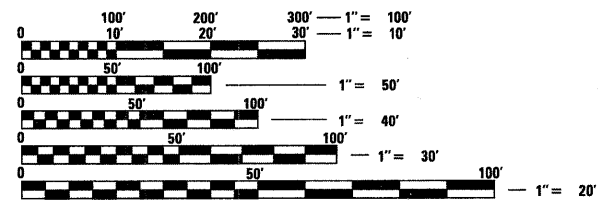

FULL SIZE PLANS HAVE BEEN PREPARED USING STANDARD ENGINEERING SCALES. REDUCED SIZED PLANS WILL NOT CONFORM TO STANDARD SCALES. IN MAKING MEASUREMENTS ON REDUCED PLANS, THE ABOVE SCALES MAY BE USED.

J.U.L.I.E.  
JOINT UTILITY LOCATION INFORMATION FOR EXCAVATION  
1-800-892-0123  
OR 811

PROJECT ENGINEER: MASOOD AHMAD  
SQUAD ENGINEER: TRACI HELFRICH (815) 284-5932

CONTRACT NO. 64C63

STEPHENSON COUNTY

STA 421 + 25.0091  
EXISTING S.N. 089-079  
PROPOSED S.N. 089-1122

C-92-091-07

SECTION ENDS  
STA 446 + 00  
IMPROVEMENT ENDS  
STA 446 + 50

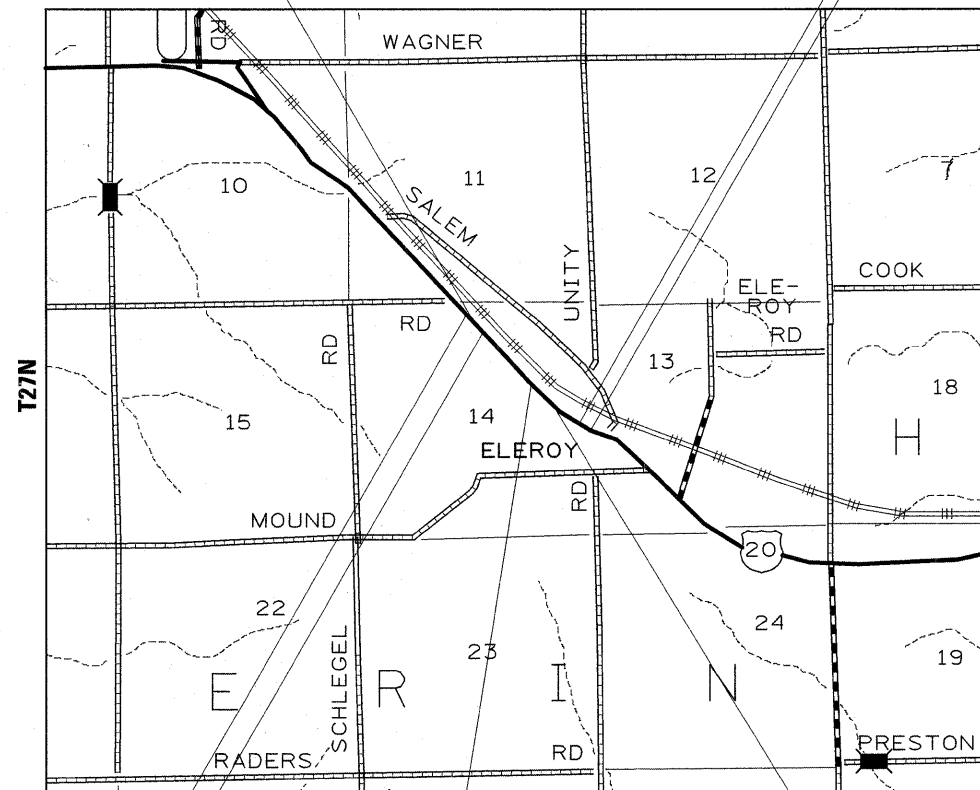

SECTION BEGINS  
STA 418 + 50  
IMPROVEMENT BEGINS  
STA 418 + 00

OMISSION  
STA 424 + 50 TO 441 + 50

STA 444 + 08  
EXISTING S.N. 089-081  
PROPOSED S.N. 089-1110

GROSS LENGTH = 2750 LIN. FT. = 0.521 MILE  
NET LENGTH = 1050.00 LIN. FT. = 0.199 MILE

SECTION 21T-2

FAP ROUTE 301



D-92-112-06

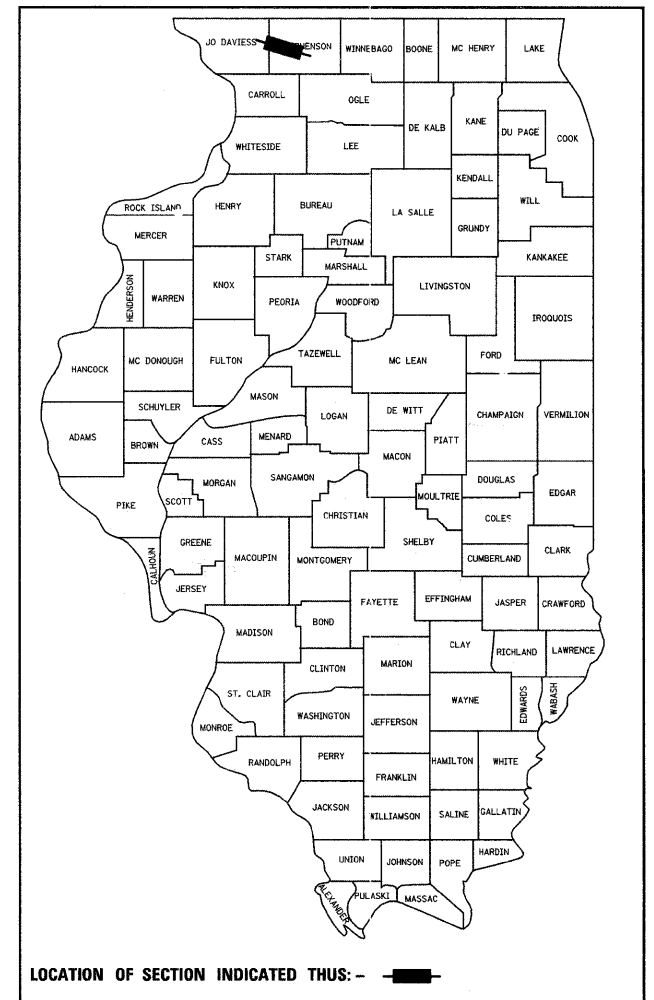

STATE OF ILLINOIS  
DEPARTMENT OF TRANSPORTATION  
DIVISION OF HIGHWAYS

SUBMITTED Dec 4 20 08  
George F. Ryan  
DEPUTY DIRECTOR OF HIGHWAYS, REGION ENGINEER

January 30, 20 09  
Charles J. Ingersoll  
ENGINEER OF DESIGN AND ENVIRONMENT

January 30, 20 09  
Christine M. Reed  
DIRECTOR OF HIGHWAYS, CHIEF ENGINEER

**PRINTED BY THE AUTHORITY  
OF THE STATE OF ILLINOIS**