

- STAGE I**
1. INSTALL 42" TEMPORARY CULVERT WITH CONCRETE COLLAR.
  2. CONSTRUCT 7' HOT-MIX ASPHALT SHOULDER FOR A TOTAL OF 8' HOT-MIX ASPHALT SHOULDER - LEFT.
  3. REMOVE THE EXISTING HEADWALL AND WING WALLS AND LEAVE THE EXISTING CULVERT IN PLACE TO MAINTAIN THE FLOW OF THE CULVERT.
  4. INSTALL PIPE CULVERT, CLASS A, TYPE 1, 84".
  5. INSTALL PAVEMENT PATCHING SPECIAL.
  6. CONSTRUCT 7' HOT-MIX ASPHALT SHOULDER FOR A TOTAL OF 8' HOT-MIX ASPHALT SHOULDER - RIGHT.

LEGEND	
	Work area
	Type III barricade
	Traffic signal
	Detector loops
	Drum with steady burning light
	Temporary concrete barrier
	Impact attenuator

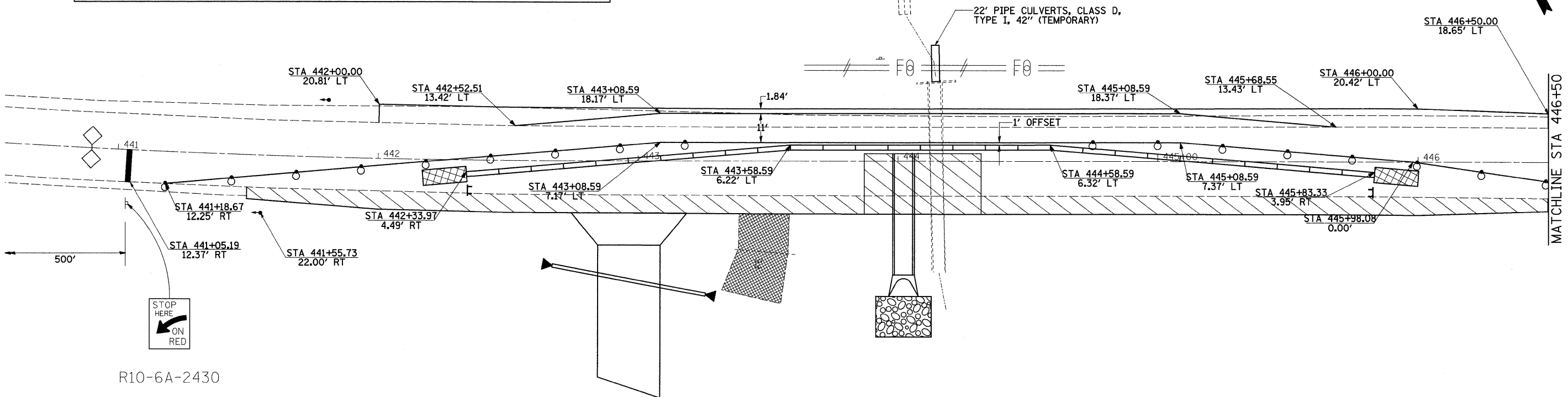
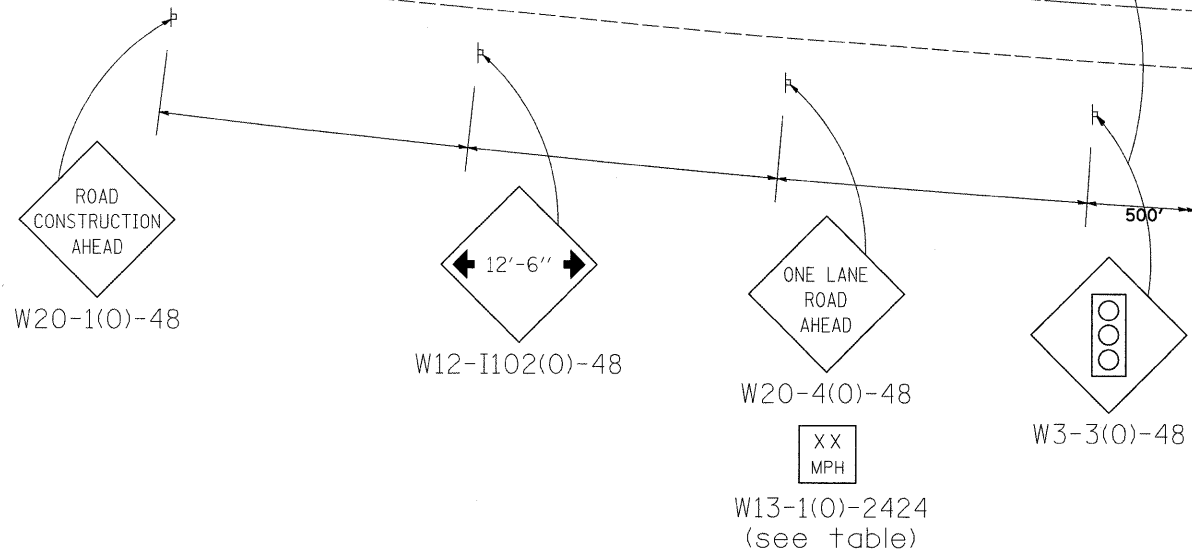

R10-6A-2430

NOTE: THE TEMPORARY CONCRETE BARRIER WALL SHALL BE SECURED TO THE PAVEMENT WITH SIX PINS THROUGHOUT THE LENGTH OF THE PATCH  
 \* SET TRAFFIC CONTROL PROTECTION PER STANDARD 701321 & 704001 FOR OTHER DEVICES NOT SHOWN IN WORK ZONE

FILE NAME =	USER NAME = dosidd	DESIGNED -	REVISED -	<b>STATE OF ILLINOIS DEPARTMENT OF TRANSPORTATION</b>	<b>STAGE I CONSTRUCTION CULVERT STA 444 + 02</b>				F.A.P. RTE.	SECTION	COUNTY	TOTAL SHEETS	SHEET NO.
ct\pw_work\PWIDOT\DOSSDD\dms34371\d11201stg.dgn		DRAWN -	REVISED -		301	21T-2	STEPHENSON	56	20				
PLOT SCALE = 20.0000' / IN.		CHECKED -	REVISED -		SCALE: SHEET NO. OF SHEETS STA. TO STA.				CONTRACT NO. 64C63				
PLOT DATE = Thu Dec 04 07:22:04 2008		DATE -	REVISED -		FED. ROAD DIST. NO. ILLINOIS FED. AID PROJECT								