

SECTION & IMPROVEMENT
BEGINS STA 37+20

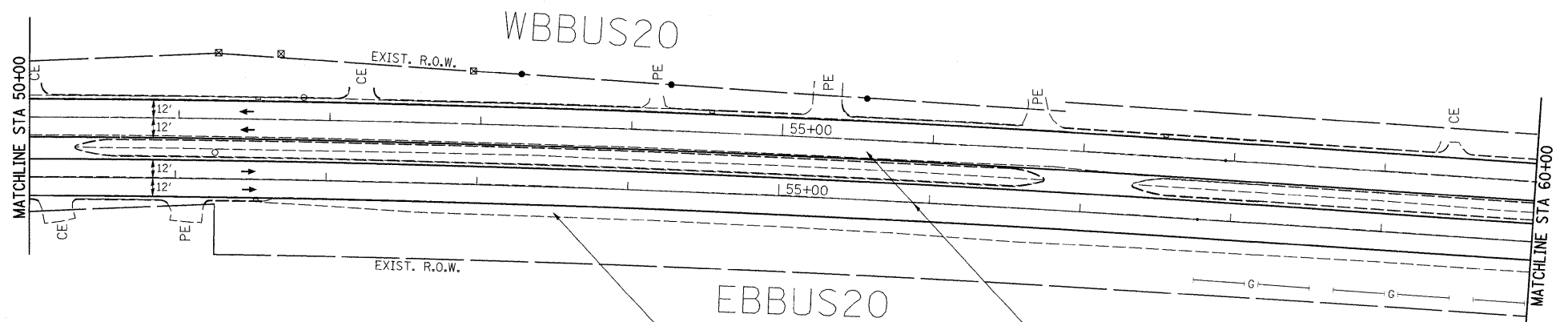
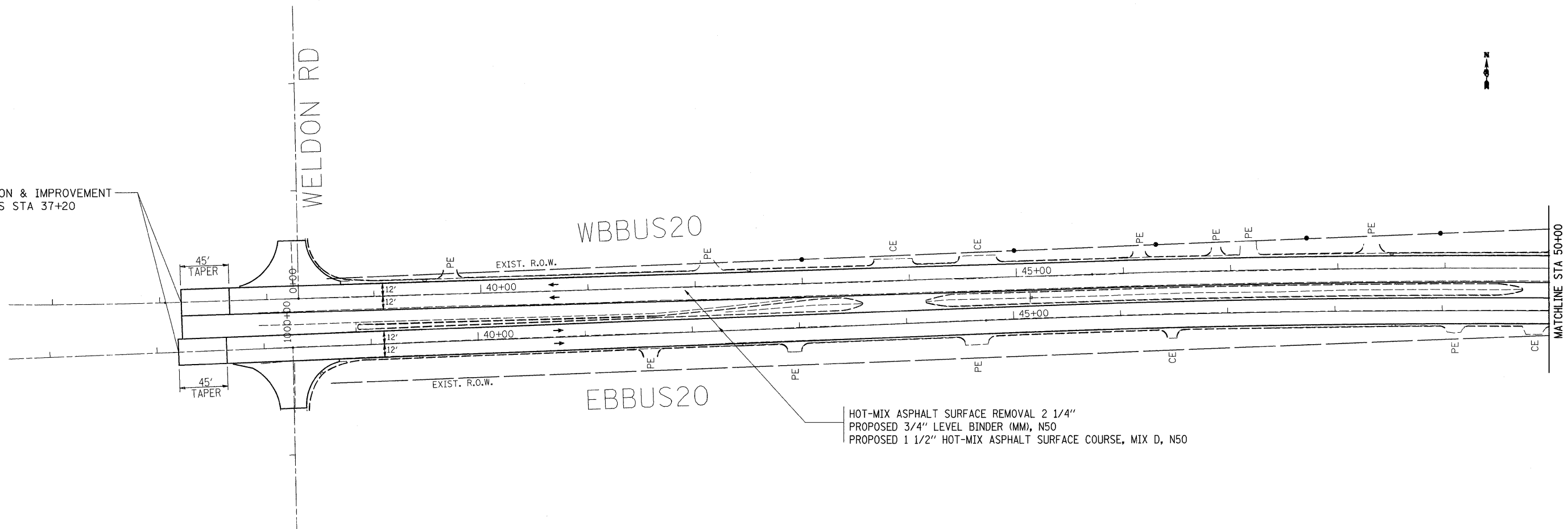

AGGREGATE SHOULDERS, TYPE B
(TO RAISE LOW EXISTING AGGREGATE
SHOULDERS, IF NEEDED)

FILE NAME = ca\projects\p211406\dl1406pln.dgn	USER NAME = polzinej	DESIGNED -	REVISED -	STATE OF ILLINOIS DEPARTMENT OF TRANSPORTATION	US BUS 20 PLAN & PROFILE SHEETS			F.A.P. RTE. 303	SECTION (40R)T	COUNTY WINNEBAGO	TOTAL SHEETS 67	SHEET NO. 24
PLCT SCALE = 50,0000 ' / IN.	CHECKED -	REVISED -	REVISED -					SCALE: SHEET NO. OF SHEETS STA. TO STA.			CONTRACT NO. 64C65	
PLCT DATE = Mon Aug 04 13:33:49 2008	DATE -	REVISED -	REVISED -		FED. ROAD DIST. NO. ILLINOIS FED. AID PROJECT							