

# STAGE 2

## STAGE 2

1. SETUP TRAFFIC CONTROL AND PROTECTION ACCORDING TO STANDARD 701431. SEE STANDARD FOR ADDITIONAL SIGNS AND DEVICES. SHIFT EB TRAFFIC ONTO THE INSIDE WB LANE AND WB TRAFFIC ONTO THE OUTSIDE WB LANE
2. REMOVE PAVEMENT AND GUARDRAIL AS SHOWN ON PLANS.
3. REMOVE SOUTH HALF OF EXISTING CULVERT.
4. CONSTRUCT PRECAST BOX CULVERT, END SECTIONS, STORM SEWER PIPE AND BACKFILL.
5. CONSTRUCT CLASS C PATCH.

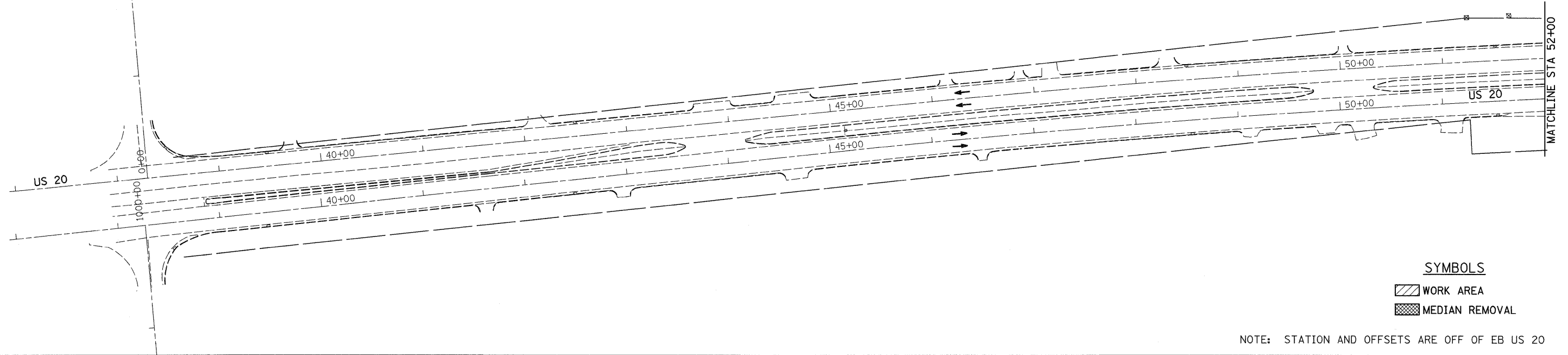

### SYMBOLS

- WORK AREA
- MEDIAN REMOVAL

NOTE: STATION AND OFFSETS ARE OFF OF EB US 20

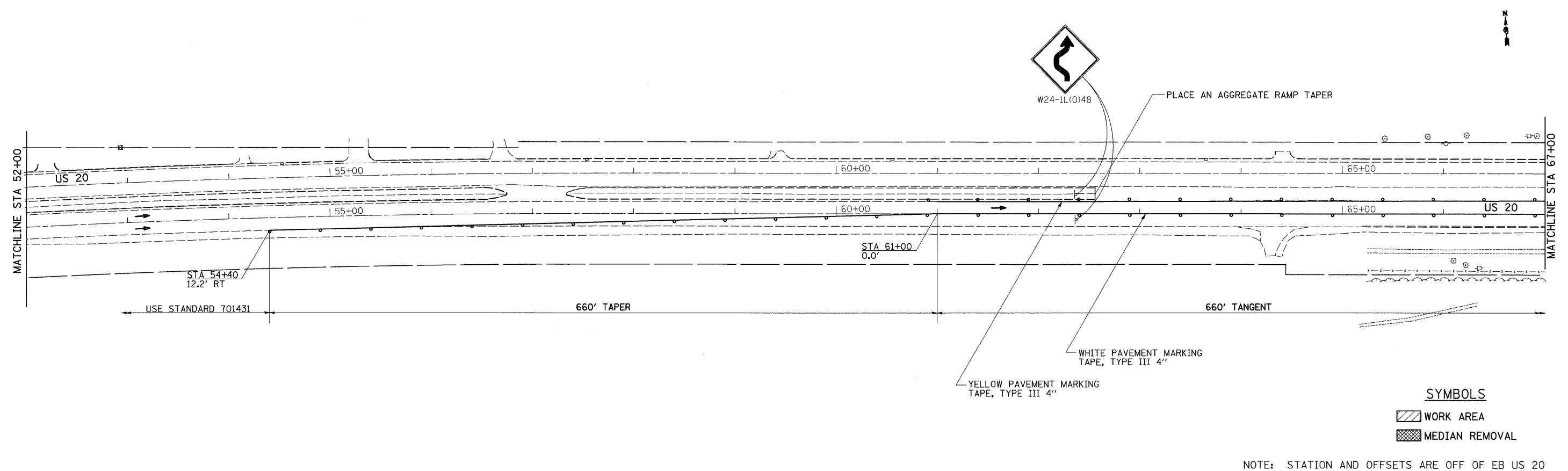

### SYMBOLS

- WORK AREA
- MEDIAN REMOVAL

NOTE: STATION AND OFFSETS ARE OFF OF EB US 20

FILE NAME = c:\projects\p211406\dl1406stg.dgn	USER NAME = polzinej	DESIGNED -	REVISED -	<b>STATE OF ILLINOIS DEPARTMENT OF TRANSPORTATION</b>	<b>STAGING PLANS</b>			F.A.P. RTE. 303	SECTION (40)RT	COUNTY WINNEBAGO	TOTAL SHEETS 67	SHEET NO. 31
	PLOT SCALE = 50.0000' / IN.	DRAWN -	REVISED -		SCALE:	SHEET NO.	OF SHEETS	STA. 37+00	TO STA. 67+00	CONTRACT NO. 64C65		
	PLOT DATE = Mon Aug 04 14:50:19 2008	CHECKED -	REVISED -							FED. ROAD DIST. NO. ILLINOIS FED. AID PROJECT		
		DATE -	REVISED -									