

PAVEMENT ELEVATIONS

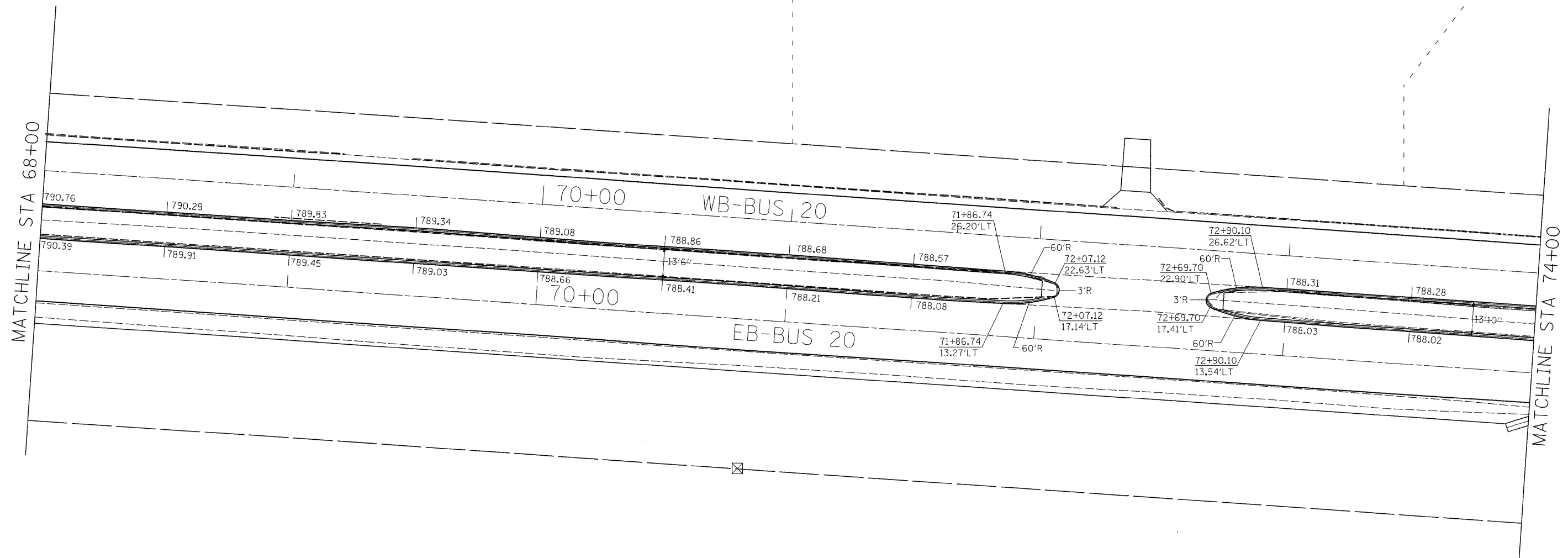

NOTES:

STA/OFFSET FROM \square EB-BUS 20
 PROPOSED MEDIAN ELEVATIONS @ 50' INTERVALS

* ELEVATIONS ARE AT THE GUTTER FLAG

| | | | | | | | | | | | | |
|---|----------------------|------------|---|---|----------------------------|--|--|--------------------|-------------------|---------------------|--------------------|--------------------|
| FILE NAME = c:\projects\p211406\dl1406e1.dgn | USER NAME = polzinej | DESIGNED - | REVISED - | STATE OF ILLINOIS DEPARTMENT OF TRANSPORTATION | PAVEMENT ELEVATIONS | | | F.A.P. RTE. 303 | SECTION (40R)T | COUNTY WINNEBAGO | TOTAL SHEETS 67 | SHEET NO. 38 |
| PLOT SCALE = 50.0000' / IN. | CHECKED - | REVISED - | SCALE: | | | | | SHEET NO. | OF SHEETS | STA. | TO STA. | CONTRACT NO. 64C65 |
| PLOT DATE = Mon Aug 04 13:20:14 2008 | DATE - | REVISED - | FED. ROAD DIST. NO. ILLINOIS FED. AID PROJECT | | | | | | | | | |