

FOR INFORMATION ONLY

PROJECT NO.	SECTION	COUNTY	SHEET NO.	TOTAL SHEETS
195-403	1-2	WHITESIDE	230	17
F.A. DIST. NO. 7	ALIGNED	FED. AID PROJECT		

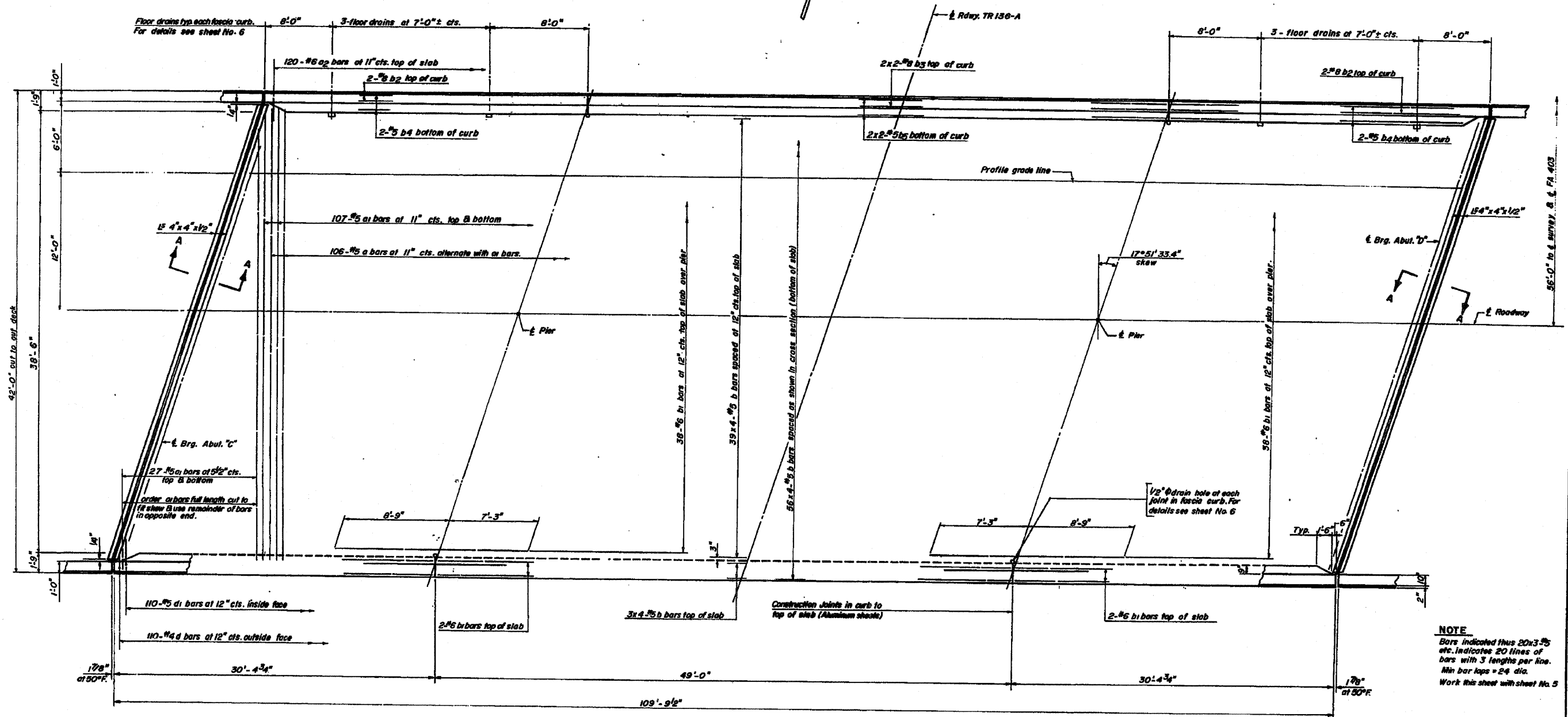

NOTE
 Bars indicated thus 20x3 #5 etc. indicate 20 lines of bars with 3 lengths per line. Min bar laps = 24 dia. Work this sheet with sheet No. 6

DESIGNED	B.T.M.
CHECKED	H.S.
DRAWN	A.M.
CHECKED	H.S.

DECK PLAN (EAST BOUND SHOWN)
 (WEST BOUND SIMILAR BY 180° ROTATION ABOUT & SURVEY & & FA 403)

DECK SLAB
 FA 403 SECTION 195-1H8-5
 FA 403 OVER TR 136A
 WHITESIDE COUNTY
 STATION 1496+11.93
 098-0063.4

* FAI Route 88 & FAP Route 309 (I-88 & US 30)
 ** D2 Bridge Painting 2009-2

FILE NAME: P:\PAINTING\64E63\PLA\eng.dgn	USER NAME: linkdj	DESIGNED: B.T.M.	REVISION: 1	STATE OF ILLINOIS DEPARTMENT OF TRANSPORTATION	F.A. DIST. NO. 7	SECTION 1-2	COUNTY Whiteside	TOTAL SHEETS 29	SHEET NO. 17
PLOT SCALE = 50.0000' / IN.	PLOT DATE = Fri Dec 05 13:41:09 2008	DRAWN: A.M.	REVISION: 2						
		CHECKED: H.S.	REVISION: 3						
		CHECKED: H.S.	REVISION: 4						
			REVISION: 5						
			REVISION: 6						
			REVISION: 7						
			REVISION: 8						
			REVISION: 9						
			REVISION: 10						
			REVISION: 11						
			REVISION: 12						
			REVISION: 13						
			REVISION: 14						
			REVISION: 15						
			REVISION: 16						
			REVISION: 17						
			REVISION: 18						
			REVISION: 19						
			REVISION: 20						
			REVISION: 21						
			REVISION: 22						
			REVISION: 23						
			REVISION: 24						
			REVISION: 25						
			REVISION: 26						
			REVISION: 27						
			REVISION: 28						
			REVISION: 29						
			REVISION: 30						
			REVISION: 31						
			REVISION: 32						
			REVISION: 33						
			REVISION: 34						
			REVISION: 35						
			REVISION: 36						
			REVISION: 37						
			REVISION: 38						
			REVISION: 39						
			REVISION: 40						
			REVISION: 41						
			REVISION: 42						
			REVISION: 43						
			REVISION: 44						
			REVISION: 45						
			REVISION: 46						
			REVISION: 47						
			REVISION: 48						
			REVISION: 49						
			REVISION: 50						
			REVISION: 51						
			REVISION: 52						
			REVISION: 53						
			REVISION: 54						
			REVISION: 55						
			REVISION: 56						
			REVISION: 57						
			REVISION: 58						
			REVISION: 59						
			REVISION: 60						
			REVISION: 61						
			REVISION: 62						
			REVISION: 63						
			REVISION: 64						
			REVISION: 65						
			REVISION: 66						
			REVISION: 67						
			REVISION: 68						
			REVISION: 69						
			REVISION: 70						
			REVISION: 71						
			REVISION: 72						
			REVISION: 73						
			REVISION: 74						
			REVISION: 75						
			REVISION: 76						
			REVISION: 77						
			REVISION: 78						
			REVISION: 79						
			REVISION: 80						
			REVISION: 81						
			REVISION: 82						
			REVISION: 83						
			REVISION: 84						
			REVISION: 85						
			REVISION: 86						
			REVISION: 87						
			REVISION: 88						
			REVISION: 89						
			REVISION: 90						
			REVISION: 91						
			REVISION: 92						
			REVISION: 93						
			REVISION: 94						
			REVISION: 95						
			REVISION: 96						
			REVISION: 97						
			REVISION: 98						
			REVISION: 99						
			REVISION: 100						