

F.A.I. RTE.	SECTION	COUNTY	TOTAL SHEETS	SHEET NO.
39	(50-1VB)BP	LASALLE	11	1
FED. ROAD DIST. NO.	ILLINOIS	CONTRACT NO. 66878		

### STANDARDS

1. COVER SHEET
2. GENERAL NOTES
3. SUMMARY OF QUANTITIES
4. TYPICAL SECTION
5. STAGE I TRAFFIC CONTROL
6. STAGE II TRAFFIC CONTROL
- 7 - 11. EXISTING STRUCTURE PLANS

### STANDARDS

- 000001-05 STANDARD SYMBOLS, ABBREVIATIONS AND PATTERNS
- 701101-02 OFF-ROAD OPERATIONS MULTILANE, 15' (4.5 m) TO 24" (600 mm) FROM PAVEMENT EDGE
- 701106-02 OFF-ROAD OPERATIONS, MULTILANE, MORE THAN 15' (4.5 m) AWAY
- 701400-03 APPROACH TO LANE CLOSURE, FREEWAY/EXPRESSWAY
- 701402-07 LANE CLOSURE, FREEWAY/EXPRESSWAY, WITH BARRIER
- 701901-01 TRAFFIC CONTROL DEVICES
- 704001-05 TEMPORARY CONCRETE BARRIER

## STATE OF ILLINOIS DEPARTMENT OF TRANSPORTATION

### DIVISION OF HIGHWAYS

# PROPOSED HIGHWAY PLANS

**FAI ROUTE 39 (I-39)  
SECTION (50-1VB)BP**

**BRIDGE PAINTING  
LASALLE COUNTY**

C-93-026-09

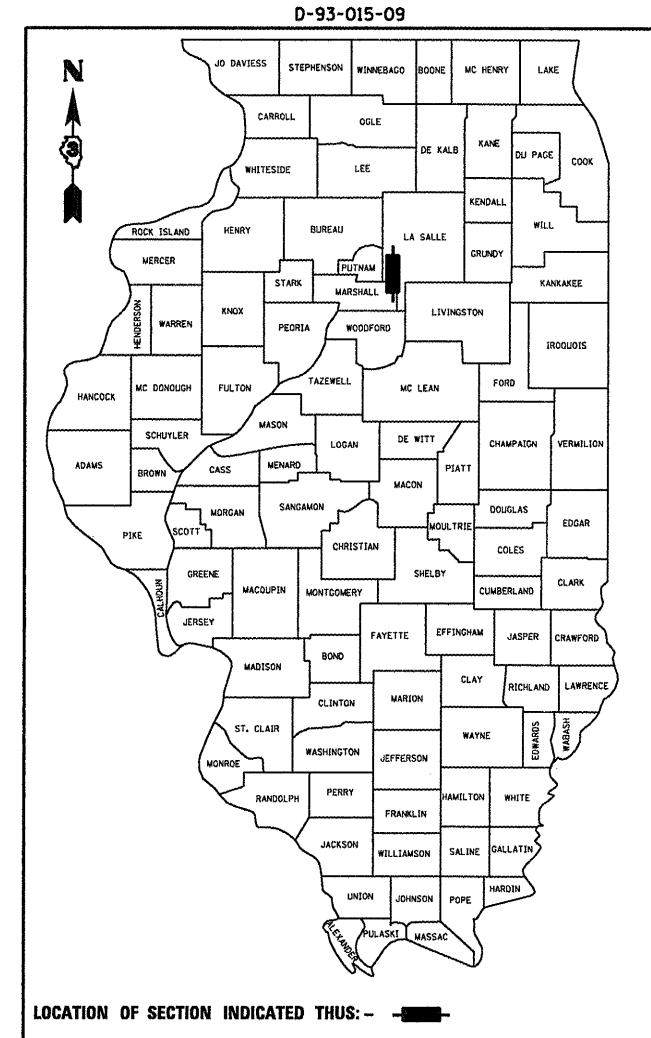

**PROJECT LOCATION**  
BRIDGE NO. 1 SN 050-0210 SB &  
BRIDGE NO. 2 SN 050-0211 NB  
OVER THE NORFOLK SOUTHERN RAILROAD  
1.48 MILES NORTH OF IL ROUTE 18  
NEAR LOSTANT

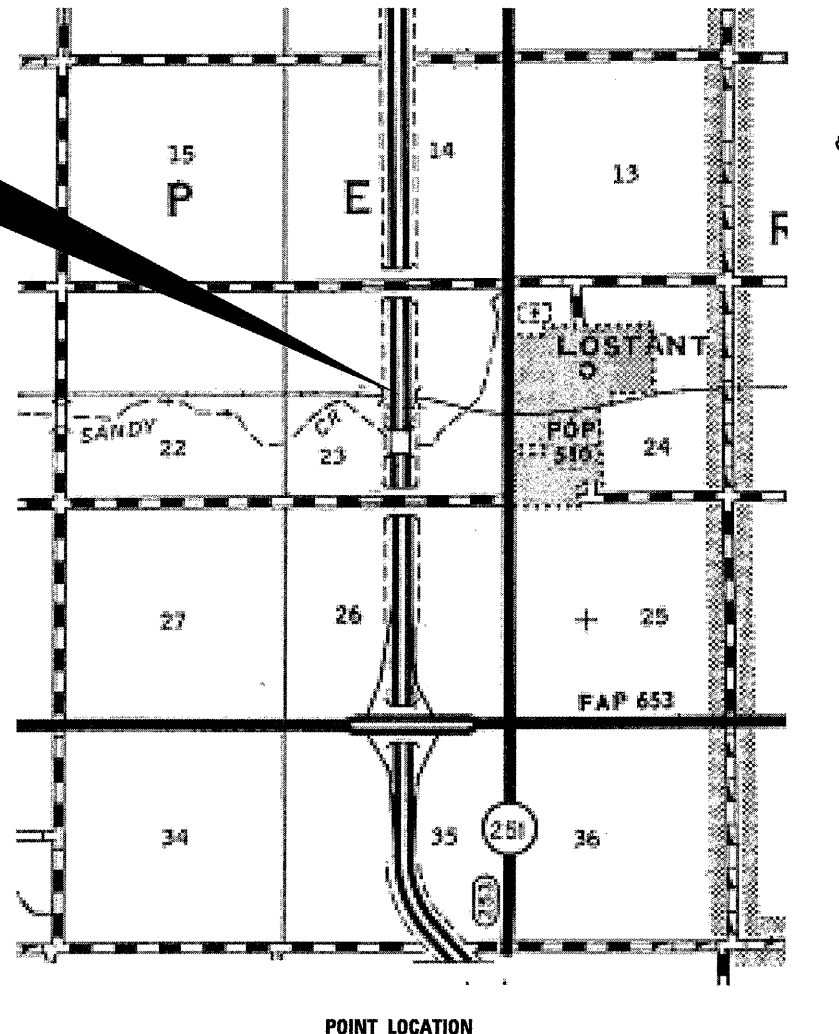

FUNCTIONAL CLASSIFICATION  
RURAL - INTERSTATE  
F.A.I. ROUTE 39 (I-39)  
2007 ADT = 18400  
P.V = 62.8% M.U. = 32.6% S.U. = 4.6%

J.U.L.I.E.  
JOINT UTILITY LOCATION INFORMATION FOR EXCAVATION  
1-800-892-0123  
OR 811

PROJECT ENGINEER JOE KANNEL  
UNIT CHIEF RON WOODSHANK

CONTRACT NO. 66878

STATE OF ILLINOIS  
DEPARTMENT OF TRANSPORTATION  
DIVISION OF HIGHWAYS

SUBMITTED 12/10 20 08

*George F. Ryan*  
DEPUTY DIRECTOR OF HIGHWAYS, REGION ENGINEER

January 30, 20 09

*Charles J. Ingersoll*  
ENGINEER OF DESIGN AND ENVIRONMENT

January 30, 20 09

*Christine M. Reed*  
DIRECTOR OF HIGHWAYS, CHIEF ENGINEER

**PRINTED BY THE AUTHORITY  
OF THE STATE OF ILLINOIS**