

STATE OF ILLINOIS
DEPARTMENT OF TRANSPORTATION

TOTAL BILL OF MATERIAL

ITEM	UNIT	SUPER	SUB	TOTAL
Structure Excavation	Cu. Yd.	-	124	124
Concrete Removal	Cu. Yd.	-	33.6	33.6
Concrete Structures	Cu. Yd.	-	20.6	20.6
Concrete Superstructure	Cu. Yd.	566.3	-	566.3
Preformed Joint Strip Seal	Foot	172.0	-	172.0
** Bridge Deck Grooving	Sq. Yd.	1448	-	1448
** Reinforcement Bars, Epoxy Coated	Pound	148150	5910	154060
** Protective Coat	Sq. Yd.	1743	-	1743
Name Plates	Each	2	-	2
Removal of Existing Superstructures	Each	2	-	2
Elastomeric Bearing Assembly, Type I	Each	-	24	24
Anchor Bolts, 1"	Each	-	48	48
Bar Splicers	Each	-	164	164
Pipe Underdrains for Structures, 4 in.	Foot	-	224	224
Porous Granular Embankment (Special)	Cu. Yd.	-	124	124
Floor Drains	Each	16	-	16
Geocomposite Wall Drain	Sq. Yd.	-	82	82
Structural Repair of Concrete (Depth Equal To or Less Than 5 in)	Sq. Ft.	-	11.8	11.8
Concrete Sealer	Sq. Ft.	-	964	964

** Quantity includes approach pavement.

GENERAL NOTES

Reinforcement bars shall conform to the requirements of ASTM A 706 Gr 60. See Special Provisions.

Reinforcement bars designated (E) shall be epoxy coated.

Plan dimensions and details relative to existing plans are subject to nominal construction variations. The Contractor shall field verify existing dimensions and details affecting new construction and make necessary approved adjustments prior to construction or ordering of materials. Such variations shall not be cause for additional compensation for a change in scope of the work, however, the Contractor will be paid for the quantity actually furnished at the unit price bid for the work.

Stationing, offsets and elevations are developed from field survey data. It is the Contractor's responsibility to verify this data matches the existing structures.

Concrete Sealer shall be applied to areas of the Abutments as designated on Sheets 15 and 16 of 18.

The Contractor shall make allowance for the deflection of forms, shrinkage and settlement of falsework, in addition to allowance for dead load deflection. Forms for deck slab shall be removed prior to placement of bridge approach pavement.

Slipforming of the parapets is not allowed.

The existing steel bearing coating contains lead. The Contractor shall take appropriate precautions to deal with the presence of lead on this project.

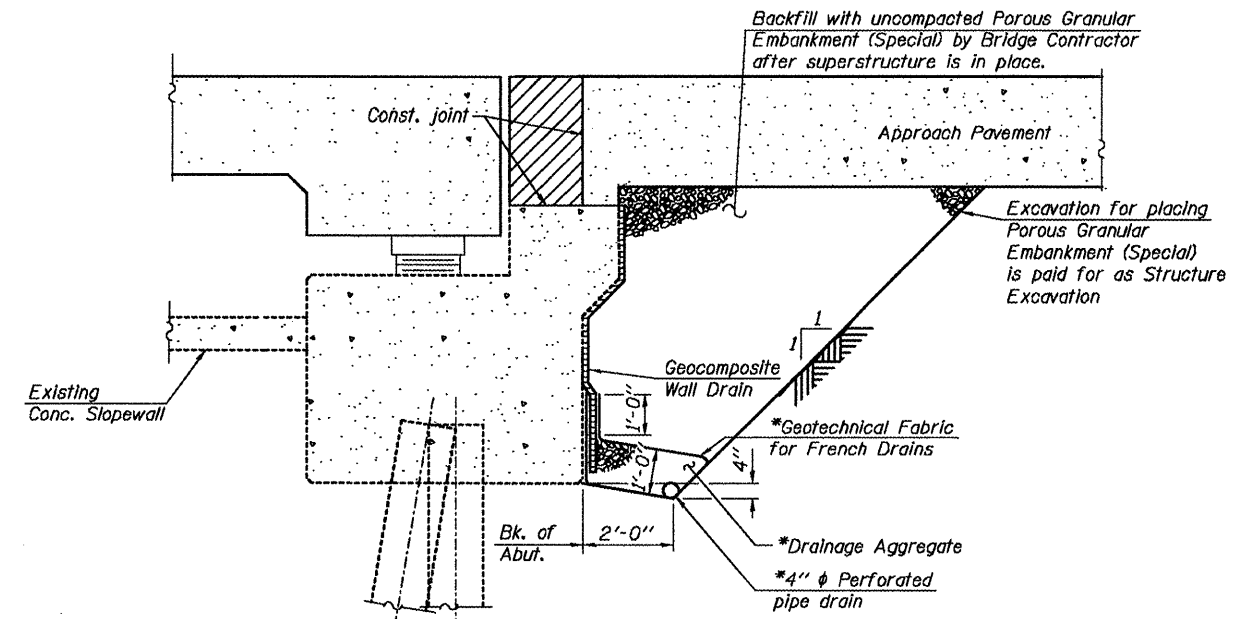

SECTION THRU ABUTMENT
(Horizontal dimensions @ Rt. L's)

*Included in the cost of Pipe Underdrains for Structures.

All drainage system components shall extend to the wingwall except an outlet pipe shall extend until intersecting with the side slopes. The pipes shall drain into concrete headwalls. (See Article 601.05 of the Standard Specifications and Highway Standard 601101).

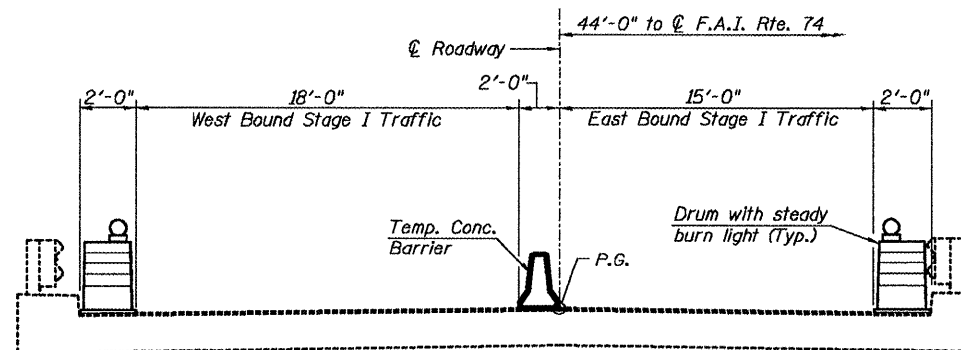

STAGE I TRAFFIC
(Utilizing Crossovers)
(Existing North Structure)

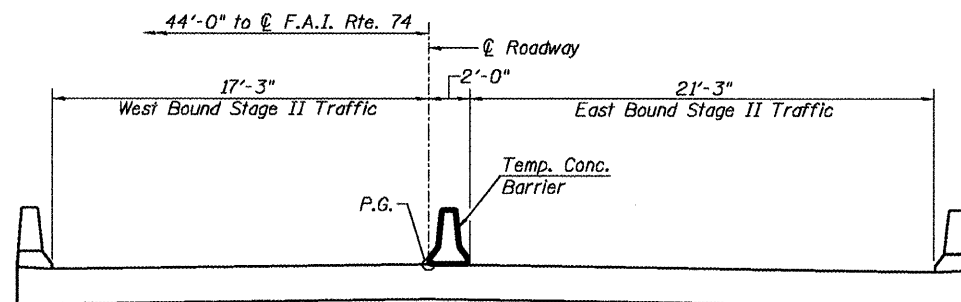

STAGE II TRAFFIC
(Utilizing Crossovers)
(Proposed South Structure)

- Notes:
1. See roadway plans for quantity of Temporary Concrete Barrier.
 2. See sheet 3 of 18 for details of Temporary Concrete Barrier.
 3. All cross sections are Looking East.

STATION 570+11.72
RE-BUILT 20 BY
STATE OF ILLINOIS
F.A.I. RT. 74 SEC. 48-(27HB-5)I,I-1
LOADING HL-93
STR NO. 048-0011

STATION 570+11.72
RE-BUILT 20 BY
STATE OF ILLINOIS
F.A.I. RT. 74 SEC. 48-(27HB-5)I,I-1
LOADING HL-93
STR NO. 048-0012

NAME PLATES
See Std. 515001

Note:
Existing Name Plates shall be cleaned and relocated next to new Name Plates.
Cost included with Name Plates.

GENERAL NOTES & DETAILS
I-74 OVER TOWNSHIP ROAD 205
F.A.I. RTE. 74 - SEC. 48-(27HB-5)I,I-1
KNOX COUNTY
STATION 570+11.72
STRUCTURE NO. 048-0011 (WB), 0012 (EB)

	SHEET NO. 2	F.A.I. RTE. 74	SECTION 48-(27HB-5)I,I-1	COUNTY KNOX	TOTAL SHEETS 104	SHEET NO. 41
	18 SHEETS	CONTRACT NO. 68062				
<small>Designed By: ESH, Checked By: MTH, Drawn By: ESH, Date: 01/2008, File: 048-0011.002.dwg</small>		FED. ROAD DIST. NO. ILLINOIS FED. AID PROJECT				