

BENCHMARKS:
 M SPIKE IN POWER POLE STA. 48+93, 107' LT.
 ELEV. = 484.10
 RR SPIKE AT SOUTH SIDE OF POWER POLE
 STA. 45+00, 35' RT.; ELEV. = 483.16
 CHISELED "C" TOP OF NW WINGWALL
 ELEV. = 487.86
 CHISELED "C" TOP OF SW WINGWALL
 ELEV. = 487.81

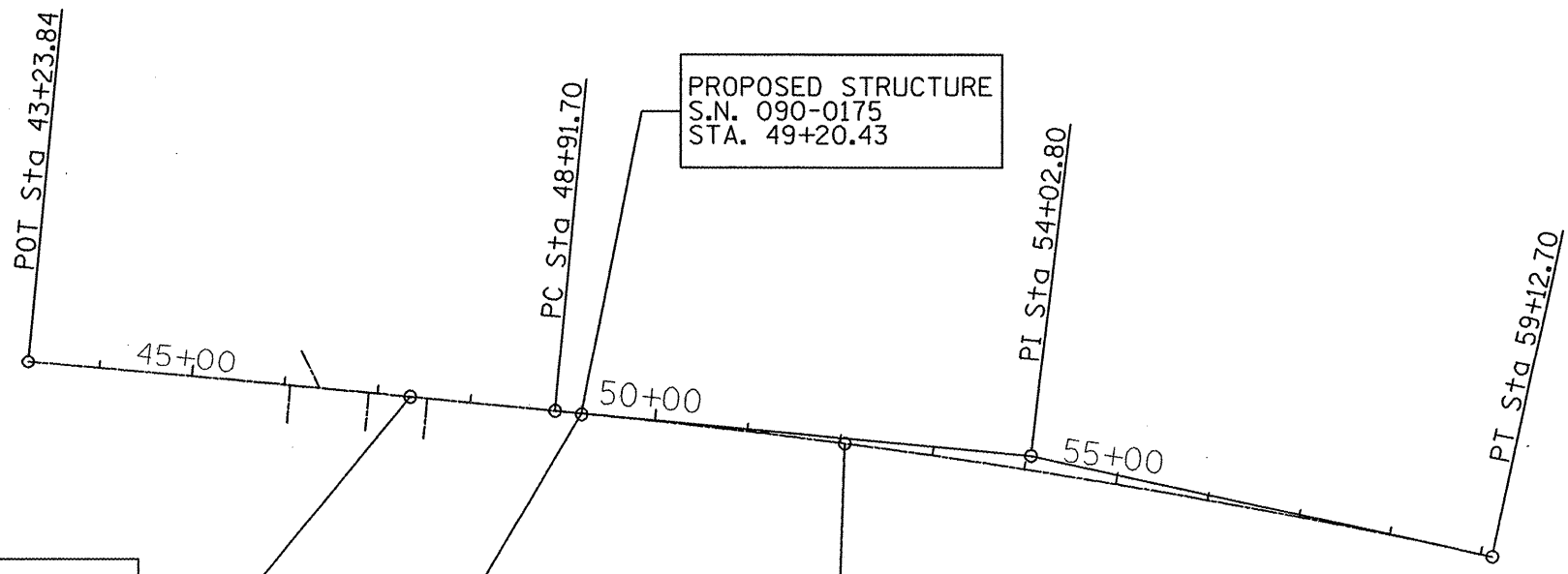

Exlst. Curve C1
 PI Sta. 54+02.80
 $\Delta = 6^\circ 48' 24''$ (RT)
 $D = 0^\circ 40' 00''$
 $T = 511.10'$
 $R = 8,594.42'$
 $L = 1,021.00'$
 $E = 15.18'$
 PC Sta. 48+91.70
 PT Sta. 59+12.70
 S.E. = N.C.

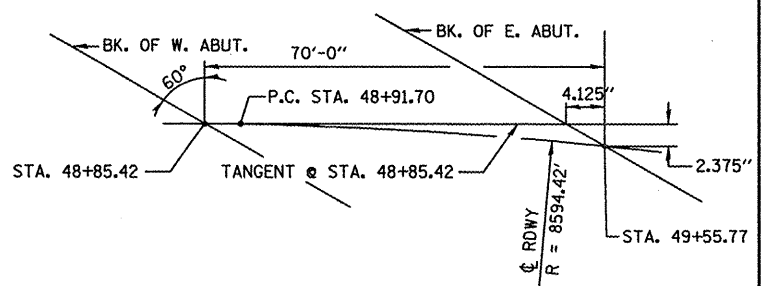
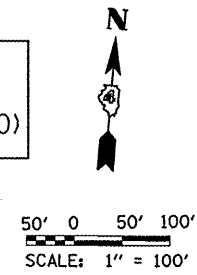

FILE NAME =
 ...\\038alignmentandties.dgn

USER NAME = Plotted by new6	DESIGNED - ST	REVISED - ---
DRAWN - ST	CHECKED - FL	REVISED - ---
PLOT SCALE = 200.0000 / IN.	DATE - 12/2007	REVISED - ---
PLOT DATE = 7/29/2008		

**STATE OF ILLINOIS
 DEPARTMENT OF TRANSPORTATION**

ALIGNMENT & TIES
US 150 OVER LITTLE FARM CREEK S.N. 090-0038
 SCALE: 1" = 100' SHEET NO. OF SHEETS STA. 47+35.00 TO STA. 52+05.00

F.A.U. RTE.	SECTION	COUNTY	TOTAL SHEETS	SHEET NO.
6757	(105B) BR-2	TAZEWELL	19	133
CONTRACT NO. 68086			FED. ROAD DIST. NO. ILLINOIS FED. AID PROJECT	