

STAGE I TYPICAL SECTION  
(LOOKING EAST)

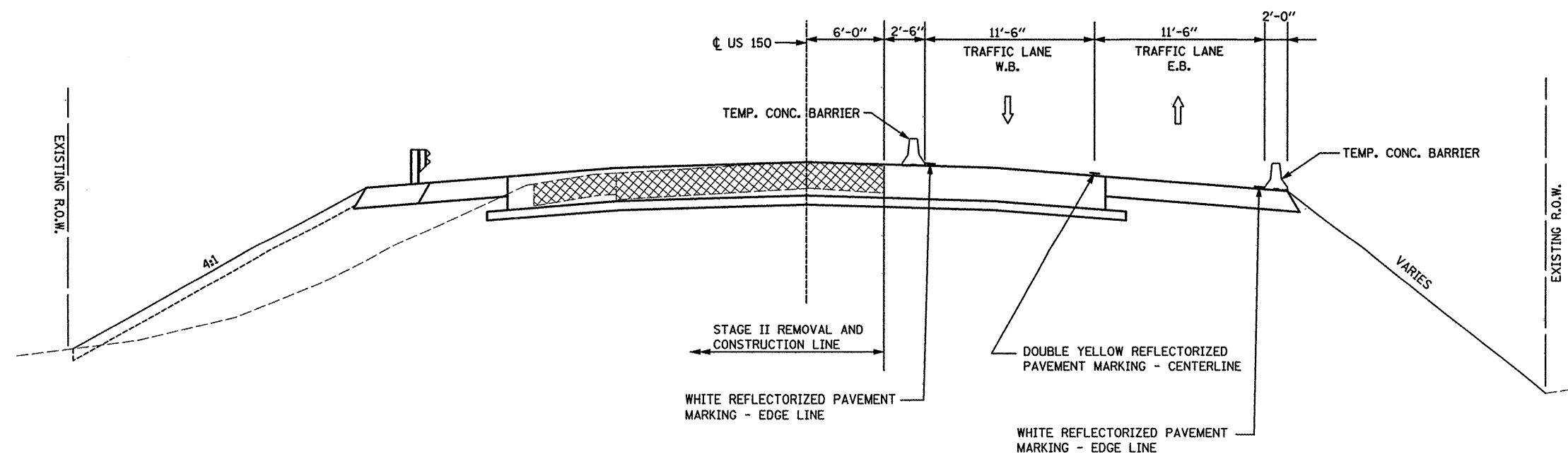

STAGE II TYPICAL SECTION  
(LOOKING EAST)

FILE NAME =  
...Phase II\0900040\0040MOTXS.dgn

USER NAME = Plotted by flm	DESIGNED - ST	REVISED -
	DRAWN - ST	REVISED -
PLOT SCALE = 40.0000' / IN.	CHECKED - FL	REVISED -
PLOT DATE = 10/7/2008	DATE - 12/2007	REVISED -

STATE OF ILLINOIS  
DEPARTMENT OF TRANSPORTATION

MAINTENANCE OF TRAFFIC TYPICAL SECTIONS  
US 150 OVER LITTLE FARM CREEK S.N. 090-0040  
SCALE: N.T.S. SHEET NO. OF SHEETS STA. 84+36.72 TO STA. 96+00.00

F.A.U. RTE. 6757	SECTION (105B) BR-3	COUNTY TAZEWELL	TOTAL SHEETS 38	SHEET NO. 133
CONTRACT NO. 68086				
FED. ROAD DIST. NO. ILLINOIS FED. AID PROJECT				