

**ELEVATION**  
Stage I  
(Looking North)

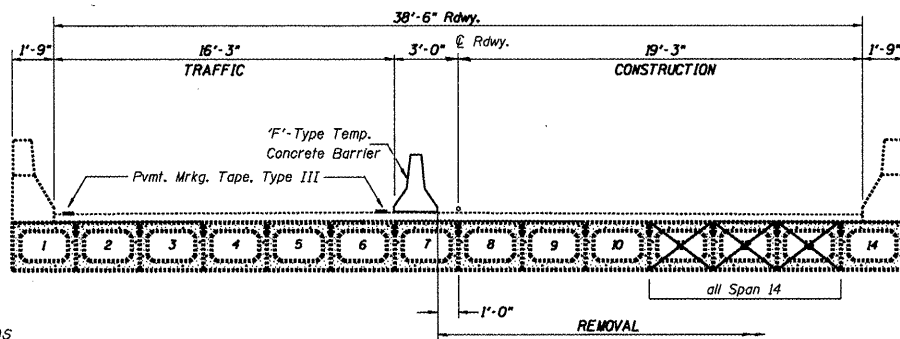

**ELEVATION**  
Stage II  
(Looking North)

☒ PPC Beams to be replaced

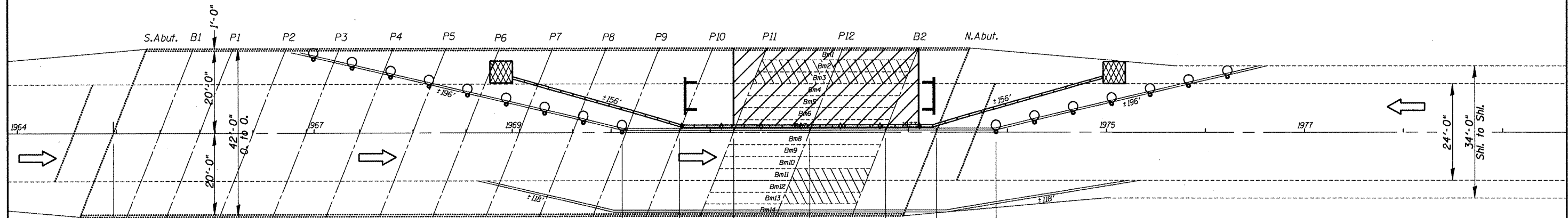

**PLAN**  
(Stage I)

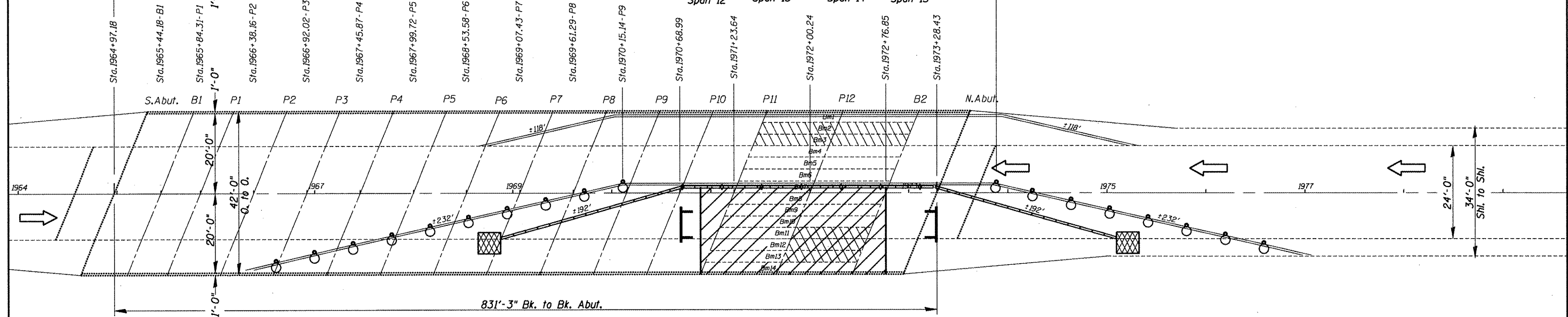

**PLAN**  
(Stage II)

**SYMBOLS**

- Work Area
- Type III Barricade
- Drum w/ steady burning light
- Beam Rem/Repl
- Bidirectional Barrier Wall Marker
- Temporary Concrete Barrier
- Impact Attenuator NRD TL3

**NOTES**  
Refer to Highway Standard 701321 in conjunction with this sheet for exact placement of traffic management devices and other clarifications as construction staging symbols and dimensioning were duplicated off of this standard.  
Barricades or Drums with bi-directional steady burn lights delineating the closed lane shall be placed in the work access opening during nonworking hours.  
Construction staging sequence shall be at the discretion of the Engineer.

SN.048-0075 IL.97  
over Spoon River

|  |                     |                |               |
|--|---------------------|----------------|---------------|
| FILE NAME =<br>SN048-0075_IL.97ovrSpoonRiv.dgn | USER NAME = jonesco | DESIGNED - CEJ | REVISED - --- |
|  |                     | DRAWN - CEJ    | REVISED - --- |
|  |                     | CHECKED - ---  | REVISED - --- |
|  |                     | DATE - ---     | REVISED - --- |
|  |                     |                |               |

**STATE OF ILLINOIS  
DEPARTMENT OF TRANSPORTATION**

**PROPOSED TRAFFIC CONTROL**

SCALE: \_\_\_\_\_ SHEET NO. \_\_\_\_\_ OF \_\_\_\_\_ SHEETS STA. \_\_\_\_\_ TO STA. \_\_\_\_\_

| F.A.P. RTE.                                     | SECTION   | COUNTY             | TOTAL SHEETS | SHEET NO. |
|---|-----------|--------------------|--------------|-----------|
| 626   | (44-B-1)I | KNOX               | 13           | 8         |
| PPC BEAM REPLACEMENT                            |           | CONTRACT NO. 68855 |              |           |
| FED. ROAD DIST. NO. 4 ILLINOIS FED. AID PROJECT |           |                    |              |           |