

ROUTE NO.	COUNTY	SECTION	SHEET NO.
FAT 55	McLEAN	70	40
SHEET NO. 3		JOA SHEETS	

• (157-1)HBR-5&VBR-1)8.57-2HB-1

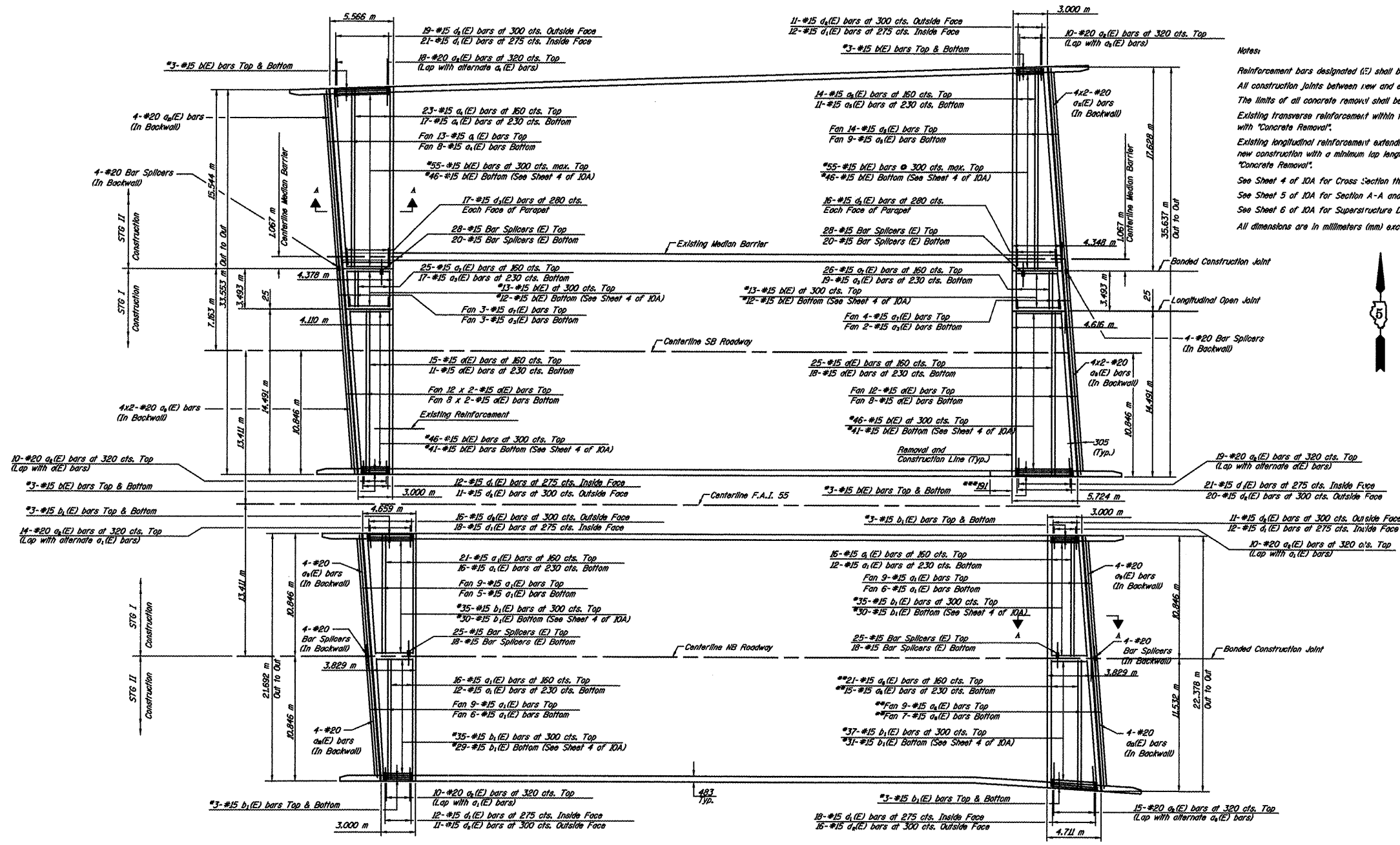

**Notes:**

Reinforcement bars designated (E) shall be epoxy coated.

All construction joints between new and existing construction shall be Bonded Construction Joints. The limits of all concrete removal shall be saw cut 20 mm into concrete.

Existing transverse reinforcement within the removal area shall be cut off flush with the removal line. Cost included with "Concrete Removal".

Existing longitudinal reinforcement extending into removed areas shall be cleaned, straightened and incorporated into the new construction with a minimum lap length of 610 mm except as noted. Cost included with "Concrete Removal".

See Sheet 4 of JOA for Cross Section thru deck.

See Sheet 5 of JOA for Section A-A and Silicone Joint Sealer Details.

See Sheet 6 of JOA for Superstructure Details, Parapet Reinforcement, Bar Details and Bill of Material.

All dimensions are in millimeters (mm) except as noted.



PLAN-DECK REINFORCEMENT

DESIGNED	GAE
CHECKED	JDA
DRAWN	NQ
CHECKED	GAE

\* Cut to fit. Use remainder in opposite Staged corner.  
Lap to existing reinforcement.

\*\* Cut to fit.

\*\*\* See sheet 6 of JOA for Exterior Parapet Elevation Joint Detail.

MIN. BAR LAP  
#15 bars = 500

**SUPERSTRUCTURE PLAN**  
**F.A.I. 55 OVER BUSINESS U.S. 51**  
**McLEAN COUNTY**  
**SN 057-0024 (NB)**  
**SN 057-0025 (SB)**  
**STA. 37+474.206**