

SHEET NO.	SECTION	COUNTY	DATE	SCALE	SHEET NO. 3
FAI 55		MCLEAN	70	54	14 SHEETS

• (57-4)HR-5&VBR-11&57-2HB-1

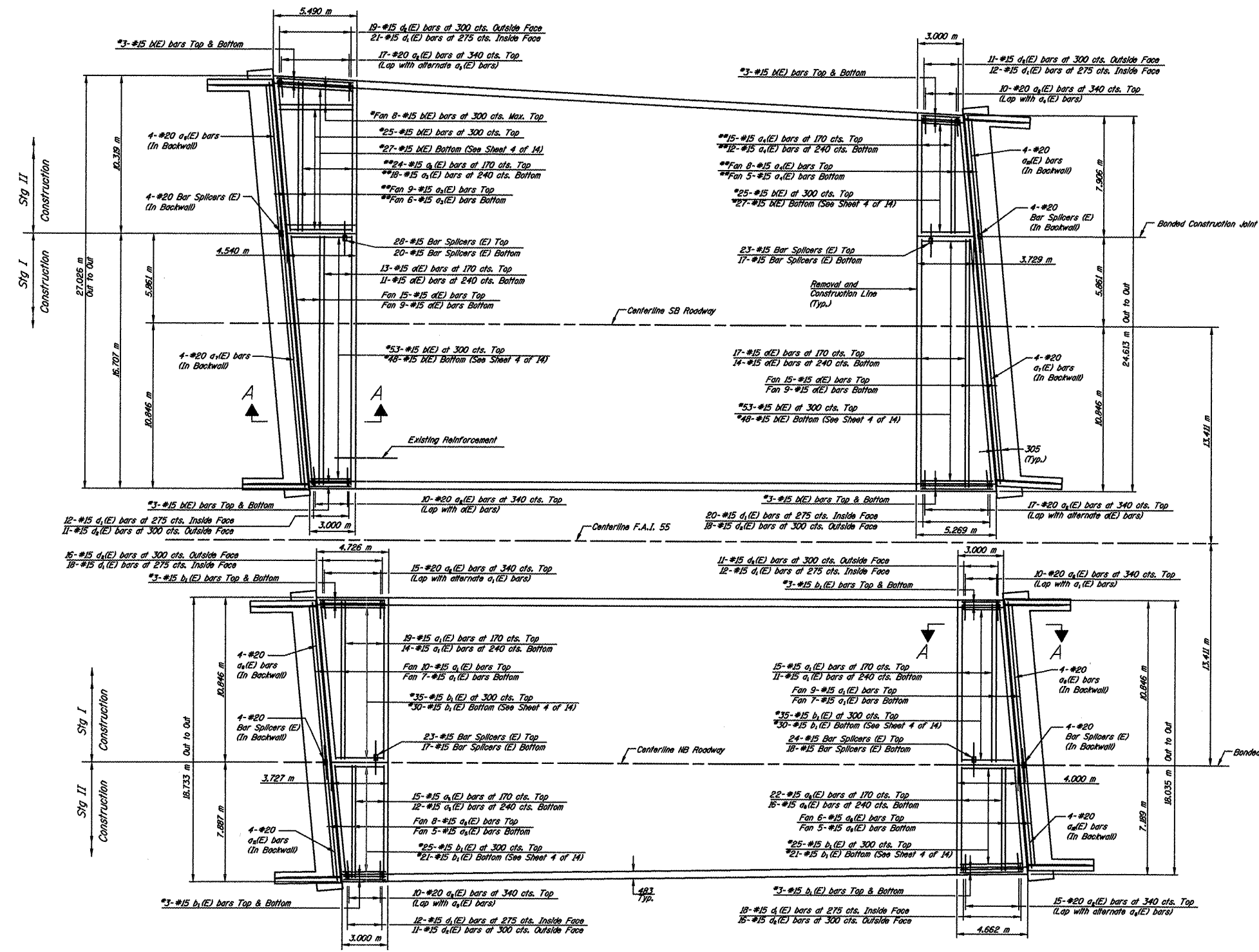

Notes:

- Reinforcement bars designated (E) shall be epoxy coated.
- All construction joints between new and existing construction shall be Banded Construction Joints.
- The limits of all concrete removal shall be cut 20 mm into concrete.
- Existing transverse reinforcement within the removal area shall be cut off flush with the removal line. Cost included with "Concrete Removal".
- Existing longitudinal reinforcement extending into removed areas shall be cleaned, straightened and incorporated into the new construction with a minimum lap length of 60 mm except as noted. Cost included with "Concrete Removal".
- See Sheet 4 of 14 For Cross Section thru deck.
- See Sheet 5 of 14 For Superstructure Details, Parapet Reinforcement, Bar Details and Bill of Material.
- See Sheet 6 of 14 For Section A-A.
- All dimensions are in millimeters (mm) except as noted.

PLAN-DECK REINFORCEMENT

DESIGNED	GAE
CHECKED	JDA
DRAWN	NQ
CHECKED	GAE

* Cut to fit. Use remainder in opposite Staged corner. Lap to existing reinforcement.

** Cut to fit.

MIN. BAR LAP
#15 bars = 510

DECK REPAIR
F.A.I. 55 OVER CONSTITUTION TRAIL
MCLEAN COUNTY
SN 057-0026 (NB)
SN 057-0027 (SB)
STA. 38+263.167