

1- STA 2196+26.1
 PROPOSED PIPE CULVERT, TY 1, CS/A, 18"Ø x 56'
 USFL = 665.12 (+01.0 34.9' LT)
 DSFL = 663.64 (+57.0 35.3' LT)
 METAL END SECTIONS 18", 2 EACH
 TRENCH BACKFILL, 5.4 CU YD

2- STA 2197+46.0
 PROPOSED DOUBLE PIPE CULVERT, TY 1, RCCP, 42"Ø x 62'
 USFL = 660.58 (30.5' RT) DSFL = 660.12 (31.5' LT)
 DRAINAGE AREA = 34.1 ACRES
 Q30 = 122 CFS Q100 = 167 CFS
 CONCRETE STRUCTURES, 8.8 CU YD (STD 542121)
 REINFORCEMENT BARS, 540 LBS (STD 542121)
 TRENCH BACKFILL, 65.0 CU YD

3- STA 2198+34.5
 PROPOSED PIPE CULVERT, TY 1, CS/A, 15"Ø x 38'
 USFL = 665.04 (+51.3 28.1' LT)
 DSFL = 663.90 (+13.3 27.8' LT)
 METAL END SECTIONS 15", 2 EACH
 TRENCH BACKFILL, 1.5 CU YD

4- STA 2200+22.5
 PROPOSED PIPE CULVERT, TY 1, CS/A, 15"Ø x 34'
 USFL = 665.31 (+05.9 31.8' LT)
 DSFL = 665.12 (+39.9 31.9' LT)
 METAL END SECTIONS 15", 2 EACH
 TRENCH BACKFILL, 1.6 CU YD

PARCEL NO. 6144110
 ST. JOHN'S ANGLICAN CHURCH

PARCEL NO. 6144111
 DOUGLAS & MARIE ANDERSON

PR FAS 1597 CURVE 30952 DATA
 PI STA = 2201+81.59
 Δ = 0° 27' 07" (RT)
 D = 0° 22' 55"
 R = 15,000.00'
 T = 59.17'
 L = 118.34'
 E = 0.12'
 e = N.C.
 PC STA = 2201+22.42
 PT STA = 2202+40.76

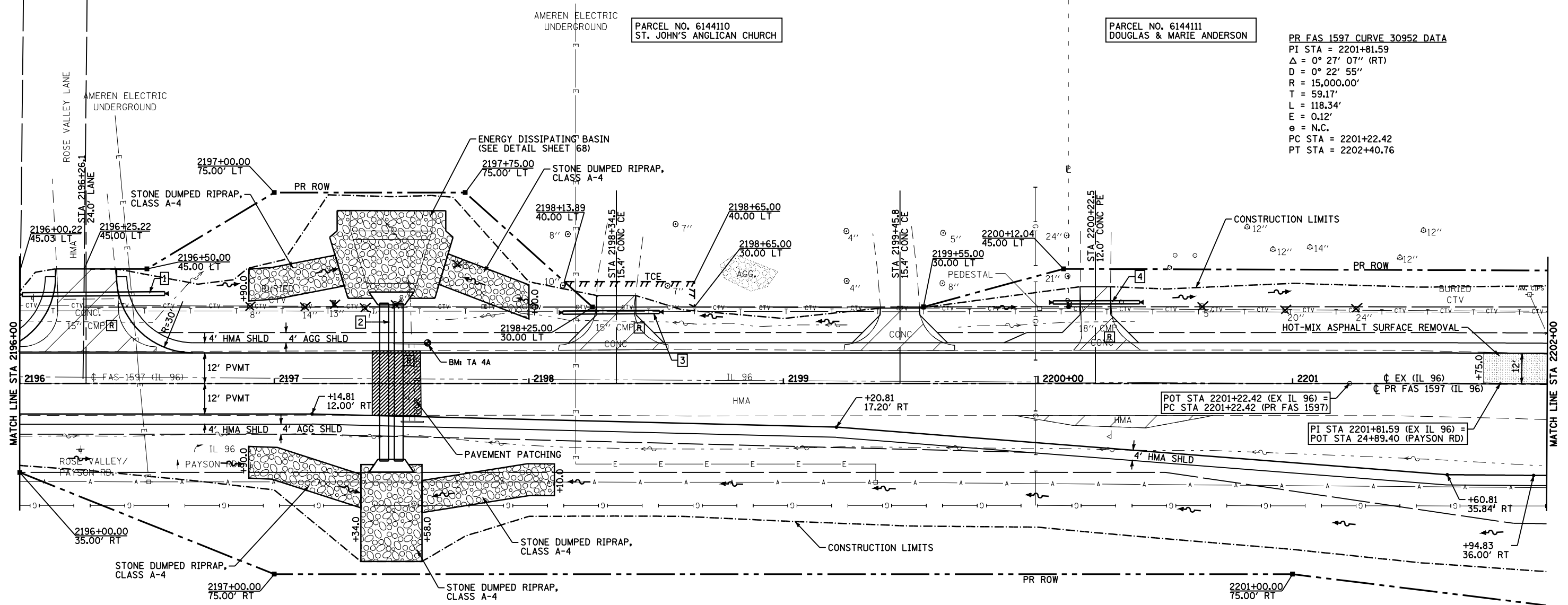

PARCEL NO. 6144107
 MARILYN SHRIVER & SONS, AN
 ILLINOIS GENERAL PARTNERSHIP

BENCHMARK TA 4A:
 ELEV = 665.986 (NGVD '29 DATUM)
 FAS 1597 STA 2197+60.2 15.9' LT
 CHSLD " " ON HIGH POINT OF HEADWALL (WEST END SOUTH HEADWALL)
 2' BY 2' BOX CULVERT

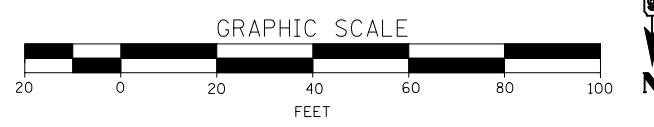

FILE NAME =	USER NAME = laughlinr1	DESIGNED -	REVISED -	STATE OF ILLINOIS DEPARTMENT OF TRANSPORTATION	PLAN VIEW - FAS 1597 (IL 96)			F.A. RTE.	SECTION	COUNTY	TOTAL SHEETS	SHEET NO.
et:\pwwork\pwwid01\LAUGHLINRL\0114681\02	9PLAN02.dgn	DRAWN -	REVISED -		SCALE: 1"=20'	SHEET NO. 3 OF 19 SHEETS	STA. 2196+00 TO STA. 2202+00	• - FAS 1597 & FAU 7830	(11)N	ADAMS	117	29
	PLOT SCALE = 40.0000 ' / IN.	CHECKED -	REVISED -									
	PLOT DATE = Dec-12-2008 02:51:15PM	DATE -	REVISED -					FED. ROAD DIST. NO.	ILLINOIS FED. AID PROJECT			
CONTRACT NO. 72817												