

PR FAS 1597 CURVE 30952 DATA
 PI STA = 2201+81.59
 $\Delta = 0^\circ 27' 07''$ (RT)
 $D = 0^\circ 22' 55''$
 $R = 15,000.00'$
 $T = 59.17'$
 $L = 118.34'$
 $E = 0.12'$
 $e = \text{NONE}$
 PC STA = 2201+22.42
 PT STA = 2202+40.76

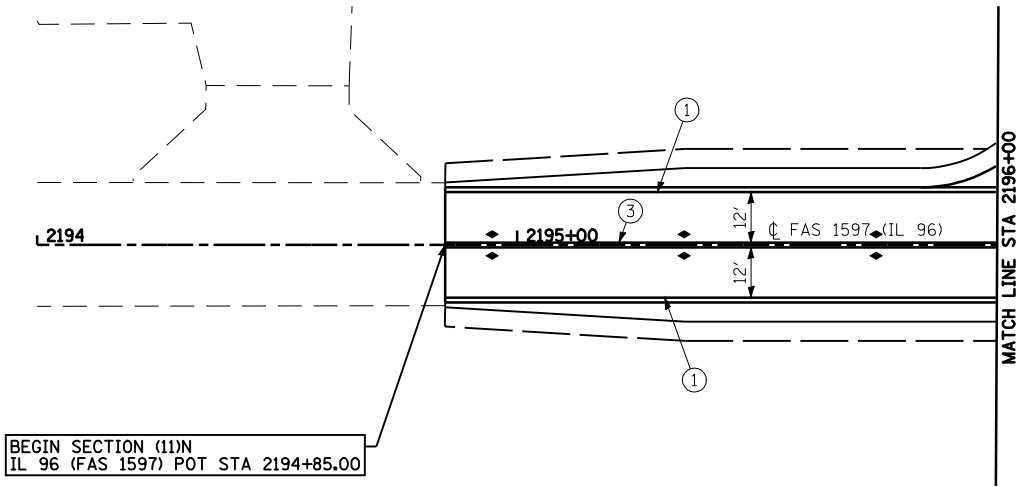

- LEGEND:
- ▷ ONE-WAY CRYSTAL RAISED REFLECTIVE PAVEMENT MARKER
 - ◆ TWO-WAY AMBER RAISED REFLECTIVE PAVEMENT MARKER
 - ▶ ONE-WAY AMBER RAISED REFLECTIVE PAVEMENT MARKER
 - ① URETHANE PAVEMENT MARKING, 5" WHITE-SOLID
 - ② URETHANE PAVEMENT MARKING, 5" WHITE-SKIP DASH
 - ③ URETHANE PAVEMENT MARKING, 5" YELLOW-DUAL SOLID
 - ④ URETHANE PAVEMENT MARKING, 6" WHITE-SOLID
 - ⑤ URETHANE PAVEMENT MARKING, 6" WHITE-SKIP DASH
 - ⑥ PREFORMED PLASTIC, TYPE B-INLAID, 8" WHITE-SOLID
 - ⑦ PREFORMED PLASTIC, TYPE B-INLAID, 12" WHITE-SOLID
 - ⑧ PREFORMED PLASTIC, TYPE B-INLAID, 12" YELLOW-SOLID
 - ⑨ PREFORMED PLASTIC, TYPE B-INLAID, 24" WHITE-SOLID
 - ⑩ PREFORMED PLASTIC, TYPE B-INLAID, WHITE-LETTERS & SYMBOLS
 - ⑪ PREFORMED PLASTIC, TYPE B-INLAID, 6" WHITE-SOLID

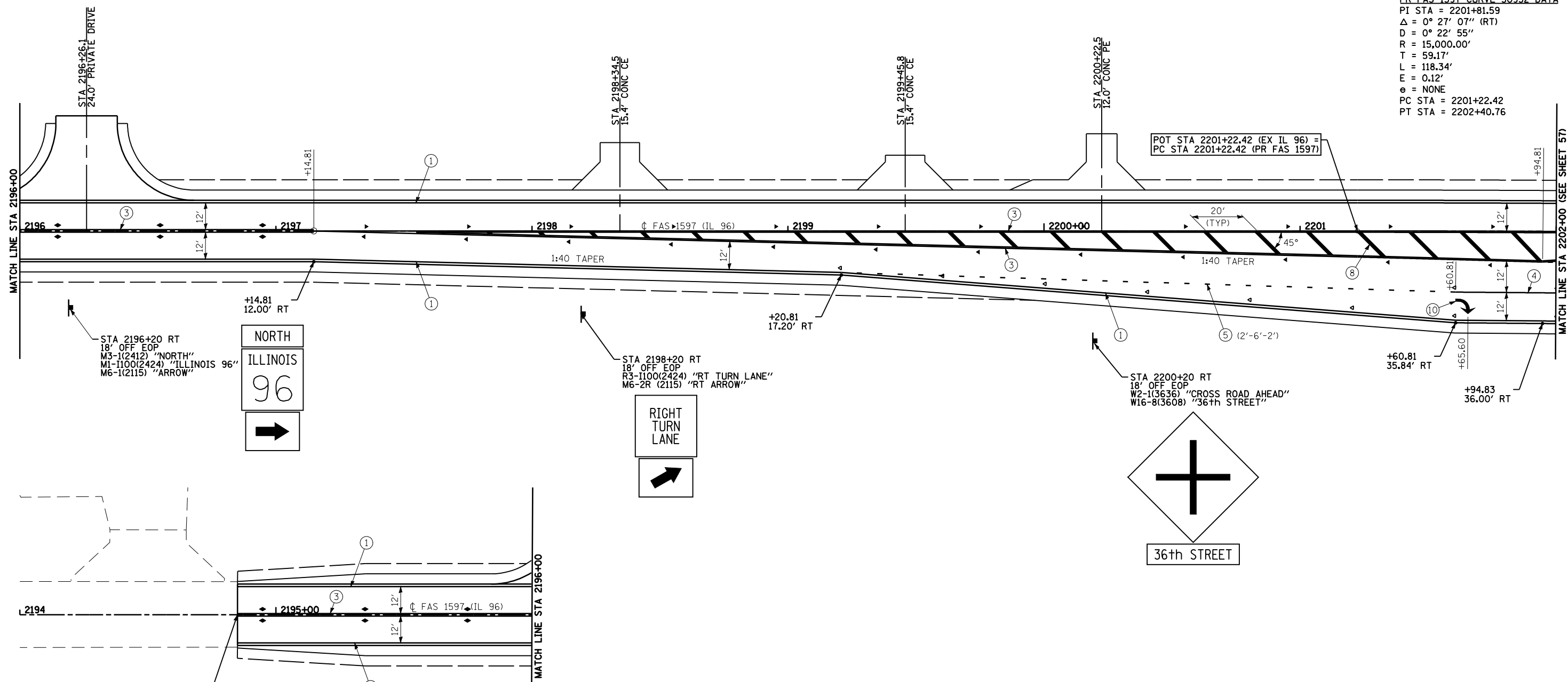
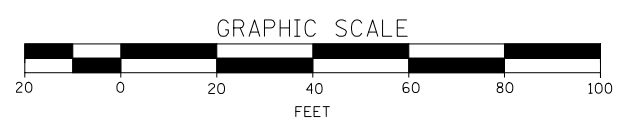

FILE NAME = et:\pw\work\PWIDOT\LAUGHLIN\ld\0114681\096STRIPING01.dgn	USER NAME = laughlinr1	DESIGNED -	REVISED -	STATE OF ILLINOIS DEPARTMENT OF TRANSPORTATION	SIGNING AND PAVEMENT MARKING PLAN FAS 1597 (IL 96)	F.A. RTE.	SECTION	COUNTY	TOTAL SHEETS	SHEET NO.
PLOT SCALE = 40.0000' / IN.	CHECKED -	REVISED -	• - FAS 1597 & FAU 7830			(11N)	ADAMS	117	56	
PLOT DATE = Dec-12-2008 02:53:50PM	DATE -	REVISED -	FED. ROAD DIST. NO.			ILLINOIS	FED. AID PROJECT	CONTRACT NO. 72817		
SCALE: 1"=20'		SHEET NO. 1 OF 5 SHEETS				STA. 2194+00 TO STA. 2202+00				