

DATE	
BY	
FINAL SURVEY	SURVEYED
NOTE BOOK	PLOTTED
NO.	TEMPLATE
	AREAS CHECKED

DATE	
BY	
ORIGINAL SURVEY	SURVEYED
NOTE BOOK	PLOTTED
NO.	TEMPLATE
	AREAS CHECKED

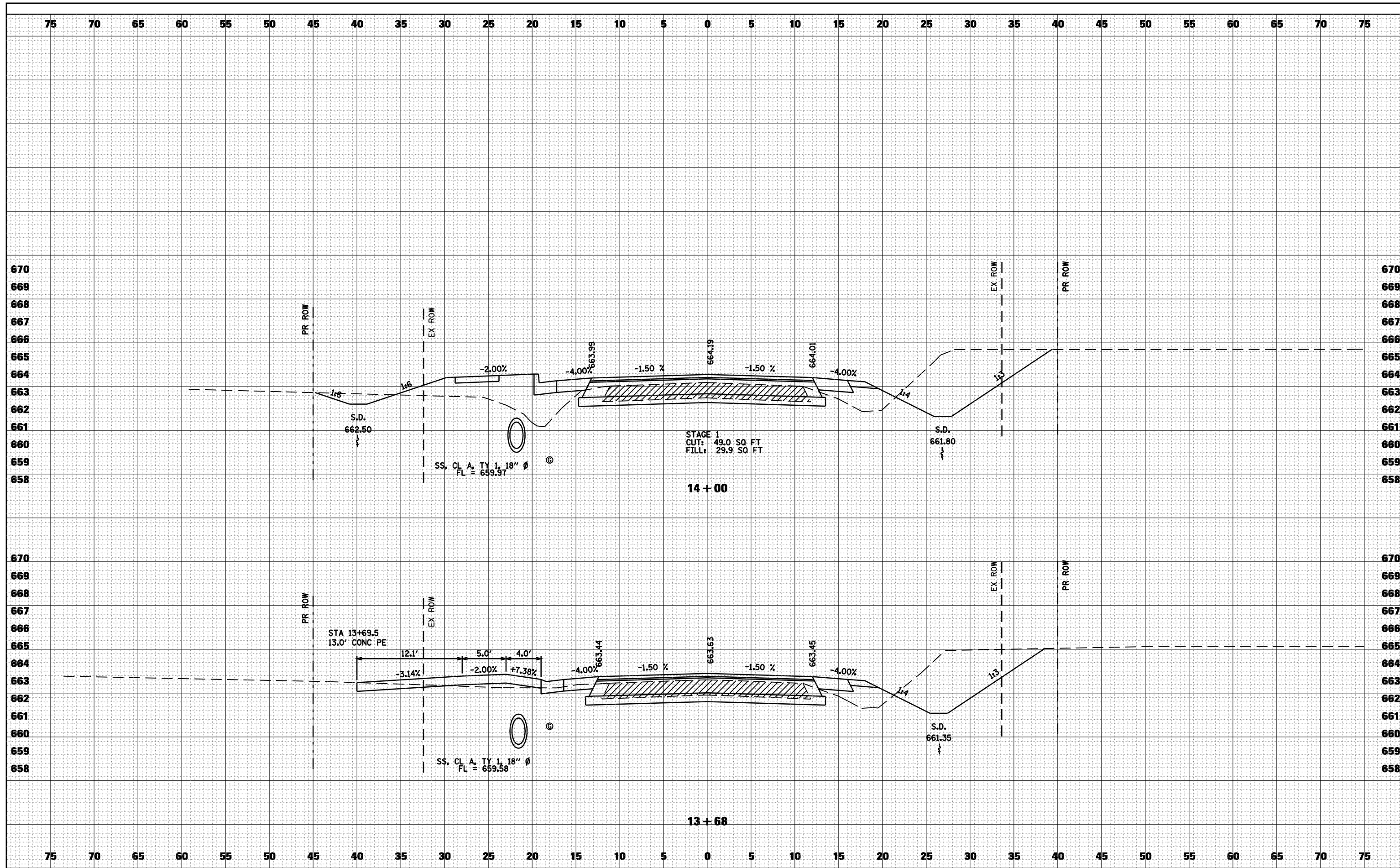

FILE NAME =	USER NAME = laughlinr1	DESIGNED -	REVISED -
c:\pwork\PWIDOT\LAUGHLINRL\d011468\109XSS200_PAYSONRD.dgn		CHECKED -	REVISED -
		DRAWN -	REVISED -
		CHECKED -	REVISED -

**STATE OF ILLINOIS
DEPARTMENT OF TRANSPORTATION**

CROSS SECTIONS - FAU 7817 (PAYSON ROAD)

SCALE: 1"=5' SHEET NO. 2 OF 8 SHEETS STA. 13+68 TO STA. 14+00

F.A. RTE.	SECTION	COUNTY	TOTAL SHEETS	SHEET NO.
• -	(11)N	ADAMS	117	110

CONTRACT NO. 72817
ILLINOIS FED. AID PROJECT