

DATE	
BY	
FINAL SURVEY	SURVEYED
NOTE BOOK	PLOTTED
NO.	TEMPLATE
	AREAS CHECKED
	AREAS CHECKED

DATE	
BY	
ORIGINAL SURVEY	SURVEYED
NOTE BOOK	PLOTTED
NO.	TEMPLATE
	AREAS CHECKED
	AREAS CHECKED

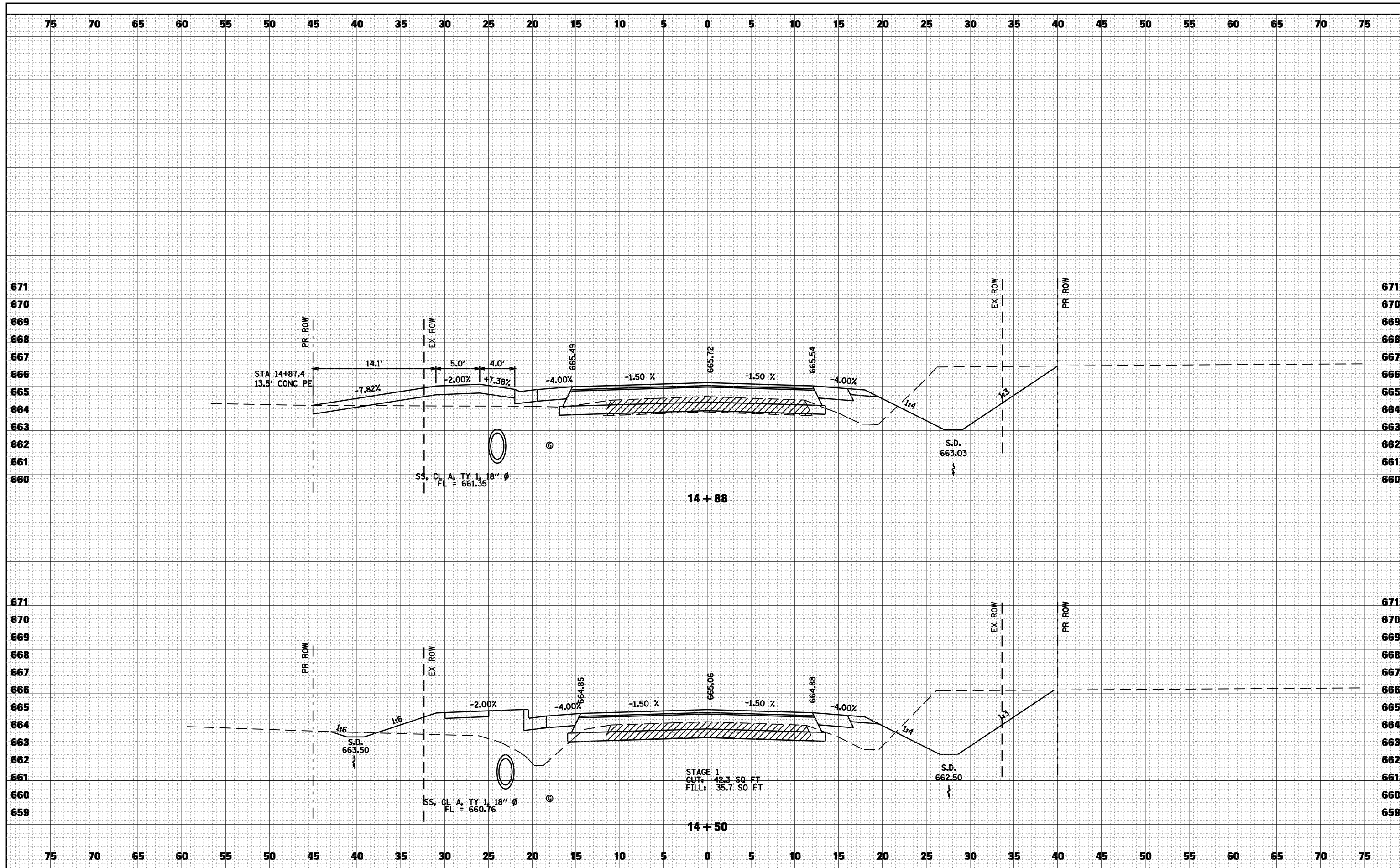

FILE NAME =	USER NAME = laughlinr1	DESIGNED -	REVISED -
ct:\pw_work\PWIDOT\LAUGHLINRL\d011468\1\09XSS200_PAYSONRD.dgn		CHECKED -	REVISED -
		DRAWN -	REVISED -
		CHECKED -	REVISED -

**STATE OF ILLINOIS  
DEPARTMENT OF TRANSPORTATION**

**CROSS SECTIONS - FAU 7817 (PAYSON ROAD)**

SCALE: 1"=5'      SHEET NO. 3 OF 8 SHEETS      STA. 14+50      TO STA. 14+88

F.A. RTE.	SECTION	COUNTY	TOTAL SHEETS	SHEET NO.
• - FAS 1597 & FAU 7830	(11)N	ADAMS	117	111
FED. ROAD DIST. NO.	ILLINOIS FED. AID PROJECT			